

**DETAIL B**  
SCALE: 1"=10'

• TOP OF DEPRESSED CURB  
•• TOP OF CURB FLUSH W/SIDEWALK

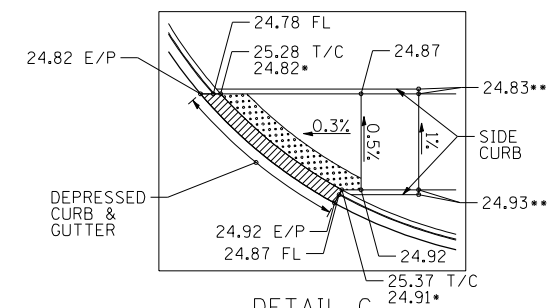

**DETAIL C**  
SCALE: 1"=10'

• TOP OF DEPRESSED CURB  
•• TOP OF CURB FLUSH W/SIDEWALK

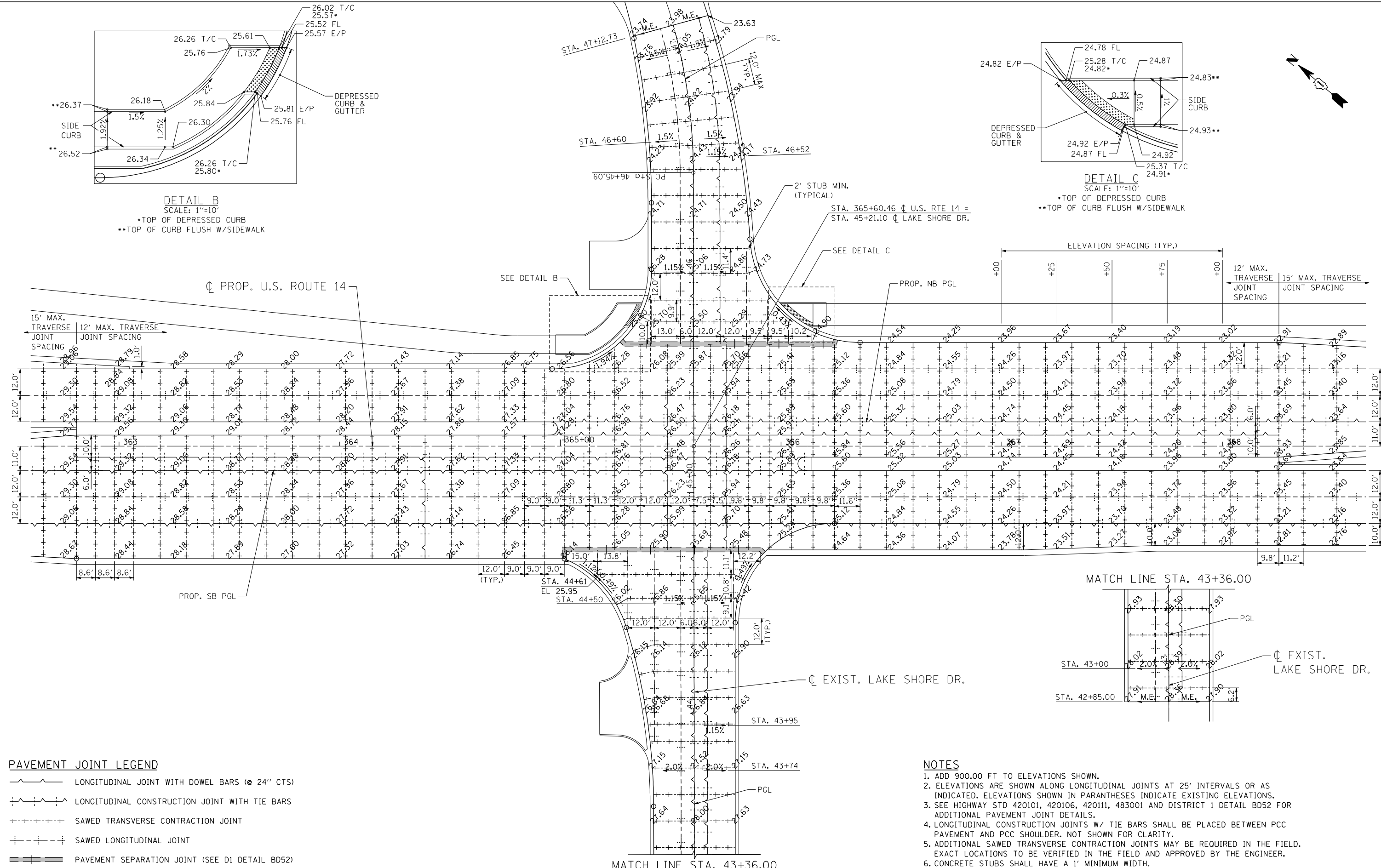

**PAVEMENT JOINT LEGEND**

	LONGITUDINAL JOINT WITH DOWEL BARS @ 24" CTS
	LONGITUDINAL CONSTRUCTION JOINT WITH TIE BARS
	SAWED TRANSVERSE CONTRACTION JOINT
	SAWED LONGITUDINAL JOINT
	PAVEMENT SEPARATION JOINT (SEE D1 DETAIL BD52)

- NOTES**
1. ADD 900.00 FT TO ELEVATIONS SHOWN.
  2. ELEVATIONS ARE SHOWN ALONG LONGITUDINAL JOINTS AT 25' INTERVALS OR AS INDICATED. ELEVATIONS SHOWN IN PARANTESES INDICATE EXISTING ELEVATIONS.
  3. SEE HIGHWAY STD 420101, 420106, 420111, 483001 AND DISTRICT 1 DETAIL BD52 FOR ADDITIONAL PAVEMENT JOINT DETAILS.
  4. LONGITUDINAL CONSTRUCTION JOINTS W/ TIE BARS SHALL BE PLACED BETWEEN PCC PAVEMENT AND PCC SHOULDER. NOT SHOWN FOR CLARITY.
  5. ADDITIONAL SAWED TRANSVERSE CONTRACTION JOINTS MAY BE REQUIRED IN THE FIELD. EXACT LOCATIONS TO BE VERIFIED IN THE FIELD AND APPROVED BY THE ENGINEER.
  6. CONCRETE STUBS SHALL HAVE A 1' MINIMUM WIDTH.

FILE NAME = #FILEL#  
 USER NAME = HECHTBR  
 DESIGNED -  
 DRAWN - AG  
 CHECKED - BRH  
 DATE - 11/01/13  
 REVISED -  
 REVISED -  
 REVISED -  
 REVISED -  
 STATE OF ILLINOIS  
 DEPARTMENT OF TRANSPORTATION  
 U.S. ROUTE 14  
 INTERSECTION DETAIL  
 U.S. ROUTE 14 & LAKE SHORE DRIVE  
 SCALE: 1"=50'  
 SHEET NO. OF SHEETS STA. TO STA.  
 F.A.P. RTE. SECTION COUNTY TOTAL SHEETS SHEET NO.  
 305 27R-2 MCHENRY 673 383  
 CONTRACT NO. 62268  
 FED. ROAD DIST. NO. 1 ILLINOIS FED. AID PROJECT

FILE NAME = #FILEL#	USER NAME = HECHTBR	DESIGNED -	REVISED -	<b>STATE OF ILLINOIS</b> <b>DEPARTMENT OF TRANSPORTATION</b> U.S. ROUTE 14	<b>INTERSECTION DETAIL</b> <b>U.S. ROUTE 14 &amp; LAKE SHORE DRIVE</b>	F.A.P. RTE.	SECTION	COUNTY	TOTAL SHEETS	SHEET NO.
exp U.S. Services Inc. Chicago, IL	PLOT SCALE = #SCALE#	DRAWN - AG	REVISED -			305	27R-2	MCHENRY	673	383
exp U.S. Services Inc. Chicago, IL	PLOT DATE = #DATE#	CHECKED - BRH	REVISED -			CONTRACT NO. 62268				
INDUSTRIAL-INFRASTRUCTURE-SUSTAINABILITY		DATE - 11/01/13	REVISED -			FED. ROAD DIST. NO. 1 ILLINOIS FED. AID PROJECT				