

NOTE:
SEE SHEET 396 FOR NOTES.

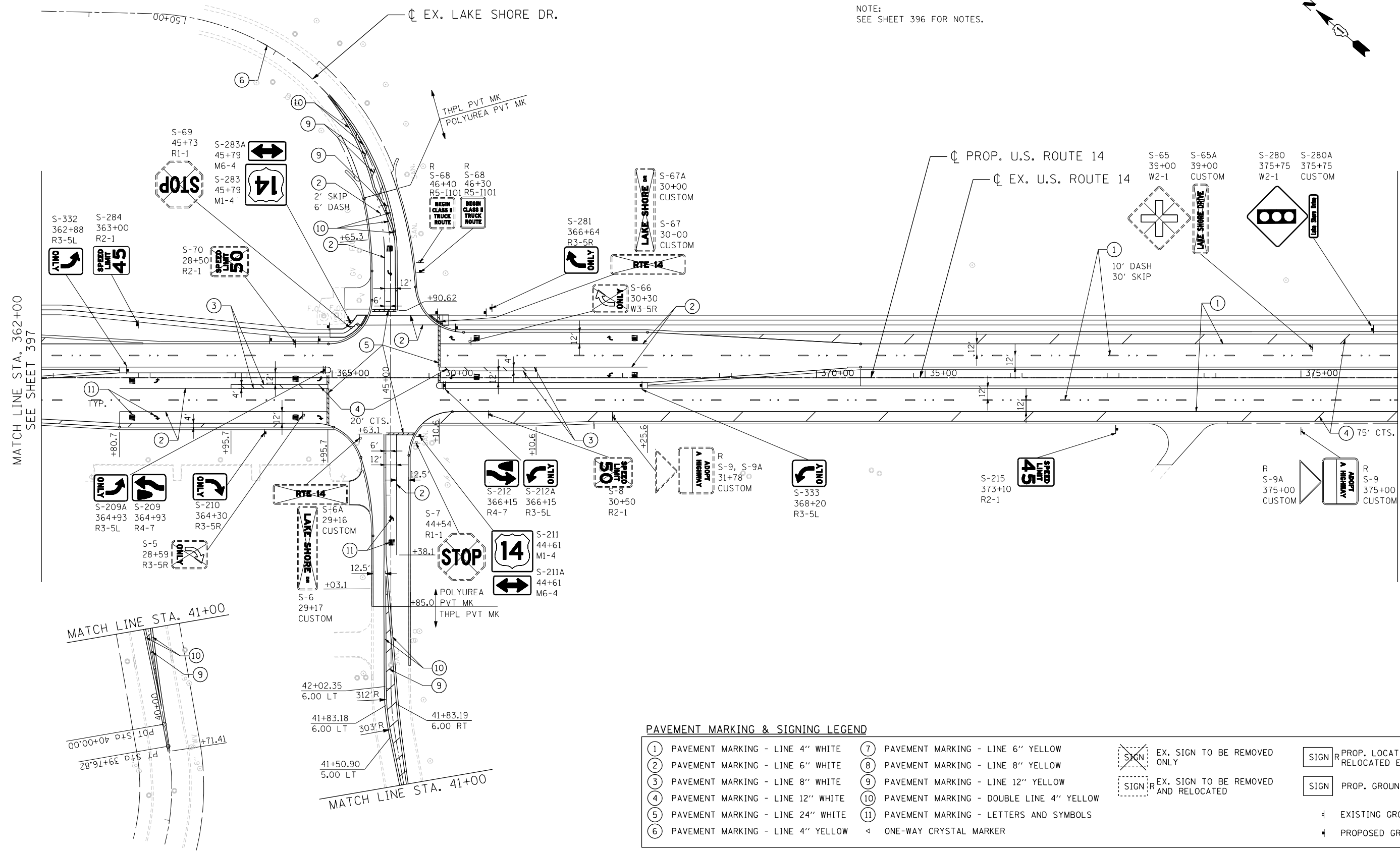

MATCH LINE STA. 362+00
SEE SHEET 397

MATCH LINE STA. 376+00
SEE SHEET 400

MATCH LINE STA. 41+00

MATCH LINE STA. 41+00

PAVEMENT MARKING & SIGNING LEGEND			
①	PAVEMENT MARKING - LINE 4" WHITE	⑦	PAVEMENT MARKING - LINE 6" YELLOW
②	PAVEMENT MARKING - LINE 6" WHITE	⑧	PAVEMENT MARKING - LINE 8" YELLOW
③	PAVEMENT MARKING - LINE 8" WHITE	⑨	PAVEMENT MARKING - LINE 12" YELLOW
④	PAVEMENT MARKING - LINE 12" WHITE	⑩	PAVEMENT MARKING - DOUBLE LINE 4" YELLOW
⑤	PAVEMENT MARKING - LINE 24" WHITE	⑪	PAVEMENT MARKING - LETTERS AND SYMBOLS
⑥	PAVEMENT MARKING - LINE 4" YELLOW	◀	ONE-WAY CRYSTAL MARKER
			EX. SIGN TO BE REMOVED ONLY
			EX. SIGN TO BE REMOVED AND RELOCATED
			PROP. LOCATION OF RELOCATED EX. SIGN
			PROP. GROUND SIGN
			EXISTING GROUND SIGN
			PROPOSED GROUND SIGN

FILE NAME = T:\DOCUMENTS\1934\9401\CIVIL\DCN\PMW00.OP.DGN
 USER NAME = HECHTBR
 DESIGNED -
 DRAWN - AMB
 CHECKED - TMH
 DATE - 11/01/13
 REVISED -
 REVISED -
 REVISED -
 REVISED -
 REVISED -
 REVISED -
 PLOT SCALE = *SCALE*
 PLOT DATE = *DATE*
 exp U.S. Services Inc. Chicago, IL BUILDINGS-EARTH & ENVIRONMENT-ENERGY INDUSTRIAL-INFRASTRUCTURE-SUSTAINABILITY

STATE OF ILLINOIS
DEPARTMENT OF TRANSPORTATION
 U.S. ROUTE 14

PAVEMENT MARKING & SIGNING PLANS
STA. 362+00 TO STA. 376+00

SCALE: 1"=50' SHEET NO. OF SHEETS STA. TO STA.

F.A.P. RTE.	SECTION	COUNTY	TOTAL SHEETS	SHEET NO.
305	27R-2	MCHENRY	673	399
CONTRACT NO. 62268				
FED. ROAD DIST. NO. 1 ILLINOIS FED. AID PROJECT				