

MEDIAN LANDSCAPE SCHEDULE

SECTION	PERENNIAL PLANT, ORNAMENTAL TYPE (SCIENTIFIC NAME)	COMMON NAME	QUANTITY	SPACING (IN)
A	RUDBECKIA FULGIDA 'GOLDSTURM'	BLACK-EYED SUSANS	28	18
	HELICTROTTRICHON SEMPERVIRENS 'SAPHIRSPRUDEL'	BLUE OAT GRASS	12	18
	HEUCHERA 'CITRONELLE'	CITRONELLE CORALBELL	14	18
	CALAMAGROSTIS X ACUTIFLORA 'KARL FOERSTER'	FEATHER REED GRASS	4	36
	NEPETA X FAASSENII 'KIT CAT'	KIT CAT CATMINT	24	18
	ECHINACEA PURPUREA 'MAGNUS'	MAGNUS CONEFLOWERS	32	18
B	HEMEROCALLIS 'STELLA DE ORO'	STELLA DE ORO DAYLILY	24	18
	CALAMAGROSTIS X ACUTIFLORA 'KARL FOERSTER'	FEATHER REED GRASS	5	36
C	RUDBECKIA FULGIDA 'GOLDSTURM'	BLACK-EYED SUSANS	60	18
	HELICTROTTRICHON SEMPERVIRENS 'SAPHIRSPRUDEL'	BLUE OAT GRASS	24	18
	HEUCHERA 'CITRONELLE'	CITRONELLE CORALBELL	16	18
	HEMEROCALLIS 'STELLA DE ORO'	STELLA DE ORO DAYLILY	22	18
	CALAMAGROSTIS X ACUTIFLORA 'KARL FOERSTER'	FEATHER REED GRASS	5	36

EX. U.S. ROUTE 14
 PROP. U.S. ROUTE 14

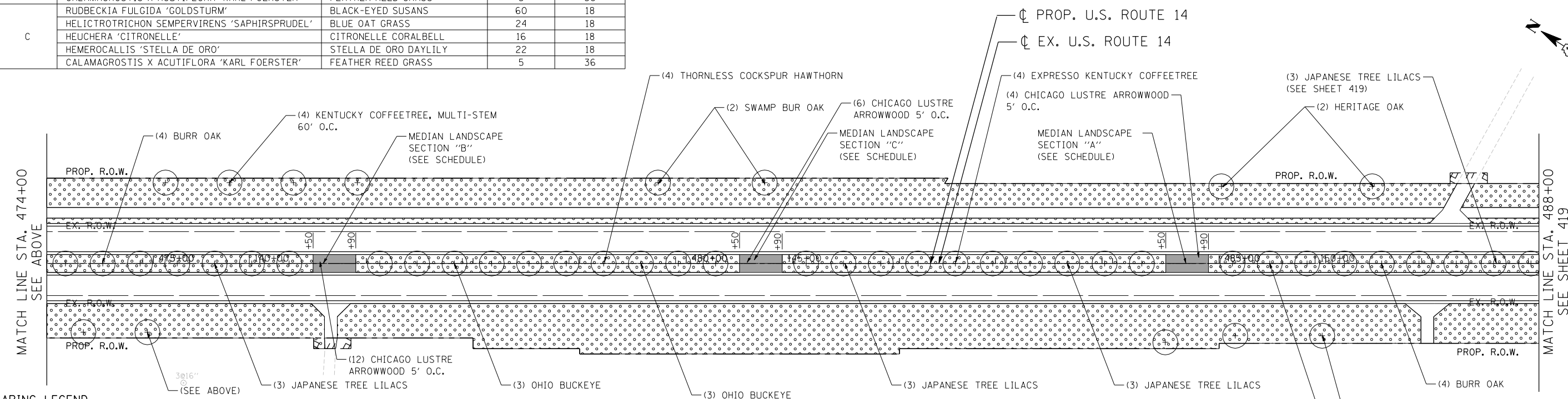

LANDSCAPING LEGEND

	SEEDING, CLASS 2A (SALT TOLERANT ROADSIDE MIXTURE) AND EROSION CONTROL BLANKET		TURF REINFORCEMENT MAT SEEDING, CLASS 2A (SALT TOLERANT ROADSIDE MIXTURE)
	SEEDING, CLASS 4 (NATIVE GRASS) COMPOST FURNISH AND PLACE, 6" AND EROSION CONTROL BLANKET		BIOSWALE

STATE OF ILLINOIS
 DEPARTMENT OF TRANSPORTATION
 U.S. ROUTE 14

LANDSCAPING PLANS
 STA. 460+00 TO STA. 488+00

FILE NAME =	USER NAME = HECHTBR	DESIGNED -	REVISED -
#FILEL#		DRAWN - MRK	REVISED -
		CHECKED - TKL	REVISED -
		DATE - 11/01/13	REVISED -

SCALE: 1"=50' SHEET NO. OF SHEETS STA. TO STA.

F.A.P. RTE.	SECTION	COUNTY	TOTAL SHEETS	SHEET NO.
305	27R-2	MCHENRY	673	418
CONTRACT NO. 62268				
FED. ROAD DIST. NO. 1 ILLINOIS FED. AID PROJECT				

I:\PROJECTS\11-07-2013_163618\11-07-2013_163618.DGN
 T:\DOCUMENT\19343901\CIVIL\DCN\LDN\LDN000#E.DGN
 HECHTBR
 exp U.S. Services Inc.
 CHICAGO, IL
 BUILDING-EARTH & ENVIRONMENT-ENERGY
 INDUSTRIAL-INFRASTRUCTURE-SUSTAINABILITY