

150 140 130 120 110 100 90 80 70 60 50 40 30 20 10 0 10 20 30 40 50 60 70 80 90 100 110 120 130 140 150

PR C US RTE 14

DATE	
BY	
SURVEYED	
PLOTTED	
TEMPLATE	
AREAS CHECKED	
FINAL SURVEY	
NOTE BOOK	
NO.	

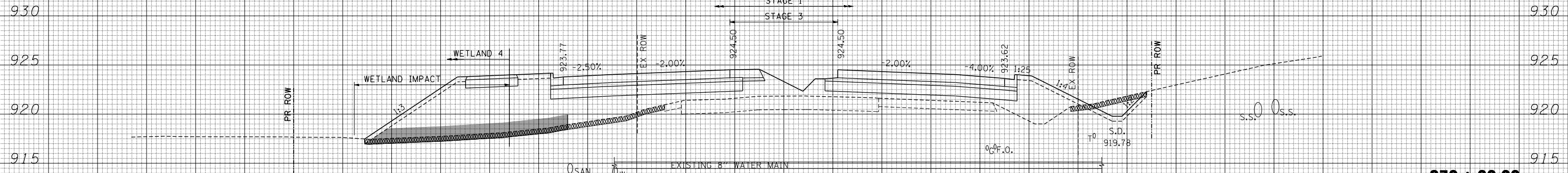

370+00.00

STAGE 1
 EARTH EXCAVATION = 12.5 SQ FT
 TOPSOIL EXCAVATION = 38.4 SQ FT
 EMBANKMENT = 337.3 SQ FT
 UNSUIT. MATERIALS = 0.0 SQ FT
 AGGREGATE SUBGRADE IMPROVEMENT (CU YD) (CU YD) PLACEMENT = 58.8 SQ FT

DATE	
BY	
SURVEYED	
PLOTTED	
TEMPLATE	
AREAS CHECKED	
ORIGINAL SURVEY	
NOTE BOOK	
NO.	

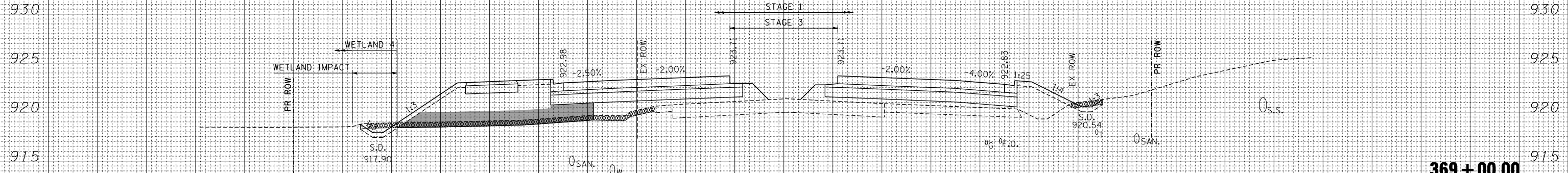

369+00.00

STAGE 1
 EARTH EXCAVATION = 7.1 SQ FT
 TOPSOIL EXCAVATION = 33.3 SQ FT
 EMBANKMENT = 207.2 SQ FT
 UNSUIT. MATERIALS = 0.0 SQ FT
 AGGREGATE SUBGRADE IMPROVEMENT (CU YD) (CU YD) PLACEMENT = 59.2 SQ FT

- LEGEND**
- TOPSOIL REMOVAL
 - UNSUIT. MATERIAL
 - AGGREGATE SUBGRADE IMPROVEMENT (CU YD)
 - EARTH EXCAVATION MULTI-USE PATH (80% IDOT 20% MCD)

AGGREGATE SUBGRADE IMPROVEMENT (CU YD) (CU YD) PLACEMENT = 59.2 SQ FT

PR C US RTE 14

150 140 130 120 110 100 90 80 70 60 50 40 30 20 10 0 10 20 30 40 50 60 70 80 90 100 110 120 130 140 150

FILE NAME =	USER NAME = \$USER\$	DESIGNED -	REVISED -
\$FILEL\$		DRAWN - AC	REVISED -
		CHECKED - BRH	REVISED -
		DATE - 11/01/13	REVISED -



**STATE OF ILLINOIS
 DEPARTMENT OF TRANSPORTATION**

U.S. ROUTE 14 CROSS SECTIONS

SCALE: HORIZ. 1" = 10' VERT. 1" = 5' STA. 369+00.00 TO STA. 370+00.00

F.A.P. RTE.	SECTION	COUNTY	TOTAL SHEETS	SHEET NO.
305	27R-2	MCHENRY	673	508
			CONTRACT NO. 62268	

ILLINOIS FED. AID PROJECT