

DATE	
BY	
SURVEYED	
PLOTTED	
TEMPLATE	
NOTE BOOK	
AREAS CHECKED	
NO.	

DATE	
BY	
SURVEYED	
PLOTTED	
TEMPLATE	
NOTE BOOK	
AREAS CHECKED	
NO.	

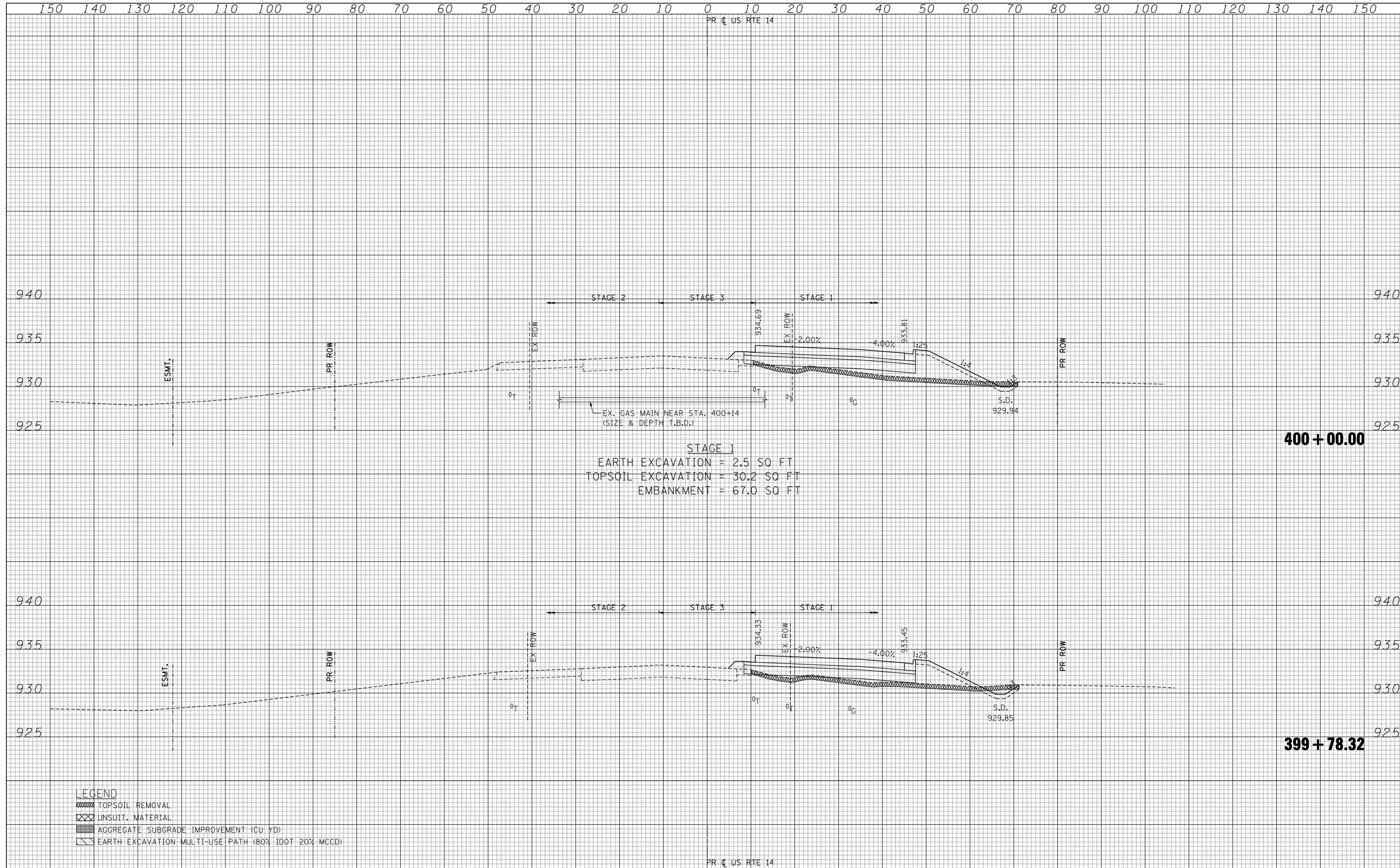

400 + 00.00

399 + 78.32

- LEGEND**
- TOPSOIL REMOVAL
 - UNSUIT. MATERIAL
 - AGGREGATE SUBGRADE IMPROVEMENT (CU YD)
 - EARTH EXCAVATION: MULTI-USE PATH (80% IDOT 20% MCCD)

FILE NAME =
 #FILEL#
 exp U.S. Services Inc.
 Chicago, IL
 BUILDINGS-EARTH & ENVIRONMENT-ENERGY
 INDUSTRIAL-INFRASTRUCTURE-SUSTAINABILITY

USER NAME = #USER#
 DESIGNED -
 DRAWN - AC
 CHECKED - BRH
 DATE - 11/01/13

REVISED -
 REVISED -
 REVISED -
 REVISED -

**STATE OF ILLINOIS
 DEPARTMENT OF TRANSPORTATION**

U.S. ROUTE 14 CROSS SECTIONS
 SCALE: HORIZ. 1" = 10' VERT. 1" = 5'
 STA. 399+78.32 TO STA. 400+00.00

F.A.P. RTE.	SECTION	COUNTY	TOTAL SHEETS	SHEET NO.
305	27R-2	MCHENRY	673	524
			CONTRACT NO. 62268	
ILLINOIS FED. AID PROJECT				