

DATE	
BY	
SURVEYED	
PLOTTED	
TEMPLATE	
NOTE BOOK	
AREAS CHECKED	
NO.	

DATE	
BY	
SURVEYED	
PLOTTED	
TEMPLATE	
NOTE BOOK	
AREAS CHECKED	
NO.	

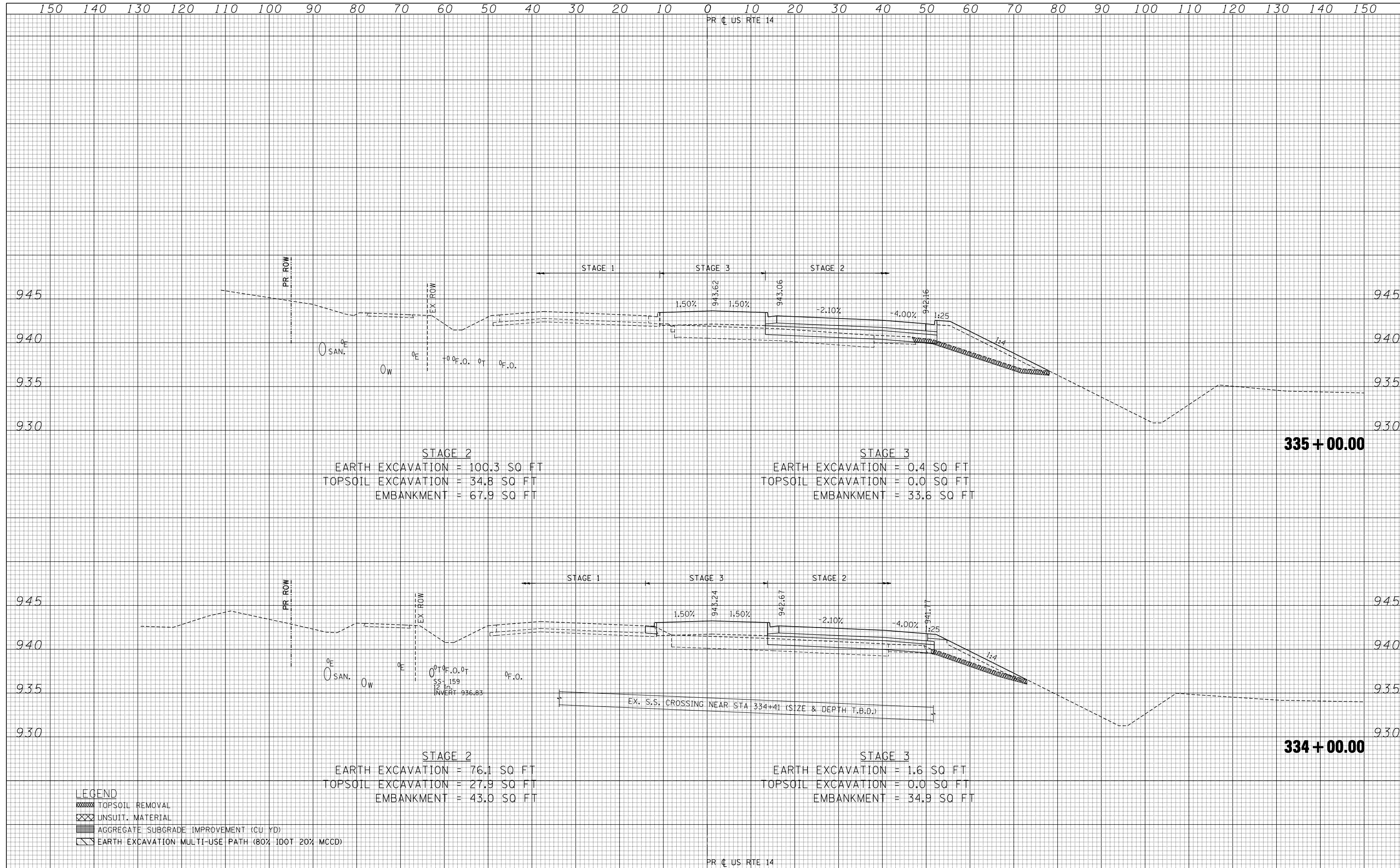

STAGE 2  
 EARTH EXCAVATION = 100.3 SQ FT  
 TOPSOIL EXCAVATION = 34.8 SQ FT  
 EMBANKMENT = 67.9 SQ FT

STAGE 3  
 EARTH EXCAVATION = 0.4 SQ FT  
 TOPSOIL EXCAVATION = 0.0 SQ FT  
 EMBANKMENT = 33.6 SQ FT

STAGE 2  
 EARTH EXCAVATION = 76.1 SQ FT  
 TOPSOIL EXCAVATION = 27.9 SQ FT  
 EMBANKMENT = 43.0 SQ FT

STAGE 3  
 EARTH EXCAVATION = 1.6 SQ FT  
 TOPSOIL EXCAVATION = 0.0 SQ FT  
 EMBANKMENT = 34.9 SQ FT

- LEGEND**
- TOPSOIL REMOVAL
  - UNSUIT. MATERIAL
  - AGGREGATE SUBGRADE IMPROVEMENT (CU YD)
  - EARTH EXCAVATION MULTI-USE PATH (80% IDOT 20% MCCD)

FILE NAME =  
 #FILEL#  
 exp U.S. Services Inc.  
 Chicago, IL  
 BUILDINGS-EARTH & ENVIRONMENT-ENERGY  
 INDUSTRIAL-INFRASTRUCTURE-SUSTAINABILITY

USER NAME = #USER#	DESIGNED -	REVISED -
	DRAWN - AG	REVISED -
PLOT SCALE = #SCALE#	CHECKED - BRH	REVISED -
PLOT DATE = #DATE#	DATE - 11/01/13	REVISED -

**STATE OF ILLINOIS  
 DEPARTMENT OF TRANSPORTATION**

**U.S. ROUTE 14 CROSS SECTIONS**  
 SCALE: HORIZ. 1" = 10' VERT. 1" = 5'  
 STA. 334+00.00 TO STA. 335+00.00

F.A.P. RTE.	SECTION	COUNTY	TOTAL SHEETS	SHEET NO.
305	27R-2	MCHENRY	673	579
			CONTRACT NO. 62268	
ILLINOIS FED. AID PROJECT				