

150 140 130 120 110 100 90 80 70 60 50 40 30 20 10 0 10 20 30 40 50 60 70 80 90 100 110 120 130 140 150

PR C US RTE 14

DATE	
BY	
FINAL SURVEY	SURVEYED
NOTE BOOK	PLOTTED
NO.	TEMPLATE
	AREAS CHECKED

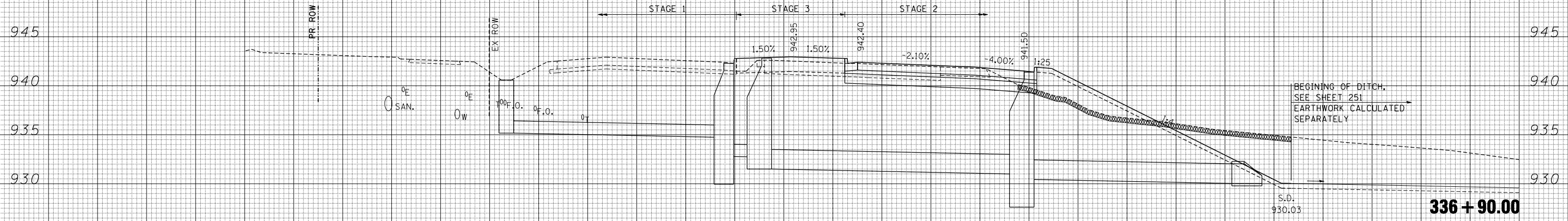

DATE	
BY	
ORIGINAL SURVEY	SURVEYED
NOTE BOOK	PLOTTED
NO.	TEMPLATE
	AREAS CHECKED

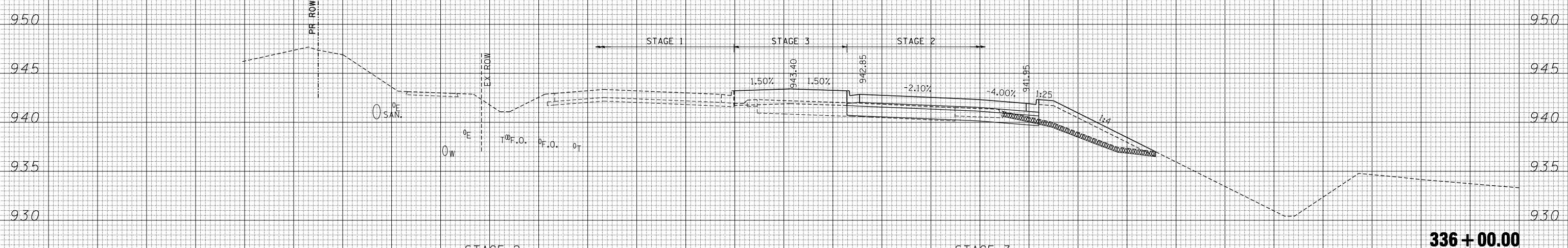

STAGE 2
 EARTH EXCAVATION = 116.4 SQ FT
 TOPSOIL EXCAVATION = 36.3 SQ FT
 EMBANKMENT = 38.8 SQ FT

STAGE 3
 EARTH EXCAVATION = 0.6 SQ FT
 TOPSOIL EXCAVATION = 0.0 SQ FT
 EMBANKMENT = 19.4 SQ FT

- LEGEND**
- TOPSOIL REMOVAL
 - UNSUIT. MATERIAL
 - AGGREGATE SUBGRADE IMPROVEMENT (CU YD)
 - EARTH EXCAVATION MULTI-USE PATH (80% IDOT 20% MCCD)

150 140 130 120 110 100 90 80 70 60 50 40 30 20 10 0 10 20 30 40 50 60 70 80 90 100 110 120 130 140 150

PR C US RTE 14

FILE NAME =
 #FILEL#
 exp U.S. Services Inc.
 Chicago, IL
 BUILDINGS-EARTH & ENVIRONMENT-ENERGY
 INDUSTRIAL-INFRASTRUCTURE-SUSTAINABILITY

USER NAME = #USER#
 DESIGNED -
 DRAWN - AG
 CHECKED - BRH
 DATE - 11/01/13

REVISED -
 REVISED -
 REVISED -
 REVISED -

DESIGNED -
 DRAWN - AG
 CHECKED - BRH
 DATE - 11/01/13

**STATE OF ILLINOIS
 DEPARTMENT OF TRANSPORTATION**

U.S. ROUTE 14 CROSS SECTIONS

SCALE: HORIZ. 1" = 10' VERT. 1" = 5' STA. 336+00.00 TO STA. 336+90.00

F.A.P. RTE.	SECTION	COUNTY	TOTAL SHEETS	SHEET NO.
305	27R-2	MCHENRY	673	580
			CONTRACT NO. 62268	

ILLINOIS FED. AID PROJECT