

| | |
|--------------|--|
| DATE | |
| BY | |
| FINAL SURVEY | |
| SURVEYED | |
| PLOTTED | |
| TEMPLATE | |
| AREAS | |
| AREAS | |
| CHECKED | |
| NO. | |

| | |
|-----------------|--|
| DATE | |
| BY | |
| ORIGINAL SURVEY | |
| SURVEYED | |
| PLOTTED | |
| TEMPLATE | |
| AREAS | |
| AREAS | |
| CHECKED | |
| NO. | |

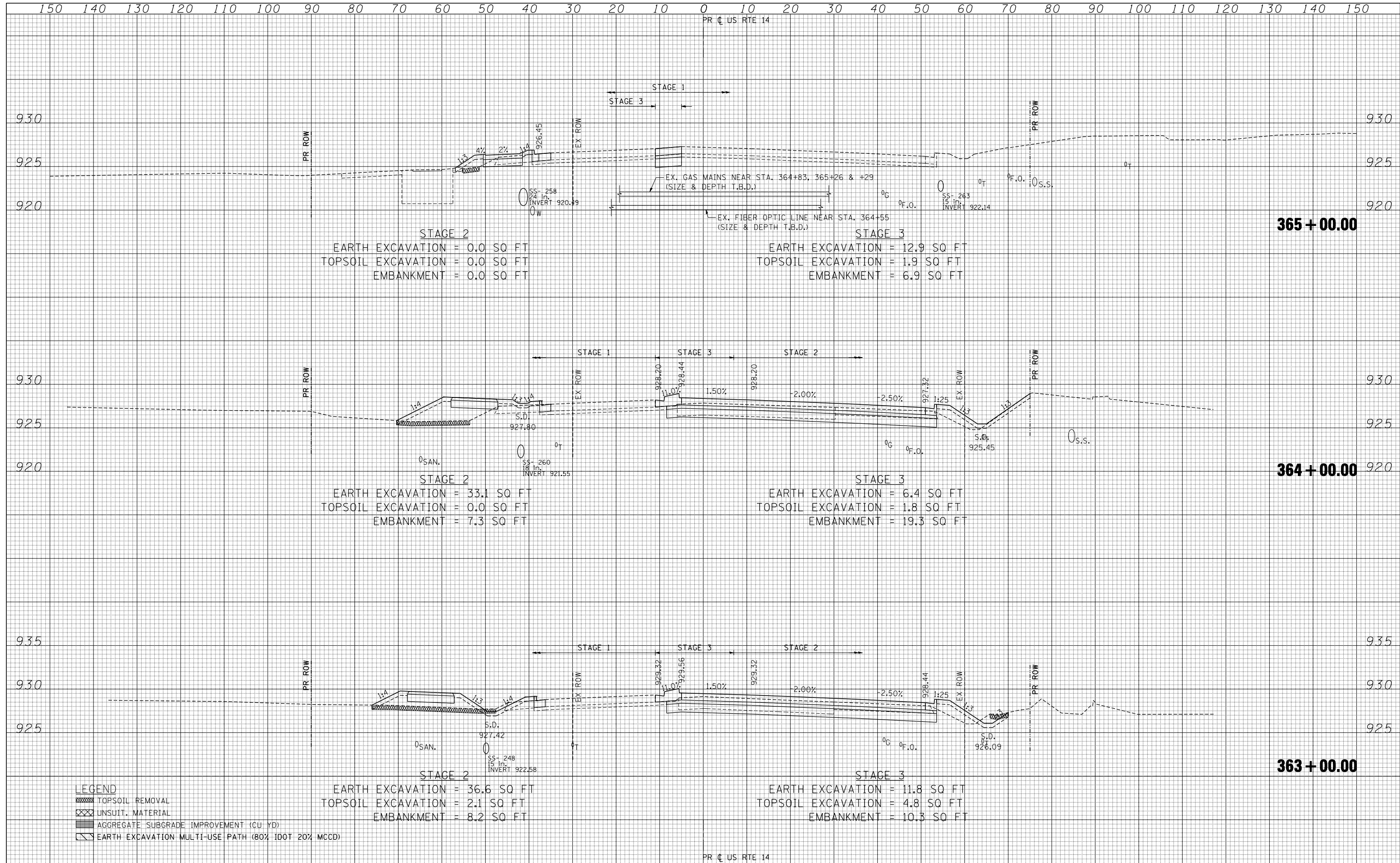

STAGE 2
 EARTH EXCAVATION = 0.0 SQ FT
 TOPSOIL EXCAVATION = 0.0 SQ FT
 EMBANKMENT = 0.0 SQ FT

STAGE 3
 EARTH EXCAVATION = 12.9 SQ FT
 TOPSOIL EXCAVATION = 1.9 SQ FT
 EMBANKMENT = 6.9 SQ FT

STAGE 2
 EARTH EXCAVATION = 33.1 SQ FT
 TOPSOIL EXCAVATION = 0.0 SQ FT
 EMBANKMENT = 7.3 SQ FT

STAGE 3
 EARTH EXCAVATION = 6.4 SQ FT
 TOPSOIL EXCAVATION = 1.8 SQ FT
 EMBANKMENT = 19.3 SQ FT

STAGE 2
 EARTH EXCAVATION = 36.6 SQ FT
 TOPSOIL EXCAVATION = 2.1 SQ FT
 EMBANKMENT = 8.2 SQ FT

STAGE 3
 EARTH EXCAVATION = 11.8 SQ FT
 TOPSOIL EXCAVATION = 4.8 SQ FT
 EMBANKMENT = 10.3 SQ FT

- LEGEND**
- TOPSOIL REMOVAL
 - UNSUIT. MATERIAL
 - AGGREGATE SUBGRADE IMPROVEMENT (CU YD)
 - EARTH EXCAVATION MULTI-USE PATH (80% IDOT 20% MCCD)

| | | | | | | | | | | | |
|------------------------|----------------------|-----------------|-----------|---|-------------------------------------|--------------------------------------|----------------------------------|--------------------|------------------|---------------------------|--|
| FILE NAME * | USER NAME * \$USER\$ | DESIGNED - | REVISED - | STATE OF ILLINOIS DEPARTMENT OF TRANSPORTATION | U.S. ROUTE 14 CROSS SECTIONS | F.A.P. RTE. 305 | SECTION 27R-2 | COUNTY MCHENRY | TOTAL SHEETS 673 | SHEET NO. 592 | |
| *FILEL\$ | | DRAWN - AG | REVISED - | | | SCALE: HORIZ. 1" = 10' VERT. 1" = 5' | STA. 363+00.00 TO STA. 365+00.00 | CONTRACT NO. 62268 | | ILLINOIS FED. AID PROJECT | |
| PLOT SCALE * \$SCALE\$ | | CHECKED - BRH | REVISED - | | | | | | | | |
| PLOT DATE * \$DATE\$ | | DATE - 11/01/13 | REVISED - | | | | | | | | |