

DATE	
BY	
SURVEYED	
PLOTTED	
TEMPLATE	
AREAS	
CHECKED	
FINAL SURVEY	
NOTE BOOK	
NO.	

DATE	
BY	
SURVEYED	
PLOTTED	
TEMPLATE	
AREAS	
CHECKED	
ORIGINAL SURVEY	
NOTE BOOK	
NO.	

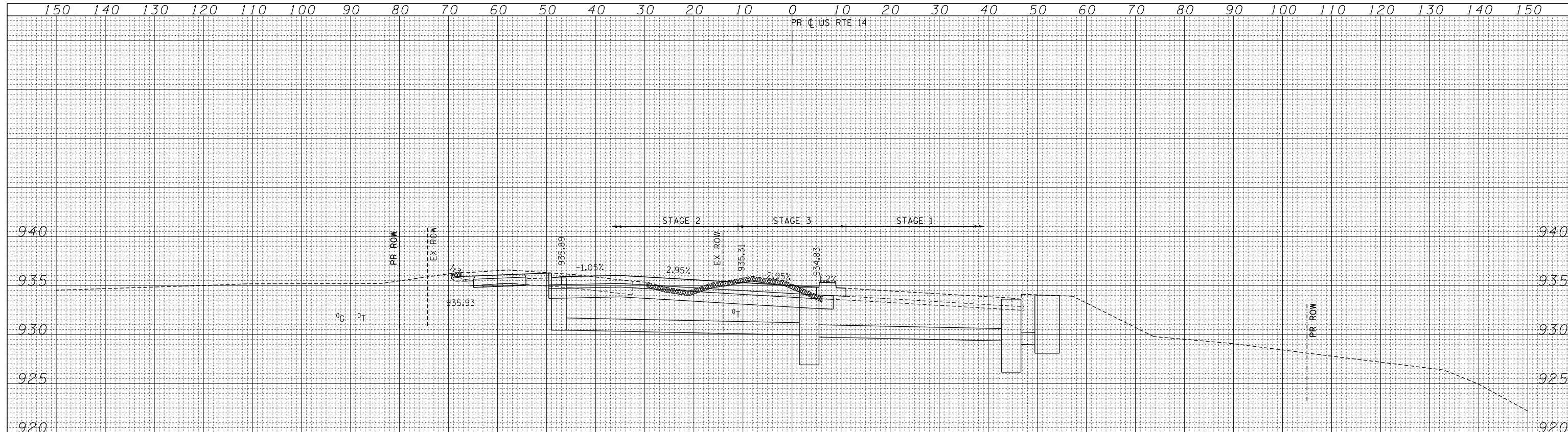

STAGE 2
 EARTH EXCAVATION = 39.8 SQ FT
 TOPSOIL EXCAVATION = 10.3 SQ FT
 EMBANKMENT = 3.7 SQ FT

STAGE 3
 EARTH EXCAVATION = 35.0 SQ FT
 TOPSOIL EXCAVATION = 8.6 SQ FT
 EMBANKMENT = 0.0 SQ FT

433 + 00.00

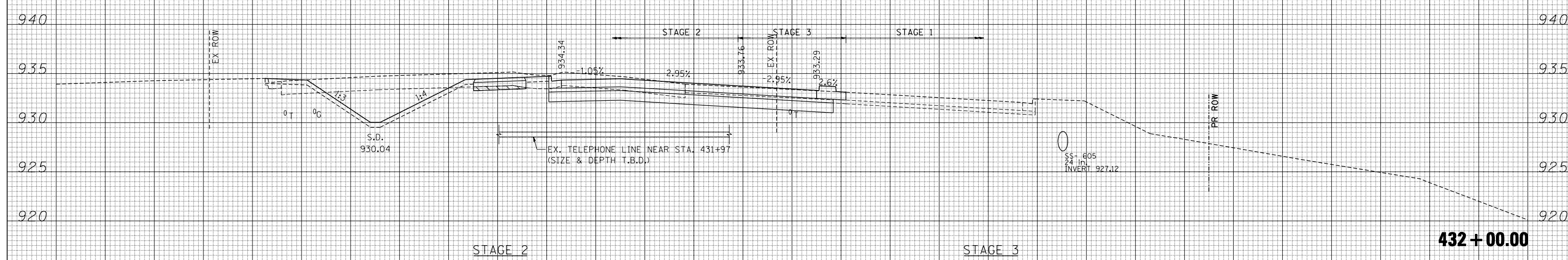

STAGE 2
 EARTH EXCAVATION = 106.7 SQ FT
 TOPSOIL EXCAVATION = 0.0 SQ FT
 EMBANKMENT = 11.3 SQ FT

STAGE 3
 EARTH EXCAVATION = 24.7 SQ FT
 TOPSOIL EXCAVATION = 0.0 SQ FT
 EMBANKMENT = 0.0 SQ FT

432 + 00.00

- LEGEND**
- TOPSOIL REMOVAL
 - UNSUIT. MATERIAL
 - AGGREGATE SUBGRADE IMPROVEMENT (CU YD)
 - EARTH EXCAVATION MULTI-USE PATH (80% IDOT 20% MCCD)

PR (C) US RTE 14

FILE NAME =
 #FILEL#
 exp U.S. Services Inc.
 CHICAGO, IL
 BUILDINGS-EARTH & ENVIRONMENT-ENERGY
 INDUSTRIAL-INFRASTRUCTURE-SUSTAINABILITY

USER NAME = #USER#
 PLOT SCALE = #SCALE#
 PLOT DATE = #DATE#

DESIGNED -
 DRAWN - AG
 CHECKED - BRH
 DATE - 11/01/13

REVISED -
 REVISED -
 REVISED -
 REVISED -

**STATE OF ILLINOIS
 DEPARTMENT OF TRANSPORTATION**

U.S. ROUTE 14 CROSS SECTIONS
 SCALE: HORIZ. 1" = 10' VERT. 1" = 5'
 STA. 432+00.00 TO STA. 433+00.00

F.A.P. RTE.	SECTION	COUNTY	TOTAL SHEETS	SHEET NO.
305	27R-2	MCHENRY	673	629
			CONTRACT NO. 62268	
ILLINOIS FED. AID PROJECT				