

150 140 130 120 110 100 90 80 70 60 50 40 30 20 10 0 10 20 30 40 50 60 70 80 90 100 110 120 130 140 150

PR C US RTE 14

DATE	
BY	
SURVEYED	
PLOTTED	
TEMPLATE	
NOTE BOOK	
AREAS CHECKED	
NO.	

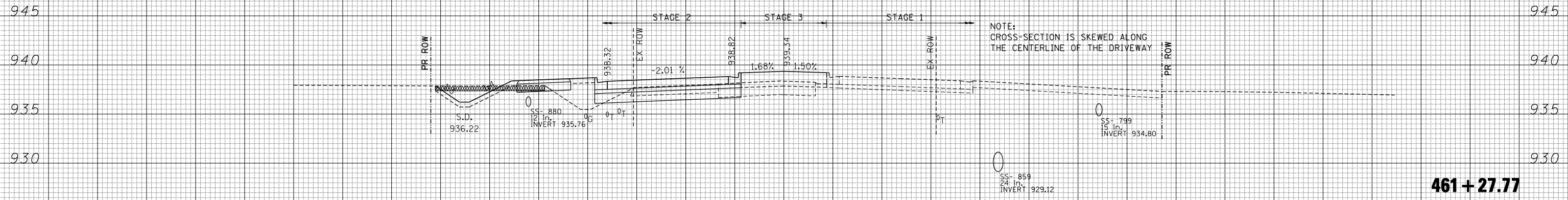

DATE	
BY	
SURVEYED	
PLOTTED	
TEMPLATE	
NOTE BOOK	
AREAS CHECKED	
NO.	

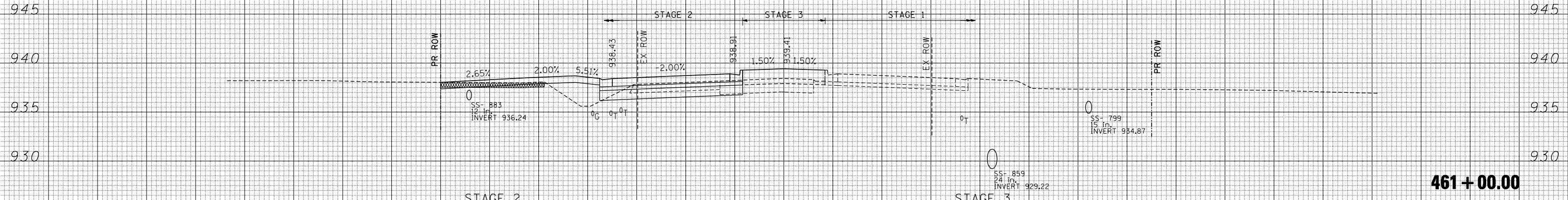

LEGEND
 [Pattern] TOPSOIL REMOVAL
 [Pattern] UNSUIT. MATERIAL
 [Pattern] AGGREGATE SUBGRADE IMPROVEMENT (CU YD)
 [Pattern] EARTH EXCAVATION MULTI-USE PATH (80% IDOT 20% MCCD)

STAGE 2
 EARTH EXCAVATION = 16.6 SQ FT
 TOPSOIL EXCAVATION = 10.6 SQ FT
 EMBANKMENT = 20.2 SQ FT

STAGE 3
 EARTH EXCAVATION = 0.8 SQ FT
 TOPSOIL EXCAVATION = 0.0 SQ FT
 EMBANKMENT = 12.6 SQ FT

PR C US RTE 14

150 140 130 120 110 100 90 80 70 60 50 40 30 20 10 0 10 20 30 40 50 60 70 80 90 100 110 120 130 140 150

FILE NAME =
 #FILEL#
 exp U.S. Services Inc.
 Chicago, IL
 BUILDINGS-EARTH & ENVIRONMENT-ENERGY
 INDUSTRIAL-INFRASTRUCTURE-SUSTAINABILITY

USER NAME = #USER#
 PLOT SCALE = #SCALE#
 PLOT DATE = #DATE#

DESIGNED -
 DRAWN - AG
 CHECKED - BRH
 DATE - 11/01/13

REVISED -
 REVISED -
 REVISED -
 REVISED -

**STATE OF ILLINOIS
 DEPARTMENT OF TRANSPORTATION**

U.S. ROUTE 14 CROSS SECTIONS

SCALE: HORIZ. 1" = 10' VERT. 1" = 5' STA. 461+00.00 TO STA. 461+27.77

F.A.P. RTE.	SECTION	COUNTY	TOTAL SHEETS	SHEET NO.
305	27R-2	MCHENRY	673	643
			CONTRACT NO. 62268	
ILLINOIS FED. AID PROJECT				