

- 1 COVER SHEET
- 2 GENERAL NOTES AND LOCATION MAP
- 3-5 SUMMARY OF QUANTITIES
- 6 TYPICAL SECTIONS
- 7-8 SCHEDULES
- 9-11 DETAILS

STANDARDS

- 000001-06 STANDARD SYMBOLS, ABBREVIATIONS AND PATTERNS
- 001006 DECIMAL OF AN INCH AND OF A FOOT
- 406201-01 MAILBOX TURNOUT
- 630301-06 SHOULDER WIDENING FOR TYPE 1 (SPECIAL) GUARDRAIL TERMINALS
- 667101-02 PERMANENT SURVEY MARKERS
- 701001-02 OFF-ROAD OPERATIONS 2L, 2W, MORE THAN 15' (4.5 m) AWAY
- 701006-05 OFF-ROAD OPERATIONS 2L, 2W, 15' (4.5 m) TO 24" (600 mm) FROM PAVEMENT EDGE
- 701301-04 LANE CLOSURE, 2L, 2W, SHORT TIME OPERATIONS
- 701306-03 LANE CLOSURE, 2L, 2W, SLOW MOVING OPERATIONS DAY ONLY, FOR SPEEDS ≥ 45 MPH
- 701326-04 LANE CLOSURE, 2L, 2W, PAVEMENT WIDENING, FOR SPEEDS ≥ 45 MPH
- 701901-03 TRAFFIC CONTROL DEVICES
- 780001-04 TYPICAL PAVEMENT MARKINGS
- 781001-03 TYPICAL APPLICATIONS RAISED REFLECTIVE PAVEMENT MARKERS

STATE OF ILLINOIS
 DEPARTMENT OF TRANSPORTATION
 DIVISION OF HIGHWAYS
**PROPOSED
 HIGHWAY PLANS**

FAP ROUTE 697 (IL 9)
 SECTION 17RS-4

TYPE of IMPROVEMENT-3P RESURFACING
 FORD COUNTY

C-93-143-04

F.A. RTE.	SECTION	COUNTY	TOTAL SHEETS	SHEET NO.
697	17RS-4	FORD	11	1
ILLINOIS CONTRACT NO. 66500				

D-93-084-04

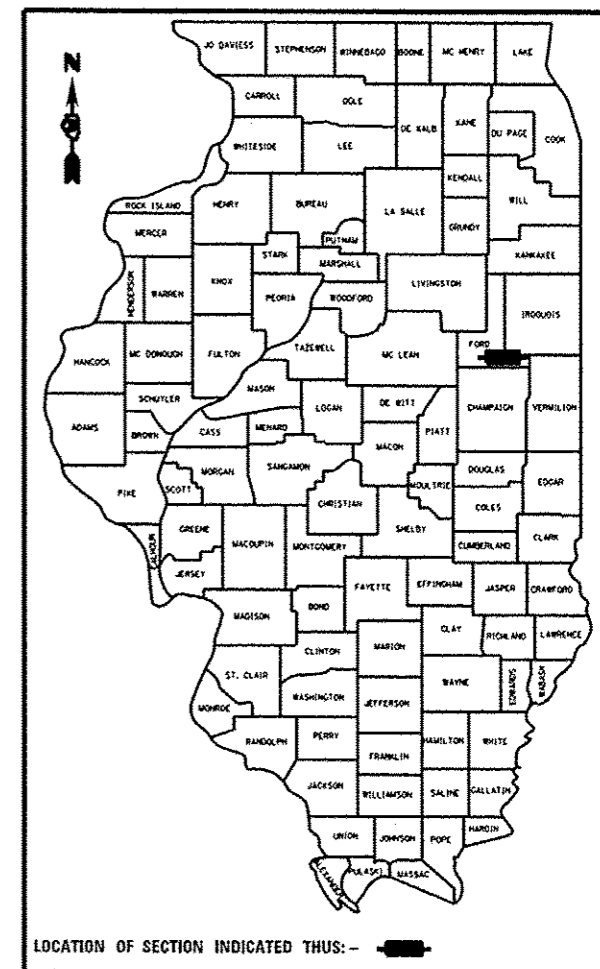

FUNCTION CLASSIFICATION
 MINOR ARTERIAL (RURAL)

2013 ADT = 2,100
 P.V. = 90% S.U. = 4.76% M.U. = 5.24%

BEGIN IMPROVEMENT
 STA 959 + 26

END IMPROVEMENT
 STA 1115 + 84

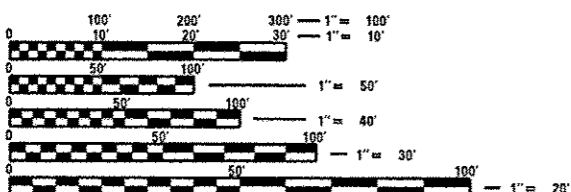
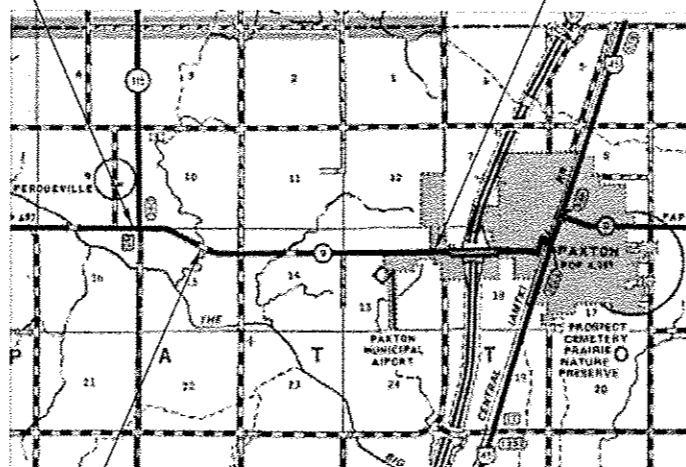

FULL SIZE PLANS HAVE BEEN PREPARED USING STANDARD ENGINEERING SCALES. REDUCED SIZED PLANS WILL NOT CONFORM TO STANDARD SCALES. IN MAKING MEASUREMENTS ON REDUCED PLANS, THE ABOVE SCALES MAY BE USED.

J.U.L.I.E.
 JOINT UTILITY LOCATION INFORMATION FOR EXCAVATION
 1-800-892-0123
 OR 811

OMIT SN 027-0094
 992 + 89 TO 994 + 71

LOCATION MAP
 NOT TO SCALE

GROSS LENGTH = 15658 FT = 2.97 MI
 NET LENGTH = 15475 FT = 2.93 MI

PROJECT ENGINEER CRAIG REED, P.E.
 UNIT CHIEF PAT BRABOY, P.E.

CONTRACT NO. 66500

STATE OF ILLINOIS
 DEPARTMENT OF TRANSPORTATION
 DIVISION OF HIGHWAYS
 SUBMITTED June 5, 2014
 Paul Coete, D.B.
 DEPUTY DIRECTOR OF HIGHWAYS, REGION ENGINEER
 June 27, 2014
 John D. Baranzelli, P.E.
 acting ENGINEER OF DESIGN AND ENVIRONMENT
 June 27, 2014
 Omar Osman, P.E., Jr.
 DIRECTOR OF HIGHWAYS, CHIEF ENGINEER

PRINTED BY THE AUTHORITY
 OF THE STATE OF ILLINOIS

GENERAL NOTES

THE THICKNESS OF HMA SHOWN ON THE PLANS IS THE NOMINAL THICKNESS. DEVIATIONS FROM THE NOMINAL THICKNESS WILL BE PERMITTED WHEN SUCH DEVIATIONS OCCUR DUE TO IRREGULARITIES IN THE EXISTING SURFACE OR BASE ON WHICH THE HMA IS PLACED.

THE HMA SURFACE OF ALL MAILBOX TURNOUTS, PRIVATE ENTRANCES, COMMERCIAL ENTRANCES, AND SIDE ROADS SHALL BE MADE NEATLY, IN A WORKMANLIKE MANNER, AND SHALL ACCURATELY CONFORM TO THE SHAPES AND DIMENSIONS SHOWN ON THE PLAN DETAILS. IF REQUIRED BY THE ENGINEER, THE CONTRACTOR SHALL SAW CUT THE HMA SURFACE TO CONFORM TO THE SHAPES AND DIMENSIONS SHOWN ON THE PLAN DETAILS. THIS WORK WILL BE INCLUDED IN THE COST OF THE HMA SURFACE.

THE BASE COURSE WIDENING SHALL BE CARRIED THROUGH ALL ENTRANCES, SIDE ROADS, AND MAILBOX TURNOUTS. EXCEPTIONS WILL BE SHOWN ON THE PLANS.

THE ENGINEER WILL BE THE SOLE JUDGE CONCERNING CURING TIME FOR THE VARIOUS HMA LIFTS.

SEEDING WILL NOT BE PERMITTED AT ANY TIME WHEN THE GROUND IS FROZEN, WET, OR IN AN UNTILLABLE CONDITION. LOCATIONS TO BE SEEDED WILL BE DETERMINED BY THE ENGINEER.

THE FINISHED EARTHWORK SHALL HAVE A VEGETATION SUSTAINING SOIL COVERING THE TOP FOUR INCHES (100 MILLIMETERS) IN AREAS TO BE SEEDED OR SODDED. THE VEGETATION SUSTAINING SOIL REQUIRED WILL NOT BE PAID FOR SEPARATELY BUT WILL BE INCLUDED IN THE COST OF FURNISHED EXCAVATION.

ON EXISTING PAVEMENT WHICH MAY BE SUPERELEVATED, THE NEW HMA PAVEMENT SHALL BE BUILT WITH THE SAME SUPERELEVATION UNLESS NEW SUPERELEVATION RATES ARE GIVEN ON THE PLANS.

ANY REFERENCE TO A STANDARD IN THESE PLANS SHALL BE INTERPRETED TO MEAN THE EDITION AS INDICATED BY THE SUBNUMBER SHOWN IN THE LIST OF STANDARDS OR THE COPY INCLUDED IN THESE PLANS.

THE FOLLOWING RATES OF APPLICATION HAVE BEEN USED IN CALCULATING PLAN QUANTITIES:

GRANULAR MATERIALS	2.05	TONS / CU YD
HMA RESURFACING	112	LBS / SQ YD / IN
SHORT TERM PAVEMENT MARKING	10	FT / 100 FT OF APPLICATION
MIX FOR CRACKS, JTS & FLGWYS	0.0003	TONS / SQ YD
LEVEL BINDER (HAND METHOD)	0.0005	TONS / SQ YD
SUPPLEMENTAL WATERING	3	GAL / SQ YD / APPLICATION
CALCIUM CHLORIDE	2	LB / SQ YD / APPLICATION
AGGREGATE DITCH CHECKS	5	TONS AGGREGATE

THE EXISTING SHOULDERS ARE LOW. IN THE EVENT THAT CONSTRUCTION OPERATIONS RESULT IN A DROP OFF GREATER THAN 3" BETWEEN THE EDGE OF PAVEMENT OR EDGE OF SHOULDER WITHIN 3' OF THE EDGE OF PAVEMENT AND THE EARTH OR AGGREGATE SHOULDERS, THEN THE DROP OFF SHALL BE PROTECTED ACCORDING TO ARTICLE 701.04(B)(1) OF THE STANDARD SPECIFICATIONS. THIS WORK WILL BE CONSIDERED AS INCLUDED IN THE CONTRACT UNIT PRICES FOR TRAFFIC CONTROL.

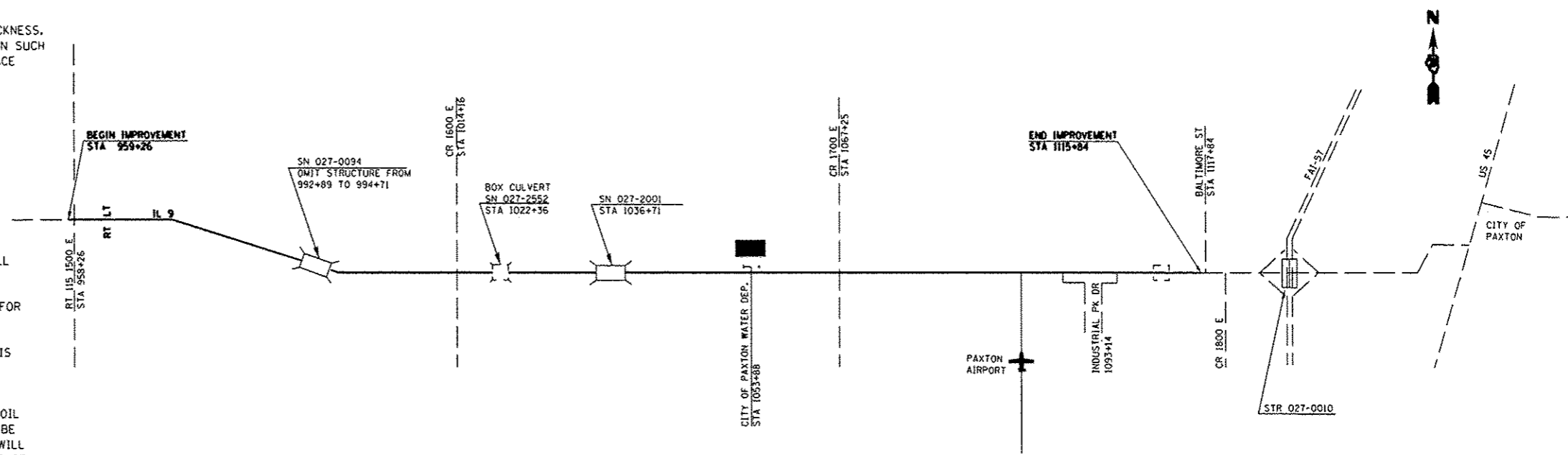

**STATE OF ILLINOIS
DEPARTMENT OF TRANSPORTATION
DISTRICT THREE**

PREPARED BY: *Dan Beonil*
DISTRICT STUDIES & PLANS ENGINEER

DATE: 6-5-14

EXAMINED BY: *Walter J. Phillips*
DISTRICT CONSTRUCTION ENGINEER

Wayne L. Phillips
DISTRICT MATERIALS ENGINEER

James A. Wheeler
DISTRICT OPERATIONS ENGINEER

FILE NAME *	USER NAME * #USER*	DESIGNED -	REVISED -	STATE OF ILLINOIS DEPARTMENT OF TRANSPORTATION	GENERAL NOTES AND LOCATION MAP	F.A.P. RITE, 697	SECTION 11RS-4	COUNTY FORD	TOTAL SHEETS 11	SHEET NO. 2	
#FILE#		DRAWN -	REVISED -			SCALE: _____	SHEET NO. ___ OF ___ SHEETS	STA. _____ TO STA. _____	CONTRACT NO. 66500		
		CHECKED -	REVISED -			ILLINOIS FED. AID PROJECT					
		DATE -	REVISED -								

100% STATE

CODE NO.	ITEM	UNIT	TOTAL QUANTITY	CONSTR. CODE	
				ROADWAY	RURAL
20200600	EXCAVATING AND GRADING EXISTING SHOULDER	UNIT	318	318	
20400800	FURNISHED EXCAVATION	CU YD	245	245	
40600400	MIXTURE FOR CRACKS, JOINTS, AND FLANGEWAYS	TON	15	15	
40600527	LEVELING BINDER (HAND METHOD), IL-9.5FG, N50	TON	25	25	
40600627	LEVELING BINDER (MACHINE METHOD), IL-9.5FG, N50	TON	2110	2110	
40600895	CONSTRUCTING TEST STRIP	EACH	1	1	
40600990	TEMPORARY RAMP	SQ YD	115	115	
40603310	HOT-MIX ASPHALT SURFACE COURSE, MIX "C", N50	TON	4329	4329	
40800050	INCIDENTAL HOT-MIX ASPHALT SURFACING	TON	240	240	
44000158	HOT-MIX ASPHALT SURFACE REMOVAL, 2 1/4"	SQ YD	44345	44345	
48101200	AGGREGATE SHOULDERS, TYPE B	TON	368	368	
48203017	HOT-MIX ASPHALT SHOULDERS, 5"	SQ YD	7072	7072	
*63100167	TRAFFIC BARRIER TERMINAL, TYPE 1 (SPECIAL) TANGENT	EACH	12	12	
63200310	GUARDRAIL REMOVAL	FOOT	600	600	

100% STATE
CONSTR. CODE
ROADWAY
0005
RURAL

*Specialty Items

FILE NAME *	USER NAME * #USER#	DESIGNED -	REVISED -	STATE OF ILLINOIS DEPARTMENT OF TRANSPORTATION	SUMMARY OF QUANTITIES		P.A.E. RTE. 697	SECTION 17RS-4	COUNTY FORD	TOTAL SHEETS 11	SHEET NO. 5
#PLOT#	PLOT SCALE * #SCALE#	DRAWN -	REVISED -				SCALE: _____	SHEET NO. _____ OF _____ SHEETS	STA. _____ TO STA. _____	CONTRACT NO. 66500	
	PLOT DATE * #DATE#	CHECKED -	REVISED -		ILLINOIS FED. AID PROJECT						
		DATE -	REVISED -								

CODE NO.	ITEM	UNIT	TOTAL QUANTITY	CONSTR. CODE	
				ROADWAY	RURAL
				100% STATE	
66700205	PERMANENT SURVEY MARKERS, TYPE I	EACH	1	1	
67100100	MOBILIZATION	L SUM	1	1	
70100460	TRAFFIC CONTROL AND PROTECTION, STANDARD 701306	L SUM	1	1	
70100500	TRAFFIC CONTROL AND PROTECTION, STANDARD 701326	L SUM	1	1	
70103815	TRAFFIC CONTROL SURVEILLANCE	CAL DA	7	7	
70300100	SHORT TERM PAVEMENT MARKING	FOOT	4696	4696	
70300220	TEMPORARY PAVEMENT MARKING - LINE 4"	FOOT	42145	42145	
70300240	TEMPORARY PAVEMENT MARKING - LINE 6"	FOOT	3019	3019	
70301000	WORK ZONE PAVEMENT MARKING REMOVAL	SQ FT	521	521	
* 78001110	PAINT PAVEMENT MARKING - LINE 4"	FOOT	84290	84290	
* 78001130	PAINT PAVEMENT MARKING - LINE 6"	FOOT	6038	6038	
* 78100100	RAISED REFLECTIVE PAVEMENT MARKER	EACH	197	197	
* 78201000	TERMINAL MARKER - DIRECT APPLIED	EACH	12	12	
78300200	RAISED REFLECTIVE PAVEMENT MARKER REMOVAL	EACH	197	197	

FILE NAME *	USER NAME * #USER#	DESIGNED -	REVISED -	STATE OF ILLINOIS DEPARTMENT OF TRANSPORTATION	SUMMARY OF QUANTITIES		F.A.R. RTE.	SECTION	COUNTY	TOTAL SHEETS	SHEET NO.
#FILE#		DRAWN -	REVISED -				697	1785-4	FORD	11	4
PLOT SCALE * #SCALE#		CHECKED -	REVISED -		SCALE: _____ SHEET NO. ___ OF ___ SHEETS STA. _____ TO STA. _____		CONTRACT NO. 66500		ILLINOIS FED. AID PROJECT		
PLOT DATE * #DATE#		DATE -	REVISED -								

*Specialty Items

0015 20 101

CODE NO.	ITEM	UNIT	TOTAL QUANTITY	CONSTR. CODE
				ROADWAY 0005 RURAL
X4060110	BITUMINOUS MATERIALS (PRIME COAT)	POUND	35890	100% STATE
Z0030850	TEMPORARY INFORMATION SIGNING	SQ FT	42	
Z0034105	MATERIAL TRANSFER DEVICE	TON	6439	

FILE NAME * #FILE#	USER NAME * #USER#	DESIGNED -	REVISED -	STATE OF ILLINOIS DEPARTMENT OF TRANSPORTATION	SUMMARY OF QUANTITIES	F.A.P. RTE. 697	SECTION 17RS-4	COUNTY FORD	TOTAL SHEETS 11	SHEET NO. 5	
	PLOT SCALE * #SCALE#	DRAWN -	REVISED -			SCALE: _____	SHEET NO. _____ OF _____ SHEETS	STA. _____ TO STA. _____	CONTRACT NO. 65500		ILLINOIS FED. AID PROJECT
	PLOT DATE * #DATE#	CHECKED -	REVISED -								

	HMA LEVEL BINDER	HMA SURFACE	HMA SHOULDERS 5"
PG GRADE**	PG 64-22	PG 64-22	PG 64-22
DESIGN AIR VOIDS	4.0% @ N50	4.0% @ N50	4.0% @ N50
MIXTURE COMPOSITION	IL 9.5FG	IL 9.5	IL 19.0FG
FRICTION AGGREGATE		MIXTURE C	
DENSITY TEST METHODS	COORELATION	COORELATION	CORES

**When RAP/RAS ABR exceeds 20 percent, the high and low virgin asphalt binder grades shall each be reduced by one grade (i.e. 25% ABR would require a virgin asphalt binder grade of PG 64-22 to be reduced to PG 58-28).

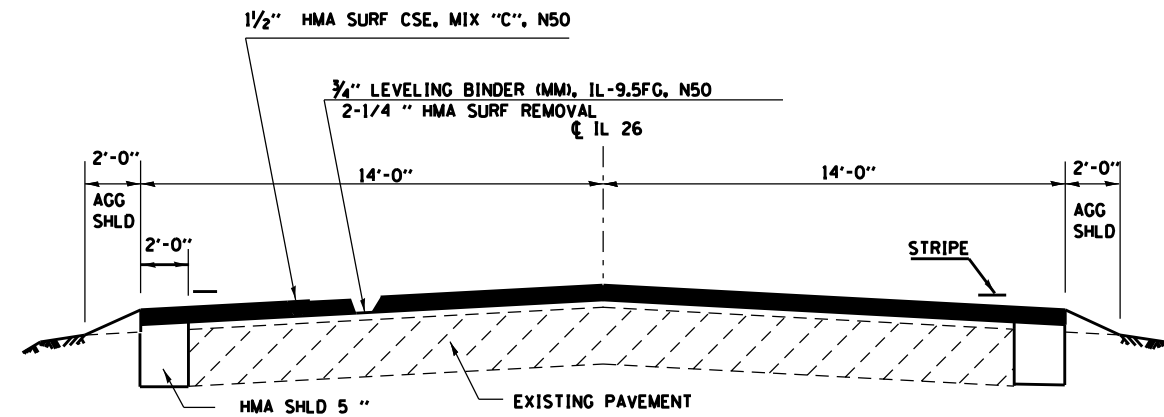

PROPOSED TYPICAL SECTION

- SEQUENCE OF OPERATIONS:
1. REMOVE 2-1/4" HMA SURFACE
 2. PLACE HMA SHLD 5"
 3. PLACE 3/4" LEVEL BINDER
 4. PLACE 1/2" SURFACE CSE.

PAVEMENT MARKING SCHEDULE												
LOCATION	PAINT PAVEMENT MARKING*					RAISED REFLECT		TEMPORARY			SHORT TERM	
	LENGTH	NO PASSING ZONE SIDE	PAINT PVMT MARK 4"		PAINT PVMT MARK 6"	RAISED REFLECT PVMT MARK	RAISED REFLECT PVMT	TEMPORARY PVMT MARK 4"		TEMPORARY PVMT MARK 6"	SHORT TERM PAVEMENT MARKING	WORK ZONE PAVEMENT MARKING
			WHITE FOOT	YELLOW** FOOT	YELLOW FOOT	MARKER EACH	REMOVAL EACH	WHITE FOOT	YELLOW FOOT	YELLOW FOOT	YELLOW FOOT	REMOVAL SQ FT
IL 9/RT 115 INT 958+26												
959+26 TO 961+37	211	CL	844		106	3	3	422		53	63	7
961+37 TO 966+71	534	RT	2136	1068	268	7	7	1068	534	134	160	18
966+71 TO 992+89	2618	RT/LT	10472	10472		33	33	5236	5236		785	87
SN 027-0069 992+89 TO 994+71	182	RT/LT	728	728		2	2	364	364		55	6
994+71 TO 1002+61	790	RT/LT	3160	3160		10	10	1580	1580		237	26
1002+61 TO 1015+28	1267	LT	5068	2534	634	16	16	2534	1267	317	380	42
1015+28 TO 1022+32	704	CL	2816		352	9	9	1408		176	211	23
SN 027-0801 1022+32 TO 1022+40	8	CL	32		4	0	0	16		2	2	0
1022+40 TO 1036+61	1421	CL	5684		710	18	18	2842		355	426	47
SN 027-2001 1036+61 TO 1036+81	20	CL	80		10	0	0	40		5	6	1
1036+81 TO 1087+85	5104	CL	20416		2552	64	64	10208		1276	1531	170
1087+85 TO 1096+83	898	RT	3592	1796	450	11	11	1796	898	225	269	30
1096+83 TO 1097+89	106	CL	424		54	1	1	212		27	32	4
1097+89 TO 1107+39	950	LT	3800	1900	476	12	12	1900	950	238	285	32
1107+39 TO 1115+84	845	CL	3380		422	11	11	1690		211	254	28
BALTIMORE ST 1117+84												
TOTAL	15658		62632	21658	6038	197	197	31316	10829	3019	4696	521

NOTE: ALL STATION ARE APPROXIMATE +/-
 *PAINT PVT MARKING QUANTITY HAS QUANTITY FOR TWO APPLICATIONS-SEE SPECIAL PROVISIONS

MAINLINE									
LOCATION STATION	LENGTH FT	AREA SQ YD	LEVELING BINDER (MM) TON	LEVEL BINDER (HM) TON	MIX FOR CRACKS, JOINTS, & FLGWYS TON	TEMP RAMP SQ YD	BIT MATERIALS (PR CT) POUND	HMA SURF CSE MIX "C" TON	AGG SHLD TY B TON
IL 9/RT 115 INT 958+26									
957+26.33 TO 992+89	3563	11084	465.5	5.5	3.3	13.3	7481.6	931.0	81.1
OMIT SN 027-0094 992+89 TO 994+71						26.7			
994+71.75 TO CR 1600 E INT 1014+16	1944	6049	254.0	3.0	1.8		4082.9	508.1	44.3
CR 1600 E INT 1014+16 TO 1022+32	816	2539	106.6	1.3	0.8		1713.6	213.2	18.6
SN 027-2552 1022+32 TO 1022+40	8	25	1.0	0.1	0.1		16.8	2.1	0.2
1022+40 TO 1036+61	1421	4421	185.7	2.2	1.3		2984.1	371.4	32.4
SN 027-2001 1036+61 TO 1036+81	20	62	2.6	0.0	0.1		42.0	5.2	0.5
1036+81 TO CR 1700 E INT 1062+89	2608	8114	340.8	4.1	2.4		5476.8	681.6	59.4
1062+89 TO IND PK DR 1093+14	3025	9411	395.3	4.7	2.8		6352.5	790.5	68.9
IND PK DR 1093+14 TO 1115+84	2270	7062	296.6	3.5	2.1	13.3	4767.0	593.2	51.7
BALTIMORE ST STA 1117+84									
TOTALS			2109.6	25.2	14.8	54.9	33904.9	4219.3	367.8

IL 9/RT 115 INT 958+26

GUARDRAIL					
STRUCTURE LOCATION	SIDE	TBT TY 1 SPL (TANGENT)	GUARDRAIL REMOVAL	TERMINAL MARKER - DA	FURNISHED EXCAVATION
		EA	FOOT	EA	CU YD
1022+36 (SN 027-2552)	LT&RT	4	200	4	80
1036+71 (SN 027-2001)	LT&RT	4	200	4	80
APPROX STA 1105+00 (NO S.N.)	LT&RT	4	200	4	80
TOTAL		12	600	12	240

- THESE AREAS TO BE SEEDED AND FERTILIZED AND MULCHED-INCLUDED IN THE COST OF FURNISHED EXCAVATION.
- FURNISHED EX. TO BE PLACED AT END SECTIONS ACCORDING TO STD. 630301

HMA SURF REM			
LOCATION	LENGTH	AREA	HMA SURF REM 2-1/4"
STATION	FT	SQ YD	SQ YD
957+26 TO 992+89	3563	9501	9501
OMIT SN 027-0094 992+89 TO 994+71	182	485	
994+71 TO 1022+32	2761	7363	7363
SN 027-2552 1022+32 TO 1022+40	8	21	21
1022+40 TO 1036+61	1421	3789	3789
SN 027-2001 1036+61 TO 1036+81	20	53	53
1036+81 TO 1094+14	5733	15288	15288
1090+14 TO 1095+14+	500	1333	1333
1095+14 TO 1115+84	2070	5520	5520
BALTIMORE ST 1117+84			
TOTALS			42869.0

IL 9/RT 115 INT 958+26

SIDEROAD AND ENTRANCE SCHEDULE											
SIDEROAD OR DESCRIPTION	STA	SIDE	EXIST MAT	WIDTH	AREA	HMA SURF	INC	BIT	TEMP	HMA SURF	FURN
						CSE, MIX C N50	HMA SURF	MAT'L (PR CT)	RAMP	REM 2-1/4"	EX
				FOOT	SQ YD	SQ YD	TON	POUND	SQ YD	SQ YD	CU YD
IL 115	958+26	LT	HMA	50	210	25	26.5	141.8	10.0	210.0	1
IL 115	958+26	RT	HMA	50	210	25	26.5	141.8	10.0	210.0	1
PE *	977+74	RT	AGG	20	33		4.2	22.3			
PE *	985+11	RT	AGG	15	28		3.5	18.9			
PE *	986+08	LT	AGG	25	39		4.9	26.3			
CE *	986+26	RT	HMA	17	30		3.8	20.3		30.0	
MB	986+26	RT	HMA		10		1.3	6.9		10.2	
PE *	995+66	RT	AGG	12	24		3.0	16.2			
PE *	996+12	LT	AGG	15	28		3.5	18.9			
FE	1005+96	RT	AGG	12	24		3.0	16.2			
PE	1009+24	RT	AGG	20	33		4.2	22.3			
MB	1009+24	RT	AGG		10		1.3	6.9			
PE	1011+70	RT	AGG	20	33		4.2	22.3			
CR 1600 E	1014+16	RT	T&C	20	110	20	13.9	74.3	10.0	110.0	1
CR 1600 E	1014+16	LT	T&C	20	110	20	13.9	74.3	10.0	110.0	1
CE	1017+84	LT	AGG	15	28		3.5	18.9			
FE	1019+42	LT	HMA	17	30		3.8	20.3		30.0	
CE	1019+92	RT	AGG	15	28		3.5	18.9			
PE	1024+87	RT	HMA	20	33		4.2	22.3		33.0	
MB	1024+87	LT	AGG		10		1.3	6.9			
PE	1025+37	LT	HMA	20	33		4.2	22.3		33.0	
PE	1025+77	LT	HMA	20	33		4.2	22.3		33.0	
PE	1046+09	RT	HMA	17	30		3.8	20.3		30.0	
CE/WATER PLANT	1047+09	LT	HMA	35	50		6.3	33.8		50.0	
PE	1048+87	LT	HMA	25	39		4.9	26.3		39.0	
PE	1053+35	LT	HMA	15	28		3.5	18.9		28.0	
MB	1053+35	LT	HMA		10		1.3	6.9		10.2	
PE	1055+45	LT	HMA	12	24		3.0	16.2		24.0	
MB	1055+45	LT	HMA		10		1.3	6.9		10.2	
PE	1055+93	LT	HMA	25	39		4.9	26.3		39.0	
MB	1055+93	LT	HMA		10		1.3	6.9		10.2	
PE	1057+13	LT	HMA	20	33		4.2	22.3		33.0	
MB	1057+13	LT	HMA		10		1.3	6.9		10.2	
PE	1060+81	LT	HMA	20	33		4.2	22.3		33.0	
MB	1060+81	LT	HMA		10		1.3	6.9		10.2	
CR 1700 E	1062+89	RT	T&C	15	28	20	3.5	18.9	10.0		1
PE	1074+73	RT	HMA	12	24		3.0	16.2		24.0	
MB	1074+73	LT	HMA		10		1.3	6.9		10.2	
PE	1076+41	RT	HMA	12	24		3.0	16.2		24.0	
PE	1077+30	LT	HMA	15	28		3.5	18.9		28.0	
MB	1077+30	LT	AGG		10		1.3	6.9			
PE	1077+66	RT	AGG	12	24		3.0	16.2			
MB	1077+66	LT	AGG		10		1.3	6.9			
PE	1079+69	RT	HMA	12	24		3.0	16.2		24.0	
MB	1079+69	LT	HMA		10		1.3	6.9		10.2	
CE	1080+09	RT	HMA	25	39		4.9	26.3		39.0	
CE	1082+57	RT	HMA	30	44		5.5	29.7		44.0	
PE	1084+55	LT	HMA	12	24		3.0	16.2		24.0	
MB	1084+55	LT	HMA		10		1.3	6.9		10.2	
PE	1085+85	LT	HMA	12	24		3.0	16.2		24.0	
MB	1085+85	LT	AGG		10		1.3	6.9			
CE	1088+33	RT	HMA	35	50		6.3	33.8		50.0	
INDUSTRIAL PARK STREET	1093+14	RT	CONC	40	1035			698.9	10.0		
PE	1099+17	RT	AGG	15	28		3.5	18.9			
PE	1101+95	LT	HMA	15	28		3.5	18.9		28.0	
TOTAL						110	240	1985	60	1476	5

- NOTE: ALL STATION ARE APPROXIMATE +/-
- FURNISHED EXCAVATION TO BE PLACED AROUND ALL SIDEROAD RADII. THESE AREAS TO BE SEEDED AND FERTILIZED AND MULCHED-INCLUDED IN THE COST OF FURNISHED EXCAVATION.

HMA SHOULDER				
LOCATION	LENGTH	AREA	HMA SHOULDER 5"	EXCAVATING & GRADING EXISTING SHLD
STATION (RT<))	FT	SO YD	SO YD	UNIT
IL 9/RT 115 INT 958+26				
959+26 TO 992+89	3363	1495	1495	67.3
OMIT SN 027-0094 992+89 TO 994+71	182	0	0	0.0
994+71 TO 1022+32	2761	1227	1227	55.2
SN 027-2552 1022+32 TO 1022+40	8	0	0	0
1022+40 TO 1036+61	1421	632	632	28.4
SN 027-2001 1036+61 TO 1036+81	20	0	0	0.0
1036+81 TO 1115+84	7903	3512	3512	158.1
BALTIMORE ST 1117+84				
TOTALS	15658		7072	318



PERMANENT SURVEY MARKERS					
STATION	DESCRIPTION	EXISTING MONUMENT TYPE	PROPOSED MONUMENT TYPE	MONUMENT RECORD TO BE RECORDED	RESPONSIBILITY
ILL RTE 9	ILL RTE 115 TO BALTIMORE DRIVE INPAXTON			FORD COUNTY	
	NE CORNER SEC 16-23-9E	BRASS DISK	TYPE 1	YES	2

NOTE: FOR ALL MONUMENT LOCATIONS SEE TIE SKETCHES

RESPONSIBILITY:

- 1) RESIDENT TO RE-ESTABLISH MONUMENT
- 2) RESIDENT TO RE-ESTABLISH MONUMENT AND FURNISH TIE SKETCHES TO D-3 PLATS AND PLANS (PAY ITEM REQUIRED. PERMANENT SURVEY MARKER, TYPE 1)
- 3) PROFESSIONAL LAND SURVEYOR TO RE-ESTABLISH MONUMENT, RECORD NEW MONUMENT RECORD, AND PROVIDE COPY TO D-3 PLATS AND PLANS (PAY ITEM REQUIRED - LAND SECTION MARKERS)

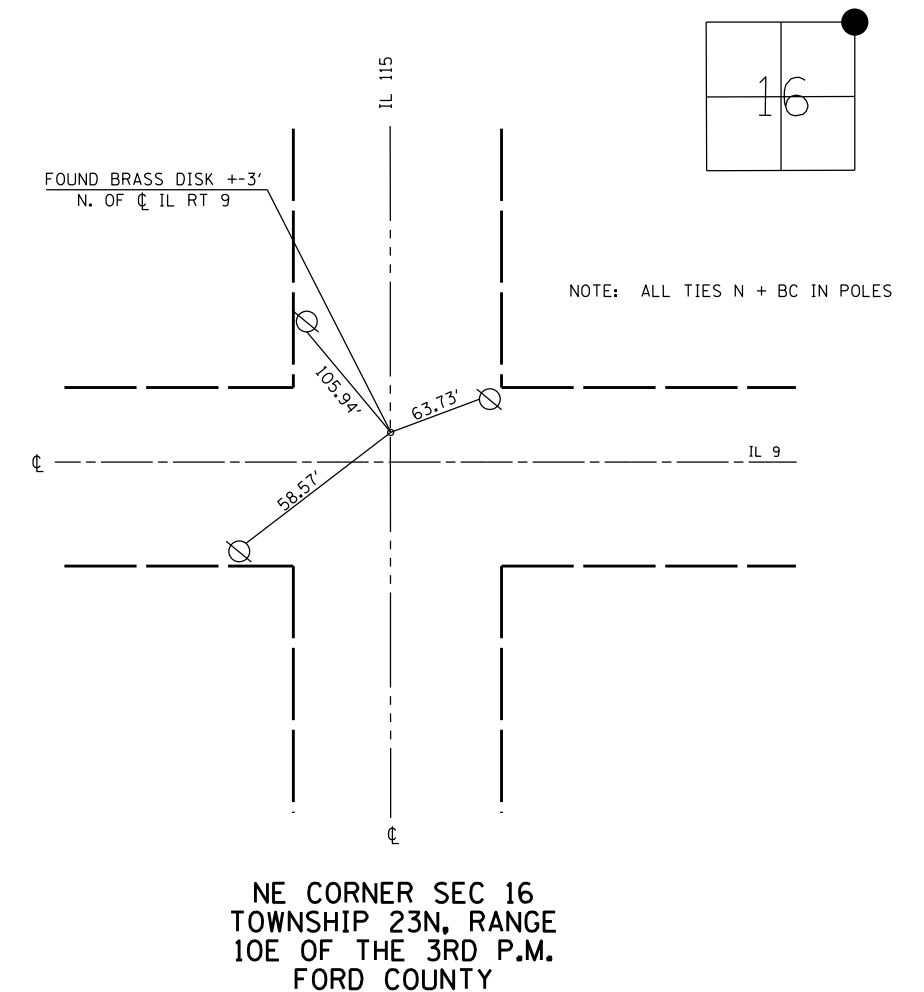

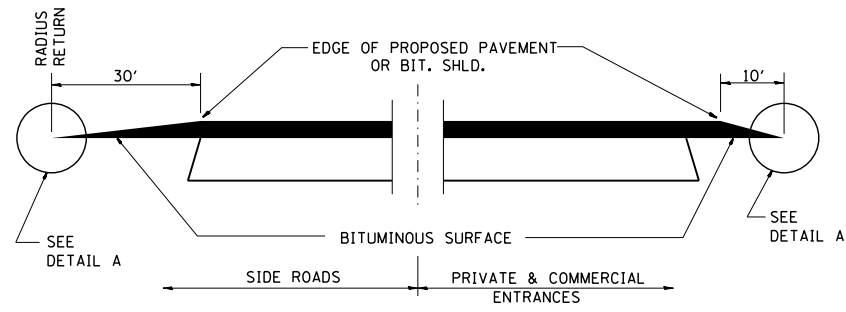

SECTION A-A
DETAILS AT ENTRANCES & SIDE ROADS

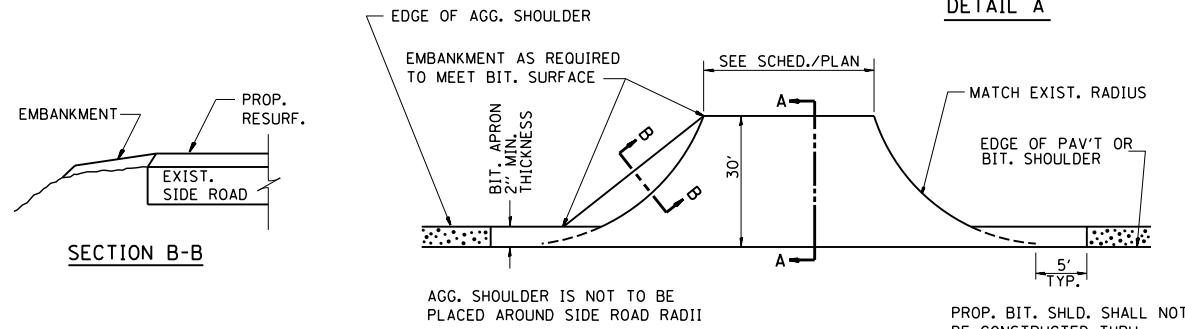
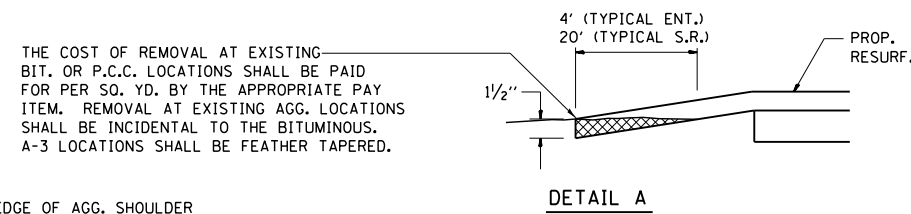

PLAN AT SIDE ROADS

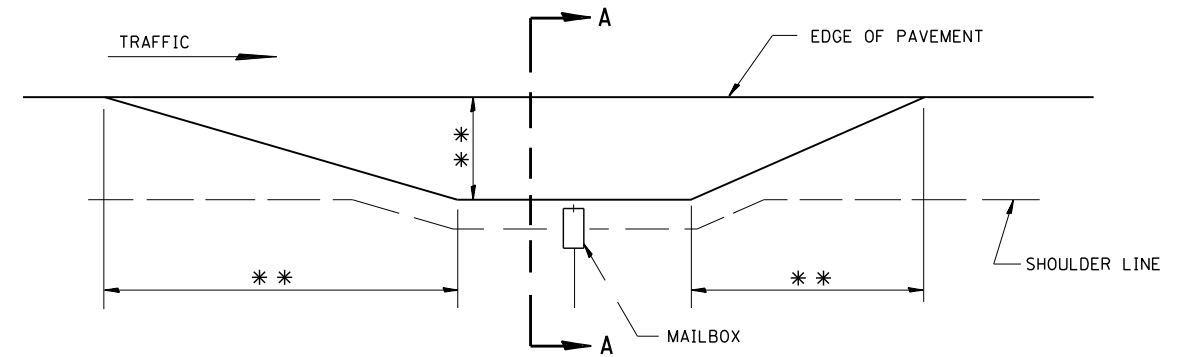

••SEE STANDARD 406201

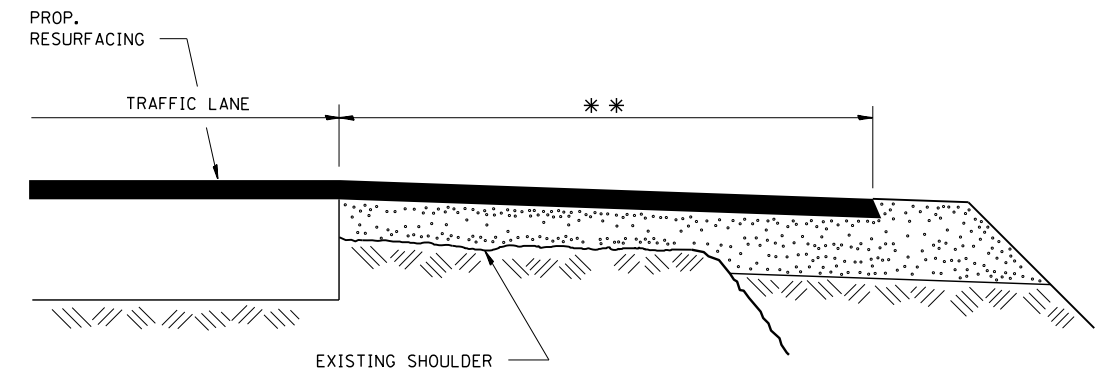

SECTION A-A
MAILBOX TURNOUT DETAILS

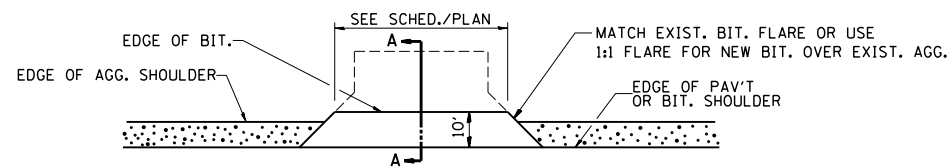

PLAN AT PRIVATE & COMMERCIAL ENTRANCES
(DO NOT RESURFACE FIELD ENTRANCES)

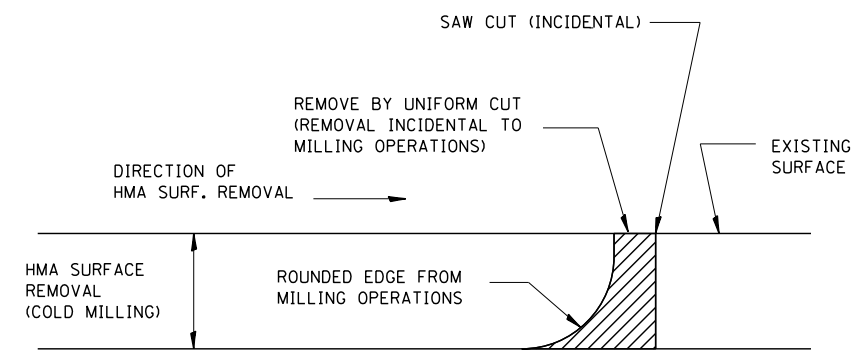

NOTE: WHEN MILLING OPERATIONS PRODUCE A ROUNDED EDGE, THEN A SAW CUT SHALL BE USED TO MANUFACTURE A PERPENDICULAR EDGE AS SHOWN IN THE DETAIL. THE ENGINEER SHALL BE THE SOLE JUDGE CONCERNING THE USE OF THIS DETAIL

BITUMINOUS DETAIL AT BUTT JOINTS

FILE NAME =	USER NAME = pletschr	DESIGNED -	REVISED -
et:\pwork\pwork\pletschr\d0104934\0365500-details.dgn		DRAWN -	REVISED -
	PLOT SCALE = 100.0000' / in.	CHECKED -	REVISED -
	PLOT DATE = 11/27/2013	DATE -	REVISED -

STATE OF ILLINOIS
DEPARTMENT OF TRANSPORTATION

DETAILS	
SCALE: _____	SHEET NO. ____ OF ____ SHEETS
STA. _____ TO STA. _____	

F.A.P. RTE.	SECTION	COUNTY	TOTAL SHEETS	SHEET NO.
697	17RS-4	FORD	11	10
CONTRACT NO. 66500				
ILLINOIS FED. AID PROJECT				

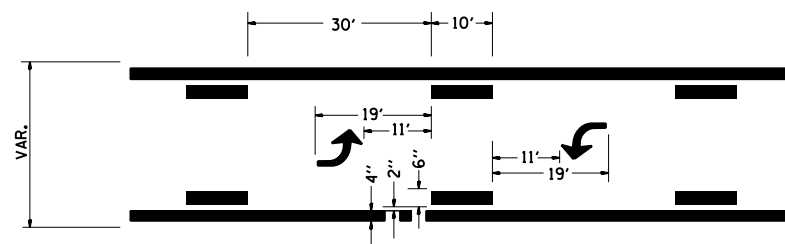

**TYPICAL APPLICATION
BI-DIRECTIONAL TURN LANE**

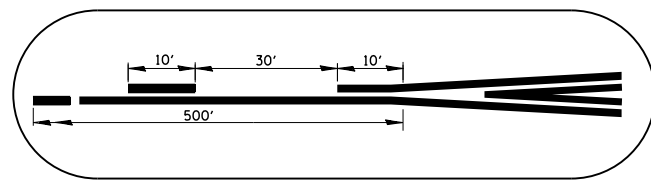

**TYPICAL APPLICATION
LEFT TURN LANES**

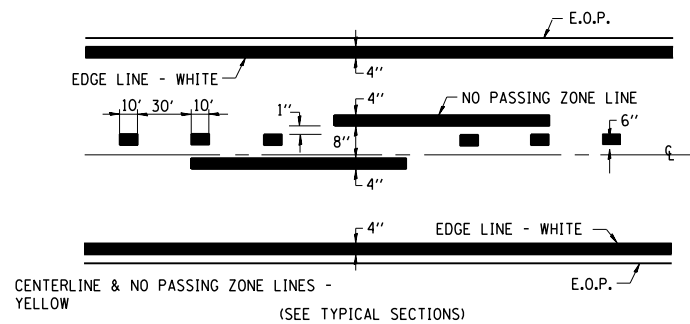
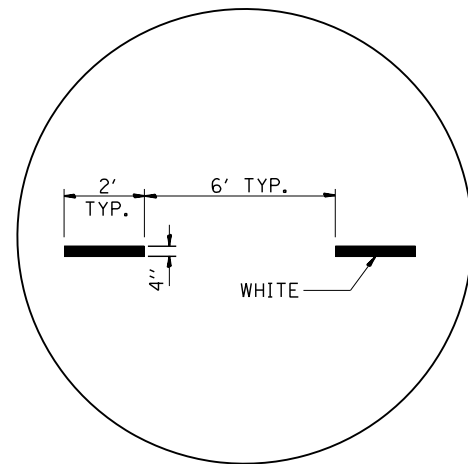
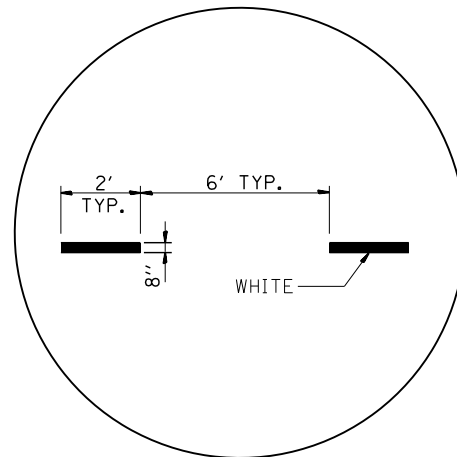
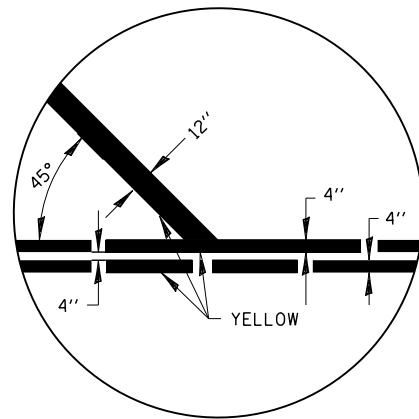
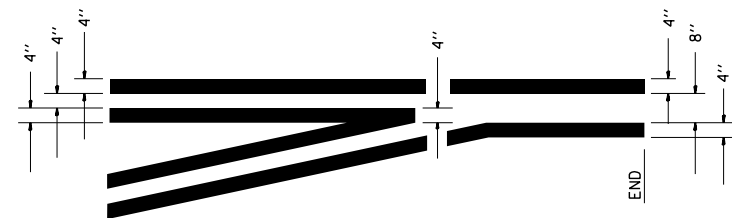

PAVEMENT MARKING

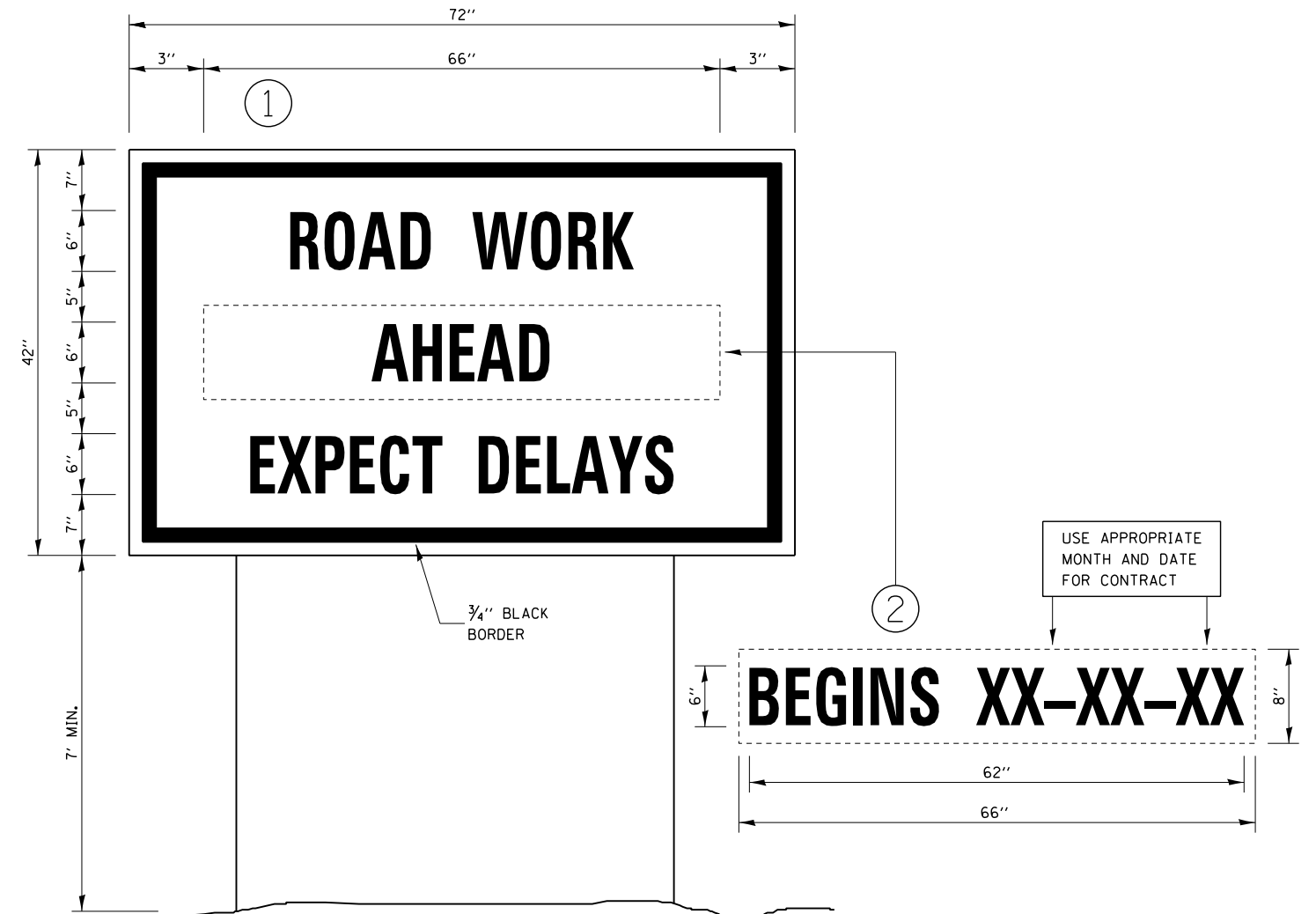

TEMPORARY INFORMATION SIGNING

NOTES:

1. USE 6" D BLACK LETTERING ON FLOURESENT ORANGE BACKGROUND.
2. ERECT SIGNS AT LOCATIONS IN ADVANCE OF THE "ROAD CONSTRUCTION AHEAD" SIGNS AS DIRECTED BY THE ENGINEER.
3. ERECT SIGN ① WITH INSTALLED PANEL ② A MINIMUM OF ONE WEEK PRIOR TO THE START OF THE LANE CLOSURE.
4. REMOVE PANEL ② ON THAT DATE.
5. SEE SPECIAL PROVISION "TEMPORARY INFORMATION SIGNING" FOR ADDITIONAL INFORMATION.
6. WILL BE PAID FOR PER SQ FT AS "TEMPORARY INFORMATION SIGNING". EACH SIGN = 21 SQ FT AND THE DATE PANEL ② WILL NOT BE MEASURED SEPARATELY FOR PAYMENT.

FILE NAME =	USER NAME = pletschr	DESIGNED -	REVISED -	STATE OF ILLINOIS DEPARTMENT OF TRANSPORTATION	DETAILS		F.A.P. RTE.	SECTION	COUNTY	TOTAL SHEETS	SHEET NO.
ci:\pw_work\pwidot\pletschr\d0104934\036500-details.dgn	DESIGNED -	REVISED -	REVISED -				697	17RS-4	FORD	11	11
PLOT SCALE = 100.0000' / in.	CHECKED -	REVISED -	REVISED -		CONTRACT NO. 66500						
PLOT DATE = 11/27/2013	DATE -	REVISED -	REVISED -		ILLINOIS FED. AID PROJECT						