

S. QTR. COR SEC 15-16-9

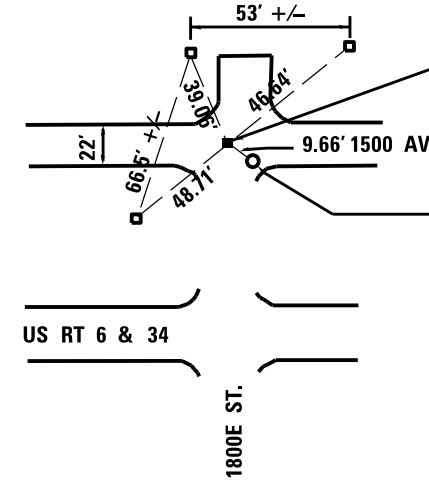
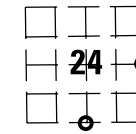
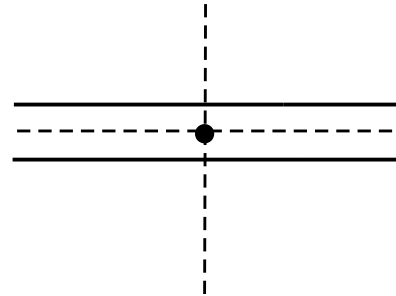

SET "SURVEY MARK" SPIKE  
AT NE COR SEC 24 BY  
PROPORTIONAL MEASUREMENTS.

FOUND BAR PER "MONUMENT  
RECORD" DOC #81-312  
BK. 604, P24-5

US RT 6 & 34

1800E ST.

SE COR SEC. 16-16-8

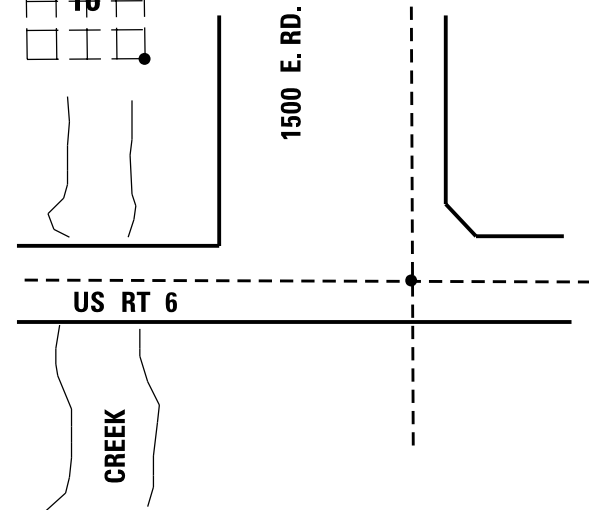
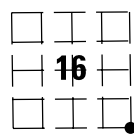

NW COR SEC. 19-16-9

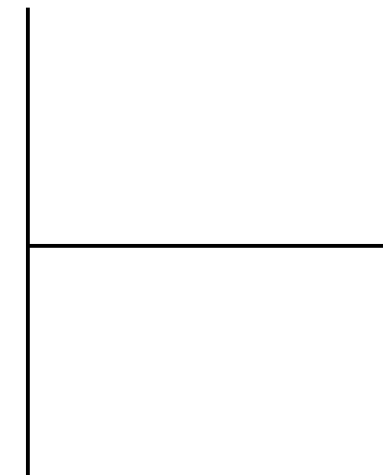
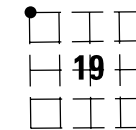

FILE NAME =	USER NAME = \$USER\$	DESIGNED - _____	REVISED - _____
\$FILEL\$		DRAWN - _____	REVISED - _____
\$MODELNAME\$		CHECKED - _____	REVISED - _____
	PLOT DATE = \$DATE\$	DATE - _____	REVISED - _____

STATE OF ILLINOIS  
DEPARTMENT OF TRANSPORTATION

TIE POINTS			
SCALE: _____	SHEET _____	OF _____	SHEETS
STA. _____	TO STA. _____		

F.A.S. RTE.	SECTION	COUNTY	TOTAL SHEETS	SHEET NO.
1248	(11)RS-1 & (11)RS-3	BUREAU	16	13
			CONTRACT NO. 66924	
ILLINOIS FED. AID PROJECT				