

INDEX OF SHEETS

- 1 COVER SHEET
- 2 GENERAL NOTES
- 3-4 SUMMARY OF QUANTITIES
- 5 TYPICAL SECTIONS
- 6 SCHEDULES
- 7-9 DETAILS

LIST OF ILLINOIS DOT HIGHWAY STANDARDS

000001-06	STANDARD SYMBOLS, ABBREVIATIONS AND PATTERNS
001006	DECIMAL OF AN INCH AND OF A FOOT
406201-01	MAILBOX TURNOUT
701001-02	OFF-ROAD OPERATIONS 2L, 2W, MORE THAN 15' (4.5 m) AWAY
701006-05	OFF-ROAD OPERATIONS 2L, 2W, 15' (4.5 m) TO 24" (600 mm) FROM PAVEMENT EDGE
701011-04	OFF-ROAD MOVING OPERATIONS 2L, 2W, DAY ONLY
701301-04	LANE CLOSURE, 2L, 2W, SHORT TIME OPERATIONS
701306-03	LANE CLOSURE, 2L, 2W, SLOW MOVING OPERATIONS DAY ONLY, FOR SPEEDS **@ 45 MPH
701326-04	LANE CLOSURE, 2L, 2W, PAVEMENT WIDENING, FOR SPEEDS **@ 45 MPH
701901-03	TRAFFIC CONTROL DEVICES
780001-04	TYPICAL PAVEMENT MARKINGS
781001-03	TYPICAL APPLICATIONS RAISED REFLECTIVE PAVEMENT MARKERS

STATE OF ILLINOIS
DEPARTMENT OF TRANSPORTATION
DIVISION OF HIGHWAYS
**PROPOSED
HIGHWAY PLANS**

FAS ROUTE 1252 (IL 29)
SECTION (R-4)RS-3

TYPE of IMPROVEMENT: 3P MILLING AND
RESURFACING
BUREAU COUNTY

C-93-030-11

PROJECT BEGINS STA 174+24
EAST APPROACH PVT
SN 006-0143

PROJECT ENDS
WEST OF IL 89
STA 333+00

FAS RTE.	SECTION	COUNTY	TOTAL SHEETS	SHEET NO.
1252	(R-4)RS-3	BUREAU	9	1
ILLINOIS			CONTRACT NO. 66A73	

D-93-024-11

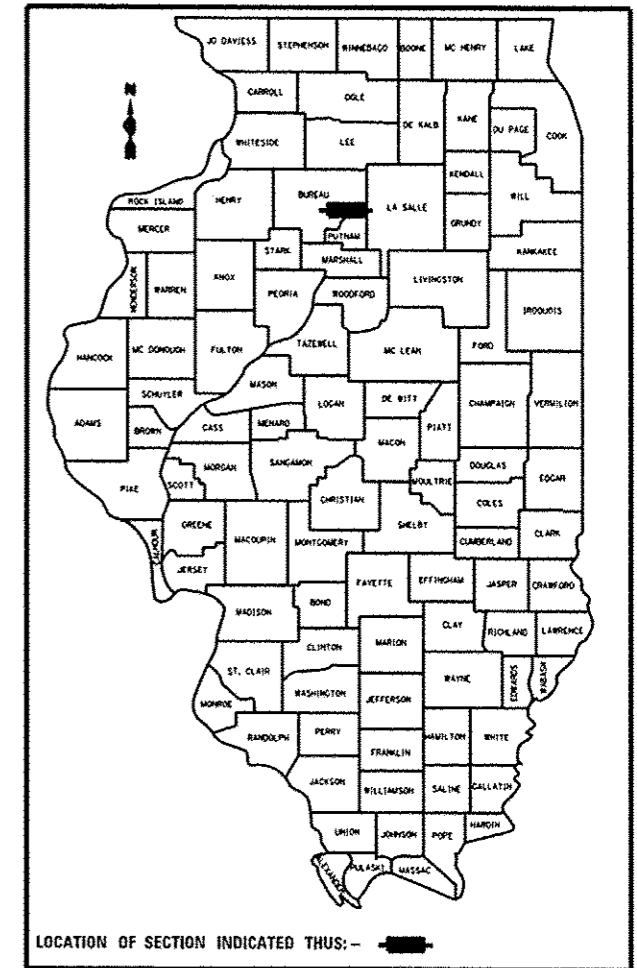

LOCATION OF SECTION INDICATED THUS: - [Symbol] -

FROM IL 89 TO BRIARCLIFF DRIVE -
FUNCTIONAL CLASSIFICATION-
MINOR ARTERIAL-RURAL
2009 ADT = 3350 VPD
PV=96.4% SU=3.0% MU=0.6%

FROM BRIARCLIFF DRIVE TO DEPUÉ-
FUNCTIONAL CLASSIFICATION-
MAJOR COLLECTOR-RURAL
2009 ADT = 3750 VPD
PV=97.6% SU=1.9% MU=0.5%

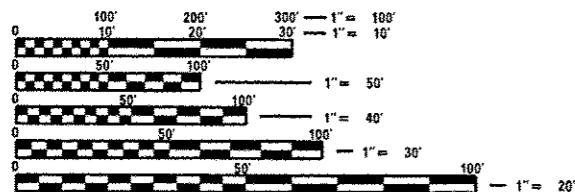

FULL SIZE PLANS HAVE BEEN PREPARED USING STANDARD ENGINEERING SCALES. REDUCED SIZED PLANS WILL NOT CONFORM TO STANDARD SCALES. IN MAKING MEASUREMENTS ON REDUCED PLANS, THE ABOVE SCALES MAY BE USED.

J.U.L.I.E.
JOINT UTILITY LOCATION INFORMATION FOR EXCAVATION
1-800-892-0123
OR 811

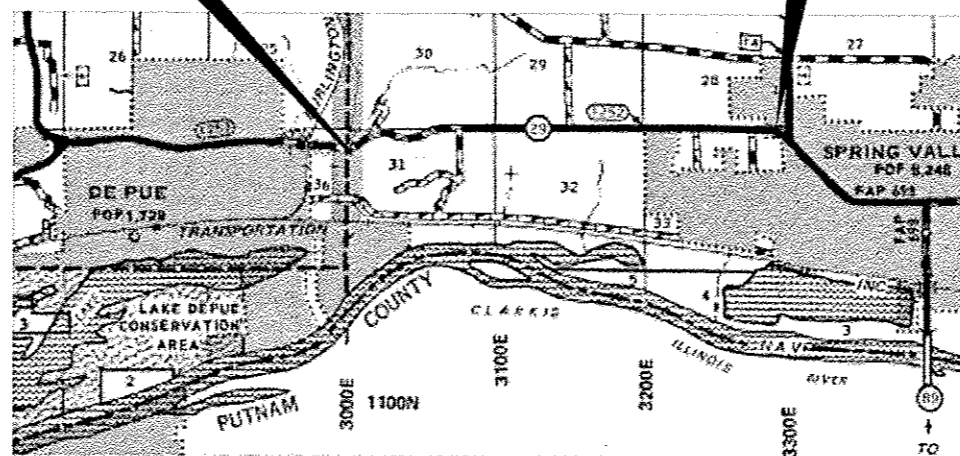

GROSS LENGTH = NET LENGTH = 15,876 FT. = 3.01 MILE

PROJECT ENGINEER: CRAIG REED, P.E.
UNIT CHIEF: P.BRABOY, P.E.

CONTRACT NO.66A73

STATE OF ILLINOIS
DEPARTMENT OF TRANSPORTATION
DIVISION OF HIGHWAYS

SUBMITTED June 5 2014
Paul Coeta, D.B.
DEPUTY DIRECTOR OF HIGHWAYS, REGION ENGINEER

June 27 2014
John D. Baranzelli, P.E.
acting ENGINEER OF DESIGN AND ENVIRONMENT

June 27 2014
Emor Osman, P.E.
DIRECTOR OF HIGHWAYS, CHIEF ENGINEER

PRINTED BY THE AUTHORITY
OF THE STATE OF ILLINOIS

GENERAL NOTES

THE THICKNESS OF HMA SHOWN ON THE PLANS IS THE NOMINAL THICKNESS. DEVIATIONS FROM THE NOMINAL THICKNESS WILL BE PERMITTED WHEN SUCH DEVIATIONS OCCUR DUE TO IRREGULARITIES IN THE EXISTING SURFACE OR BASE ON WHICH THE HMA IS PLACED.

THE HMA SURFACE OF ALL MAILBOX TURNOUTS, PRIVATE ENTRANCES, COMMERCIAL ENTRANCES, AND SIDE ROADS SHALL BE MADE NEATLY, IN A WORKMANLIKE MANNER, AND SHALL ACCURATELY CONFORM TO THE SHAPES AND DIMENSIONS SHOWN ON THE PLAN DETAILS. IF REQUIRED BY THE ENGINEER, THE CONTRACTOR SHALL SAW CUT THE HMA SURFACE TO CONFORM TO THE SHAPES AND DIMENSIONS SHOWN ON THE PLAN DETAILS. THIS WORK WILL BE INCLUDED IN THE COST OF THE HMA SURFACE.

THE SHOULDER WIDENING SHALL BE CARRIED THROUGH ALL ENTRANCES, SIDE ROADS, AND MAILBOX TURNOUTS. EXCEPTIONS WILL BE SHOWN ON THE PLANS.

EXCEPT AS NOTED ON THE PLANS, PAVEMENT GRADES SHOWN ARE AT THE TOP OF PAVEMENT SURFACES.

THE ENGINEER WILL BE THE SOLE JUDGE CONCERNING CURING TIME FOR THE VARIOUS HMA LIFTS.

FOR STABILIZATION, ALL TYPE III BARRICADES WILL REQUIRE A MINIMUM OF FOUR SAND BAGS PER BARRICADE.

SEEDING WILL NOT BE PERMITTED AT ANY TIME WHEN THE GROUND IS FROZEN, WET, OR IN AN UNTILLABLE CONDITION. LOCATIONS TO BE SEEDED WILL BE DETERMINED BY THE ENGINEER.

THE FINISHED EARTHWORK SHALL HAVE A VEGETATION SUSTAINING SOIL COVERING THE TOP FOUR INCHES (100 MILLIMETERS) IN AREAS TO BE SEEDED OR SODDED. THE VEGETATION SUSTAINING SOIL REQUIRED WILL NOT BE PAID FOR SEPARATELY BUT WILL BE INCLUDED IN THE COST OF FURNISHED EXCAVATION.

ALL EXCAVATED MATERIAL, WHICH INCLUDES DIGGING OR GRADING OF ANY SOIL OR FILL MATERIAL, WITH THE EXCEPTION OF AGGREGATE FILLS, MUST BE INCORPORATED WITHIN THE 100T RIGHT OF WAY DUE TO ENVIRONMENTAL DOCUMENTATION REQUIREMENTS.

ON EXISTING PAVEMENT WHICH MAY BE SUPERELEVATED, THE NEW HMA PAVEMENT SHALL BE BUILT WITH THE SAME SUPERELEVATION UNLESS NEW SUPERELEVATION RATES ARE GIVEN ON THE PLANS.

ABANDONED UNDERGROUND UTILITIES THAT CONFLICT WITH CONSTRUCTION SHALL BE DISPOSED OF OUTSIDE THE LIMITS OF THE RIGHT OF WAY ACCORDING TO ARTICLE 202.03 OF THE STANDARD SPECIFICATIONS AND AS DIRECTED BY THE ENGINEER. THIS WORK WILL NOT BE PAID FOR SEPARATELY, BUT WILL BE INCLUDED IN THE COST OF EARTH EXCAVATION.

ANY REFERENCE TO A STANDARD IN THESE PLANS SHALL BE INTERPRETED TO MEAN THE EDITION AS INDICATED BY THE SUBNUMBER SHOWN IN THE LIST OF STANDARDS OR THE COPY INCLUDED IN THESE PLANS.

THE FOLLOWING RATES OF APPLICATION HAVE BEEN USED IN CALCULATING PLAN QUANTITIES:

GRANULAR MATERIALS	2.05	TONS / CU YD
HMA RESURFACING	112	LBS / SQ YD / IN
SHORT TERM PAVEMENT MARKING	10	FT / 100 FT OF APPLICATION
MIX FOR CRACKS, JTS & FLGWYS	0.0003	TONS / SQ YD
LEVEL BINDER (HAND METHOD)	0.0005	TONS / SQ YD

THE CONTRACTOR SHALL CONTACT JULIE AT LEAST 48 HOURS PRIOR TO EXCAVATION TO DETERMINE WHICH UTILITIES ARE IN THE AREA.

COMMITMENTS:

1. ENVIRONMENTAL COORDINATION

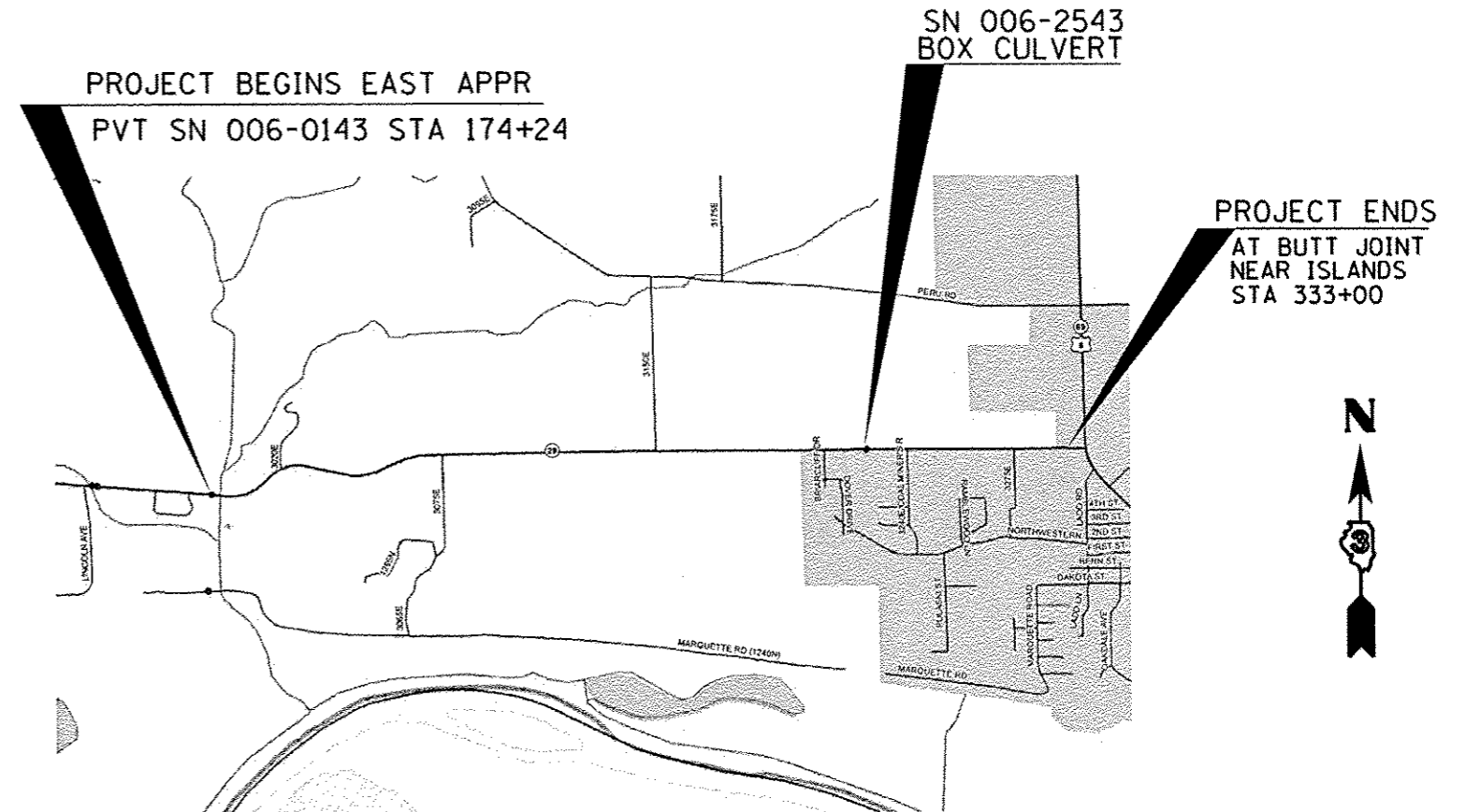

LOCATION MAP

STATE OF ILLINOIS
DEPARTMENT OF TRANSPORTATION
DISTRICT THREE

PREPARED BY: *Tom Bonvil*
DISTRICT STUDIES & PLANS ENGINEER

DATE: 6-5-14

EXAMINED BY: *[Signature]*
DISTRICT CONSTRUCTION ENGINEER

Wynne L. Phillips
DISTRICT MATERIALS ENGINEER

Paul A. Husler
DISTRICT OPERATIONS ENGINEER

FILE NAME *	USER NAME * #USER*	DESIGNED -	REVISED -	STATE OF ILLINOIS DEPARTMENT OF TRANSPORTATION	GENERAL NOTES AND LOCATION MAP	F.A. RTE.	SECTION	COUNTY	TOTAL SHEETS	SHEET NO.	
#FILE#		DRAWN -	REVISED -			1252	GR-4RS-3	BUREAU	9	2	
PLOT SCALE * #SCALE*		CHECKED -	REVISED -			CONTRACT NO. 66A75					
PLOT DATE * #DATE*		DATE -	REVISED -			ILLINOIS/FED. AID PROJECT					

CODE NO.	ITEM	UNIT	TOTAL QUANTITY	CONSTR. CODE
				100% STATE ROADWAY 0005
20200600	EXCAVATING AND GRADING EXISTING SHOULDER	UNIT	318	318
20400800	FURNISHED EXCAVATION	CU YD	10	10
40600400	MIXTURE FOR CRACKS, JOINTS, AND FLANGEWAYS	TON	14	14
40600527	LEVELING BINDER (HAND METHOD), IL-9.5FG, N50	TON	23	23
40600627	LEVELING BINDER (MACHINE METHOD), IL-9.5FG, N50	TON	1908	1908
40600895	CONSTRUCTING TEST STRIP	EACH	2	2
40600990	TEMPORARY RAMP	SO YD	56	56
40603310	HOT-MIX ASPHALT SURFACE COURSE, MIX "C", N50	TON	3816	3816
40800050	INCIDENTAL HOT-MIX ASPHALT SURFACING	TON	137	137
44000158	HOT-MIX ASPHALT SURFACE REMOVAL, 2 1/4"	SO YD	45864	45864
48101200	AGGREGATE SHOULDERS, TYPE B	TON	603	603
48203021	HOT-MIX ASPHALT SHOULDERS, 6"	SO YD	5292	5292
67000400	ENGINEER'S FIELD OFFICE, TYPE A	CAL MO	2	2
67100100	MOBILIZATION	L SUM	1	1

14

Rev.

FILE NAME *	USER NAME * #USER#	DESIGNED -	REVISED -	STATE OF ILLINOIS DEPARTMENT OF TRANSPORTATION	SUMMARY OF QUANTITIES				F.A. RTE.	SECTION	COUNTY	TOTAL SHEETS	SHEET NO.
#FILE#		DRAWN -	REVISED -		SCALE: _____	SHEET NO. _____ OF _____ SHEETS	STA. _____	TO STA. _____	1252	CR-4RS-3	BUREAU	9	3
		CHECKED -	REVISED -						CONTRACT NO. 66475				
		DATE -	REVISED -						ILLINOIS FED. AID PROJECT				

CODE NO.	ITEM	UNIT	TOTAL QUANTITY	CONSTR. CODE
				ROADWAY 0005
				100% STATE
70100460	TRAFFIC CONTROL AND PROTECTION, STANDARD 701306	L SUM	1	1
70100500	TRAFFIC CONTROL AND PROTECTION, STANDARD 701326	L SUM	1	1
70103815	TRAFFIC CONTROL SURVEILLANCE	CAL DA	10	10
70300100	SHORT TERM PAVEMENT MARKING	FOOT	4762	4762
70300220	TEMPORARY PAVEMENT MARKING - LINE 4"	FOOT	44551	44551
70300240	TEMPORARY PAVEMENT MARKING - LINE 6"	FOOT	4565	4565
70301000	WORK ZONE PAVEMENT MARKING REMOVAL	SO FT	524	524
* 78001110	PAINT PAVEMENT MARKING - LINE 4"	FOOT	89102	89102
* 78001130	PAINT PAVEMENT MARKING - LINE 6"	FOOT	9138	9138
* 78100100	RAISED REFLECTIVE PAVEMENT MARKER	EACH	199	199
78300200	RAISED REFLECTIVE PAVEMENT MARKER REMOVAL	EACH	199	199
X4060110	BITUMINOUS MATERIALS (PRIME COAT)	POUND	31786	31786
X4401198	HOT-MIX ASPHALT SURFACE REMOVAL, VARIABLE DEPTH	SO YD	1227	1227
Z0030850	TEMPORARY INFORMATION SIGNING	SO FT	42	42
Z0034105	MATERIAL TRANSFER DEVICE	TON	5724	5724

FILE NAME *	USER NAME * #USER#	DESIGNED - _____	REVISED - _____	STATE OF ILLINOIS DEPARTMENT OF TRANSPORTATION	SUMMARY OF QUANTITIES		F.A. RTE.	SECTION	COUNTY	TOTAL SHEETS	SHEET NO.
#FILE#		DRAWN - _____	REVISED - _____				1252	GR-4RS-3	BUREAU	9	4
PLOT SCALE * #SCALE#		CHECKED - _____	REVISED - _____		SCALE: _____	SHEET NO. _____ OF _____ SHEETS	STA. _____ TO STA. _____	CONTRACT NO. 66475		ILLINOIS/FED. AID PROJECT	
PLOT DATE * #DATE#		DATE - _____	REVISED - _____								

* Specialty Items

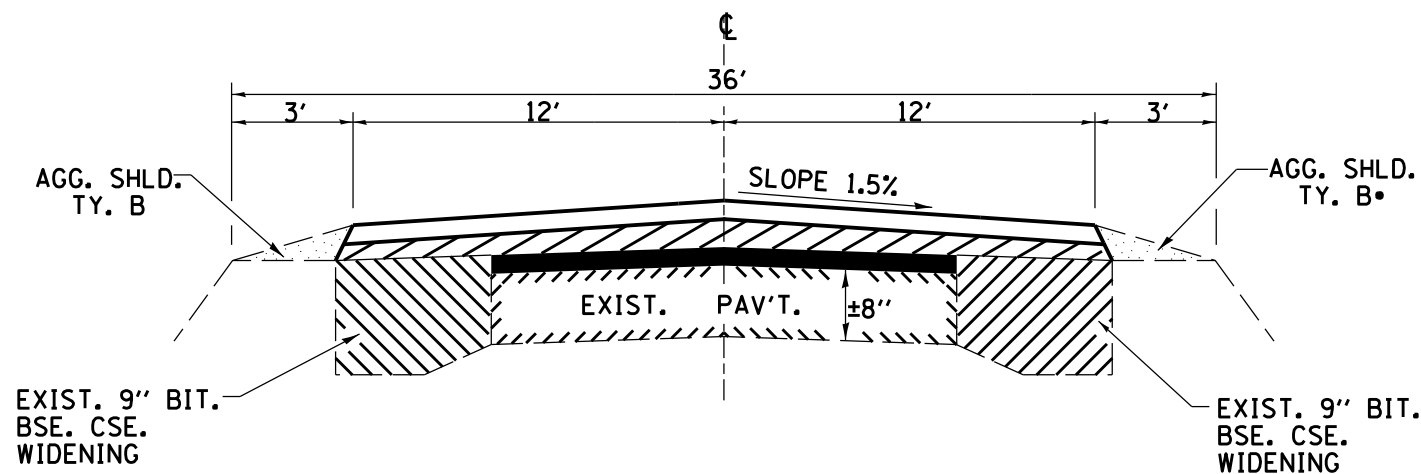

•PORTIONS OF THIS SHOULDER ARE DETERIORATED HMA SHOULDER

EXISTING TYPICAL SECTION

STA. 174+24 TO STA. 333+00

	HMA LEVEL BINDER	HMA SURFACE	HMA SHOULDERS
PG GRADE	PG 64-22	PG 64-22	PG 64-22
DESIGN AIR VOIDS	4.0% @ N50	4.0% @ N50	4.0% @ N50
MIXTURE COMPOSITION	IL 9.5FG	IL 9.5	IL 19.0 FG
FRICTION AGGREGATE		MIXTURE C	
DENSITY TEST METHODS	COORELATION	COORELATION	CORES

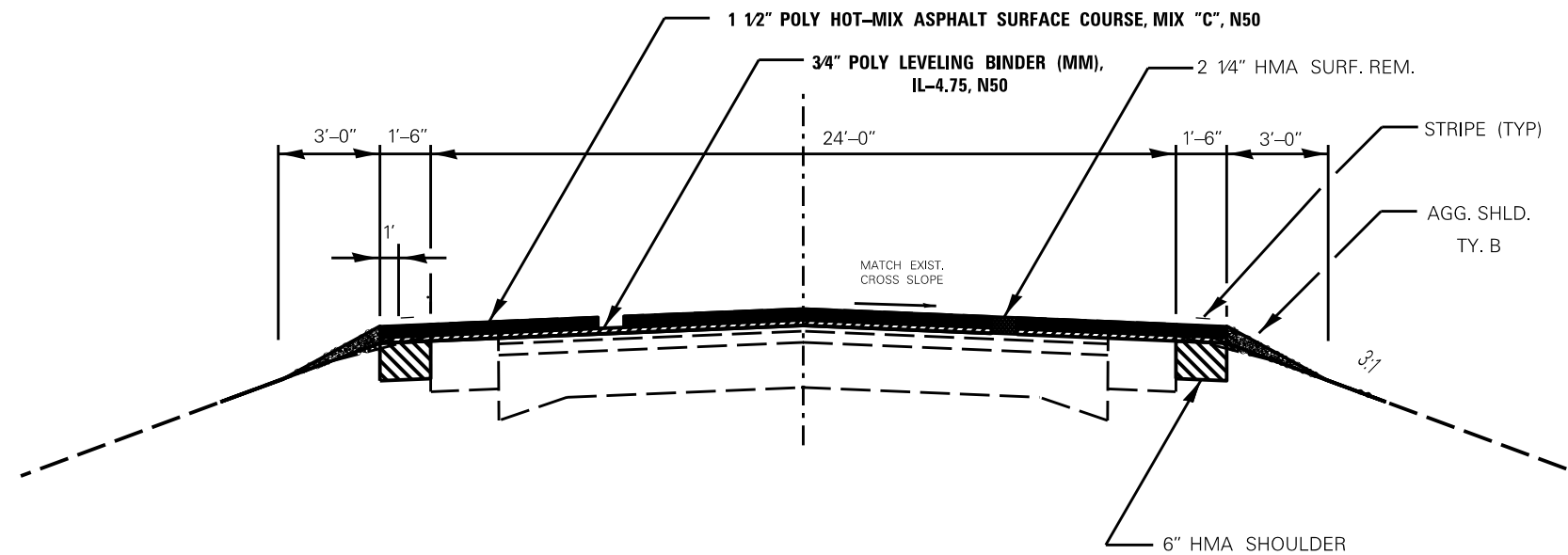

PROPOSED TYPICAL SECTION

STA. 174+24 TO STA. 333+00

MAINLINE SCHEDULE										
STA. TO STA.	LENGTH	WIDTH	HMA SURF CSE	LEVEL BINDER (MM)	LEVEL BINDER (HM)	HMA SURF REM 2 1/4"	MIX FOR JTS, CRACKS & FLGWYS	BIT. MAT'L (PR CT)	AGG SHLD TY B	TEMP RAMP
	FT	FT	TONS	TONS	TONS	SO YD	TONS	POUND	TONS	SO YD
174+24 TO 333+00	15876	26	3815.5	1907.8	22.9	45864.0	13.8	30958.2	603.0	16.0
TOTALS			3816	1908	23	45864	14	30958	603	16

PAVEMENT MARKING SCHEDULE											
LOCATION		PAINT 4" WHITE(2)	PAINT 4" YELLOW(2)	PAINT 6" YELLOW(2)	TEMP MARK 4"	TEMP MARK 6"	SHORT-TERM MARK	WORK ZONE PAVT MARK REM	RAISED REFLECTIVE PVMT MARKERS	RAISED REFLECTIVE PVT MK REM	
STA		FOOT	FOOT	FOOT	FOOT	FOOT	FOOT	SO. FT.	EACH	EACH	
174+24 TO 333+00	EDGE LINES	63504.0		7938.0	31752.0	3969.0	4762.0	524.0	199.0	199.0	
221+01 TO 230+48	RT CL			474.0							
278+50 TO 285+90	LT CL			370.0							
320+74 TO 327+68	LT CL			348.0							
NO PASSING ZONES (1)											
174+24 TO 221+01	RT & LT		18708.0								
221+01 TO 230+48	LT		1894.0								
278+50 TO 285+90	RT		1480.0								
320+74 TO 327+68	RT		1388.0								
327+68 TO 333+00	RT & LT		2128.0								
GRAND TOTAL		63504	25598	9130	44551	4565	4762	524	199	199	

(1) R.E. TO VERIFY NO PASSING ZONES PRIOR TO MILLING OPERATION
(2) QUANTITY IS FOR TWO APPLICATIONS-SEE SPECIAL PROVISIONS

SHOULDER SCHEDULE					
STA. TO STA.	LENGTH	SIDE	AREA	HMA SHLD 6"	EX & GRADING EXIST SHLD*
	FT	FT	SO YD	SO YD	UNIT
174+24 TO 333+00	15876	LT&RT	5292	5292	318
TOTALS			5292	5292	318

*PORTIONS OF THE EXIST. AGG SHOULDER ARE DETERIORATED HMA. REMOVAL OF THE EXIST HMA SHLD IS INCLUDED IN THE COST OF EX AND GRADING EXISTING SHOULDER

SIDEROADS & ENTRANCES								
NAME	STATION	TYPE	RT/LT	HMA SURF REM VAR DEPTH SO YD	INCIDENTAL HMA SURF TON	BIT MATLS PR CT POUND	TEMP. RAMP SO YD	FURN. EX* CU YD
SIDEROADS								
3075E	218+00	SIDEROAD	RT	140	15.7	94.5	8.0	2.0
3150E	258+32	SIDEROAD	LT	75	8.4	50.6	8.0	2.0
BRIARCLIFF DR	290+44	SIDEROAD	RT	61	6.8	41.2	8.0	2.0
3240E-COAL MINER'S DR	306+12	SIDEROAD	RT	101	11.3	68.2	8.0	2.0
3275E	326+36	SIDEROAD	RT	77	8.6	52.0	8.0	2.0
ENTRANCES								
	203+50	PE	LT	81	9.1	54.7		
	203+80	PE	RT	44	4.9	29.7		
	206+25	PE	RT	44	4.9	29.7		
	208+22	PE	LT	46	5.2	31.1		
	211+98	PE	RT	42	4.7	28.4		
	218+07	PE	RT	32	3.6	21.6		
	218+45	PE & MBTO	LT	64	7.2	43.2		
	220+39	PE	LT	48	5.4	32.4		
	224+07	PE & MBTO	LT	54	6.0	36.5		
	225+73	PE & MBTO	LT	72	8.1	48.6		
	235+90	PE & MBTO	RT	46	5.2	31.1		
	282+23	PE & MBTO	RT	38	4.3	25.7		
	296+07	PE & MBTO	RT	45	5.0	30.4		
	304+17	PE & MBTO	RT	41	4.6	27.7		
	313+60	PE & MBTO	RT	38	4.3	25.7		
	321+52	PE & MBTO	RT	38	4.3	25.7		
TOTALS				1227	137	828	40	10

*THESE AREAS TO BE ALSO SEEDED, FERTILIZED, AND MULCHED. INCLUDED IN THE COST OF FURNISHED EXCAVATION

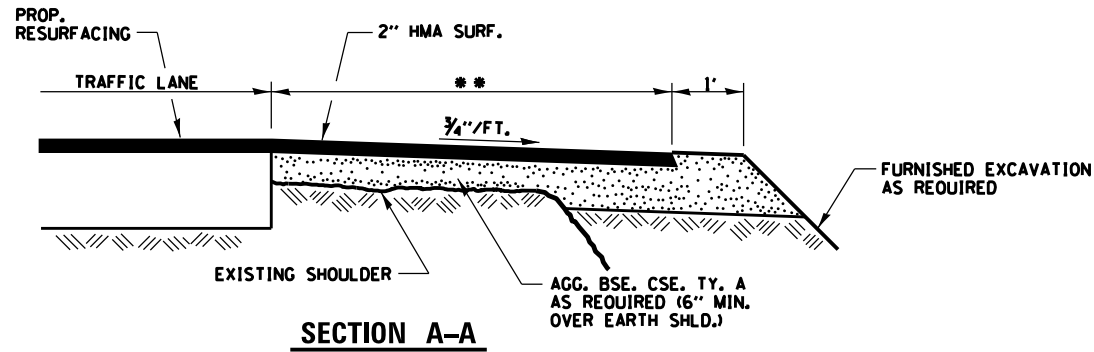
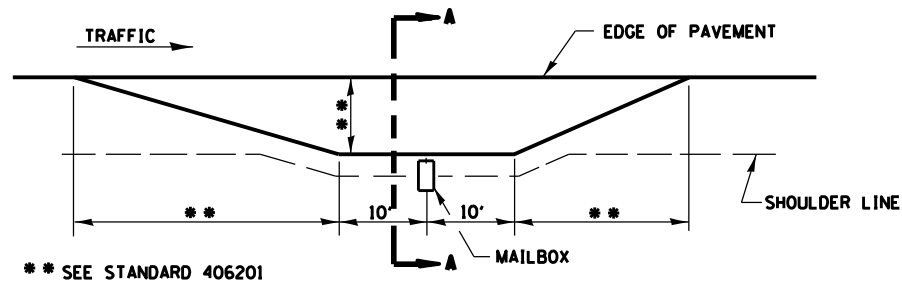

RURAL MAILBOX TURNOUT DETAILS

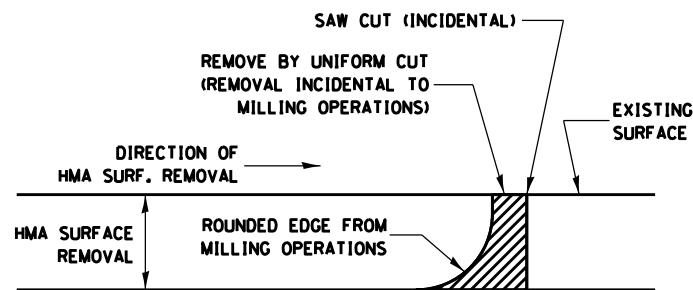

NOTE:
 WHEN MILLING OPERATIONS PRODUCE A ROUNDED EDGE, THEN A SAW CUT SHALL BE USED TO MANUFACTURE A PERPENDICULAR EDGE AS SHOWN IN THE DETAIL. THE ENGINEER SHALL BE THE SOLE JUDGE CONCERNING THE USE OF THIS DETAIL

HMA DETAIL AT BUTT JOINTS

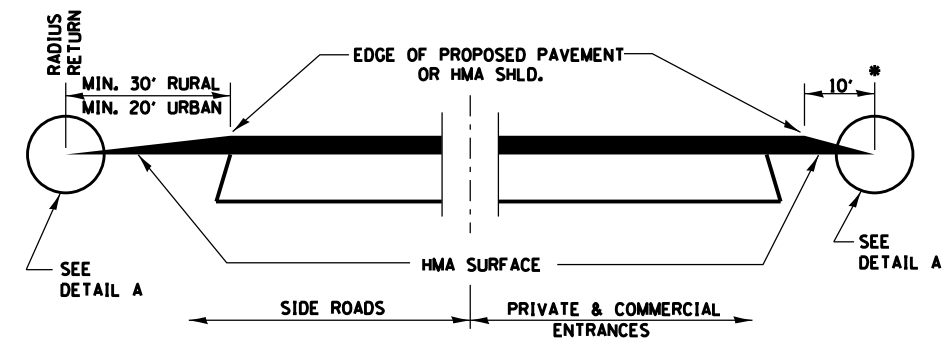

**SECTION A-A
 DETAILS AT ENTRANCES & SIDE ROADS**

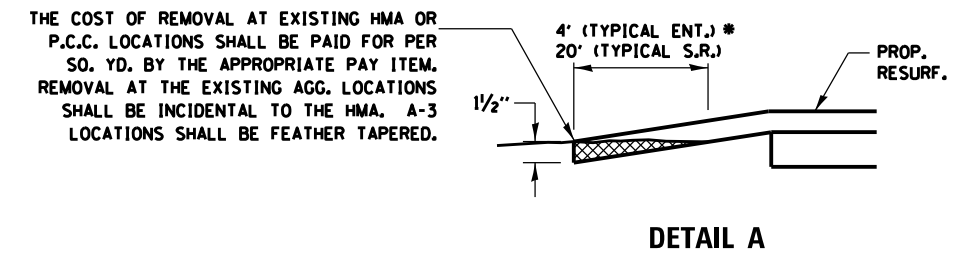
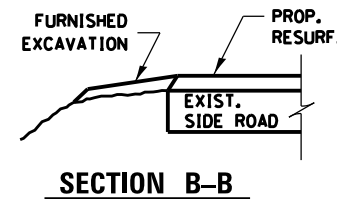

THE COST OF REMOVAL AT EXISTING HMA OR P.C.C. LOCATIONS SHALL BE PAID FOR PER SQ. YD. BY THE APPROPRIATE PAY ITEM. REMOVAL AT THE EXISTING AGG. LOCATIONS SHALL BE INCIDENTAL TO THE HMA. A-3 LOCATIONS SHALL BE FEATHER TAPERED.

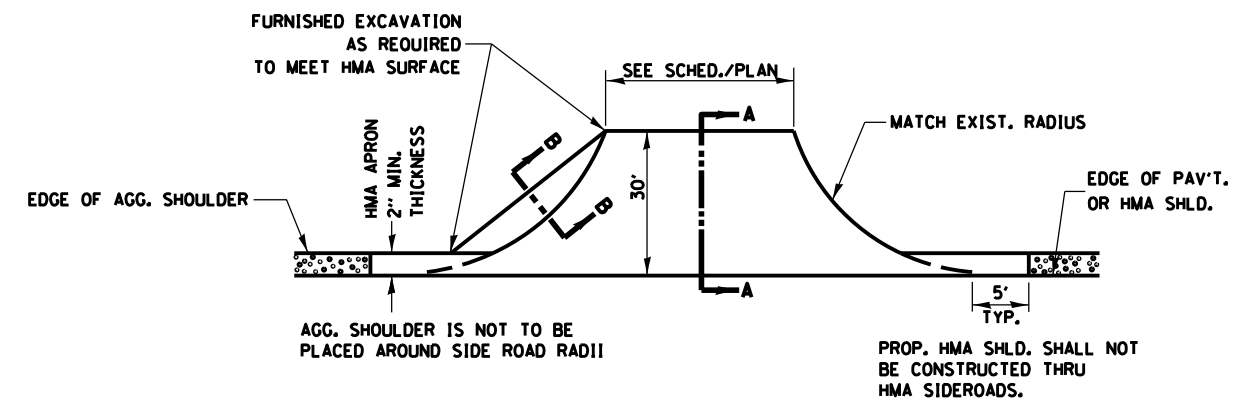

PLAN AT SIDE ROADS

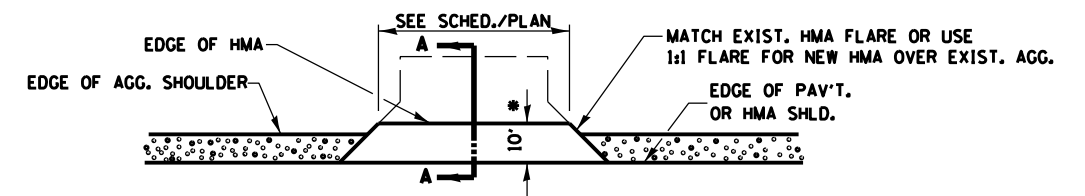

PLAN AT PRIVATE & COMMERCIAL ENTRANCES

(DO NOT RESURFACE FIELD ENTRANCES)

* PROPOSED HMA RESURFACING AT PUBLIC EDUCATIONAL FACILITY ENTRANCES SHALL BE EXTENDED TO THE RIGHT-OF-WAY LIMITS.

FILE NAME = *FILE*	USER NAME = *USER*	DESIGNED - _____	REVISED - _____	STATE OF ILLINOIS DEPARTMENT OF TRANSPORTATION	SCHEDULE OF QUANTITIES		F.A. RTE. _____	SECTION _____	COUNTY _____	TOTAL SHEETS _____	SHEET NO. _____
	PLOT SCALE = *SCALE*	DRAWN - _____	REVISED - _____				1292	IR-4RS-3	BUREAU	9	7
	PLOT DATE = *DATE*	CHECKED - _____	REVISED - _____		CONTRACT NO. 66A73						
		DATE - _____	REVISED - _____		ILLINOIS FED. AID PROJECT						

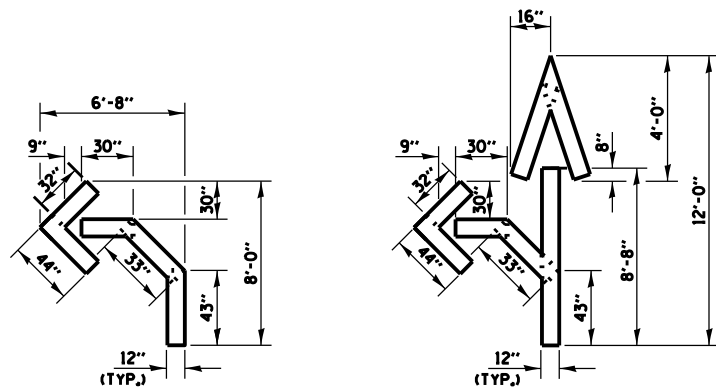

QUANTITY
 12" LINE = 16 LIN. FT.
 OR 4" LINE = 48 LIN. FT.

QUANTITY
 12" LINE = 29 LIN. FT.
 OR 4" LINE = 87 LIN. FT.

**SHORT-TERM PAVEMENT MARKING
 FOR ARROWS**

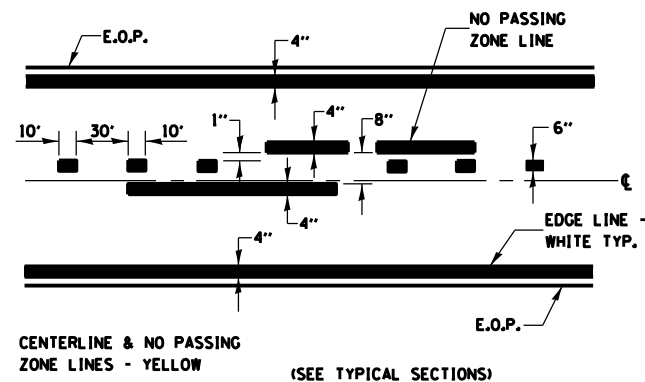

CENTERLINE & NO PASSING
 ZONE LINES - YELLOW (SEE TYPICAL SECTIONS)

PAVEMENT MARKING

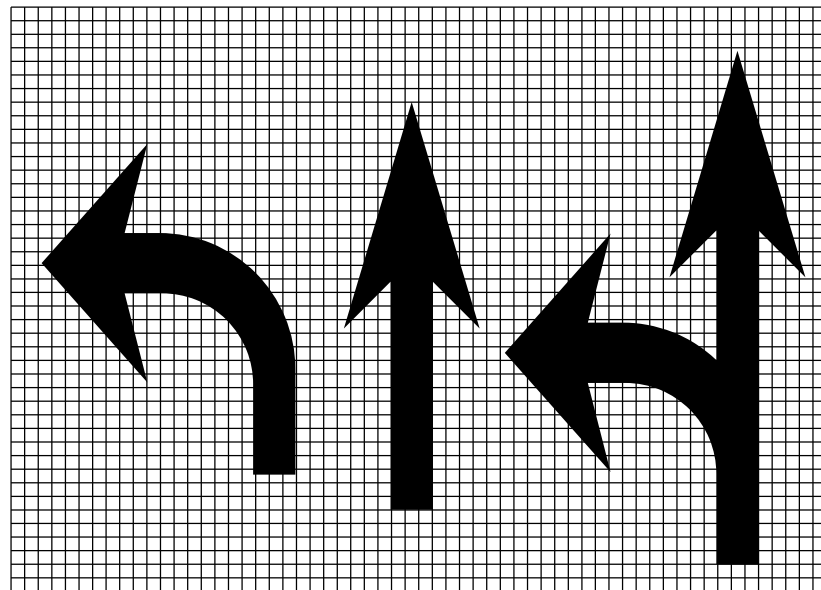
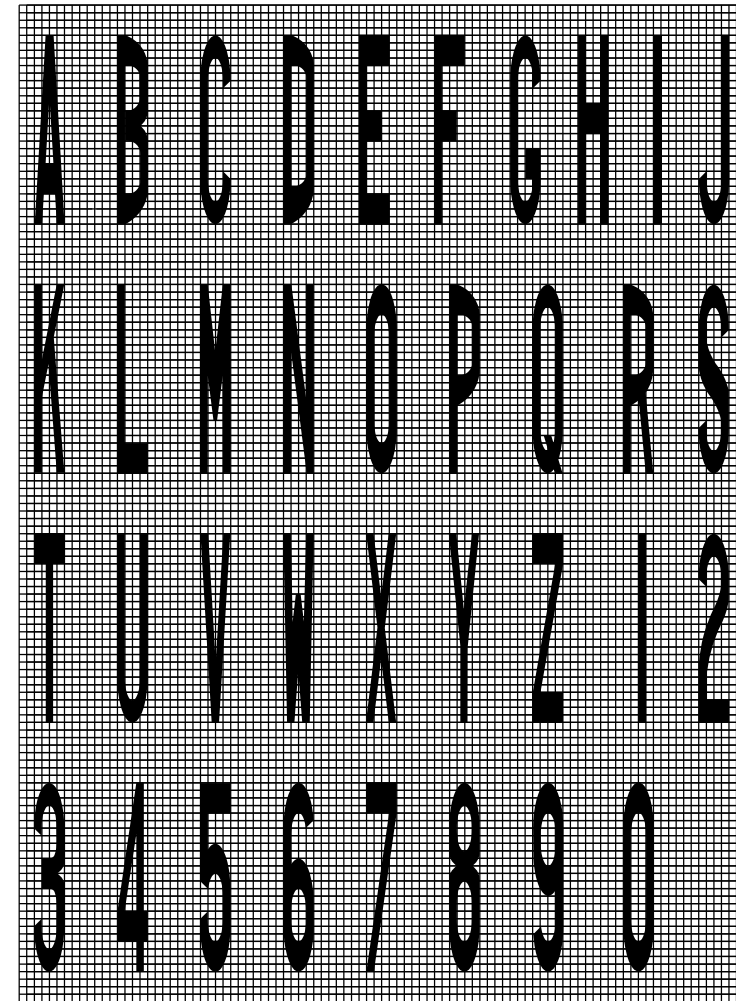

LEGEND HEIGHT	ARROW SIZE	o
6'	SMALL	2.9
8'	LARGE	3.8

THE SPACE BETWEEN ADJACENT LETTERS OR NUMERALS SHOULD BE APPROXIMATELY 3' FOR 6' LEGEND AND 4' FOR 8' LEGEND.

LETTER AND ARROW GRID SCALE

780-20

FILE NAME =	USER NAME = *USER*	DESIGNED -	REVISED -	STATE OF ILLINOIS DEPARTMENT OF TRANSPORTATION	SCHEDULE OF QUANTITIES		F.A. RTE.	SECTION	COUNTY	TOTAL SHEETS	SHEET NO.
*FILE#		DRAWN -	REVISED -				1252	IR-41RS-3	BUREAU	9	8
	PLOT SCALE = *SCALE*	CHECKED -	REVISED -		SCALE: _____ SHEET NO. ___ OF ___ SHEETS STA. _____ TO STA. _____		CONTRACT NO. 66A73		ILLINOIS FED. AID PROJECT		
	PLOT DATE = *DATE*	DATE -	REVISED -								

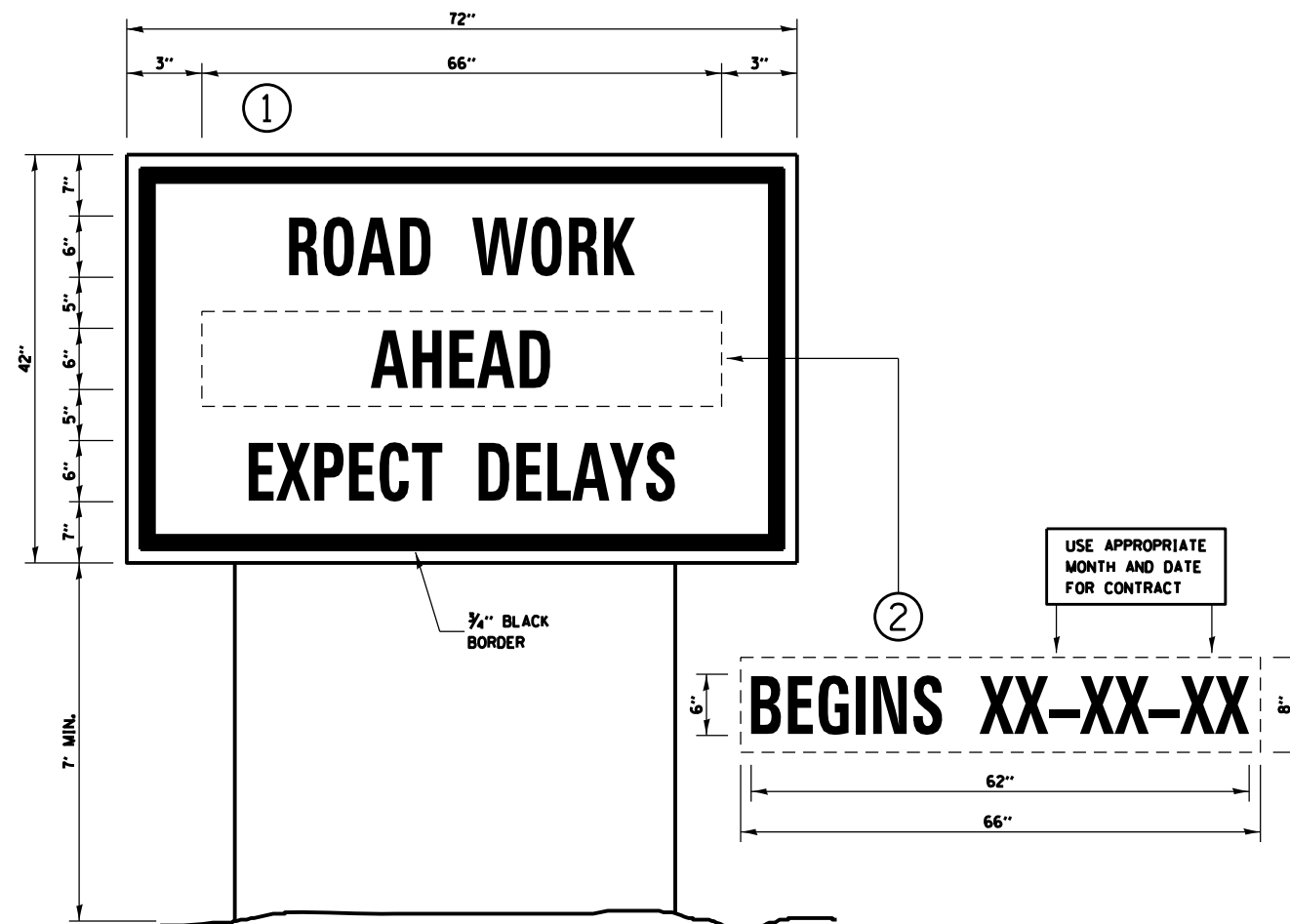

TEMPORARY INFORMATION SIGNING

NOTES:

1. USE 6" D BLACK LETTERING ON FLOURESENT ORANGE BACKGROUND.
2. ERECT SIGNS AT LOCATIONS IN ADVANCE OF THE "ROAD CONSTRUCTION AHEAD" SIGNS AS DIRECTED BY THE ENGINEER.
3. ERECT SIGN ① WITH INSTALLED PANEL ② A MINIMUM OF ONE WEEK PRIOR TO THE START OF THE LANE CLOSURE.
4. REMOVE PANEL ② ON THAT DATE.
5. SEE SPECIAL PROVISION "TEMPORARY INFORMATION SIGNING" FOR ADDITIONAL INFORMATION.
6. WILL BE PAID FOR PER 50 FT AS "TEMPORARY INFORMATION SIGNING". EACH SIGN = 21 50 FT AND THE DATE PANEL ② WILL NOT BE MEASURED SEPARATELY FOR PAYMENT.

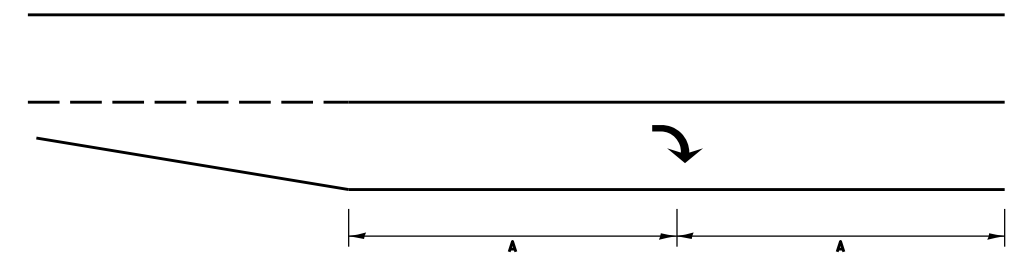

RIGHT TURN LANE AT THE IL 89 INTERSECTION

FILE NAME =	USER NAME = *USER*	DESIGNED -	REVISED -	STATE OF ILLINOIS DEPARTMENT OF TRANSPORTATION	SCHEDULE OF QUANTITIES		F.A. RTE.	SECTION	COUNTY	TOTAL SHEETS	SHEET NO.	
FILE#		DRAWN -	REVISED -		SCALE:	SHEET NO. OF SHEETS	STA. TO STA.	1252	IR-4RS-3	BUREAU	9	9
		CHECKED -	REVISED -					CONTRACT NO. 66A73		ILLINOIS FED. AID PROJECT		
		DATE -	REVISED -									