

NOTE:
 OLD PLANS INDICATE THERE MAY BE BURIED PIPES TIED INTO THE INLETS AT APPROX. STA. 611+60. UPON FIELD INVESTIGATION THE RESIDENT MAY ELECT TO HAVE THE CONTRACTOR EXCAVATE DEEP ENOUGH TO INTERCEPT AND OUTLET THEM TO THE DITCH ON EITHER SIDE. THE LABOR AND MATERIALS FOR THE WORK SHALL BE PAID IN ACCORDANCE TO ART. 109.04 OF THE STANDARD SPECIFICATIONS FOR ROAD AND BRIDGE CONSTRUCTION.

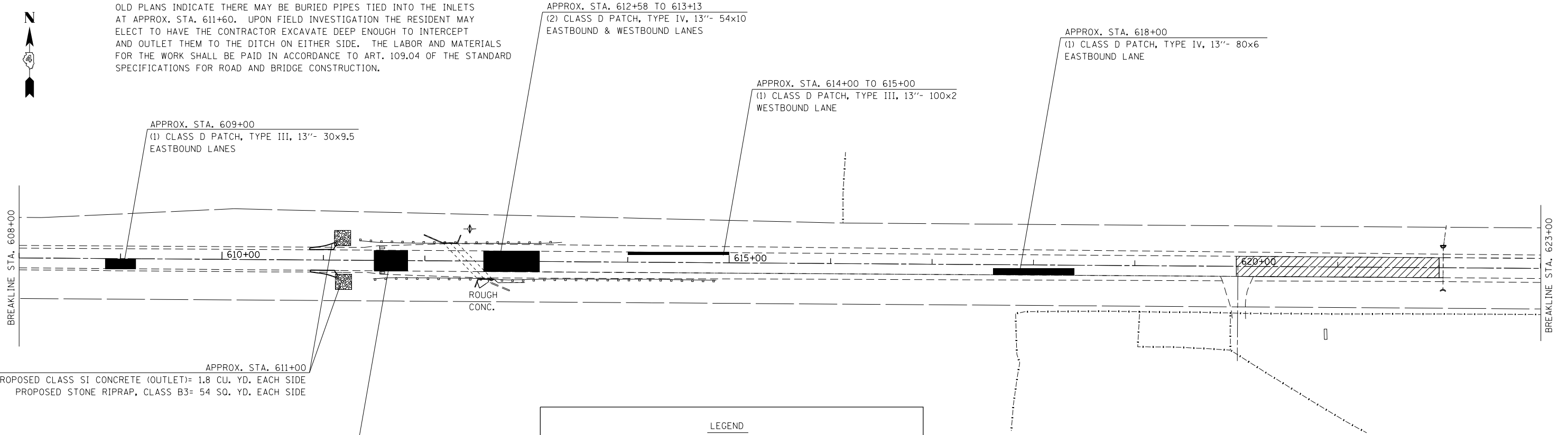

APPROX. STA. 611+00
 PROPOSED CLASS SI CONCRETE (OUTLET)= 1.8 CU. YD. EACH SIDE
 PROPOSED STONE RIPRAP, CLASS B3= 54 SQ. YD. EACH SIDE

APPROX. STA. 611+50 TO 611+85
 (2) CLASS D PATCH, TYPE IV, 13'-33x10
 EASTBOUND & WESTBOUND LANES

LEGEND

- CLASS D PATCH, TYPE III, 13" & TYPE IV, 13"
- HMA SURFACE REMOVAL, 1 3/4" (ONLY IN GUTTER SECTIONS)
 HMA SURFACE COURSE, MIX "D", N50- 2"
- SUB-BASE GRANULAR MATERIAL, TYPE B 12"
- GEOTECHNICAL FABRIC FOR GROUND STABILIZATION
- PIPE UNDERDRAINS 6"
- STONE RIPRAP, CLASS B3

NOTE: SEE SCHEDULE OF QUANTITIES FOR A LIST OF PAY ITEMS AND APPROX. LOCATIONS

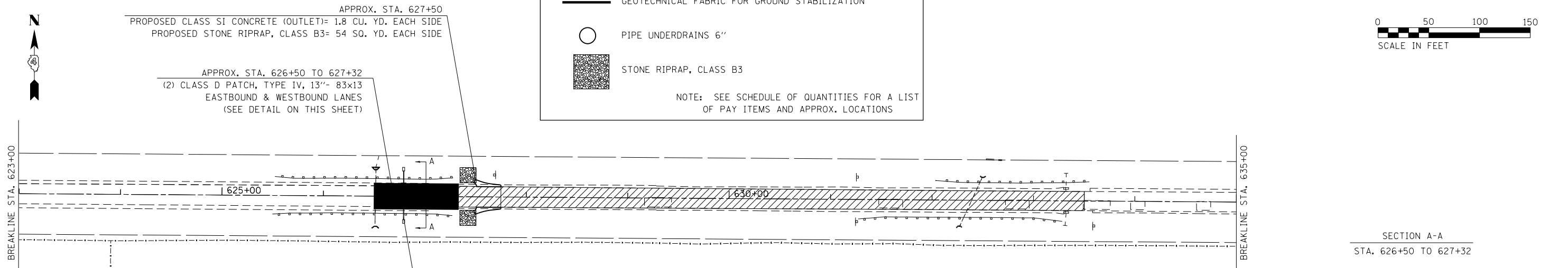
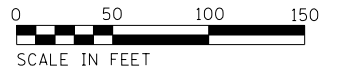

THE EXISTING PIPES WITHIN THE INLETS TO BE REMOVED SHALL BE CONNECTED TO THE 6" PIPE UNDERDRAIN OR OUTLETTED TO THE DITCH. THE LABOR AND MATERIAL NEEDED TO ACCOMPLISH THIS SHALL BE PAID IN ACCORDANCE TO ART. 109.04 OF THE STANDARD SPECIFICATIONS FOR ROAD AND BRIDGE CONSTRUCTION.

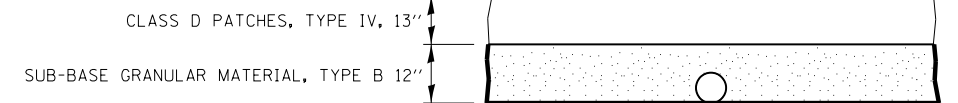

FILE NAME = D488778-SHT-REMOVAL.dgn	USER NAME = aubreys	DESIGNED -	REVISED -
		DRAWN -	REVISED -
	PLOT SCALE = 100.0000' / 1".	CHECKED -	REVISED -
Default	PLOT DATE = 5/16/2014	DATE -	REVISED -

**STATE OF ILLINOIS
 DEPARTMENT OF TRANSPORTATION**

GENERAL PLAN			
SCALE:	SHEET	OF SHEETS	STA. TO STA.

F.A.S. RTE.	SECTION	COUNTY	TOTAL SHEETS	SHEET NO.
379	(101,111)RS-3	KNOX	33	16
CONTRACT NO. 68B98				
ILLINOIS FED. AID PROJECT				