

PROPOSED PAVEMENT MARKING ENDS AT LIMIT OF OVERLAY  
STA. 475+00

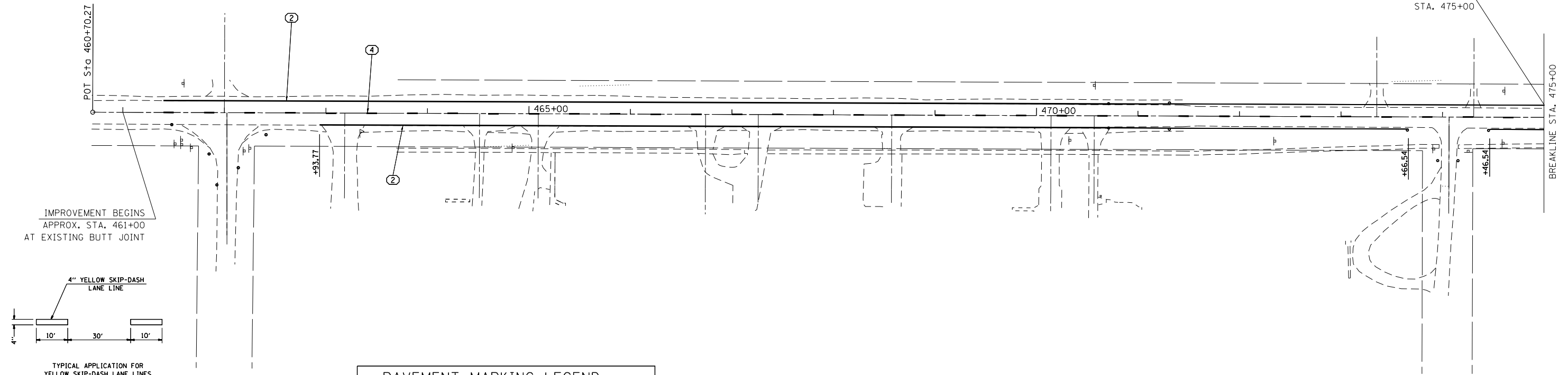

IMPROVEMENT BEGINS  
APPROX. STA. 461+00  
AT EXISTING BUTT JOINT

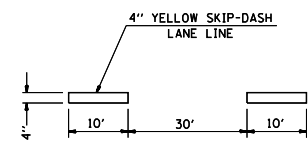

TYPICAL APPLICATION FOR  
YELLOW SKIP-DASH LANE LINES

**DETAIL**

**PAVEMENT MARKING LEGEND**

- ① 4" SOLID (YELLOW) - SEE TYPICAL SECTIONS FOR OFFSET
- ② 4" SOLID (WHITE) - 12' OFFSET
- ③ 4" DOUBLE (YELLOW)
- ④ 4" SKIP DASH (YELLOW) (SEE DETAIL)

NO PROPOSED PAVEMENT MARKING IN THIS AREA

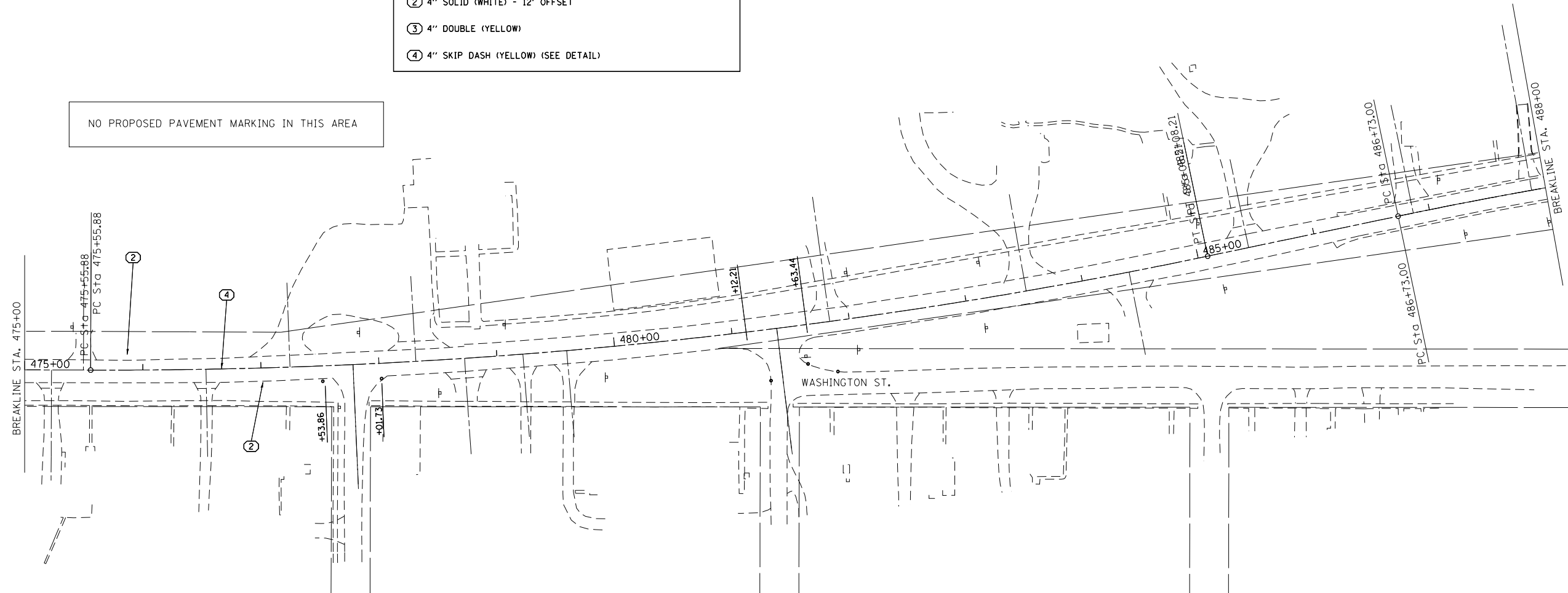

FILE NAME =  
D488778-SHT-PMK.dgn  
Default

USER NAME = aubreys  
PLOT SCALE = 100.0000' / 1" =  
PLOT DATE = 5/16/2014

DESIGNED -  
DRAWN -  
CHECKED -  
DATE -

REVISED -  
REVISED -  
REVISED -  
REVISED -

**STATE OF ILLINOIS  
DEPARTMENT OF TRANSPORTATION**

**PROPOSED PAVEMENT MARKINGS**

SCALE: SHEET OF SHEETS STA. TO STA.

F.A.S RTE.	SECTION	COUNTY	TOTAL SHEETS	SHEET NO.
379	(101, 111)RS-3	KNOX	33	18
<b>CONTRACT NO. 68B98</b>				
ILLINOIS FED. AID PROJECT				