

PROTECTIVE SHIELD
39'-2" X 6'-0"

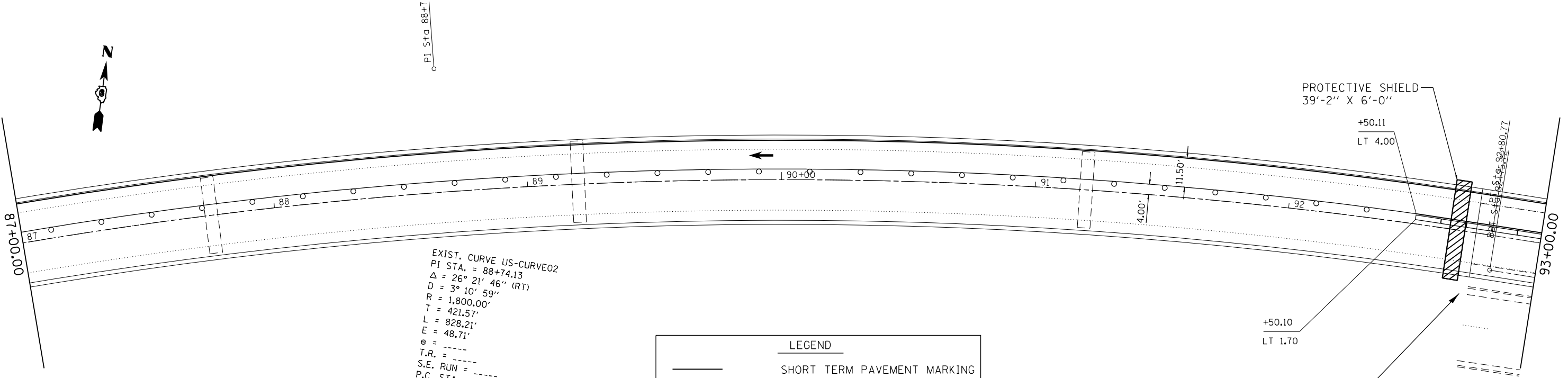
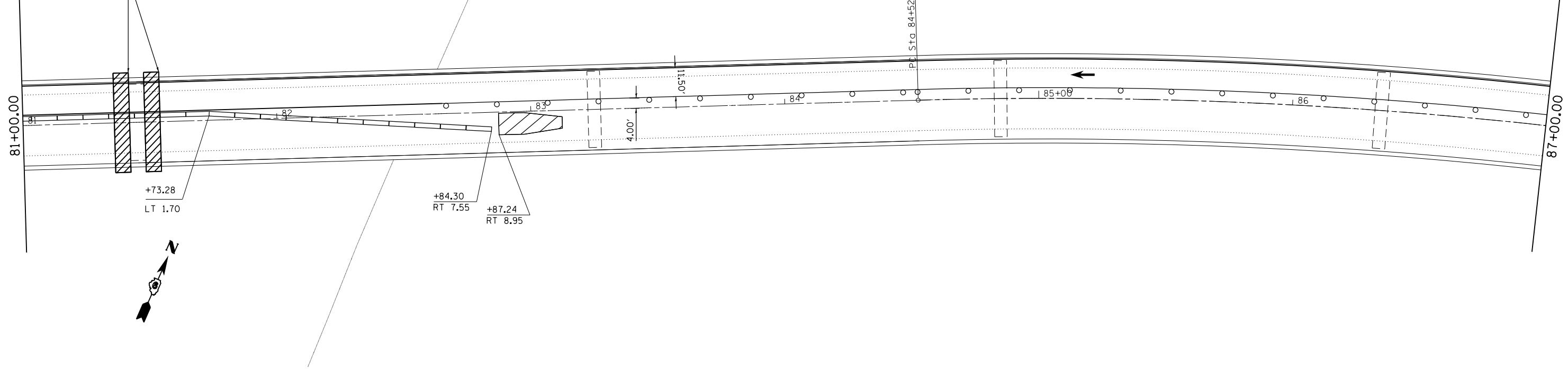

EXIST. CURVE US-CURVE02
PI STA. = 88+74.13
 $\Delta = 26^\circ 21' 46''$ (RT)
 $D = 3^\circ 10' 59''$
 $R = 1,800.00'$
 $T = 421.57'$
 $L = 828.21'$
 $E = 48.71'$
 $e =$
 $T.R. =$
 $S.E. RUN =$
P.C. STA. = 84+52.56
P.T. STA. = 92+80.77

LEGEND	
	SHORT TERM PAVEMENT MARKING
	CONSTRUCTION BARREL
	TYPE III BARRICADE
	TEMPORARY CONCRETE BARRIER
	IMPACT ATTENUATOR

NOTE: TRAFFIC CONTROL AND PROTECTION STANDARD 701201
NEEDED ON OLD US 24 WHEN WORKING ON EAST ABUTMENT.

FILE NAME =	USER NAME = sparksgw	DESIGNED -	REVISED -
ei:\pw\work\pilot\sparksgw\0381163\0672080-sht-staging2.dgn		DRAWN -	REVISED -
Default	PLOT SCALE = 40.0000' / in.	CHECKED -	REVISED -
	PLOT DATE = May-12-2014 08:59:04AM	DATE -	REVISED -

STATE OF ILLINOIS
DEPARTMENT OF TRANSPORTATION

STAGE 2 TRAFFIC CONTROL

SCALE: SHEET 4 OF 5 SHEETS STA. TO STA.

F.A.P. RTE.	SECTION	COUNTY	TOTAL SHEETS	SHEET NO.
63	(1Z-B)BJR,I-7	ADAMS	31	15
CONTRACT NO. 72G80			ILLINOIS FED. AID PROJECT	