

STATE OF ILLINOIS
 DEPARTMENT OF TRANSPORTATION
 DIVISION OF HIGHWAYS
**PROPOSED
 HIGHWAY PLANS**

FAS 1741 (FR I-55 WEST)
 SECTION (116)RS

PATCHING, 3P RESURFACING
 MONTGOMERY COUNTY

C-96-077-14

F.A.S. RTE. 1741	SECTION ***	COUNTY MONTGOMERY	TOTAL SHEETS 14	SHEET NO. 1
		ILLINOIS	CONTRACT NO. 72H06	

*** (116) RS

- INDEX OF SHEETS**
- 1 COVER SHEET
 - 2 GENERAL NOTES
 - 3-4 SUMMARY OF QUANTITIES
 - 5 SCHEDULE OF QUANTITIES
 - 6 TYPICAL SECTIONS
 - 7-10 PLAN SHEET
 - 11-14 DETAILS

STANDARDS

- 442201-03
- 701901-03
- 780001-04
- 781001-03
- BLR21-9
- BLR22-7

WHEREVER IN THESE PLANS SECTION D6 SPRING RD REPAIR 2014-4 IS MENTIONED, IT SHALL MEAN SECTION (116)RS

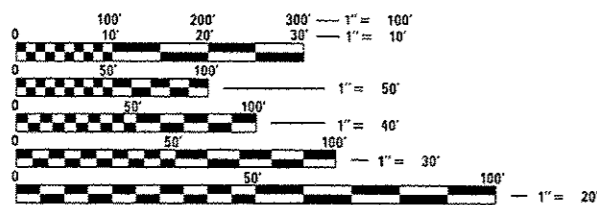
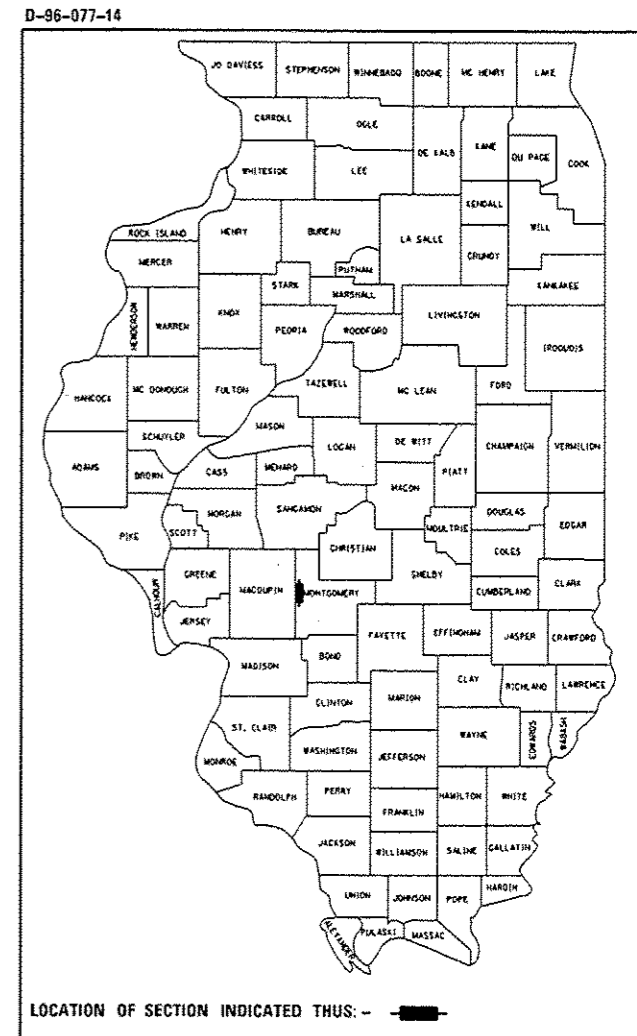

FULL SIZE PLANS HAVE BEEN PREPARED USING STANDARD ENGINEERING SCALES. REDUCED SIZED PLANS WILL NOT CONFORM TO STANDARD SCALES. IN MAKING MEASUREMENTS ON REDUCED PLANS, THE ABOVE SCALES MAY BE USED.

J.U.L.I.E.
 JOINT UTILITY LOCATION INFORMATION FOR EXCAVATION
 1-800-892-0123
 OR 811

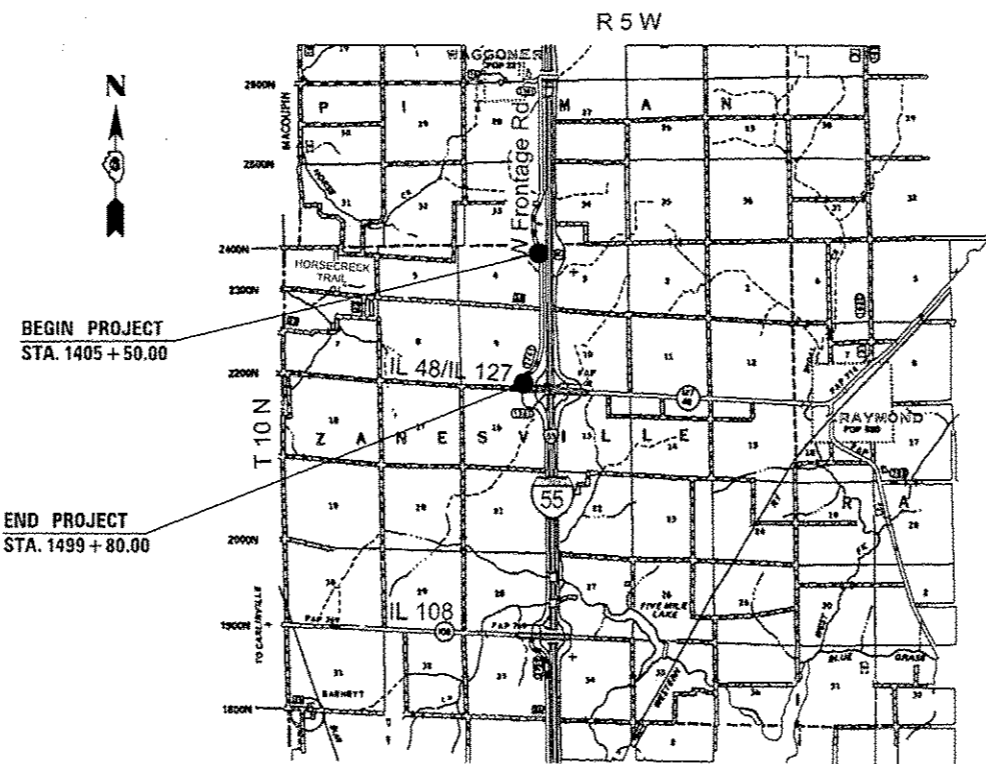

LOCATION MAP

GROSS LENGTH = 9,430.00 FT. = 1.786 MILE
 NET LENGTH = 9,430.00 FT. = 1.786 MILE

TRAFFIC COUNT

ADT = 450(2010)
 PV = N/A
 SU = N/A
 MU = N/A

STATE OF ILLINOIS
 DEPARTMENT OF TRANSPORTATION
 DIVISION OF HIGHWAYS

SUBMITTED May 21 2014
Raja Z. Smith
 DEPUTY DIRECTOR OF HIGHWAYS, REGION ENGINEER

June 07 2014
John D. Baranzoli, PE, BS
 ENGINEER OF DESIGN AND ENVIRONMENT

June 27 2014
Chris Osman, PE, BS
 DIRECTOR OF HIGHWAYS, CHIEF ENGINEER

SENIOR TEAM ENGINEER: MARK DUST (217) 785-0597
 TEAM MANAGER: JARED MARTIN (217) 524-0064

CONTRACT NO. 72H06

PRINTED BY THE AUTHORITY
 OF THE STATE OF ILLINOIS

GENERAL NOTES

1. ANY REFERENCE TO A STANDARD IN THESE PLANS SHALL BE INTERPRETED TO MEAN THE EDITION AS INDICATED BY THE SUB NUMBER LISTED IN THE INDEX OF SHEETS OR THE COPY OF THE STANDARD INCLUDED IN THESE PLANS.
2. IN ADDITION TO FIELD SURVEYS, PLAN DIMENSIONS AND DETAILS RELATIVE TO THE EXISTING FACILITIES HAVE BEEN TAKEN FROM EXISTING PLANS AND ARE SUBJECT TO CONSTRUCTION VARIATIONS. IT SHALL BE THE CONTRACTOR'S RESPONSIBILITY TO VERIFY SUCH DIMENSIONS AND DETAILS IN THE FIELD. SUCH VARIATIONS SHALL NOT BE A CAUSE FOR ADDITIONAL COMPENSATION DUE TO A CHANGE IN THE SCOPE OF WORK; HOWEVER, THE CONTRACTOR WILL BE PAID FOR THE QUANTITY ACTUALLY FURNISHED AT THE UNIT PRICE BID FOR THE WORK.
3. ACCESS TO ALL ENTRANCES AND SIDE ROADS SHALL BE MAINTAINED AT ALL TIMES.
4. THE CONTRACTOR SHALL BE RESPONSIBLE FOR PROTECTING UTILITY PROPERTY FROM CONSTRUCTION OPERATIONS, AS OUTLINED IN ARTICLE 107.31 OF THE STANDARD SPECIFICATIONS. THE J.U.L.I.E. NUMBER IS 1-800-892-0123. A MINIMUM OF 48 HOURS ADVANCE NOTICE IS REQUIRED.
5. THE THICKNESS OF BITUMINOUS MIXTURES SHOWN ON THE PLANS IS THE NOMINAL THICKNESS. DEVIATIONS FROM THE NOMINAL THICKNESS WILL BE PERMITTED WHEN SUCH DEVIATIONS OCCUR DUE TO IRREGULARITIES IN THE EXISTING SURFACE OR BASE ON WHICH THE BITUMINOUS MIXTURE IS PLACED.
6. ALL SAW CUTS, NECESSARY TO COMPLETE THE WORK DETAILED IN THESE PLANS, SHALL BE INCLUDED IN THE COST FOR THE VARIOUS PAY ITEMS INVOLVED. THE MINIMUM SAW CUT DEPTH IN THE PAVEMENT SHALL BE 1 1/2 " UNLESS OTHERWISE SPECIFIED IN A DETAIL SHOWN IN THE PLANS.
7. UNLESS DIRECTED BY THE ENGINEER, PAVEMENT MARKING LINES SHALL NOT BE LAID DIRECTLY OVER A LONGITUDINAL CRACK OR JOINT NOR OVER A TAR OR ASPHALT PAINTED LINE. THE EDGE OF A CENTERLINE OR LANE LINE SHALL BE OFFSET A MINIMUM DISTANCE OF 2" FROM A LONGITUDINAL CRACK OR JOINT. EDGE LINES SHALL BE APPROXIMATELY 2" FROM THE EDGE LINE OF PAVEMENT. SEE SECTION 780 OF THE STANDARD SPECIFICATIONS FOR TRAFFIC CONTROL ITEMS.
8. NO PASSING ZONES TO BE FIELD VERIFIED BY THE BUREAU OF OPERATIONS. THE RESIDENT ENGINEER SHALL NOTIFY THE BUREAU OF OPERATIONS AT LEAST 14 DAYS PRIOR TO PLACEMENT OF FINAL PERMANENT PAVEMENT MARKING. (PH: 217-785-5312)
9. THE FOLLOWING RATES OF APPLICATION HAVE BEEN USED TO CALCULATE THE PLAN QUANTITIES:

BITUMINOUS MATERIALS (PRIME COAT)	0.00038 TON/SQ. YD. (ON PAVEMENT)
BITUMINOUS MATERIALS (PRIME COAT)	0.001425 TON/SQ. YD. (ON AGG.)
AGGREGATE PRIME COAT	0.002 TON/SQ. YD.
BITUMINOUS CONCRETE SURFACE / BINDER	0.056 TON/SQ. YD. PER 1"
AGGREGATE MATERIAL	2.05 TON/CU. YD.
10. THE EXISTING ROAD SIGNS THAT INTERFERE WITH CONSTRUCTION WILL BE REMOVED OR RELOCATED AS DIRECTED BY THE ENGINEER. AFTER THE CONSTRUCTION IS COMPLETED, THE CONTRACTOR WILL REPLACE THE SIGNS AS DIRECTED BY THE ENGINEER. THIS WORK WILL NOT BE PAID SEPARATELY BUT SHALL BE CONSIDERED INCLUDED IN THE CONTRACT, AND NO COMPENSATION WILL BE ALLOWED.
11. WHERE SECTION OR SUBSECTION MONUMENTS ARE ENCOUNTERED THE ENGINEER SHALL BE NOTIFIED BEFORE SUCH MONUMENTS ARE REMOVED. THE CONTRACTOR SHALL PROTECT AND CAREFULLY PRESERVE ALL MONUMENTS UNTIL AN AUTHORIZED SURVEYOR OR AGENT HAS WITNESSED OR OTHERWISE REFERENCED THEIR LOCATION. THE CONTRACTOR SHALL BE RESPONSIBLE FOR HAVING AN AUTHORIZED SURVEYOR REESTABLISH ANY SECTION OR SUBSECTION MONUMENTS DESTROYED BY HIS OPERATIONS.

COMMITMENTS

1. THE RESIDENT ENGINEER SHALL CONTACT STUDIES & PLANS CONCERNING ANY MAJOR PLAN CHANGE TO MAKE SURE NO PREVIOUS COMMITMENTS (NOT LISTED) WERE MADE AFFECTING THE DESIGN AND ALLOW AN IMPROVED DESIGN FOR FUTURE PROJECTS.

THE FOLLOWING MIXTURE REQUIREMENTS ARE APPLICABLE FOR THIS PROJECT:

MIXTURE USE(S):	HMA SURFACE COURSE/ INCIDENTAL HMA	HMA BINDER COURSE	PATCHING
PG:	PG 64-22	PG 64-22	PG 64-22
DESIGN AIR VOIDS:	4.0% @ N 50	4.0% @ N 50	4.0% @ N 50
MIXTURE COMPOSITION: (GRADATION MIXTURE)	IL 9.5	IL 19.0	IL 19.0
FRICTION AGGREGATE:	MIX "C"	N/A	N/A
QUALITY MANAGEMENT	QC/OA	QC/OA	QC/OA

DISTRICT SIX	
EXAMINED	May 20th 20 14
<i>John C. Williams</i>	
OPERATIONS ENGINEER	
EXAMINED	May 20 20 14
<i>John C. Williams</i>	
PROJECT IMPLEMENTATION ENGINEER	
EXAMINED	May 16 20 14
<i>John C. Williams</i>	
PROGRAM DEVELOPMENT ENGINEER	

SUMMARY OF QUANTITIES				CONSTR. CODE	
CODE NO.	ITEM	UNIT	TOTAL QUANTITY	100% STATE FRONTAGE ROAD	
				0005	RURAL
35800100	PREPARATION OF BASE	SO YD	101	101	
40200800	AGGREGATE SURFACE COURSE, TYPE B	TON	6	6	
40600275	BITUMINOUS MATERIALS (PRIME COAT)	POUND	17,169	17,169	
40600982	HOT-MIX ASPHALT SURFACE REMOVAL - BUTT JOINT	SO YD	118	118	
40600985	PORTLAND CEMENT CONCRETE SURFACE REMOVAL - BUTT JOINT	SO YD	150	150	
40603080	HOT-MIX ASPHALT BINDER COURSE, IL-19.0, N50	TON	3218	3218	
40603310	HOT-MIX ASPHALT SURFACE COURSE, MIX "C", N50	TON	2102	2102	
40800050	INCIDENTAL HOT-MIX ASPHALT SURFACING	TON	60	60	
48101200	AGGREGATE SHOULDERS, TYPE B	TON	2763	2763	
67100100	MOBILIZATION	L SUM	1	1	
70101830	TRAFFIC CONTROL AND PROTECTION, STANDARD BLR 21	L SUM	1	1	
70101835	TRAFFIC CONTROL AND PROTECTION, STANDARD BLR 22	L SUM	1	1	
70106800	CHANGEABLE MESSAGE SIGN	CAL MO	1	1	
* 78001120	PAINT PAVEMENT MARKING - LINE 5"	FOOT	21218	21218	

* SPECIALTY ITEM

*
14

FILE NAME =	USER NAME = ssparkgn	DESIGNED -	REVISED -	STATE OF ILLINOIS DEPARTMENT OF TRANSPORTATION	SUMMARY OF QUANTITIES				F.A.S. RTE.	SECTION	COUNTY	TOTAL SHEETS	SHEET NO.
c:\p\work\p\dot\sparkgn\0347716\067	H08-ehs-500.dgn	DRAWN -	REVISED -						1743	***	MONTGOMERY	14	3
Default	PLOT SCALE = 100.0000 / 1/4"	CHECKED -	REVISED -		SCALE: SHEET OF SHEETS STA. TO STA.				CONTRACT NO. 7ZH06				
	PLOT DATE = May-28-2014 11:29:46AM	DATE -	REVISED -		ILLINOIS FED. AID PROJECT *** 06 SPRING RD REPAIR 2014-4								

SUMMARY OF QUANTITIES				CONSTR. CODE
CODE NO.	ITEM	UNIT	TOTAL QUANTITY	100% STATE FRONTAGE ROAD
				0005 RURAL
X4406030	PARTIAL DEPTH REMOVAL, TYPE I, 3"	SQ YD	182	182
X4406230	PARTIAL DEPTH REMOVAL, TYPE II, 3"	SQ YD	1970	1970
X4406430	PARTIAL DEPTH REMOVAL, TYPE III, 3"	SQ YD	160	160
X4421000	PARTIAL DEPTH PATCHING	TON	388	388

FILE NAME :	USER NAME : sparkgr	DESIGNED -	REVISED -	STATE OF ILLINOIS DEPARTMENT OF TRANSPORTATION	SUMMARY OF QUANTITIES					F.A.S. RTE.	SECTION	COUNTY	TOTAL SHEETS	SHEET NO.
c:\pwork\p\dot\sparkgr\0397716\067	06-shl-500.dgn	DRAWN -	REVISED -		1741	***	MONTGOMERY	14	4					
	PLOT SCALE = 100.0000' / 1" =	CHECKED -	REVISED -							CONTRACT NO. 72H06				
Default	PLOT DATE = May-20-2014 11:29:47AM	DATE -	REVISED -		SCALE:	SHEET OF	SHEETS	STA. TO STA.	ILLINOIS FED. AID PROJECT					

AGGREGATE SHOULDERS TYPE B			
LOCATION STATION TO STATION	LENGTH (FT)	WIDTH (FT)	(TONS)
FAS 1741 (FR I-55 WEST)			
LEFT			
STA. 1405+50.00 TO STA. 1499+80.00	9,430.00	6	1381.5
RIGHT			
STA. 1405+50.00 TO STA. 1499+80.00	9,430.00	6	1381.5
TOTAL			2,763.0

PAVEMENT MARKING							
LOCATION STATION TO STATION	DESCRIPTION	LENGTH (FT)	SPACING	LINE-5"		YELLOW (FT)	WHITE (FT)
FAS 1741 (FR I-55 WEST)							
STA. 1405+50.00 TO STA. 1499+80.00	SKIP-DASH (CENTER)	9430.00	10' @ 40'			2,358.00	-
STA. 1405+50.00 TO STA. 1499+80.00	SOLID (EDGE LINE RT)	9430.00	-			-	9,430.00
STA. 1405+50.00 TO STA. 1499+80.00	SOLID (EDGE LINE LT)	9430.00	-			-	9,430.00
TOTAL						2,358.00	18,860.00

PAVEMENT SCHEDULE								
LOCATION STATION TO STATION	LENGTH	WIDTH	PCC SURF. REM. BUTT-JOINT (SQ YD)	HMA SURF. REM. BUTT-JOINT (SQ YD)	HMA BINDER COURSE IL-19.0 N50 (2 1/4") (TON)	HMA SURF. COURSE MIX "C" N50 (1 1/2") (TON)	BIT. MAT. PRIME CT. (TON)	
FAS 1741 (FR I-55 WEST)								
STA. 1405+50.00 TO STA. 1406+25.00	75.00	24	200.00	-	25.20	16.80	0.15	
STA. 1406+25.00 TO STA. 1499+05.00	9280.00	24	-	-	3118.10	2078.70	9.35	
STA. 1499+05.00 TO STA. 1499+80.00	75.00	24	-	200.00	25.20	16.80	0.15	
TOTAL			200.00	200.00	3244.00***	2112.30	9.65	

***75 TONS OF HMA BINDER COURSE, IL-19.0, N50 ADDED TO QUANTITY FOR SUPER ELEVATION ADJUSTMENT

SIDEROAD AND ENTRANCE SCHEDULE									
LOCATION FAS 1741 (FR I-55 WEST)	WIDTH ACROSS FRONT (FT)	WIDTH ACROSS BACK (FT)	LENGTH OF IMPROVEMENT FROM EOP (FT)	EXIST. SURF. TYPE	PREPARATION OF BASE (SQ YD)	PCC SURF. REM. BUTT-JOINT (SQ YD)	HMA SURF. REM. BUTT-JOINT (SQ YD)	INCIDENTAL HOT-MIX ASPH. SURF. (TON)	BIT. MAT. PRIME COAT (TON)
P.E. W/M.B.T. RT. STA. 1428+56	62	14	8	AGG	33.81	-	-	6.62	0.05
GOBY AVE. RT. STA. 1441+78	44	24	10	HMA	-	-	38.00	16.95	0.05
M.B.T. RT. STA. 1442+24	64	10	8	AGG	32.92	-	-	6.45	0.05
C.E. RT. STA. 1444+83	44	24	10	CONC	-	37.78	-	16.91	0.05
P.E. W/M.B.T. RT. STA. 1456+05	62	15	8	AGG	34.27	-	-	6.71	0.05
P.E. RT. STA. 1497+53	24	12	8	CONC	-	16.11	-	3.18	0.05
P.E. RT. STA. 1498+57	24	12	8	CONC	-	16.11	-	3.18	0.05
TOTAL					101.00	70.00	38.00	60.00	0.35

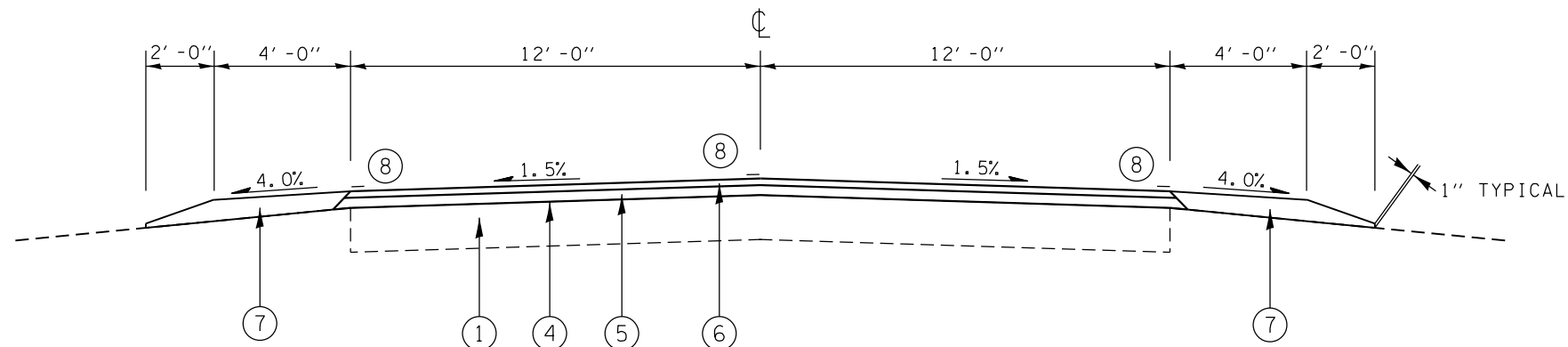

TYPICAL SECTION #1 - FR I-55 WEST
STA 1405+50.00 TO STA 1469+21.00

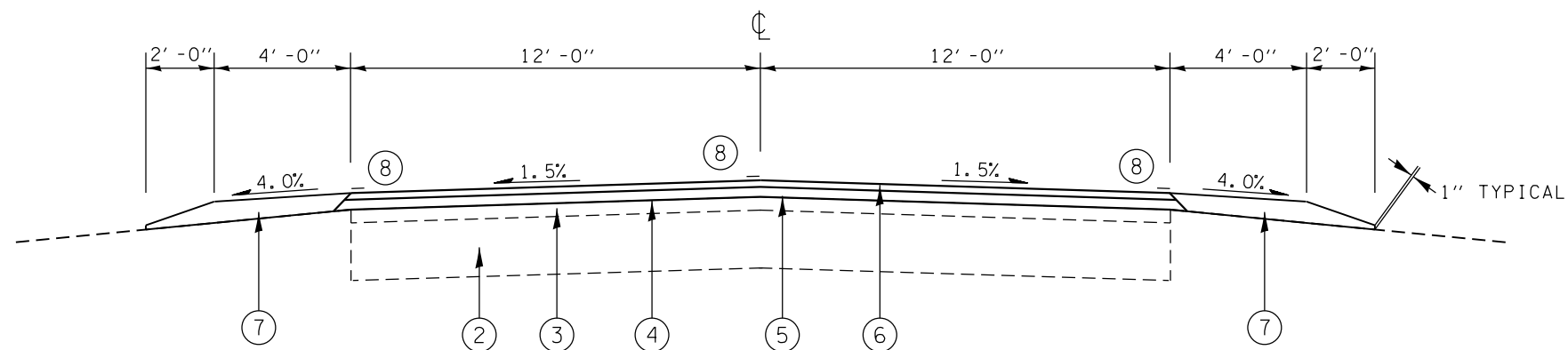

TYPICAL SECTION #2 - FR I-55 WEST
STA 1469+21.00 TO STA 1499+80.00

LEGEND

- ① EX PCC PAVEMENT, 10"
- ② EX AGGREGATE BASE COURSE TYPE A, 13"
- ③ EX BITUMINOUS MIXTURE, 3"
- ④ EX BITUMINOUS SURFACE TREATMENT, A-1
- ⑤ PR BINDER COURSE, IL 19.0, N50, 2 1/4"
- ⑥ PR HMA SURFACE MIX "C" N50, 1 1/2"
- ⑦ PR AGGREGATE SHOULDERS TYPE B
- ⑧ PR PAVEMENT MARKING, 5"

FILE NAME =	USER NAME = sparksgw	DESIGNED -	REVISED -	STATE OF ILLINOIS DEPARTMENT OF TRANSPORTATION	TYPICAL SECTIONS			F.A.S. RTE.	SECTION	COUNTY	TOTAL SHEETS	SHEET NO.	
Default	et:\pwork\pwork\sparksgw\10397716\0672\h06-sht-typical.dgn	DRAWN -	REVISED -		SCALE:	SHEET	OF	SHEETS	STA.	TO STA.	1741	6	
	PLOT SCALE = 40.0000' / in.	CHECKED -	REVISED -								MONTGOMERY	14	6
	PLOT DATE = May-20-2014 11:31:20AM	DATE -	REVISED -								CONTRACT NO. 72H06		



MATCHLINE 1418+50.00

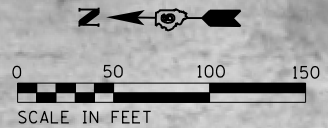

MATCHLINE 1418+50.00

MATCHLINE 1433+50.00

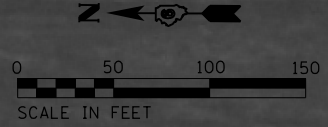

FILE NAME =	USER NAME = sparksgw	DESIGNED -	REVISED -	STATE OF ILLINOIS DEPARTMENT OF TRANSPORTATION	PLAN SHEET			F.A.S. RTE.	SECTION	COUNTY	TOTAL SHEETS	SHEET NO.	
Default	et:\pw\work\p\idot\sparksgw\140397716\0672H06-sht.pln.dgn	DRAWN -	REVISED -		SCALE:	SHEET	OF	SHEETS	STA.	TO	STA.	1741	7
		CHECKED -	REVISED -									14	7
		DATE -	REVISED -									CONTRACT NO. 72H06	



FILE NAME =	USER NAME = sparksgw	DESIGNED -	REVISED -
ci:\pw\work\p\idot\sparksgw\140397716\0672H06-sht.pln.dgn		DRAWN -	REVISED -
Default	PLOT SCALE = 100.0000' / in.	CHECKED -	REVISED -
	PLOT DATE = May-20-2014 11:31:37AM	DATE -	REVISED -

**STATE OF ILLINOIS
DEPARTMENT OF TRANSPORTATION**

PLAN SHEET			
SCALE:	SHEET	OF	SHEETS
	STA.	TO	STA.

F.A.S. RTE.	SECTION	COUNTY	TOTAL SHEETS	SHEET NO.
1741	***	MONTGOMERY	14	8
			CONTRACT NO. 72H06	
ILLINOIS FED. AID PROJECT				



FILE NAME =	USER NAME = sparksgw	DESIGNED -	REVISED -	STATE OF ILLINOIS DEPARTMENT OF TRANSPORTATION	PLAN SHEET			F.A.S. RTE.	SECTION	COUNTY	TOTAL SHEETS	SHEET NO.			
Default	et:\pw\work\pwidot\sparksgw\140397716\0672\h06-sht.pln.dgn	DRAWN -	REVISED -		SCALE:	SHEET	OF	SHEETS	STA.	TO STA.	1741	...	MONTGOMERY	14	9
	PLOT SCALE = 100.0000' / in.	CHECKED -	REVISED -										CONTRACT NO.	72H06	
	PLOT DATE = May-20-2014 11:31:45AM	DATE -	REVISED -										ILLINOIS FED. AID PROJECT		

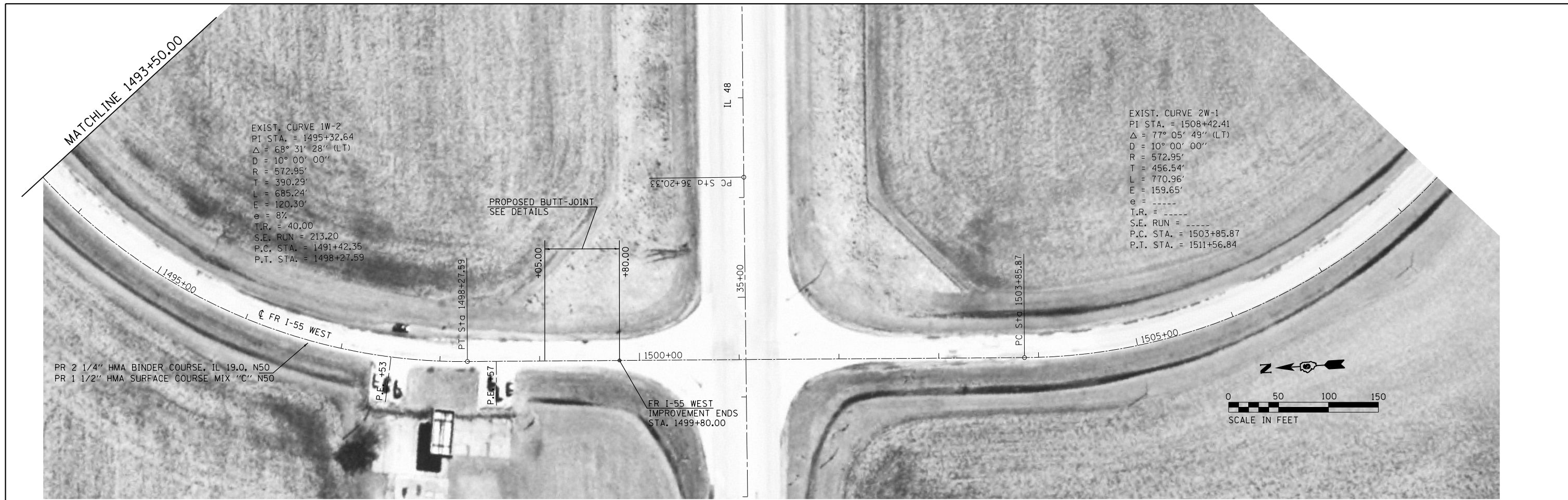

FILE NAME =	USER NAME = sparksgw	DESIGNED -	REVISED -	STATE OF ILLINOIS DEPARTMENT OF TRANSPORTATION	PLAN SHEET			F.A.S. RTE.	SECTION	COUNTY	TOTAL SHEETS	SHEET NO.
ci:\pw\work\p\idot\sparksgw\140397716\0672\06-sht-pln.dgn	PLOT SCALE = 100.0000' / in.	DRAWN -	REVISED -					1741	***	MONTGOMERY	14	10
Default	PLOT DATE = May-20-2014 11:31:55AM	CHECKED -	REVISED -		SCALE: SHEET OF SHEETS STA. TO STA.			CONTRACT NO. 72H06				
		DATE -	REVISED -		ILLINOIS FED. AID PROJECT							

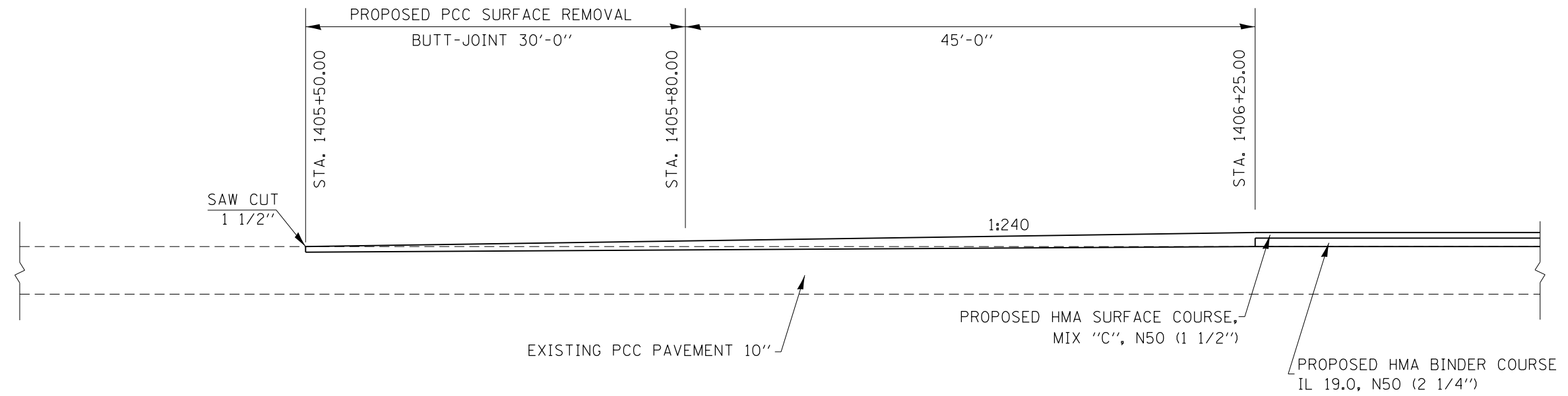

BUTT-JOINT DETAIL
 STA. 1405+50.00 TO 1406+25.00

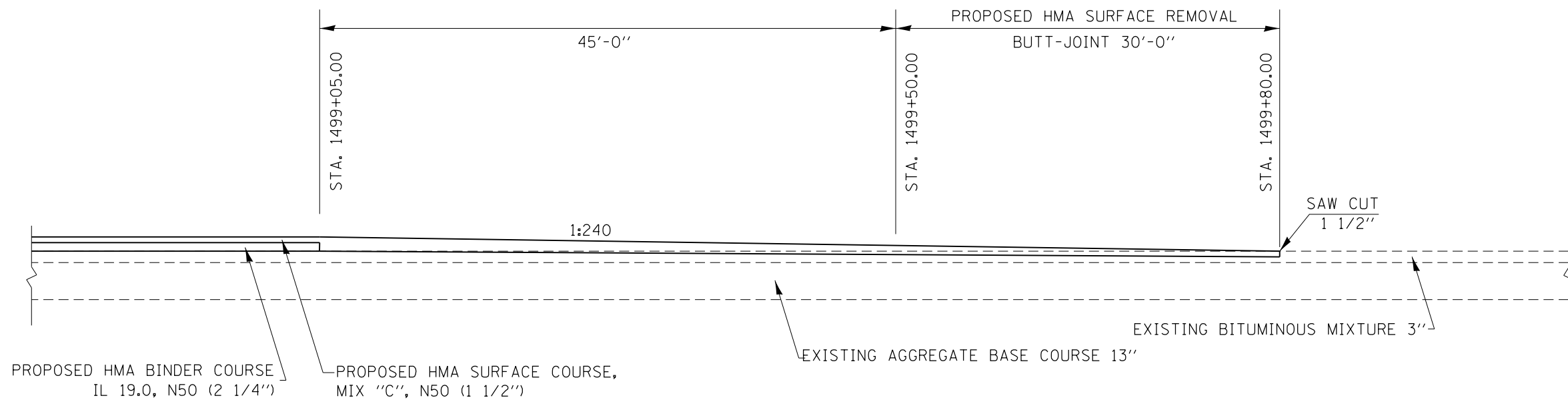

BUTT-JOINT DETAIL
 STA. 1499+05.00 TO 1499+80.00

FILE NAME =	USER NAME = sparksgw	DESIGNED -	REVISED -
ct:\pw\work\p\idot\sparksgw\140397716\0672\06-sht-detail.dgn		DRAWN -	REVISED -
Default	PLOT SCALE = 40.0000' / in.	CHECKED -	REVISED -
	PLOT DATE = May-20-2014 11:32:05AM	DATE -	REVISED -

**STATE OF ILLINOIS
 DEPARTMENT OF TRANSPORTATION**

BUTT-JOINT DETAILS			
SCALE:	SHEET	OF	SHEETS
STA.	TO STA.		

F.A.S. RTE.	SECTION	COUNTY	TOTAL SHEETS	SHEET NO.
1741	***	MONTGOMERY	14	11
CONTRACT NO.				
ILLINOIS FED. AID PROJECT				

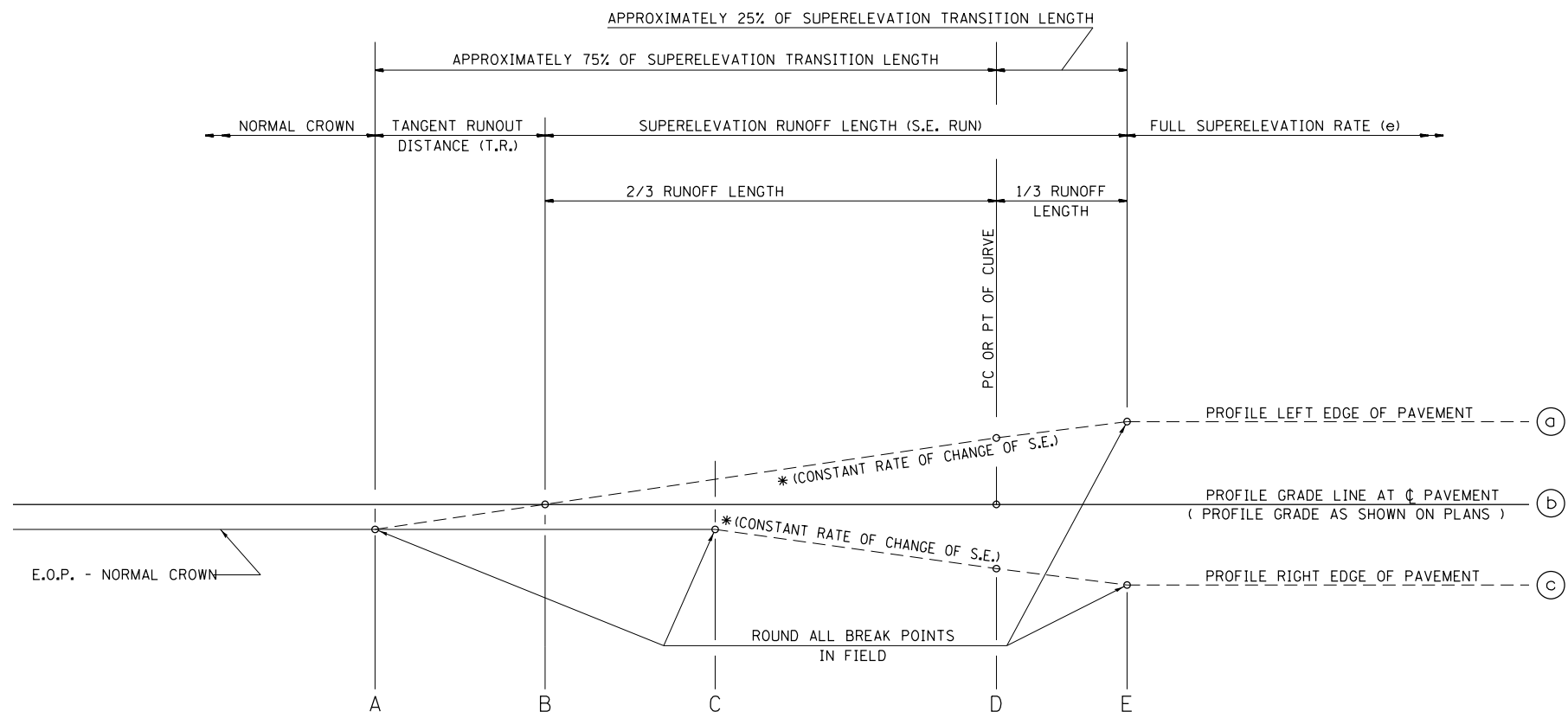

TYPICAL PROFILE - S.E. TRANSITION

SEE PLANS FOR CURVE DATA INFORMATION
 CURVE DATA
 P.I. STA=
 Δ =
 R=
 T=
 L=
 E=
 e= SUPERELEVATION RATE IN PERCENT
 T.R.= TANGENT RUNOUT DISTANCE
 S.E. RUN= SUPERELEVATION RUNOFF LENGTH
 P.C. STA=
 P.T. STA=

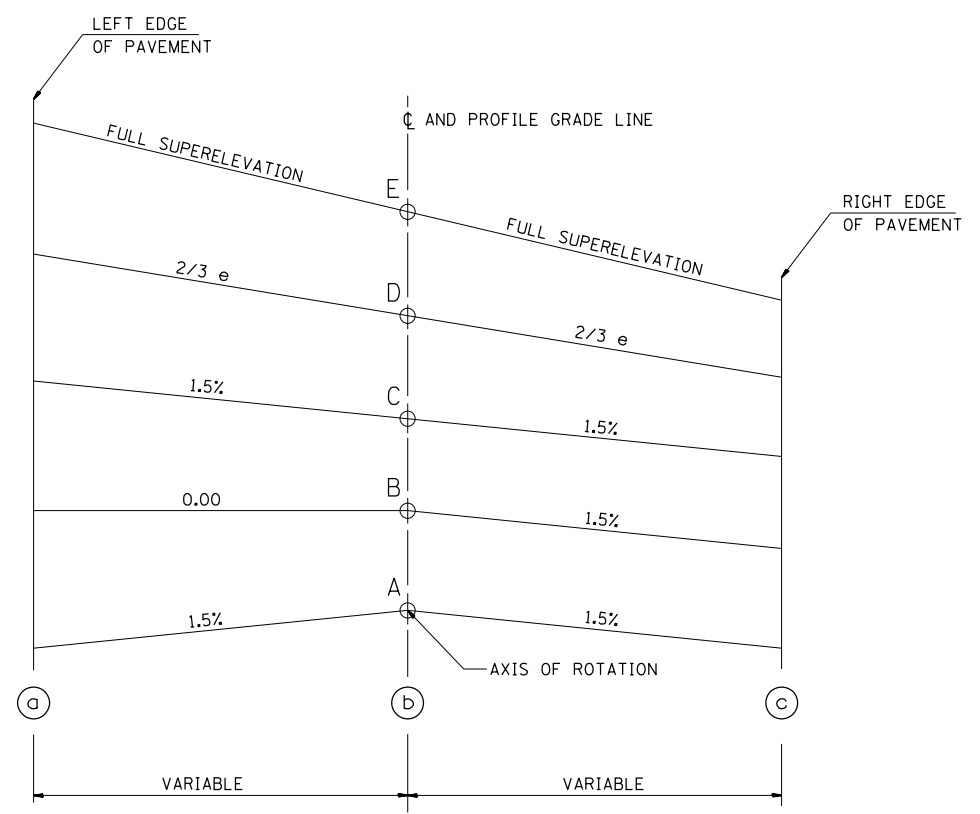

TYPICAL CROSS SECTION - S.E. TRANSITION

TABLE OF SUPERELEVATION BREAK POINT LOCATIONS							
CURVE NO.	e	A	B	C	D	E	TRANSITION
1W-1	6.0%	169+32.00	169+72.00	170+12.00	170+78.87	171+32.00	TRANS. IN
		186+60.00	186+20.00	185+80.00	185+13.01	184+60.00	TRANS. OUT
1W-2	6.0%	186+15.00	186+55.00	186+95.00	187+62.01	188+15.00	TRANS. IN
		195+94.00	195+54.00	195+14.00	194+47.25	193+94.00	TRANS. OUT

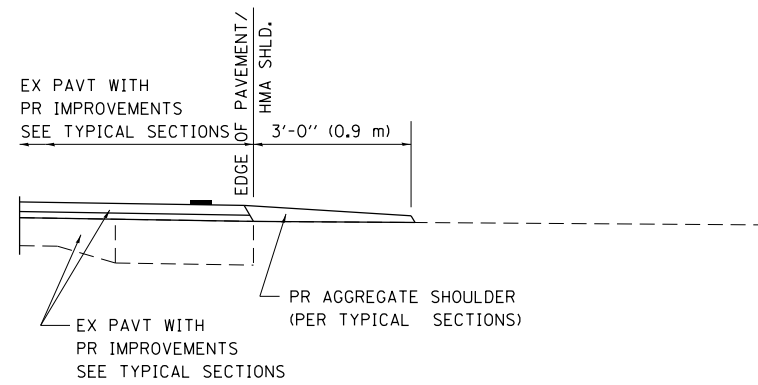

SECTION A-A FOR EX EARTH/ AGGREGATE FE

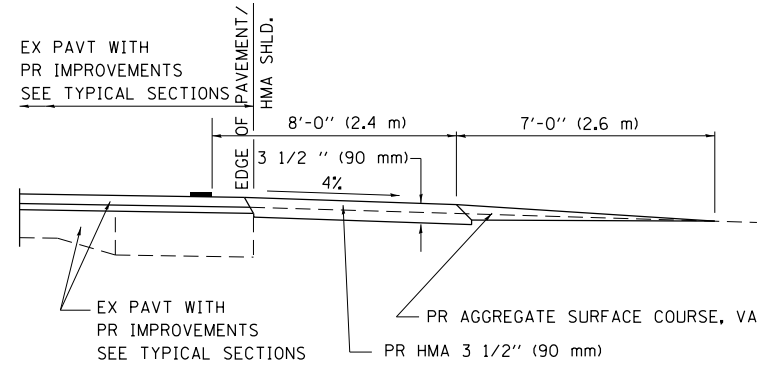

SECTION A-A FOR EX EARTH/AGGREGATE PE

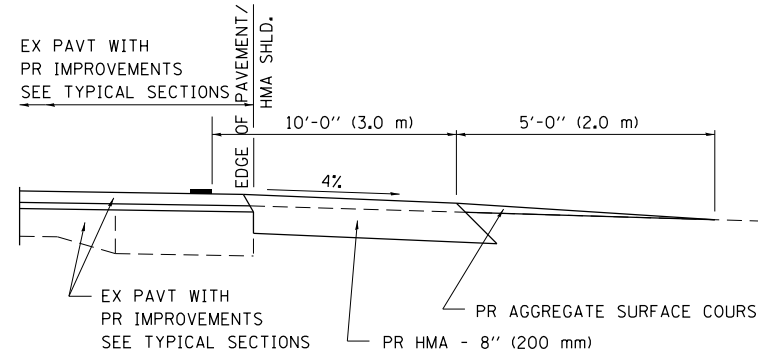

SECTION A-A FOR EX EARTH/AGGREGATE CE & SIDE ROAD

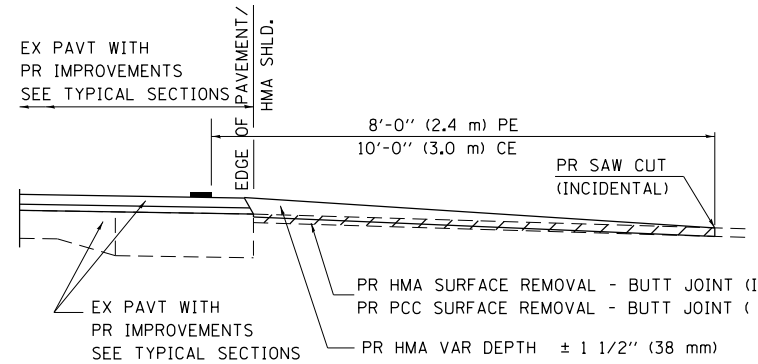

SECTION A-A FOR EX HMA/ PC CONCRETE PE, CE & SIDE ROAD

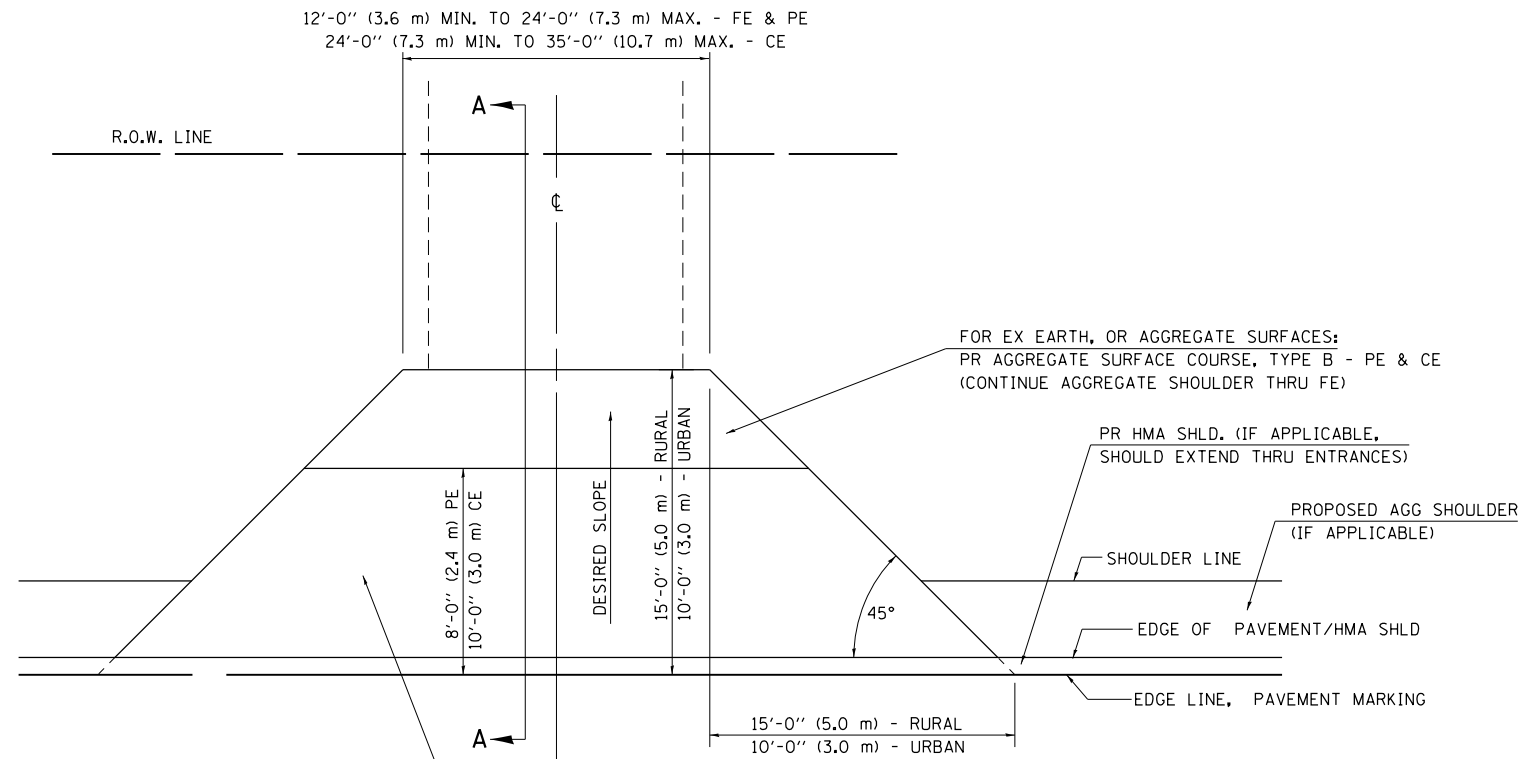

FOR EX EARTH OR AGGREGATE SURFACES:
 PR HMA SURFACE REMOVAL (IF APPLICABLE)
 PR AGGREGATE SHOULDER THRU - FE
 PR HMA CONCRETE 3 1/2" (90 mm) - PE
 PR HMA CONCRETE 8" (200 mm) - CE

FOR EX HMA CONCRETE SURFACES:
 PR HMA SURFACE REMOVAL-BUTT JOINT

FOR EX PCC SURFACES:
 PR PCC SURFACE REMOVAL-BUTT JOINT

GENERAL NOTES:

THE RESIDENT ENGINEER WILL DETERMINE THE EXACT TYPE OF IMPROVEMENT TO BE COMPLETED FOR ALL ENTRANCES, SIDEROADS AND MAILBOX TURNOUTS ON THIS PROJECT.

THE PLAN DETAILS AND SCHEDULES SHOULD BE USED AS A GUIDE FOR THE ENGINEER TO IMPLEMENT THE FINAL DESIGN. THE ENGINEER MAY DECIDE TO SALVAGE PORTIONS OF THE EXISTING ENTRANCE PAVEMENT STRUCTURE; THEREFORE, REDUCING PAY ITEM QUANTITIES. NO ADDITIONAL PAYMENT WILL BE ALLOWED FOR THIS REDUCTION IN QUANTITIES.

ANY WORK THE ENGINEER REQUIRES WHICH IS NOT COVERED BY A PAY ITEM CONTAINED IN THE PLANS WILL BE PAID FOR IN ACCORDANCE WITH ARTICLE 109.04 OF THE STANDARD SPECIFICATIONS.

HMA CONCRETE REQUIRED TO CONSTRUCT THE ENTRANCES SHALL BE IN ACCORDANCE WITH THE APPLICABLE PORTIONS OF SECTION 406 AND 408 OF THE STANDARD SPECIFICATIONS AND AS DIRECTED BY THE ENGINEER.

WHEN THE HMA CONCRETE PROPOSED FOR THE IMPROVEMENT IS THICKER THAN 3 INCHES (75 mm) AND REQUIRE PLACEMENT IN MORE THAN ONE LIFT. THE BOTTOM LIFT(S) SHALL MEET THE REQUIREMENTS OF HMA BASE COURSE IN SECTION 406 OF THE STANDARD SPECIFICATIONS AND THE TOP LIFT OF 2 INCHES (50 mm) SHALL MEET THE REQUIREMENTS OF HMA CONCRETE SURFACE COURSE, SUPERPAVE.

THIS WORK WILL BE PAID FOR IN ACCORDANCE WITH SECTIONS 351, 358, 408, 423 AND 440 OF THE STANDARD SPECIFICATIONS.

ALL DIMENSIONS ARE IN INCHES (MILLIMETERS) UNLESS OTHERWISE SHOWN.

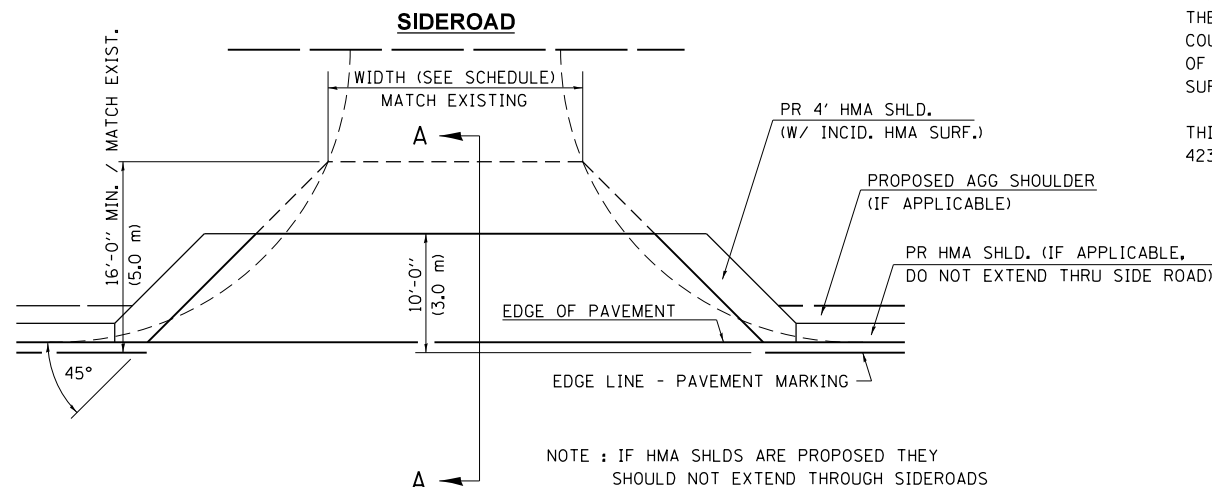

FILE NAME =	USER NAME = sparksgw	DESIGNED -	REVISED -
ci:\pw\work\p\idot\sparksgw\100397716\0672\06-sht-details.dgn		DRAWN -	REVISED -
Default	PLOT SCALE = 40.0000' / in.	CHECKED -	REVISED -
	PLOT DATE = May-20-2014 11:32:05AM	DATE -	REVISED -

**STATE OF ILLINOIS
 DEPARTMENT OF TRANSPORTATION**

**DIST.6 DETAILS FOR RURAL/URBAN ENT., MAILBOX
 TURNOUT & SIDEROADS W/O CONC. GUTTER (3P-PROJ.)**

SCALE: SHEET OF SHEETS STA. TO STA.

F.A.S. RTE.	SECTION	COUNTY	TOTAL SHEETS	SHEET NO.
1741	***	MONTGOMERY	14	13
			CONTRACT NO. 72H06	
ILLINOIS FED. AID PROJECT				

DETAILS OF MAILBOX TURNOUTS

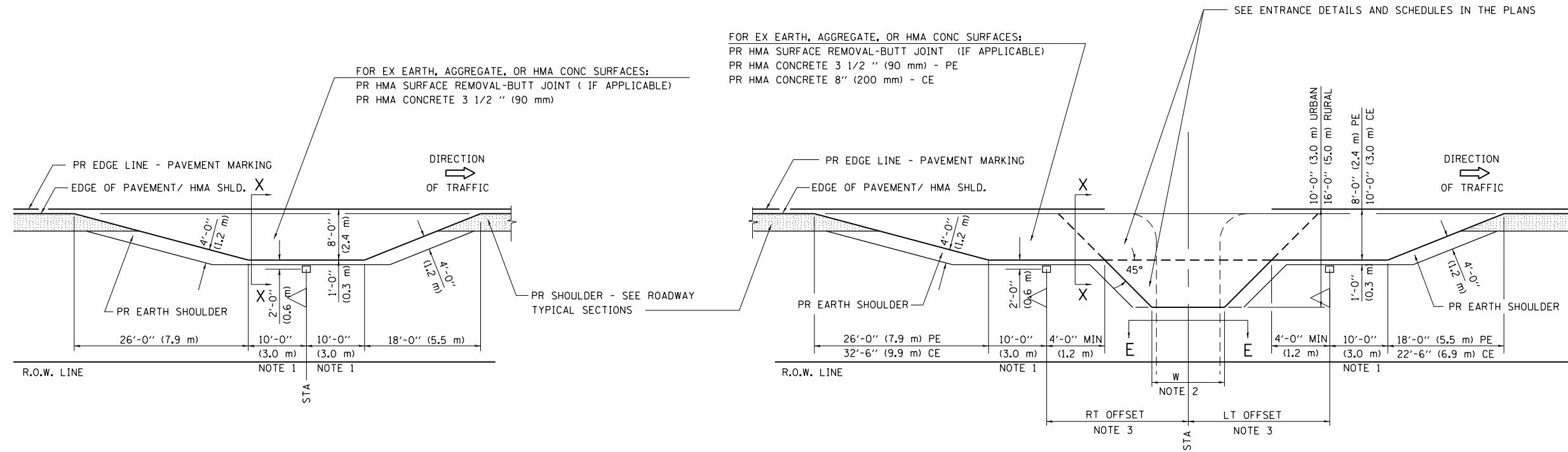

PLAN - MAILBOX TURNOUTS

PLAN - COMBINED MAILBOX TURNOUT WITH TRAILING OR LEADING ENTRANCE

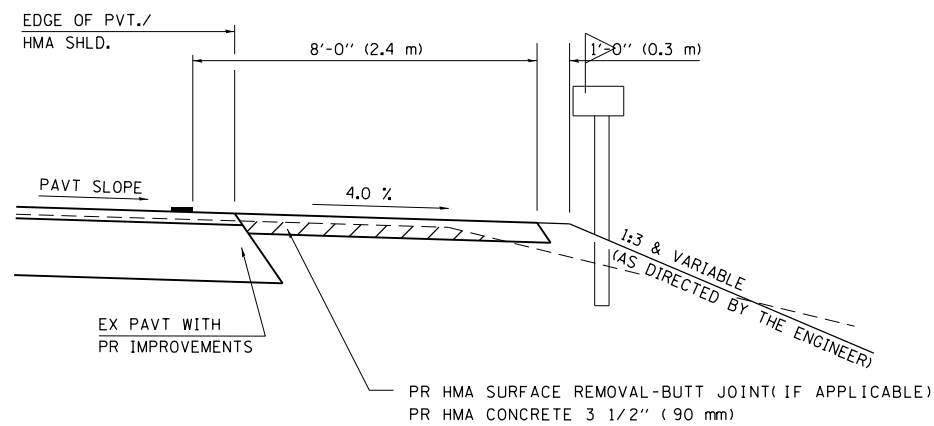

**SECTION X-X THRU MAILBOX TURNOUT
ALSO APPLIES TO MAILBOX TURNOUTS COMBINED WITH
EX EARTH, AGGREGATE, OR HMA PE & FE**

(DETAIL APPLIES WHEN M.B. TURNOUT DOES NOT EXIST.
IF EXISTING, TREAT SAME AS ENTRANCE.)

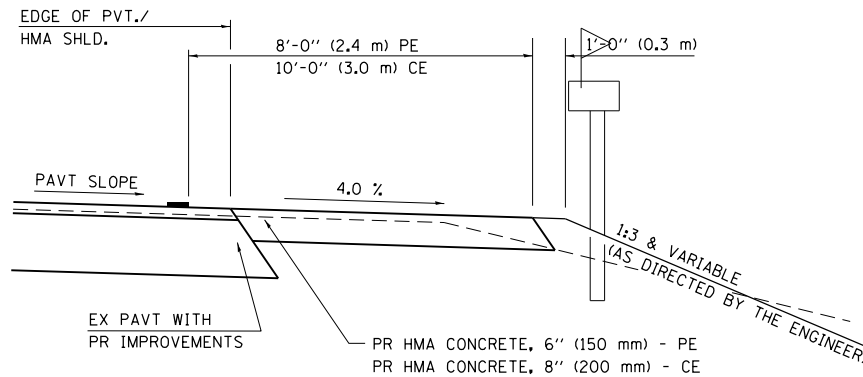

**SECTION X-X THRU MAILBOX TURNOUT
COMBINED WITH EX HMA CONC & PC CONC PE & CE**

(DETAIL APPLIES WHEN M.B. TURNOUT DOES NOT EXIST.
IF EXISTING, TREAT SAME AS ENTRANCE.)

- NOTE 1 IF MORE THAN ONE MAILBOX IS PRESENT, DIMENSION FROM CENTER OF END MAILBOX.
- NOTE 2 FOR ENTRANCE LAYOUT DIMENSIONS AND SECTIONS A-A & E-E REFER TO THE SCHEDULES IN THE PLANS.
- NOTE 3 BOTH LT OR RT OFFSETS FOR MAILBOX SHOWN USE OFFSET DIMENSION PER SCHEDULE AND REFER TO LAYOUT SHOWN ON THE PLAN.

ALL DIMENSIONS ARE IN INCHES (MILLIMETERS)
UNLESS OTHERWISE SHOWN.

FILE NAME =	USER NAME = sparksgw	DESIGNED -	REVISED -	STATE OF ILLINOIS DEPARTMENT OF TRANSPORTATION	DIST.6 DETAILS FOR RURAL/URBAN ENT., MAILBOX TURNOUT & SIDEROADS W/O CONC. GUTTER (3P-PROJ.)	F.A.S. RTE.	SECTION	COUNTY	TOTAL SHEETS	SHEET NO.	
Default	et:\pw\work\p\idot\sparksgw\10397716\0672\06-sht-details.dgn	DRAWN -	REVISED -			1741	***	MONTGOMERY	14	14	
	PLOT SCALE = 40.0000' / in.	CHECKED -	REVISED -			CONTRACT NO. 72H06					
	PLOT DATE = May-20-2014 11:32:06AM	DATE -	REVISED -			ILLINOIS FED. AID PROJECT					