

EXIST. CURVE 315  
 PI STA. = 615+23.17  
 $\Delta$  = 3° 31' 41" (RT)  
 D = 0° 20' 10"  
 R = 17,052.46'  
 T = 525.17'  
 L = 1,050.00'  
 E = 8.08'  
 e = N.C.  
 T.R. = -----  
 S.E. RUN = -----  
 P.C. STA. = 609+98.01  
 P.T. STA. = 620+48.01

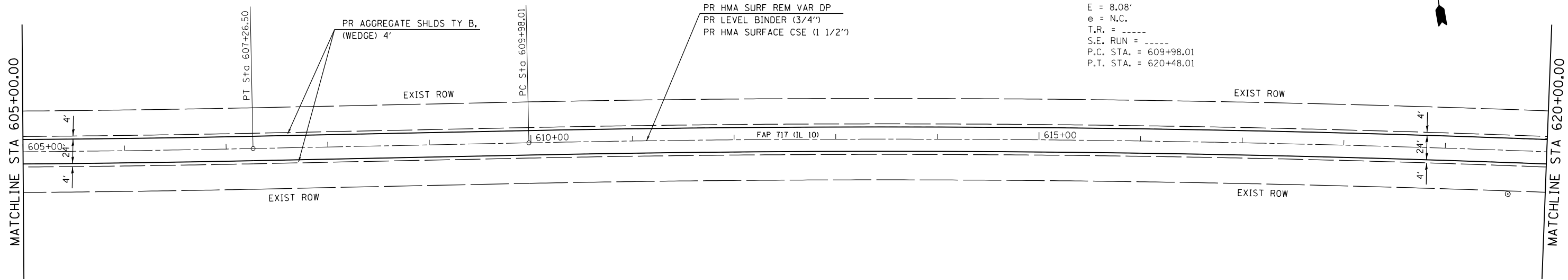

SEE ENTRANCE DETAIL AND SCHEDULES FOR ADDITIONAL INFORMATION

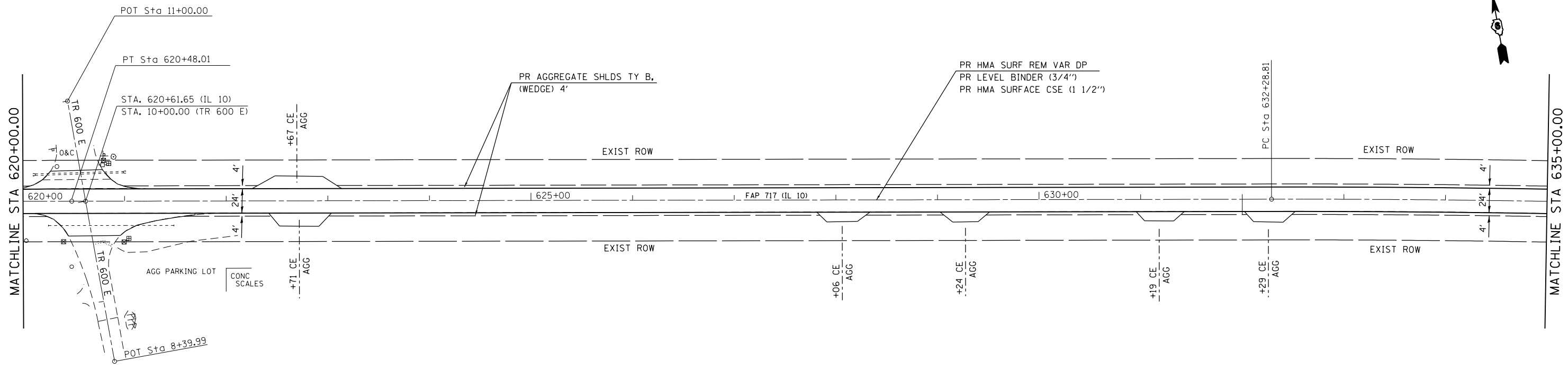

SEE ENTRANCE DETAIL AND SCHEDULES FOR ADDITIONAL INFORMATION

FILE NAME =	USER NAME = sparksgw	DESIGNED -	REVISED -
c:\pwwork\pwwork\sparksgw\10402311\0672\127-sht-plan.dgn		DRAWN -	REVISED -
	PLOT SCALE = 100.0000' / 1"	CHECKED -	REVISED -
	PLOT DATE = Jun-06-2014 01:54:09PM	DATE -	REVISED -

**STATE OF ILLINOIS  
 DEPARTMENT OF TRANSPORTATION**

**PLAN SHEET  
 FAP 717 (IL 10)**

SCALE:	SHEET NO.	OF SHEETS	STA.	TO STA.
--------	-----------	-----------	------	---------

F.A.P. RTE.	SECTION	COUNTY	TOTAL SHEETS	SHEET NO.
717	(102)RS-4, (103)RS-3	LOGAN	25	15
CONTRACT NO.			72H27	
ILLINOIS FED. AID PROJECT				