

BRASS PLATE WITH SQUARE
N 1/4 COR 15 T1N R3W
(ON N/S CENTER LINE OF WINTER RD.)

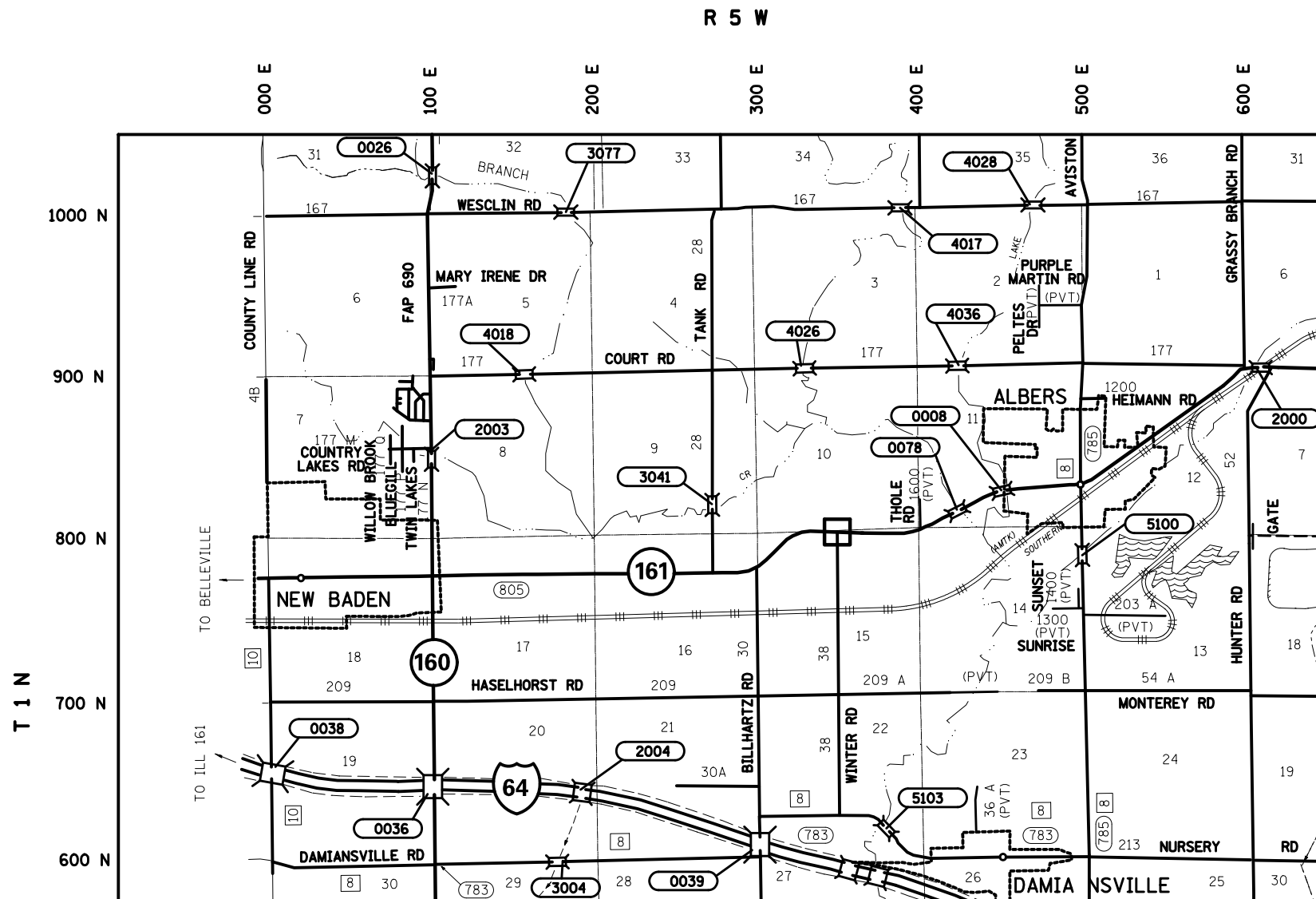

□ - SURVEY COVER MONUMENT LOCATION - 1 EACH

NORTH 1/4 CORNER SECTION 15
T.1.N., R.3.W.

FILE NAME =	USER NAME = harbaughrd	DESIGNED -	REVISED -	STATE OF ILLINOIS DEPARTMENT OF TRANSPORTATION	SURVEY MONUMENT COVER ASSEMBLY			F.A.P. RTE.	SECTION	COUNTY	TOTAL SHEETS	SHEET NO.	
et:\pwork\pwork\harbaughrd\0332311\076g30-sht-ATB.dgn	176g30-sht-ATB.dgn	DRAWN -	REVISED -					805	126-IRS-3	CLINTON	16	13	
	PLOT SCALE = 100.0000' / 1".	CHECKED -	REVISED -		SCALE: N/A			SHEET NO. 1 OF 1 SHEETS		STA.	TO STA.	CONTRACT NO. 76G30	
	PLOT DATE = 5/9/2014	DATE -	REVISED -		ILLINOIS FED. AID PROJECT								