

STATE OF ILLINOIS
 DEPARTMENT OF TRANSPORTATION
 DIVISION OF HIGHWAYS
**PROPOSED
 HIGHWAY PLANS**

F.A.P. RTE.	SECTION	COUNTY	TOTAL SHEETS	SHEET NO.
805	126-1RS-3	CLINTON	16	1
ILLINOIS			CONTRACT NO. 76G30	

FOR INDEX OF SHEETS, SEE SHEET NO. 2

TRAFFIC DATA

IL 161

2011 ADT	=	5,100 (ACTUAL)
2015 ADT	=	5,300 (ESTIMATED)
2035 ADT	=	6,500 (ESTIMATED)
SU	=	2.9%
MU	=	3.5%

FAP ROUTE 805 (IL 161)
 SECTION 126-1RS-3
 PROJECT: ACF-0805 (076)
 RESURFACING-3P
 CLINTON COUNTY
 C-98-032-13

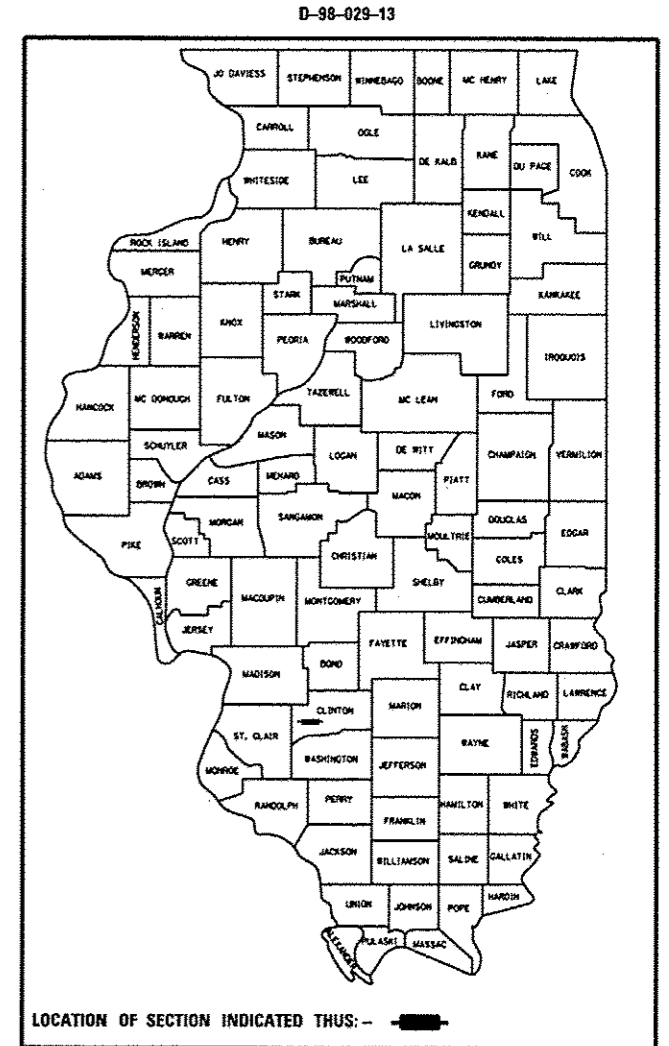

END PROJECT
 STA. 1141+14
 LONG: -89.61946
 LAT: 38.54323

PROJECT OMISSION—
 S.N. 014-0078
 STA. 1116+98.5 TO STA. 1121+11.5

STATION EQUATION
 STA. 1106+92 (BACK) =
 STA. 1104+28.9 (AHEAD)

BEGIN PROJECT
 STA. 941+10
 LONG: -89.68770
 LAT: 38.53519

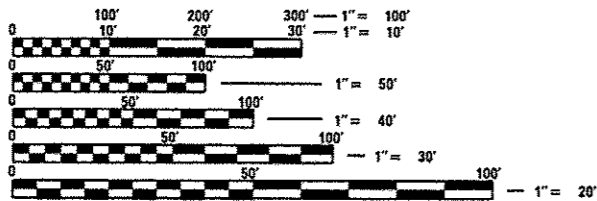
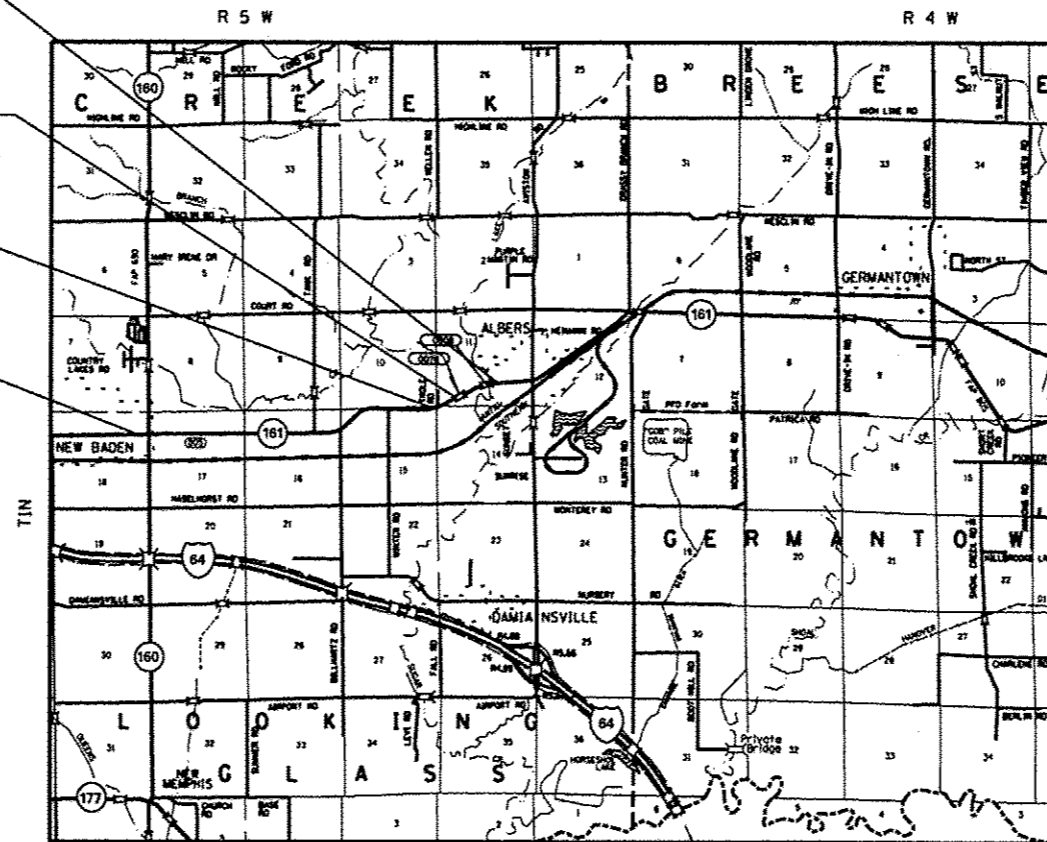

FULL SIZE PLANS HAVE BEEN PREPARED USING STANDARD ENGINEERING SCALES. REDUCED SIZED PLANS WILL NOT CONFORM TO STANDARD SCALES. IN MAKING MEASUREMENTS ON REDUCED PLANS, THE ABOVE SCALES MAY BE USED.

J.U.L.I.E.
 JOINT UTILITY LOCATION INFORMATION FOR EXCAVATION
 1-800-892-0123
 OR 811

PROJECT ENGINEER: PATTI LeBEAU (618) 346-3179
 PROJECT MANAGER: REBECCA THARP (618) 346-3323

CONTRACT NO. 76G30

DESIGN DESIGNATION
 N/A

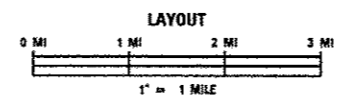

GROSS LENGTH = 20,267 FT. = 3.838 MILES
 NET LENGTH = 19,854 FT. = 3.760 MILES

STATE OF ILLINOIS
 DEPARTMENT OF TRANSPORTATION
 DIVISION OF HIGHWAYS

SUBMITTED *May 6 20 14*
Jeffrey Z. K...
 DEPUTY DIRECTOR OF HIGHWAYS, REGION 5 ENGINEER

June 27 20 14
John D. Baranzelli, P.E.
 acting ENGINEER OF DESIGN AND ENVIRONMENT

June 27 20 14
Omer Osman, P.E.
 DIRECTOR OF HIGHWAYS, CHIEF ENGINEER

**PRINTED BY THE AUTHORITY
 OF THE STATE OF ILLINOIS**

INDEX OF SHEETS

- 1 COVER SHEET
- 2 INDEX OF SHEETS, HIGHWAY STANDARDS,
GENERAL NOTES & COMMITMENTS
- 3 LOCATION MAP
- 4-6 SUMMARY OF QUANTITIES
- 7-9 TYPICAL SECTIONS
- 10-12 SCHEDULE OF QUANTITIES
- 13 SURVEY MONUMENT COVER ASSEMBLY
- 14-16 MISCELLANEOUS DETAILS

GENERAL NOTES

1. ILLINOIS STATE LAW REQUIRES A 48-HOUR NOTICE BE GIVEN TO ALL UTILITIES WITHIN THE PROJECT AREA BEFORE DIGGING. FIELD MARKING OF FACILITIES MAY BE OBTAINED BY CONTACTING J.U.L.I.E. OR FOR NON-MEMBERS, THE UTILITY COMPANY DIRECTLY. AGENCIES KNOWN TO HAVE FACILITIES WITHIN THE PROJECT AREA ARE AS FOLLOWS:
 - VILLAGE OF ALBERS (WATER & SANITARY SEWER)
 - AMEREN ILLINOIS (GAS & ELECTRIC)
 - CHARTER COMMUNICATIONS, INC. (CABLE TV)
 - CLINTON COUNTY ELECTRIC COOPERATIVE, INC. (ELECTRIC)
 - FRONTIER NORTH, INC. (COMMUNICATIONS)
 - VILLAGE OF NEW BADEN (WATER & SANITARY SEWER)
 - NEW MEMPHIS PUBLIC WATER DISTRICT (WATER)
 - MCLEOD TELECOMMUNICATIONS SERVICES, LLC (COMMUNICATIONS)
 - US SIGNAL COMPANY, LLC (COMMUNICATIONS)
- MEMBERS OF J.U.L.I.E. CALL TOLL FREE (800) 892-0123 OR 811 AND ARE INDICATED BY *. NON-J.U.L.I.E. MEMBERS MUST BE NOTIFIED INDIVIDUALLY.
2. THE CONTRACTOR AND THE ENGINEER SHALL BE AWARE THAT NO SURVEY WAS PERFORMED FOR THIS PROJECT. THE STATIONING, TOPOGRAPHY, AND QUANTITIES SHOWN IN THE PLANS WERE CREATED USING MICROFILM AND FIELD MEASUREMENTS. ALL SHALL BE ASSUMED TO BE APPROXIMATE. THE CONTRACTOR SHALL VERIFY DIMENSIONS AND CONDITIONS IN THE FIELD PRIOR TO CONSTRUCTION AND ORDERING OF MATERIALS.
3. THE THICKNESS OF HOT-MIX ASPHALT SURFACE MIXTURES SHOWN ON THE PLANS IS THE NOMINAL THICKNESS. DEVIATIONS MAY OCCUR DUE TO IRREGULARITIES IN THE EXISTING SURFACE OR BASE ON WHICH THE HOT-MIX ASPHALT MIXTURE IS PLACED.
4. THE USE OF VIBRATORY ROLLERS WILL NOT BE PERMITTED WITHIN THE CITY LIMITS OF NEW BADEN OR ALBERS. THIS DOES NOT RELIEVE THE CONTRACTOR OF DENSITY REQUIREMENTS FOR THE CONSTRUCTION OF THE BITUMINOUS PAVEMENTS AS SPECIFIED IN SECTIONS 406 & 407 OF THE STANDARD SPECIFICATIONS.
5. AN ESTIMATED QUANTITY OF 5050 TONS OF CUTTINGS FROM THE HOT-MIX ASPHALT SURFACE REMOVAL OPERATION IS ANTICIPATED.
6. NO OVERNIGHT LANE CLOSURES WILL BE PERMITTED.
7. PRIOR TO THE MILLING OPERATIONS, THE RE/RT SHALL RECORD AND DOCUMENT ALL EXISTING PAVEMENT MARKINGS AND LOCATIONS INCLUDING ALL LANE MARKINGS, CROSS-WALKS, STOP-BARS AND SYMBOLS. AFTER COMPLETION OF HOT-MIX ASPHALT OVERLAY OPERATIONS, THE PROPOSED THERMOPLASTIC PAVEMENT MARKING SHALL BE PLACED AT THE EXISTING DOCUMENTED LOCATIONS.
8. THE RESIDENT ENGINEER SHALL VERIFY THE EXISTENCE OF HIGHWAY LIGHTING AND/OR INTELLIGENT TRANSPORTATION SYSTEMS (I.T.S.) UTILITIES WITHIN THE PROJECT LIMITS. IF HIGHWAY LIGHTING AND/OR I.T.S. EXISTS WITHIN THE PROJECT LIMITS, AND IF THESE ITEMS REQUIRE LOCATING, THE CONTRACTOR SHALL BE DIRECTED TO DO SO ACCORDING TO SECTION 803 OF THE STANDARD SPECIFICATIONS. THIS WORK SHALL BE PAID FOR ACCORDING TO ARTICLE 109.04 OF THE STANDARD SPECIFICATION.
9. SIDEROADS AND ENTRANCES SHALL BE OPEN TO TRAFFIC AT ALL TIMES.
10. ALL TURF AREAS DISTURBED BY THE CONTRACTOR SHALL BE SEEDED WITH THE APPROPRIATE EROSION CONTROL, AS DIRECTED BY THE ENGINEER, AT THE CONTRACTOR'S EXPENSE.
11. THE LOCATIONS OF THE REPAIR AREAS AS SHOWN IN THE PLANS ARE APPROXIMATE LOCATIONS. THE EXACT LOCATIONS SHALL BE DETERMINED BY THE ENGINEER.
12. PROJECT SHALL BE CONSTRUCTED WITHOUT DISTURBING THE EXISTING GUARDRAIL OR THE EXISTING BRIDGE RAIL.
13. THE CONTRACTOR SHALL BE AWARE THAT THERE ARE EXISTING MANHOLES AND VALVES LOCATED WITHIN THE RESURFACING LIMITS. CARE SHALL BE TAKEN SO AS NOT TO DAMAGE THESE STRUCTURES DURING MILLING AND RESURFACING OPERATIONS.
14. THE CONTRACTOR SHALL PROVIDE POSITIVE AND ADEQUATE DRAINAGE AT ALL TIMES.
15. ONLY SHORT TERM PAYEMENT MARKING REMOVAL FROM THE FINAL SURFACE SHALL BE PAID FOR AS "WORK ZONE PAVEMENT MARKING REMOVAL".
16. THE TEMPORARY RAMPS USED ON ALL SIDE STREETS AND ENTRANCES SHALL BE 3 FEET IN LENGTH SO AS NOT TO INTERFERE WITH THE THRU TRAFFIC LANES.

STANDARDS

- 000001-06 STANDARD SYMBOLS, ABBREVIATIONS AND PATTERNS
- 001006 DECIMAL OF AN INCH AND OF A FOOT
- 406201-01 MAILBOX TURNOUT
- 442201-03 CLASS C AND D PATCHES
- 701001-02 OFF-RD OPERATIONS, 2L, 2W, MORE THAN 15' AWAY
- 701006-05 OFF-RD OPERATIONS, 2L, 2W, 15' TO 24" FROM PAVEMENT EDGE
- 701011-04 OFF-RD MOVING OPERATIONS, 2L, 2W, DAY ONLY
- 701201-04 LANE CLOSURE, 2L, 2W, DAY ONLY, FOR SPEEDS ≥ 45 MPH
- 701301-04 LANE CLOSURE, 2L, 2W, SHORT TIME OPERATIONS
- 701306-03 LANE CLOSURE, 2L, 2W, SLOW MOVING OPERATIONS DAY ONLY, FOR SPEEDS ≥ 45 MPH
- 701311-03 LANE CLOSURE, 2L, 2W, MOVING OPERATIONS - DAY ONLY
- 701326-04 LANE CLOSURE, 2L, 2W, PAVEMENT WIDENING, FOR SPEEDS ≥ 45 MPH
- 701336-06 LANE CLOSURE, 2L, 2W, WORK AREAS IN SERIES, FOR SPEEDS ≥ 45 MPH
- 701901-03 TRAFFIC CONTROL DEVICES
- 780001-04 TYPICAL PAVEMENT MARKINGS
- 781001-03 TYPICAL APPLICATIONS RAISED REFLECTIVE PAVEMENT MARKERS

COMMITMENTS

NONE

FILE NAME =	USER NAME = harbaughrd	DESIGNED -	REVISED -	STATE OF ILLINOIS DEPARTMENT OF TRANSPORTATION	INDEX OF SHEETS, HIGHWAY STANDARDS, GENERAL NOTES, & COMMITMENTS			F.A.P. RTE.	SECTION	COUNTY	TOTAL SHEETS	SHEET NO.	
d:\pwork\projdot\harbaughrd\032311\do	7630-ahh-gennote.dgn	DRAWN -	REVISED -		SCALE: N/A	SHEET NO. 1 OF 1 SHEETS	STA.	TO STA.	805	126-1RS-3	CLINTON	16	2
	PLOT SCALE = 100.0000 / 1 in.	CHECKED -	REVISED -		CONTRACT NO. 7630								
	PLOT DATE = 5/9/2014	DATE -	REVISED -		ILLINOIS FED. AID PROJECT								

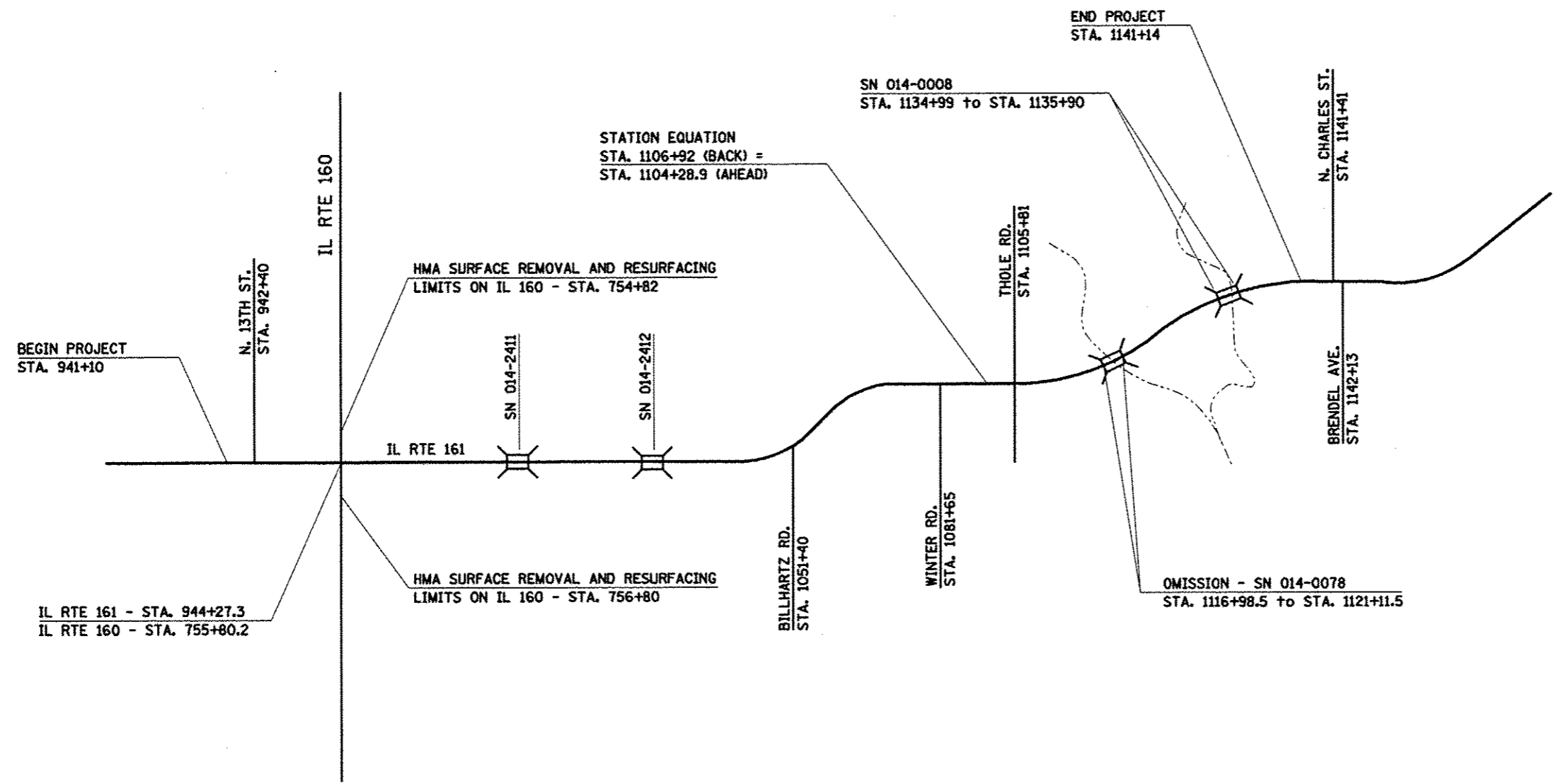

NOT TO SCALE

FILE NAME : c:\p\work\p\dot\harbaugh\d\032311\d\76g30-akt-gannote.dgn	USER NAME : harbaughhd	DESIGNED -	REVISED -	STATE OF ILLINOIS DEPARTMENT OF TRANSPORTATION	LOCATION MAP			F.A.P. RTE.	SECTION	COUNTY	TOTAL SHEETS	SHEET NO.	
	PLDT SCALE : 100.0000 ' / 1"	DRAWN -	REVISED -		805	120-URS-3	CLINTON	16	3				
	PLDT DATE : 5/9/2014	CHECKED -	REVISED -		SCALE: N/A			SHEET NO. 1 OF 1 SHEETS		STA.	TO STA.	CONTRACT NO. 76630	
		DATE -	REVISED -		ILLINOIS FED. AID PROJECT								

CODE NO.	ITEM	UNIT	TOTAL QUANTITY	CONSTR. CODE
				80% FED 20% STATE
				ROADWAY
				0005
				RURAL
40200800	AGGREGATE SURFACE COURSE, TYPE B	TON	63	63
40600637	LEVELING BINDER (MACHINE METHOD), 1L-9, 5FG, N70	TON	2466	2466
40600982	HOT-MIX ASPHALT SURFACE REMOVAL - BUTT JOINT	SQ YD	101	101
40600990	TEMPORARY RAMP	SQ YD	335	335
40603340	HOT-MIX ASPHALT SURFACE COURSE, MIX "D", N70	TON	4914	4914
40800050	INCIDENTAL HOT-MIX ASPHALT SURFACING	TON	21	21
44000155	HOT-MIX ASPHALT SURFACE REMOVAL, 1 1/2"	SQ YD	56602	56602
44000158	HOT-MIX ASPHALT SURFACE REMOVAL, 2 1/4"	SQ YD	2232	2232
44200168	PAVEMENT PATCHING, TYPE II, 14 INCH	SQ YD	111	111
44200172	PAVEMENT PATCHING, TYPE III, 14 INCH	SQ YD	80	80
44200174	PAVEMENT PATCHING, TYPE IV, 14 INCH	SQ YD	229	229
44300200	STRIP REFLECTIVE CRACK CONTROL TREATMENT	FOOT	40622	40622
48102100	AGGREGATE WEDGE SHOULDER, TYPE B	TON	714	714

CODE NO.	ITEM	UNIT	TOTAL QUANTITY	CONSTR. CODE	
				ROADWAY	RURAL
				80% FED	20% STATE
48203029	HOT-MIX ASPHALT SHOULDERS, 8"	SQ YD	1293	0005	
48203100	HOT-MIX ASPHALT SHOULDERS	TON	44		
67000400	ENGINEER'S FIELD OFFICE, TYPE A	CAL MO	5		
67100100	MOBILIZATION	L SUM	1		
70100450	TRAFFIC CONTROL AND PROTECTION, STANDARD 701201	L SUM	1		
70100460	TRAFFIC CONTROL AND PROTECTION, STANDARD 701306	L SUM	1		
70100500	TRAFFIC CONTROL AND PROTECTION, STANDARD 701326	L SUM	1		
70100600	TRAFFIC CONTROL AND PROTECTION, STANDARD 701336	L SUM	1		
70300100	SHORT TERM PAVEMENT MARKING	FOOT	5520		
70300220	TEMPORARY PAVEMENT MARKING - LINE 4"	FOOT	51992		
70300280	TEMPORARY PAVEMENT MARKING - LINE 24"	FOOT	100		
70301000	WORK ZONE PAVEMENT MARKING REMOVAL	SQ FT	18145		
* 78000200	THERMOPLASTIC PAVEMENT MARKING - LINE 4"	FOOT	51992		

* SPECIALTY ITEMS

FILE NAME =	USER NAME = herbaughd	DESIGNED -	REVISD -	STATE OF ILLINOIS DEPARTMENT OF TRANSPORTATION	SUMMARY OF QUANTITIES				F.A.P. RTE.	SECTION	COUNTY	TOTAL SHEETS	SHEET NO.
o:\pe_work\psidot\herbaughd\0332311\076g30-ehf-500.dgn	76g30-ehf-500.dgn	DRAWN -	REVISD -		SCALE: N/A	SHEET NO. 2 OF 3 SHEETS	STA.	TO STA.	805	126-1RS-3	CLINTON	16	5
PLOT SCALE = 100.0000' / 1" =		CHECKED -	REVISD -						CONTRACT NO. 76G30				
PLOT DATE = 5/9/2014		DATE -	REVISD -						ILLINOIS FED. AID PROJECT				

000 6 1 7 AM

CODE NO.	ITEM	UNIT	TOTAL QUANTITY	CONSTR. CODE	
				80% FED	20% STATE
				ROADWAY	
				0005	RURAL
* 78000650	THERMOPLASTIC PAVEMENT MARKING - LINE 24"	FOOT	100	100	
* 78100100	RAISED REFLECTIVE PAVEMENT MARKER	EACH	254	254	
78300200	RAISED REFLECTIVE PAVEMENT MARKER REMOVAL	EACH	254	254	
X4060110	BITUMINOUS MATERIALS (PRIME COAT)	POUND	39551	39551	
Z0070100	SURVEY MONUMENT COVER ASSEMBLY	EACH	1	1	
φ Z0070600	TRAINEES	HOURL	1000	1000	
φ Z0070604	TRAINEES TRAINING PROGRAM GRADUATE	HOURL	1000	1000	

* SPECIALTY ITEMS

φ 0042

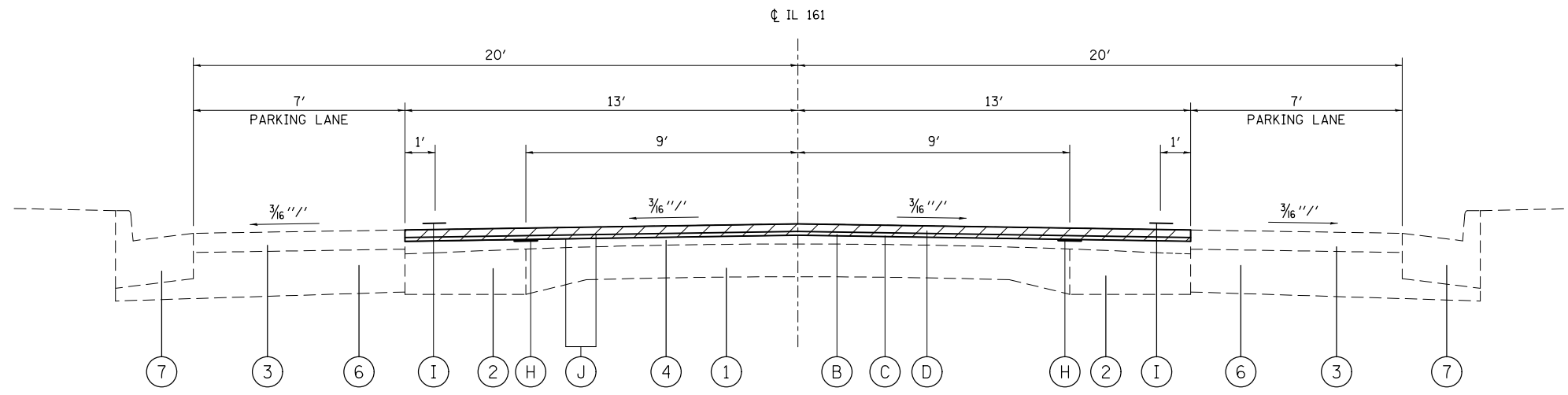

TYPICAL SECTION
STA. 941+10 TO STA. 943+56

LEGEND

- ① EXISTING P.C.C. PAVEMENT, 9-6 1/2-9
- ② EXISTING BASE COURSE WIDENING, 9"
- ③ EXISTING HOT-MIX ASPHALT RESURFACING, 3/4"
- ④ EXISTING HOT-MIX ASPHALT RESURFACING, ±4"
- ⑤ EXISTING HOT-MIX ASPHALT RESURFACING, ±5"
- ⑥ EXISTING HOT-MIX ASPHALT BASE COURSE, 8 1/2"
- ⑦ EXISTING COMBINATION CURB AND GUTTER, TYPE B-6.24
- ⑧ EXISTING HOT-MIX ASPHALT SHOULDER, 2"
- ⑨ EXISTING HOT-MIX ASPHALT SHOULDER, 9"
- ⑩ EXISTING AGGREGATE SHOULDERS, 6"
- ⑪ EXISTING AGGREGATE SHOULDERS, TYPE B"
- ⑫ EXISTING HOT-MIX ASPHALT RESURFACING AND WATERPROOFING MEMBRANE SYSTEM, ±2 1/2"

- Ⓐ PROPOSED HOT-MIX ASPHALT SURFACE REMOVAL, 1 1/2"
- Ⓑ PROPOSED HOT-MIX ASPHALT SURFACE REMOVAL, 2 1/4"
- Ⓒ PROPOSED LEVELING BINDER (MACHINE METHOD), IL-9.5FG N70 (3/4")
- Ⓓ PROPOSED HOT-MIX ASPHALT SURFACE COURSE, MIX "D", N70 (1 1/2")
- Ⓔ PROPOSED HOT-MIX ASPHALT SHOULDERS (2 1/4")
- Ⓕ PROPOSED HOT-MIX ASPHALT SHOULDERS, 8"
- Ⓖ PROPOSED AGGREGATE WEDGE SHOULDER, TYPE B
- Ⓗ PROPOSED STRIP REFLECTIVE CRACK CONTROL TREATMENT
- Ⓘ PROPOSED THERMOPLASTIC PAVEMENT MARKING - LINE 4"
- Ⓝ PROPOSED BITUMINOUS MATERIALS (PRIME COAT)

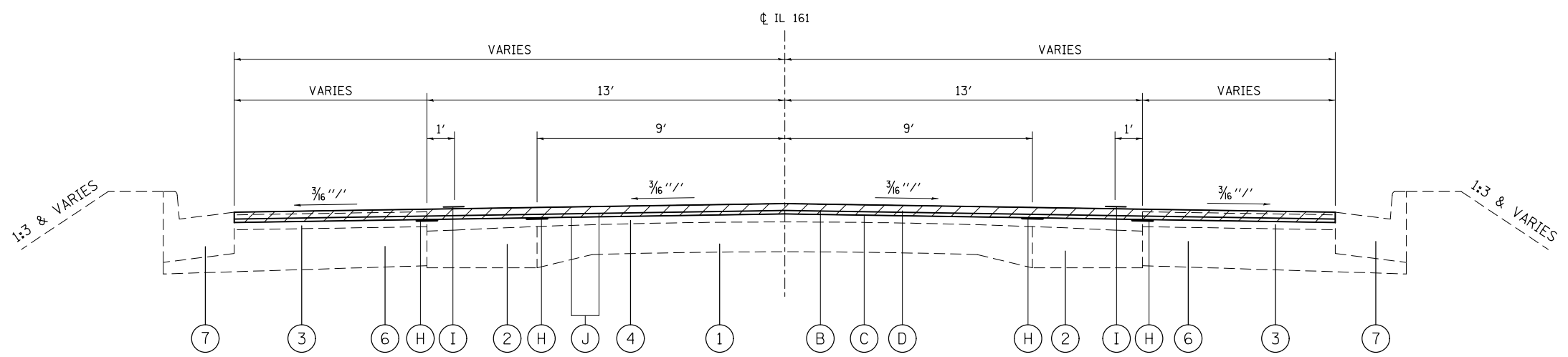

TYPICAL SECTION
STA. 943+56 TO STA. 945+10
(THIS INCLUDES THE INTERSECTION OF IL 160/IL 161
ON IL 160 FROM STA. 754+82 TO STA. 756+80)

MIXTURE USE	SURFACE	LEVEL BINDER	INCIDENTAL HMA	PATCHING	SHOULDER > 2.25
AC/PG	PG 64-22	PG 64-22	PG 64-22	PG 64-22	PG 64-22
DESIGN AIR VOIDS	4.0% @ Ndes=70	4.0% @ Ndes=70	4.0% @ Ndes=70	4.0% @ Ndes=70	**2.0% @ Ndes=30
MIX COMPOSITION					NMAS 3/4"
(GRADATION MIXTURE)	IL 9.5	IL 9.5 FG	IL 9.5	IL 19.0 FG	
FRICTION AGG	MIXTURE "D"	MIXTURE "C"	MIXTURE "C"	MIXTURE "B"	
QUALITY MGMT PROGRAM	QC/QA	QC/QA	QC/QA	QC/QA	QC/QA

** TOP LIFT SHOULDERS - DESIGN THIS MIX AT 2.0 % VOIDS AND ADD ASPHALT TO REDUCE VOIDS TO 1.5%.

PLAN QUANTITIES FOR BITUMINOUS CONCRETE SURFACE COURSE ITEMS ARE CALCULATED USING A UNIT WEIGHT OF 112 LB/SQ YD/IN.

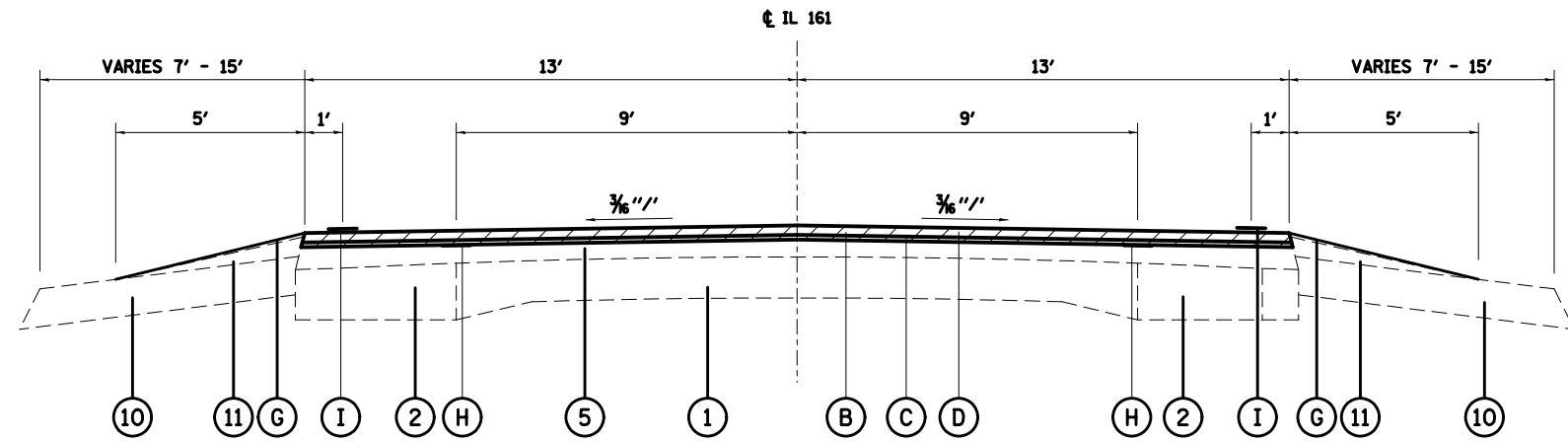

TYPICAL SECTION
STA. 945+10 TO STA. 949+35

LEGEND

- ① EXISTING P.C.C. PAVEMENT, 9-6 1/2-9
- ② EXISTING BASE COURSE WIDENING, 9"
- ③ EXISTING HOT-MIX ASPHALT RESURFACING, 3/4"
- ④ EXISTING HOT-MIX ASPHALT RESURFACING, ±4"
- ⑤ EXISTING HOT-MIX ASPHALT RESURFACING, ±5"
- ⑥ EXISTING HOT-MIX ASPHALT BASE COURSE, 8 1/2"
- ⑦ EXISTING COMBINATION CURB AND GUTTER, TYPE B-6.24
- ⑧ EXISTING HOT-MIX ASPHALT SHOULDER, 2"
- ⑨ EXISTING HOT-MIX ASPHALT SHOULDER, 9"
- ⑩ EXISTING AGGREGATE SHOULDERS, 6"
- ⑪ EXISTING AGGREGATE SHOULDERS, TYPE B"
- ⑫ EXISTING HOT-MIX ASPHALT RESURFACING AND WATERPROOFING MEMBRANE SYSTEM, ±2 1/2"
- Ⓐ PROPOSED HOT-MIX ASPHALT SURFACE REMOVAL, 1 1/2"
- Ⓑ PROPOSED HOT-MIX ASPHALT SURFACE REMOVAL, 2 1/4"
- Ⓒ PROPOSED LEVELING BINDER (MACHINE METHOD), IL-9.5FG N70 (3/4")
- Ⓓ PROPOSED HOT-MIX ASPHALT SURFACE COURSE, MIX "D", N70 (1 1/2")
- Ⓔ PROPOSED HOT-MIX ASPHALT SHOULDERS (2 1/4")
- Ⓕ PROPOSED HOT-MIX ASPHALT SHOULDERS, 8"
- Ⓖ PROPOSED AGGREGATE WEDGE SHOULDER, TYPE B
- Ⓗ PROPOSED STRIP REFLECTIVE CRACK CONTROL TREATMENT
- Ⓘ PROPOSED THERMOPLASTIC PAVEMENT MARKING - LINE 4"
- ⓵ PROPOSED BITUMINOUS MATERIALS (PRIME COAT)

CL 161

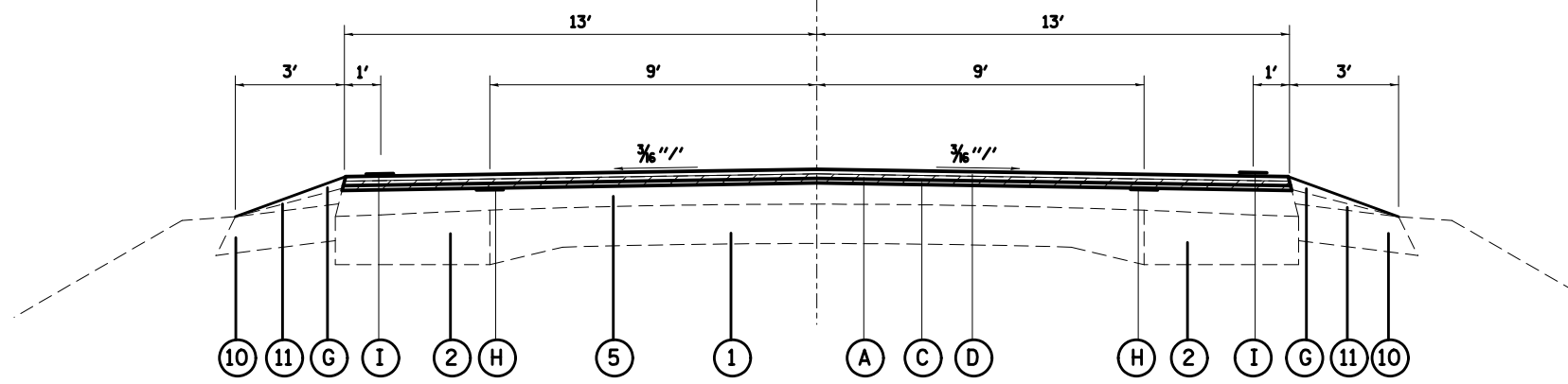

TYPICAL SECTION

STA. 949+35 TO STA. 1112+75 (SEE DETAILS A & B)
(STATION EQUATION STA. 1106+92 = STA. 1104+28.90)
STA. 1124+75 TO STA. 1132+60
STA. 1138+30 TO STA. 1140+84

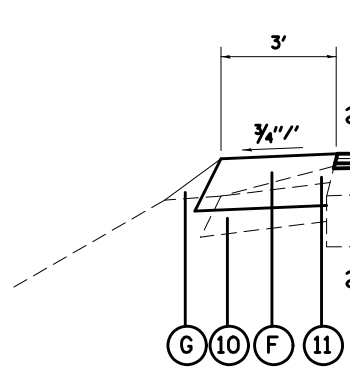

LEFT SIDE

STA. 1042+84 TO STA. 1053+41
STA. 1097+86 TO STA. 1106+92
(STATION EQUATION STA. 1106+92 = STA. 1104+28.90)
STA. 1104+28.90 TO STA. 1106+48

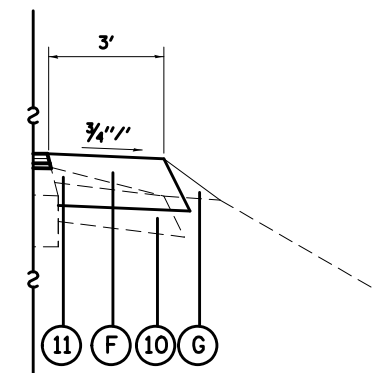

RIGHT SIDE

STA. 1061+75 TO STA. 1073+47

NOTE: MATCH EXISTING SLOPE THROUGH SUPERELEVATION SECTIONS.

FILE NAME =	USER NAME = harbaughrd	DESIGNED -	REVISED -	STATE OF ILLINOIS DEPARTMENT OF TRANSPORTATION	TYPICAL SECTIONS			F.A.P. RTE.	SECTION	COUNTY	TOTAL SHEETS	SHEET NO.	
et:\pwork\pwork\harbaughrd\0332311\d076g30-sht-typical.dgn		DRAWN -	REVISED -		SCALE: N/A	SHEET NO. 2 OF 3 SHEETS	STA.	TO STA.	805	126-1RS-3	CLINTON	16	8
PLOT SCALE = 100.0000' / 1in.		CHECKED -	REVISED -					CONTRACT NO. 76G30					
PLOT DATE = 5/9/2014		DATE -	REVISED -		FED. ROAD DIST. NO. ILLINOIS FED. AID PROJECT								

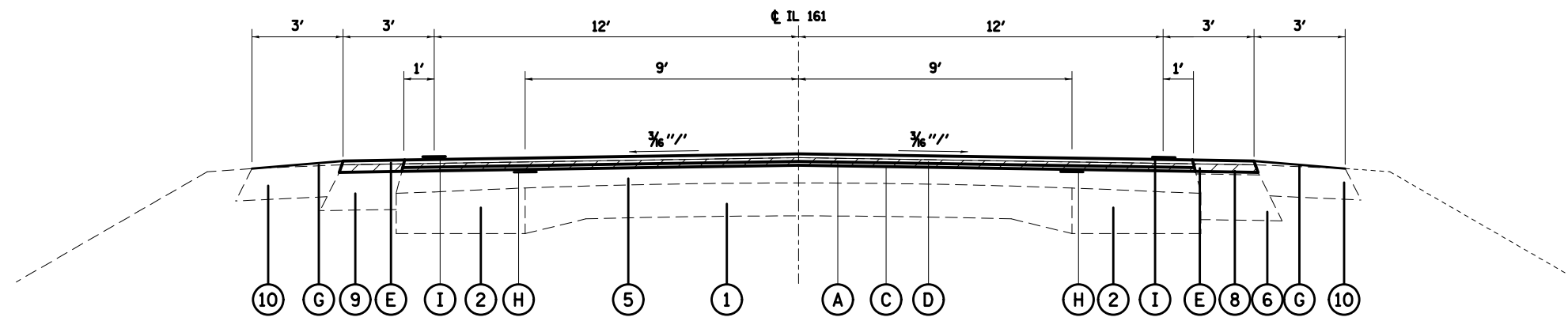

TYPICAL SECTION

STA. 1112+75 TO STA. 1116+98.5
 BRIDGE OMISSION STA. 1116+98.5 TO STA. 1121+11.5 (SN 014-0078)
 STA. 1121+11.5 TO STA. 1124+75

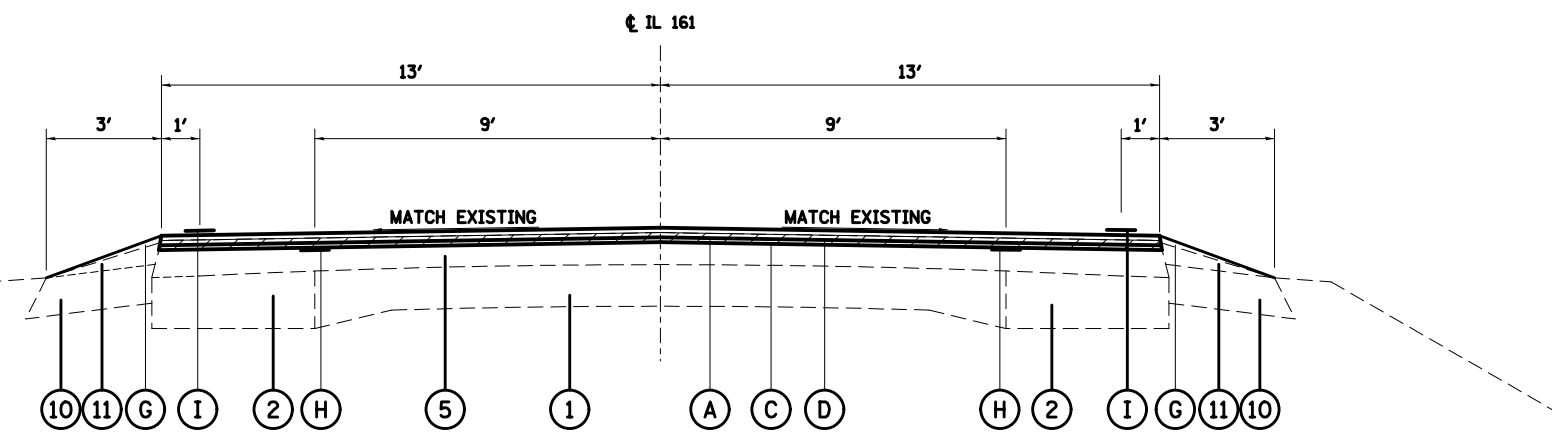

TYPICAL SECTION

STA. 1132+60 TO STA. 1134+99
 STA. 1135+90 TO STA. 1138+30

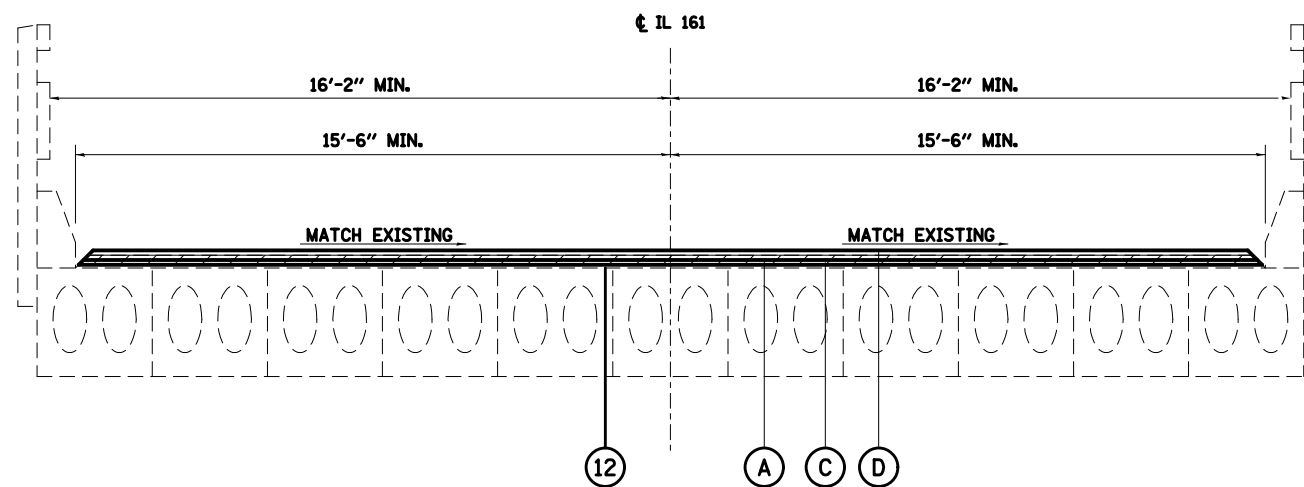

TYPICAL SECTION

STA. 1134+99 TO STA. 1135+90 (SN 014-0008)

NOTE: THE WATERPROOFING MEMBRANE SYSTEM SHOULD NOT BE DISTURBED DURING THE HOT-MIX ASPHALT SURFACE REMOVAL, IF IT IS DISTURBED IT SHALL BE REPAIRED BY THE CONTRACTOR AT THE CONTRACTOR'S EXPENSE.

LEGEND

- ① EXISTING P.C.C. PAVEMENT, 9-6 1/2-9
- ② EXISTING BASE COURSE WIDENING, 9"
- ③ EXISTING HOT-MIX ASPHALT RESURFACING, 3/4"
- ④ EXISTING HOT-MIX ASPHALT RESURFACING, ±4"
- ⑤ EXISTING HOT-MIX ASPHALT RESURFACING, ±5"
- ⑥ EXISTING HOT-MIX ASPHALT BASE COURSE, 8 1/2"
- ⑦ EXISTING COMBINATION CURB AND GUTTER, TYPE B-6.24
- ⑧ EXISTING HOT-MIX ASPHALT SHOULDER, 2"
- ⑨ EXISTING HOT-MIX ASPHALT SHOULDER, 9"
- ⑩ EXISTING AGGREGATE SHOULDERS, 6"
- ⑪ EXISTING AGGREGATE SHOULDERS, TYPE B"
- ⑫ EXISTING HOT-MIX ASPHALT RESURFACING AND WATERPROOFING MEMBRANE SYSTEM, ±2 1/2"
- A PROPOSED HOT-MIX ASPHALT SURFACE REMOVAL, 1 1/2"
- B PROPOSED HOT-MIX ASPHALT SURFACE REMOVAL, 2 1/4"
- C PROPOSED LEVELING BINDER (MACHINE METHOD), IL-9.5FG N70 (3/4")
- D PROPOSED HOT-MIX ASPHALT SURFACE COURSE, MIX "D", N70 (1 1/2")
- E PROPOSED HOT-MIX ASPHALT SHOULDERS (2 1/4")
- F PROPOSED HOT-MIX ASPHALT SHOULDERS, 8"
- G PROPOSED AGGREGATE WEDGE SHOULDER, TYPE B
- H PROPOSED STRIP REFLECTIVE CRACK CONTROL TREATMENT
- I PROPOSED THERMOPLASTIC PAVEMENT MARKING - LINE 4"
- J PROPOSED BITUMINOUS MATERIALS (PRIME COAT)

FILE NAME =	USER NAME = harbaughrd	DESIGNED -	REVISED -	STATE OF ILLINOIS DEPARTMENT OF TRANSPORTATION	TYPICAL SECTIONS			F.A.P. RTE.	SECTION	COUNTY	TOTAL SHEETS	SHEET NO.	
et:\pwork\pwork\harbaughrd\0332311\d076g30-sht-typical.dgn		DRAWN -	REVISED -		SCALE: N/A	SHEET NO. 3 OF 3 SHEETS	STA.	TO STA.	805	126-1RS-3	CLINTON	16	9
		CHECKED -	REVISED -					CONTRACT NO. 76G30					
		DATE -	REVISED -					ILLINOIS FED. AID PROJECT					

RESURFACING SCHEDULE

LOCATION		LENGTH	HOT-MIX ASPHALT SURFACE REMOVAL, 1 1/2"	HOT-MIX ASPHALT SURFACE REMOVAL, 2 1/4"	BITUMINOUS MATERIALS (PRIME COAT)	HOT-MIX ASPHALT SURFACE COURSE, MIX "D", N70	LEVELING BINDER (MACHINE METHOD), IL-9.5FG, N70	HOT-MIX ASPHALT SHOULDERS	HOT-MIX ASPHALT SHOULDERS, 8"	AGGREGATE WEDGE SHOULDER, TYPE B	STRIP REFLECTIVE CRACK CONTROL TREATMENT
STA.	TO STA.	FOOT	SQ YD	SQ YD	POUNDS	TON	TON	TON	SQ YD	TON	FOOT
941+10.00	TO 943+56.00	246.0		710.7	479.7	59.7	29.8				492
943+56.00	TO 945+10.00	154.0		684.4	300.3	57.5	28.7				616
945+10.00	TO 949+35.00	425.0	1227.8		828.8	103.2	51.6			26.3	850
949+35.00	TO 1042+84.00	9349.0	27008.4		18230.6	2268.9	1134.4			346.4	18698
1042+84.00	TO 1053+40.00	1056.0	3050.7		2059.2	256.3	128.2		352.0	39.2	2112
1053+40.00	TO 1061+75.00	835.0	2412.3		1628.3	202.7	101.4			31.0	1670
1061+75.00	TO 1073+47.00	1172.0	3385.8		2285.4	284.5	142.3		390.7	43.5	2344
1073+47.00	TO 1097+86.00	2439.0	7046.1		4756.1	591.9	296.0			90.4	4878
1097+86.00	TO 1106+92.00	906.0	2617.4		1766.7	219.9	110.0		302.0	33.6	1812
STATION EQUATION: STA. 1106+92.0 (AHEAD) = STA. 1104+28.9 (BACK)											
1104+28.90	TO 1111+74.00	745.1	2152.6		1452.9	180.9	90.5		248.3	27.6	1490
1111+74.00	TO 1112+75.00	101.0	291.8		197	24.6	12.3			3.8	202
1112+75.00	TO 1116+91.00	416.0	1386.7		936	101	50.5		23.2	7.8	832
1116+91.00	TO 1116+98.50	7.5	25.0		16.9	1.9			0.5	0.2	15
BRIDGE OMISSION (SN 014-0078)											
1116+98.50	TO 1121+11.50	413.0									
1121+11.50	TO 1121+19.00	7.5	25.0		16.9	1.9			0.5	0.2	15
1121+19.00	TO 1124+75.00	356.0	1186.7		801	86.4	43.2		19.8	6.6	712
1124+75.00	TO 1132+60.00	785.0	2267.8		1530.8	190.5	95.3			29.1	1570
1132+60.00	TO 1134+99.00	239.0	690.5		466.1	58.1	29.0			8.9	478
1134+99.00	TO 1135+90.00	91.0	313.5		211.6	26.4	13.2				
1135+90.00	TO 1138+30.00	240.0	693.4		468	58.3	29.1			8.9	480
1138+30.00	TO 1141+06.50	276.5	798.8		539.2	67.1	33.5			10.3	553
1141+06.50	TO 1141+14.00	7.5	21.7		14.6	1.9				0.2	15
TOTAL		20004	56602	1395.1	38986.1	4843.6	2419	44	1293	714	39834

PATCHING SCHEDULE

LOCATION	EB OR WB	LENGTH	WIDTH	PAVEMENT PATCHING,		
				TYPE II, 14 INCH	TYPE III, 14 INCH	TYPE IV, 14 INCH
STATION		FOOT	FOOT	SQ YD	SQ YD	SQ YD
953+67	EB	6	13	8.7		
954+67	EB	10	13	14.5		
955+20	EB	40	13			57.7
956+94	EB	30	13			43.3
967+39	EB	10	13	14.5		
967+39	WB	10	13	14.5		
970+72	EB	6	13	8.7		
981+39	EB	12	13		17.3	
1001+24	EB	20	13			28.8
1014+97	WB	12	13		17.3	
1016+92	WB	6	13	8.7		
1025+26	EB	20	6	13.4		
1029+38	EB	60	6			40
1038+15	EB	20	6	13.4		
1092+37	WB	20	13			28.8
STATION EQUATION: STA. 1106+92.0 (AHEAD) = STA. 1104+28.9 (BACK)						
1117+44	EB	12	13		17.3	
1117+44	WB	12	13		17.3	
SUBTOTAL				96.4	69.2	198.6
ANTICIPATED FAILURES (±15%)				14.6	10.8	30.4
TOTAL				111	80	229

PAVEMENT MARKING SCHEDULE

LOCATION			THERMOPLASTIC PAVEMENT MARKING -				SHORT TERM PAVEMENT MARKING	TEMPORARY PAVEMENT MARKING LINE		WORK ZONE PAVEMENT MARKING REMOVAL SQ FT	RAISED REFLECTIVE PAVEMENT MARKER	
			LINE 4"		LINE 24"			4"	24"		REMOVAL EACH	REMOVAL EACH
			SOLID WHITE	SKIP-DASH YELLOW	SOLID YELLOW	SOLID WHITE						
			FOOT	FOOT	FOOT	FOOT		FOOT	FOOT		FOOT	
STA.	TO	STA.										
IL 161												
941+10.00	TO	943+56.00	492	61.5			126.5	553.5		198.6	3	3
943+56.00	TO	944+07.30	102.8		102.7	25.5	26.6	205.5	25.5	122.5	1	1
944+47.30	TO	945+10.00	125.5		125.4	24.5	17.1	250.9	24.5	134.6	1	1
945+10.00	TO	965+59.00	4098	512.3			558.9	4610.3		1598.9	26	26
965+59.00	TO	971+77.00	1236	154.5	618		168.6	2008.5		688.3	8	8
971+77.00	TO	977+02.00	1050	131.3			143.4	1181.3		409.7	7	7
977+02.00	TO	983+07.00	1210	151.3	605		165	1966.3		673.8	8	8
983+07.00	TO	999+48.00	3282	410.3			447.6	3692.3		1280.5	21	21
999+48.00	TO	1004+82.00	1068	133.5	534		145.8	1735.5		594.7	7	7
1004+82.00	TO	1012+06.00	1448	181			197.7	1629		565.1	9	9
1012+06.00	TO	1017+46.00	1080	135	540		147.3	1755		601.4	7	7
1017+46.00	TO	1090+74.00	14656	1832			1998.6	16488		5718.1	92	92
1090+74.00	TO	1101+79.00	2210	276.3	1105		301.5	3591.3		1230.6	14	14
1101+79.00	TO	1103+24.00	290		290		39.6	580		197.8	2	2
1103+24.00	TO	1106+92.00	736	92	368		100.5	1196		409.9	5	5
1106+92.00	=	1104+28.90	STATION EQUATION									
1104+28.90	TO	1111+73.00	1488.3	186.1	744.2		203.1	2418.6		828.8	9	9
1111+73.00	TO	1116+98.50	1051	131.4			143.4	1182.4		410.1	7	7
1116+98.50	TO	1121+11.50	BRIDGE OMISSION									
1121+11.50	TO	1123+73.50	524	65.5			71.7	589.5		204.5	3	3
1123+73.50	TO	1134+84.00	2221	277.7	1110.5		303	3609.2		1236.8	14	14
1134+84.00	TO	1134+99.00	30		30		4.2	60		20.5	0	0
1134+99.00	TO	1135+90.00	182		182		24.9	364		124.1	2	2
1135+90.00	TO	1136+08.00	36		36		5.1	72		24.6	0	0
1136+08.00	TO	1141+14.00	1012	126.5	506		138	1644.5		563.5	6	6
IL 160												
754+82.00	TO	755+56.20	148.5		148.4	22.5	20.5	296.9	22.5	146.3	1	1
756+02.20	TO	756+80.00	155.8		155.7	27.5	21.4	311.5	27.5	161.3	1	1
SUBTOTAL			39932.9	4858.2	7200.9							
TOTAL			51992		100		5520	51992	100	18145	254	254

TEMPORARY RAMP SCHEDULE

LOCATION	COMMENTS	ENTRANCE MATERIAL	SIDE	LENGTH FOOT	WIDTH FOOT	TEMPORARY RAMP SQ YD
941+10	BEGIN PROJECT			26	7.5	21.7
942+40	COMMERCIAL ENTRANCE	CONC/HMA	LT	3	55	18.4
943+40	COMMERCIAL ENTRANCE	CONC/HMA	LT	3	55	18.4
944+27.30	IL 160 - STA. 754+82			22	7.5	18.4
944+27.30	IL 160 - STA. 756+80			22	7.5	18.4
1013+85	PRIVATE ENTRANCE	HMA	LT	3	35	11.7
1023+90	PRIVATE/COMM ENTRANCE	CONC	RT	3	74	24.7
1037+75	TANK ROAD (TR 28)	O&C	LT	3	60	20
1051+40	BILLHARTZ ROAD (TR 30)	HMA/O&C	RT	3	55	18.4
1081+65	WINTER ROAD (TR 38)	O&C	RT	3	56	18.7
1102+95	PRIVATE ENTRANCE	HMA	RT	3	60	20
1104+30	PRIVATE ENTRANCE	HMA	RT	3	35	11.7
1104+70	PRIVATE ENTRANCE	HMA	RT	3	34	11.4
STATION EQUATION: STA. 1106+92 (BACK) = STA. 1104+28.9 (AHEAD)						
1105+81	THOLE ROAD (MUN 5000)	O&C	LT	3	48	16
1105+81	THOLE ROAD (MUN 5000)	O&C	RT	3	40	13.4
1111+95	PRIVATE ENTRANCE	HMA	LT	3	32	10.7
1114+16	PRIVATE ENTRANCE	CONC	LT	3	35	11.7
1137+05	PRIVATE ENTRANCE	CONC	RT	3	32	10.7
1137+15	PRIVATE ENTRANCE	HMA	LT	3	25	8.4
1139+70	PRIVATE ENTRANCE	HMA	LT	3	30	10
1140+84	EXISTING JOINT					
1141+14	END PROJECT			40	5	22.2
TOTAL						335

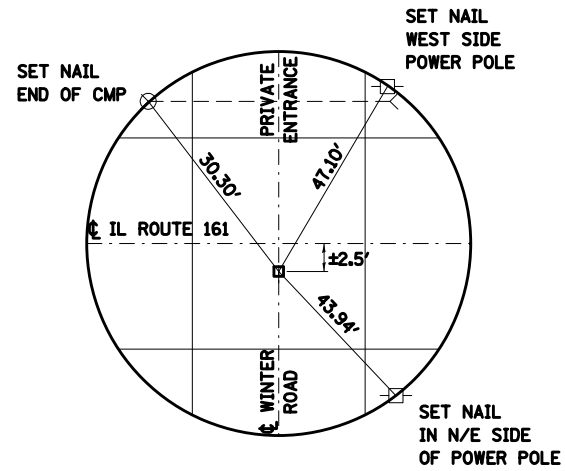

BRASS PLATE WITH SQUARE
N 1/4 COR 15 T1N R3W
(ON N/S CENTER LINE OF WINTER RD.)

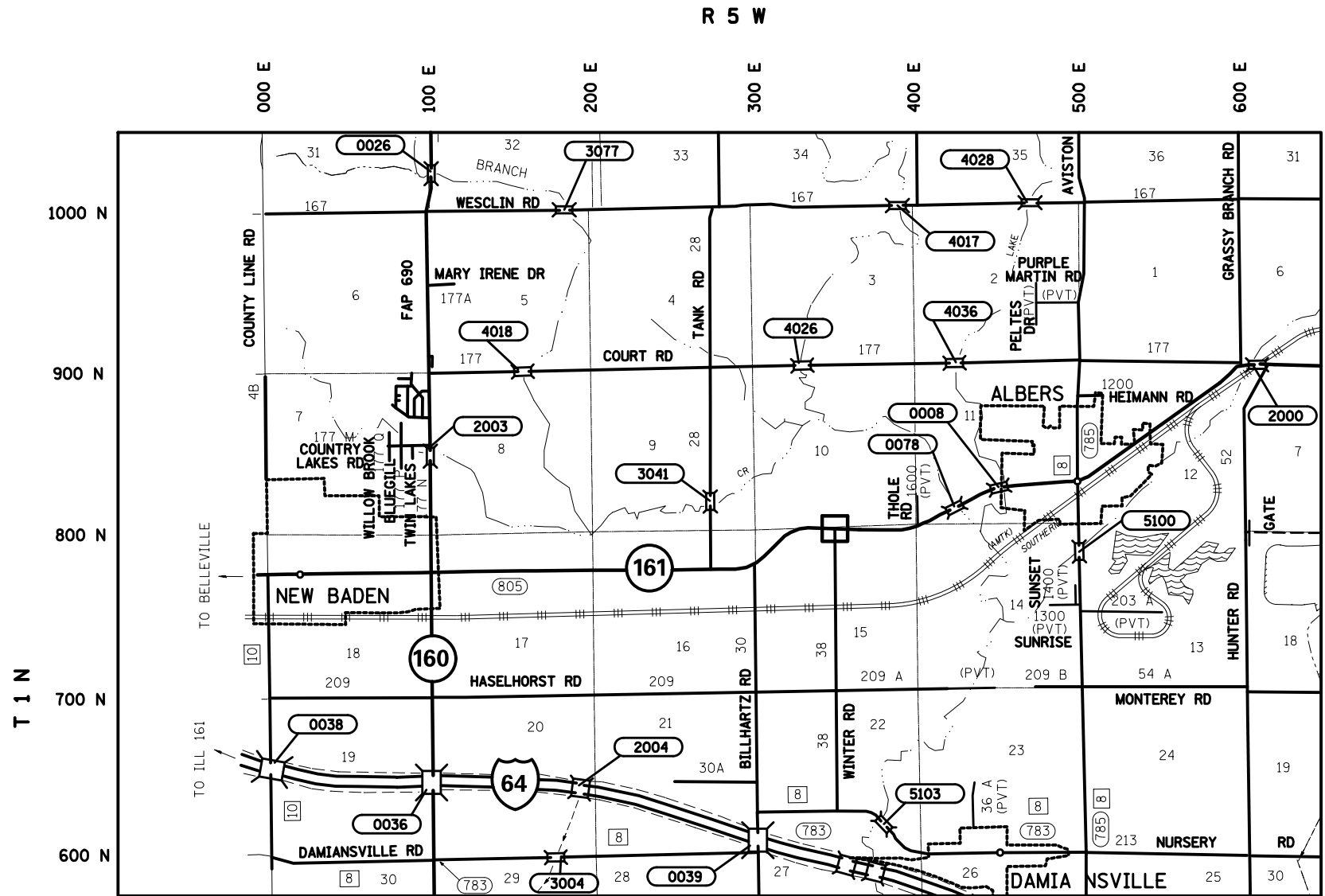

□ - SURVEY COVER MONUMENT LOCATION - 1 EACH
NORTH 1/4 CORNER SECTION 15
T.1.N., R.3.W.

FILE NAME =	USER NAME = harbaughrd	DESIGNED -	REVISED -	STATE OF ILLINOIS DEPARTMENT OF TRANSPORTATION	SURVEY MONUMENT COVER ASSEMBLY			F.A.P. RTE.	SECTION	COUNTY	TOTAL SHEETS	SHEET NO.	
et:\pwork\pwork\harbaughrd\0332311\076g30-sht-ATB.dgn	16g30-sht-ATB.dgn	DRAWN -	REVISED -					805	126-IRS-3	CLINTON	16	13	
	PLOT SCALE = 100.0000' / 1" =	CHECKED -	REVISED -		SCALE: N/A			SHEET NO. 1 OF 1 SHEETS		STA.	TO STA.		CONTRACT NO. 76G30
	PLOT DATE = 5/9/2014	DATE -	REVISED -		ILLINOIS FED. AID PROJECT								

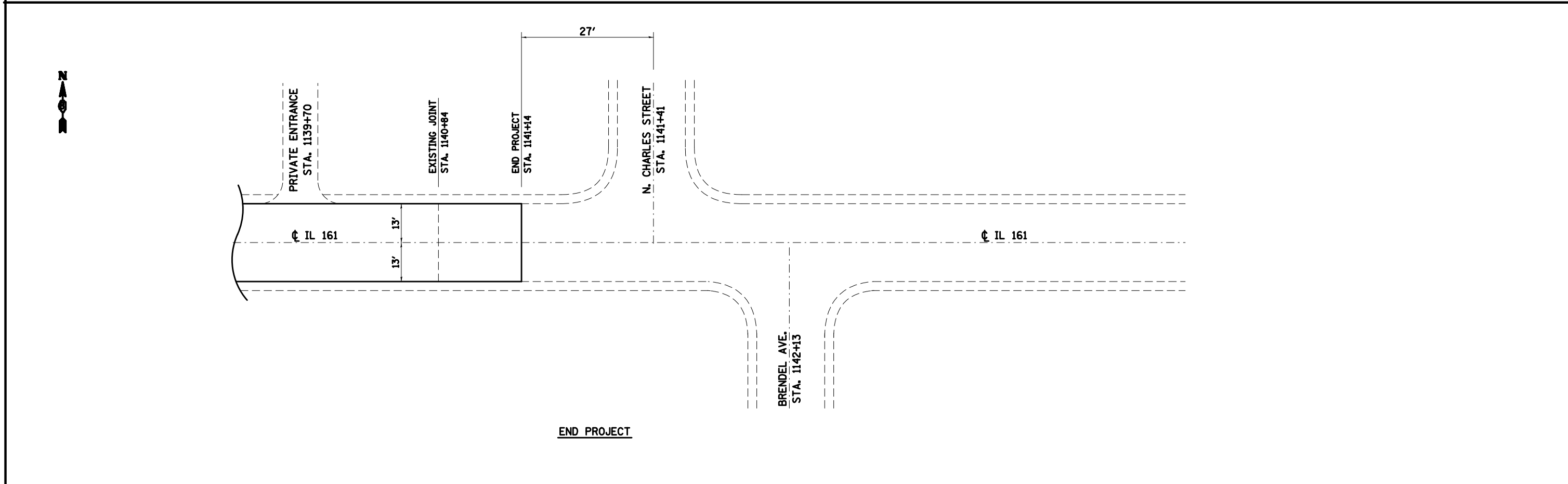
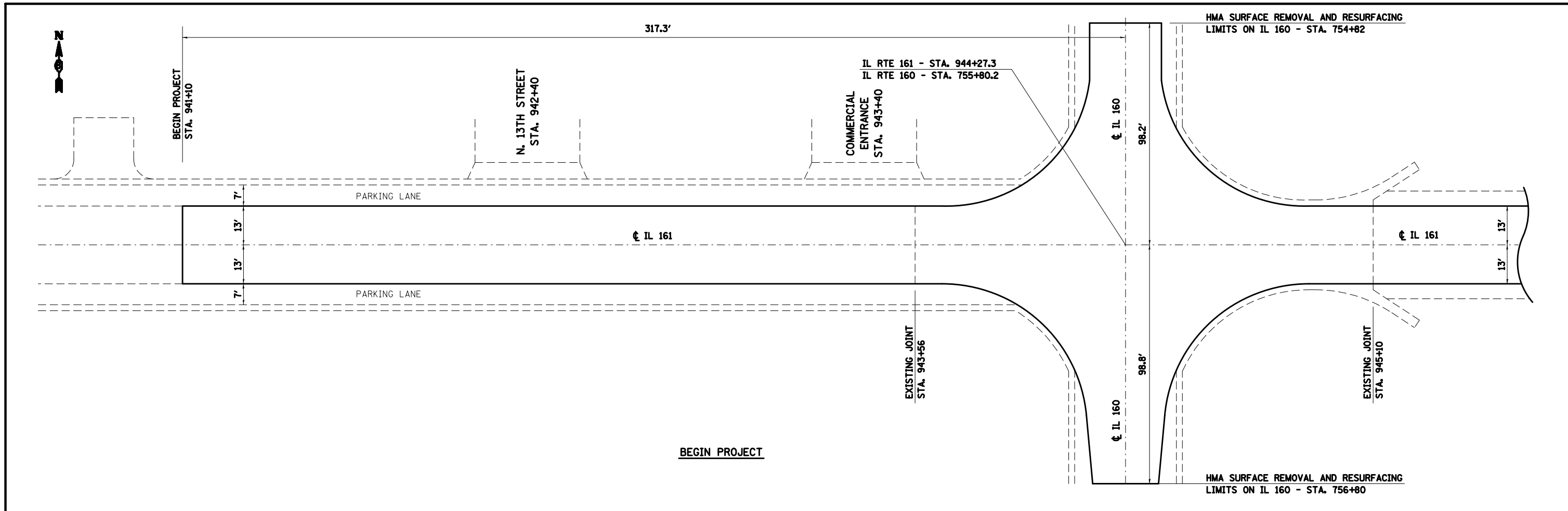

FILE NAME = c:\pwwork\pwwork\harbaugh\rd\0332311.dwg	USER NAME = harbaughrd	DESIGNED -	REVISED -	STATE OF ILLINOIS DEPARTMENT OF TRANSPORTATION	MISCELLANEOUS DETAILS BEGIN PROJECT AND END PROJECT DETAIL			F.A.P. RTE. 805	SECTION 126-1RS-3	COUNTY CLINTON	TOTAL SHEETS 16	SHEET NO. 14
	PLOT SCALE = 100.0000' / 1in.	DRAWN -	REVISED -		SCALE: N/A	SHEET NO. 1 OF 3 SHEETS	STA.	TO STA.	CONTRACT NO. 76G30			
	PLOT DATE = 5/9/2014	CHECKED -	REVISED -		FED. ROAD DIST. NO. ILLINOIS FED. AID PROJECT							
		DATE -	REVISED -									

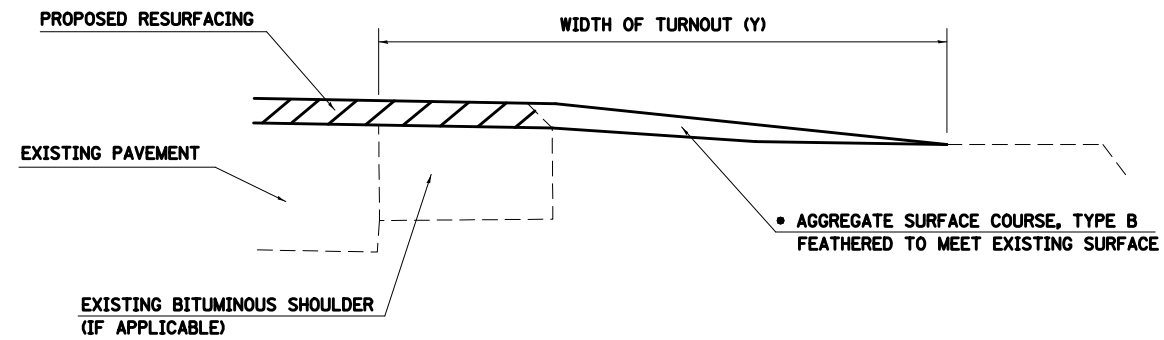

TYPICAL SECTION AT MAILBOX TURNOUT

NOTE: SEE STANDARD 406201 FOR MAILBOX TURNOUT DETAILS

- EXISTING MAILBOX TURNOUTS THAT ARE BITUMINOUS SHALL BE FEATHERED WITH INCIDENTAL HOT-MIX ASPHALT SURFACING. SEE SIDE ROAD & ENTRANCE SCHEDULE FOR LOCATION.

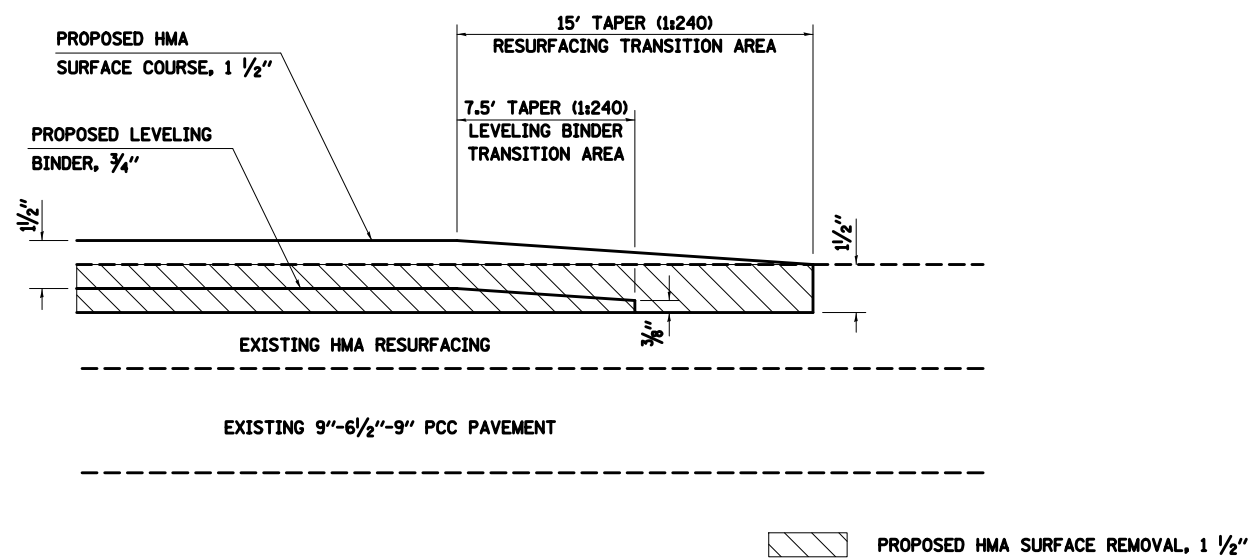
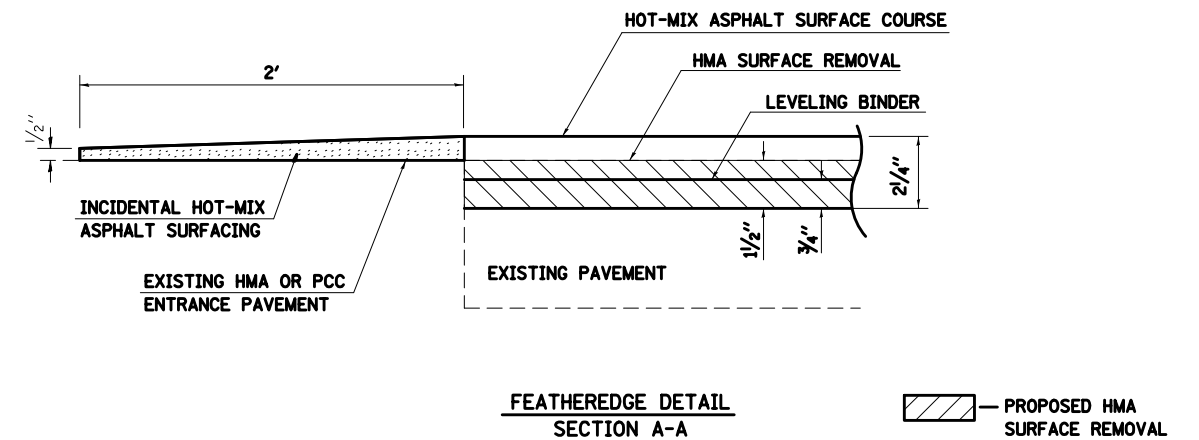

BUTT JOINT ELEVATION VIEW

STA. 1116+83.5 TO STA. 1116+98.5
 STA. 1121+11.5 TO STA. 1121+26.5
 STA. 1140+99 TO STA. 1141+14

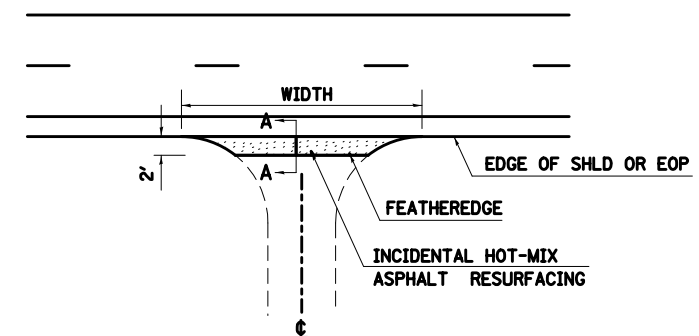

ENTRANCE DETAIL
 (FOR EXISTING HMA OR PCC APRONS)

FILE NAME =	USER NAME = harbaughrd	DESIGNED -	REVISED -
et:\pwork\pwork\pwork\harbaughrd\0332311.dgn		DRAWN -	REVISED -
	PLOT SCALE = 100.0000' / 1in.	CHECKED -	REVISED -
	PLOT DATE = 5/9/2014	DATE -	REVISED -

STATE OF ILLINOIS
 DEPARTMENT OF TRANSPORTATION

MISCELLANEOUS DETAILS			
RESURFACING DETAILS			
SCALE: N/A	SHEET NO. 2 OF 3 SHEETS	STA.	TO STA.

F.A.P. RTE.	SECTION	COUNTY	TOTAL SHEETS	SHEET NO.
805	126-IRS-3	CLINTON	16	15
CONTRACT NO. 76G30				
ILLINOIS FED. AID PROJECT				

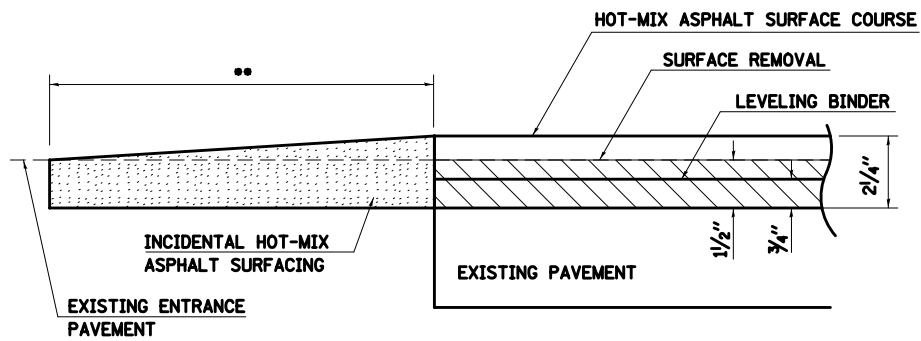

**TRANSITION DETAIL
SECTION A-A**

PROPOSED HMA SURFACE REMOVAL

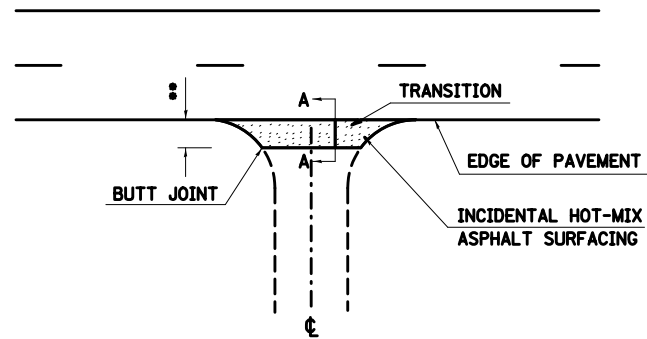

SIDEROAD DETAIL

EOP ELEVATION CHANGE	**TOTAL TRANSITION LENGTH
3/4"	3.5'
1"	5'
1-1/2"	7.5'
2"	10'
2-1/2"	12.5'
3"	15'
3-1/2"	17.5'
4"	20'
4-1/2"	22.5'
5"	25'
5-1/2"	27.5'
6"	30'

NOTE: WHERE THE HMA TRANSITION IS MATCHING INTO AN EXISTING HMA SIDE ROAD SURFACE, A MILLED BUTT JOINT SHALL BE CONSTRUCTED WITHIN THE LIMITS OF THE TOTAL TRANSITION LENGTH ON THE LOCAL ROUTE.

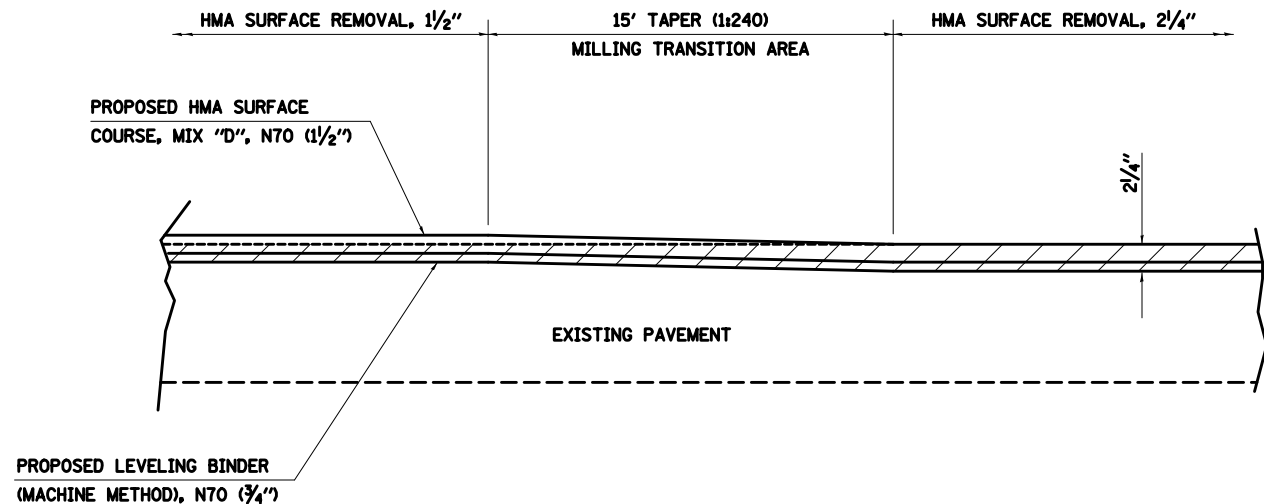

MILLING TRANSITION DETAIL

NOTE: AREA OF MILLING TRANSITION SHALL BE INCLUDED IN THE CONTRACT UNIT PRICE FOR THE HOT-MIX ASPHALT SURFACE REMOVAL, 2 1/4". NO ADDITIONAL COMPENSATION SHALL BE ALLOWED.

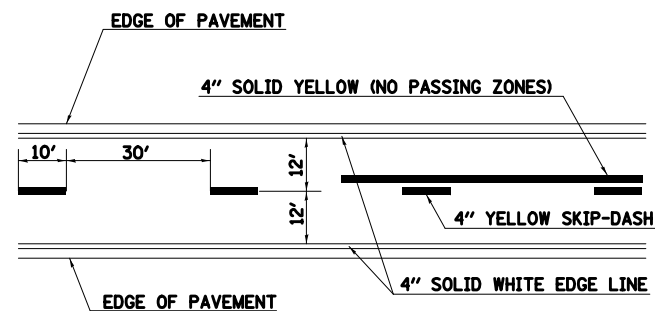

PAVEMENT MARKING DETAIL

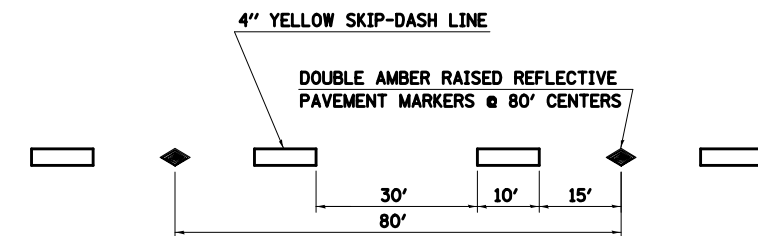

TYPICAL APPLICATION FOR YELLOW SKIP-DASH LINES WITH RAISED REFLECTIVE PAVEMENT MARKERS

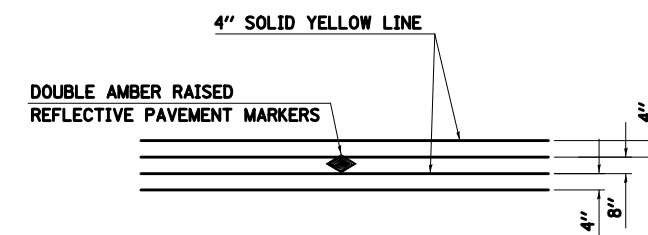

TYPICAL APPLICATION FOR DOUBLE YELLOW LANE LINES WITH RAISED REFLECTIVE PAVEMENT MARKERS