

NOTE: ALT A & ALT B OPTION BEGINS AT STATION 449+88.13 AND CONTINUES TO THE END OF THE PROJECT.

STA. 606+40.43 (US 45) = STA. 10+00.00 (UNTHANK RD.)  
 INTERSECTION ANGLE = 90°  
 STA. 606+40.43 (US 45) = STA. 10+00.00 (FLANDERS RD.)  
 INTERSECTION ANGLE = 90°

EXISTING ABELL RD.  
 TO BE RELOCATED  
 JOSEPH & DONALD UNTHANK, ETAL

DAVID G. & TONI D. SINKS

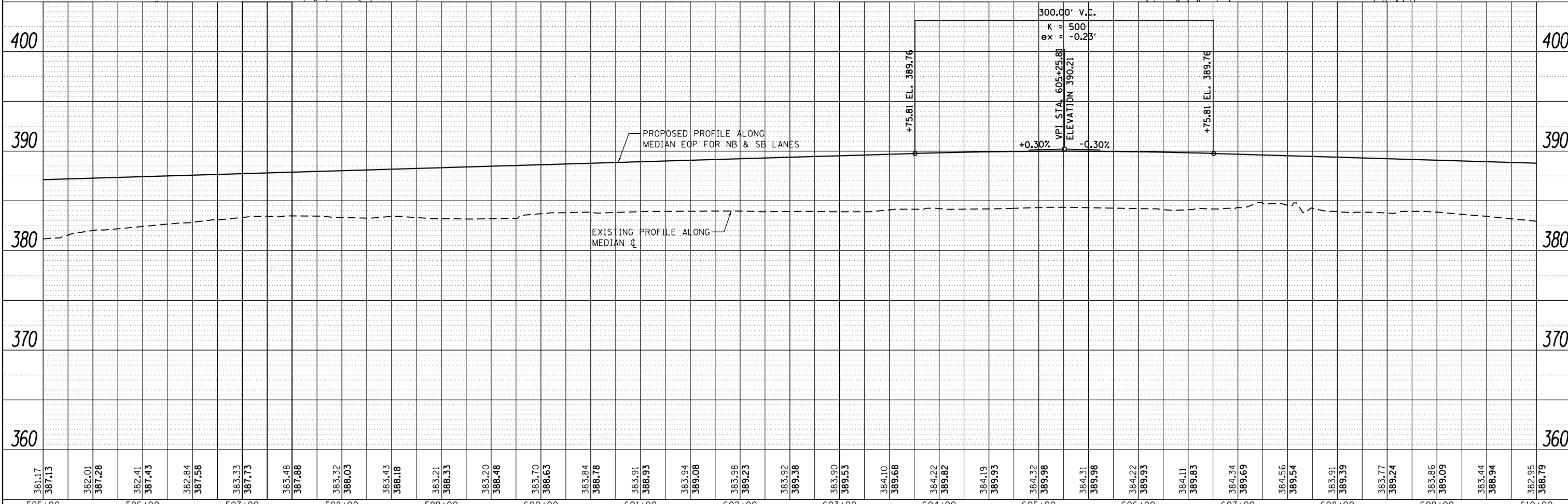
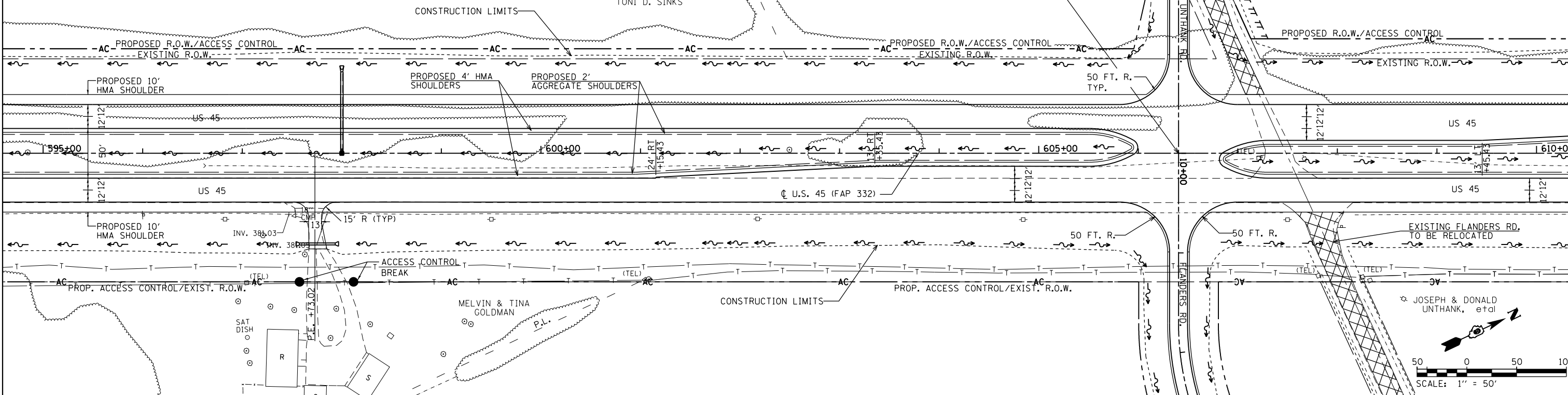

DATE  
 BY  
 SURVEYED  
 PLOTTED  
 ALIGNED  
 CHECKED  
 DRAWN  
 NO.  
 PLAN

DATE  
 BY  
 SURVEYED  
 PLOTTED  
 GRADES CHECKED  
 STRUCTURE NOTATIONS CHECKED  
 NO.  
 PROFILE

FILE NAME =	USER NAME = bemery	DESIGNED -	REVISED -	<b>STATE OF ILLINOIS          DEPARTMENT OF TRANSPORTATION</b>	<b>ROADWAY PLAN &amp; PROFILE          U.S. 45</b>	F.A.P. RTE. 332	SECTION (29,30)R-1	COUNTY SALINE	TOTAL SHEETS 745	SHEET NO. 160		
P:\Projects\2011 Projects\11297 - I00T US45	Ph2\CV\CADD Sheets\0978077-sh1-plnprof-US45	DRAWN -	REVISED -			SCALE: 1"=50'	SHEET NO. OF SHEETS	STA. 595+00.00 TO STA. 610+00.00	ILLINOIS FED. AID PROJECT			
PLOT SCALE = 100.0000' / in.		CHECKED -	REVISED -			CONTRACT NO. 78077						
PLOT DATE = 4/30/2014		DATE -	REVISED -									