

NOTE: ALT A & ALT B OPTION BEGINS AT STATION 449+88.13 AND CONTINUES TO THE END OF THE PROJECT.

ROGER SWEENEY, ETAL

STA. 649+37.28 (US 45) = STA. 10+00.00 (GARNER RD.)
INTERSECTION ANGLE = 90°

GRADE DITCH TO DRAIN INTO PROPOSED WETLAND. SEE WETLAND PLAN.

WILMA GARNER TRUST

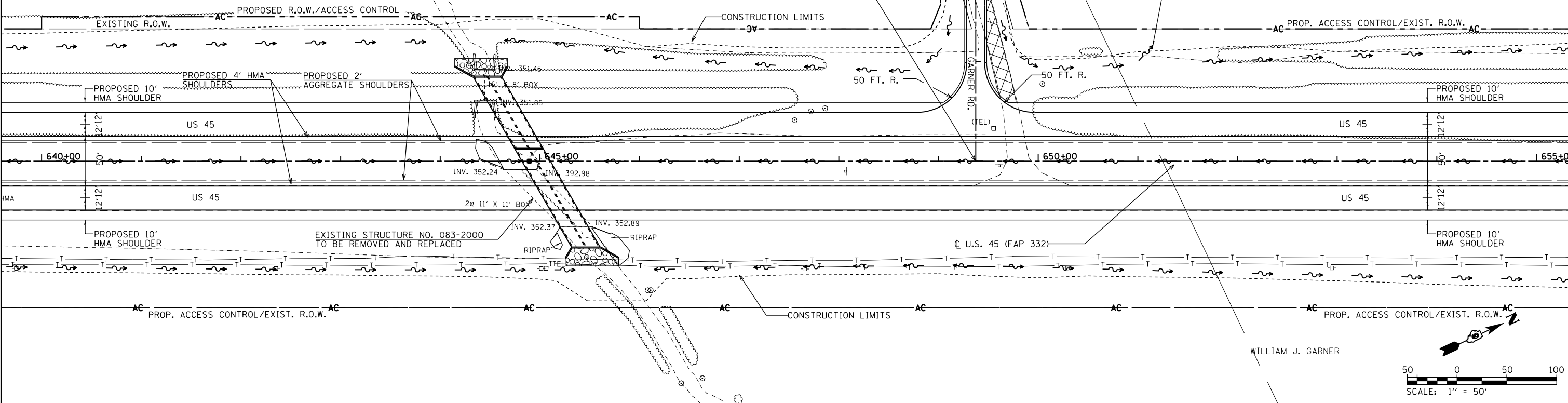

PLAN	SURVEYED	DATE
	PLOTTED	
	ALIGNMENT CHECKED	
	GRADE CHECKED	
	STRUCTURE NOTATIONS CHECKED	
	NO. _____	

PROFILE	SURVEYED	DATE
	PLOTTED	
	GRADES CHECKED	
	STRUCTURE NOTATIONS CHECKED	
	NO. _____	

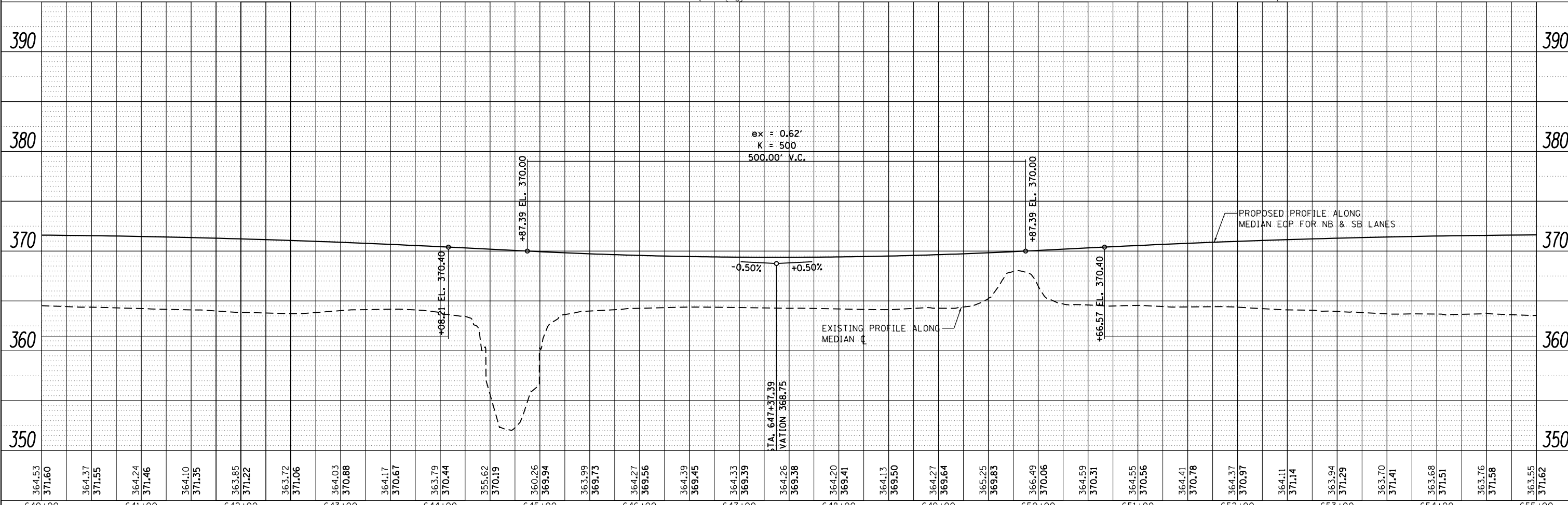

FILE NAME =	USER NAME = bemery	DESIGNED -	REVISED -
P:\Projects\2011 Projects\11297 - I00T US45	Ph2\CV\CADD Sheets\0978077-shr-plnprof-US45	DRAWN -	REVISED -
	PLOT SCALE = 100.0000' / in.	CHECKED -	REVISED -
	PLOT DATE = 4/30/2014	DATE -	REVISED -

STATE OF ILLINOIS
DEPARTMENT OF TRANSPORTATION

ROADWAY PLAN & PROFILE
U.S. 45

SCALE: 1"=50' SHEET NO. OF SHEETS STA. 640+00.00 TO STA. 655+00.00

F.A.P. RTE.	SECTION	COUNTY	TOTAL SHEETS	SHEET NO.
332	(29,30)R-1	SALINE	745	163
CONTRACT NO. 78077			ILLINOIS FED. AID PROJECT	