

**MAINTENANCE OF TRAFFIC STAGE 1A (THIS SHEET)**

**SEQUENCE OF CONSTRUCTION**

1. PROVIDE TEMPORARY AGGREGATE SURFACE COURSE WIDENING PER PROJECT DETAIL; CONSTRUCTING CULVERT UNDER TRAFFIC. REMOVE EXISTING 3'X3' RCBC AND CONSTRUCT PROPOSED 5'X3' RCBC. CULVERT SHALL BE COMPLETELY CONSTRUCTED UNDER TRAFFIC PER PROJECT DETAIL ABOVE PRIOR TO PERMANENT WIDENING CONSTRUCTION. TEMPORARY TRAFFIC SIGNAL LOCATIONS SHOWN ON PLANS ARE APPROXIMATE AND SHOULD BE PLACED PER HIGHWAY STANDARD 701316.
2. WIDEN EXISTING U.S. 45 TO THE NORTH (BASE AND BINDER COURSE ONLY - SURFACE COURSE TO BE CONSTRUCTED IN STAGE 3), CONSTRUCT CURB & GUTTER, ENTRANCES, SIDEWALK, AND SHOULDER.
3. CONSTRUCT JEFFERSON STREET, GROVE STREET, AND DEWEY ROAD ONE LANE AT A TIME UNDER TRAFFIC. USE FLAGMEN FOR LANE CLOSURE AND BUILD PARTS OF ROAD UNDER TRAFFIC IN LIFTS.

**TRAFFIC PLACEMENT**

1. MAINTAIN TRAFFIC ON EXISTING U.S. 45
2. ALL SIDEROADS SHALL REMAIN OPEN AND SHALL BE CONSTRUCTED UNDER TRAFFIC
3. ALL ENTRANCES SHALL REMAIN OPEN AND SHALL BE CONSTRUCTED UNDER TRAFFIC
4. TRAFFIC CONTROL DEVICES USED FOR TRAFFIC CONTROL SHALL BE PLACED IN THE WIDENING ALONG THE EDGE OF PAVEMENT WHEN NO WORK OPERATIONS ARE PRESENT AT THE END OF EACH WORK DAY AND WEEKENDS.







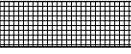

**TRAFFIC CONTROL STANDARDS**

701006, 701201, 701326, 701901

**TRAFFIC CONTROL PAYMENT**

TRAFFIC CONTROL AND PROTECTION, LUMP SUM AS PER TRAFFIC CONTROL STANDARD USED

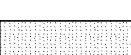
**LEGEND**

	TEMPORARY PAVEMENT CONSTRUCTED AS NOTED		DIRECTION OF TRAFFIC FLOW
	PERMANENT PAVEMENT CONSTRUCTED THIS STAGE		CONSTRUCTION SIGN
	PERMANENT PAVEMENT CONSTRUCTED IN PREVIOUS STAGE		TYPE III BARRICADE
	PAVEMENT REMOVAL THIS STAGE		DRUMS WITH STEADY BURNING MONODIRECTIONAL LIGHTS @ 25' CENTERS
			SIGN PANEL/BARRICADE ASSEMBLY (INCLUDED IN THE COST FOR TRAFFIC CONTROL AND PROTECTION, LUMP SUM)

**NOTES:**

ALL SIDEROADS / ENTRANCES ARE TO REMAIN OPEN AND BE CONSTRUCTED WITH MINIMAL TEMPORARY SHUTDOWNS AT THE DIRECTION OF THE ENGINEER.

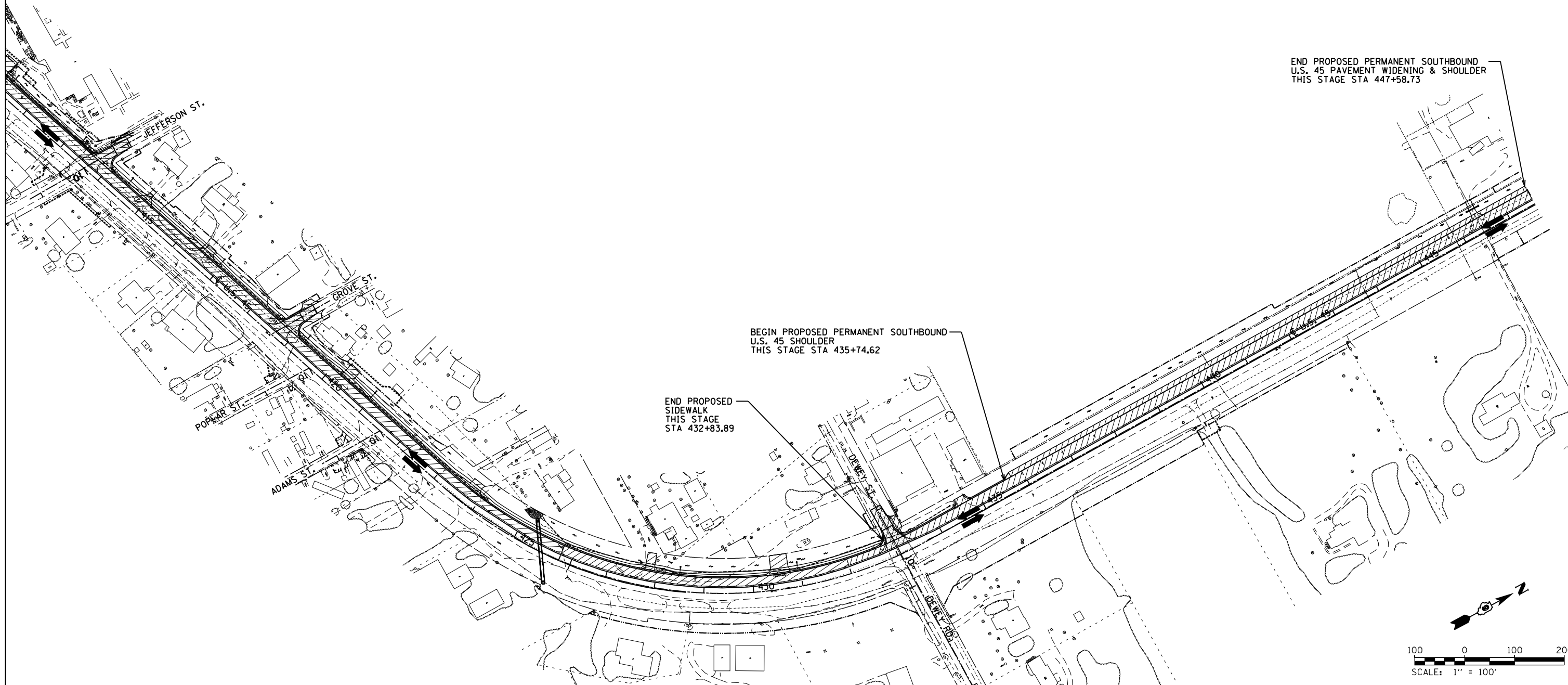

FILE NAME =	USER NAME = bemory	DESIGNED -	REVISED -	<b>STATE OF ILLINOIS DEPARTMENT OF TRANSPORTATION</b>	<b>CONSTRUCTION STAGING PLAN STAGE 1A</b>				F.A.P. RTE.	SECTION	COUNTY	TOTAL SHEETS	SHEET NO.	
		DRAWN -	REVISED -		SCALE: 1" = 100'	SHEET	OF	SHEETS	STA. 412+00.00	TO STA. 447+58.73	332	(29,30)R-1	SALINE	745 194
		CHECKED -	REVISED -		<b>CONTRACT NO. 78077</b>									
		DATE -	REVISED -		ILLINOIS FED. AID PROJECT									