

TEMPORARY PAVEMENT CONSTRUCTED AS NOTED
 PERMANENT PAVEMENT CONSTRUCTED THIS STAGE
 PERMANENT PAVEMENT CONSTRUCTED IN PREVIOUS STAGE
 ROADWAY REMOVAL THIS STAGE
 DIRECTION OF TRAFFIC FLOW
 TYPE III BARRICADE
 TEMPORARY FLOW ARROW
 DRUMS WITH STEADY BURNING MONODIRECTIONAL LIGHTS
 SIGN PANEL/BARRICADE ASSEMBLY (INCLUDED IN THE COST FOR TRAFFIC CONTROL AND PROTECTION, LUMP SUM)

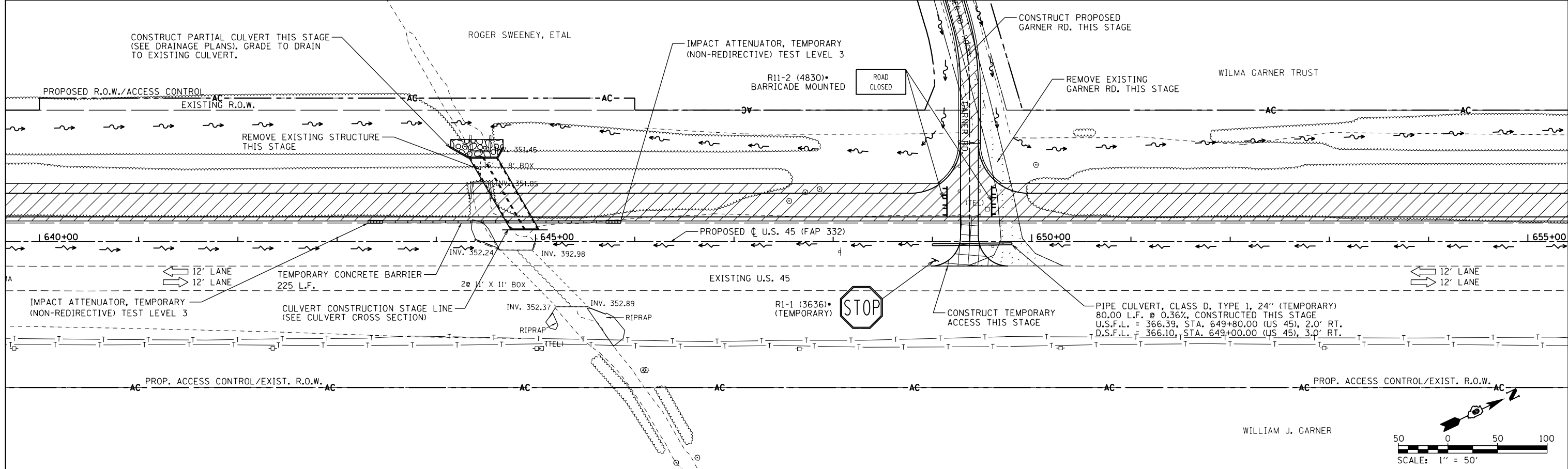

FILE NAME =	USER NAME = bemery	DESIGNED -	REVISED -	STATE OF ILLINOIS DEPARTMENT OF TRANSPORTATION	MAINTENANCE OF TRAFFIC - STAGE 1A U.S. 45	F.A.P. RTE. =	SECTION =	COUNTY =	TOTAL SHEETS =	SHEET NO. =	
						332	(29,30)R-1	SALINE	745	211	
						CONTRACT NO. 78077					
						ILLINOIS FED. AID PROJECT					
Default	P:\Projects\2011 Projects\11297 - IDOT US 45 Ph2\CV\CADD Sheets\0978077-sht-MOT-Stage1A.dgn			SCALE: 1" = 50'		SHEET	OF	SHEETS	STA. 625+00.00	TO STA. 655+00.00	