

	TEMPORARY PAVEMENT CONSTRUCTED AS NOTED		PERMANENT PAVEMENT CONSTRUCTED THIS STAGE		PERMANENT PAVEMENT CONSTRUCTED IN PREVIOUS STAGE		ROADWAY REMOVAL THIS STAGE		DIRECTION OF TRAFFIC FLOW		TYPE III BARRICADE		TEMPORARY FLOW ARROW		CONSTRUCTION SIGN		DRUMS WITH STEADY BURNING MONODIRECTIONAL LIGHTS @ 25' CENTERS		SIGN PANEL/BARRICADE ASSEMBLY (INCLUDED IN THE COST FOR TRAFFIC CONTROL AND PROTECTION, LUMP SUM)
--	---	--	---	--	--	--	----------------------------	--	---------------------------	--	--------------------	--	----------------------	--	-------------------	--	--	--	---

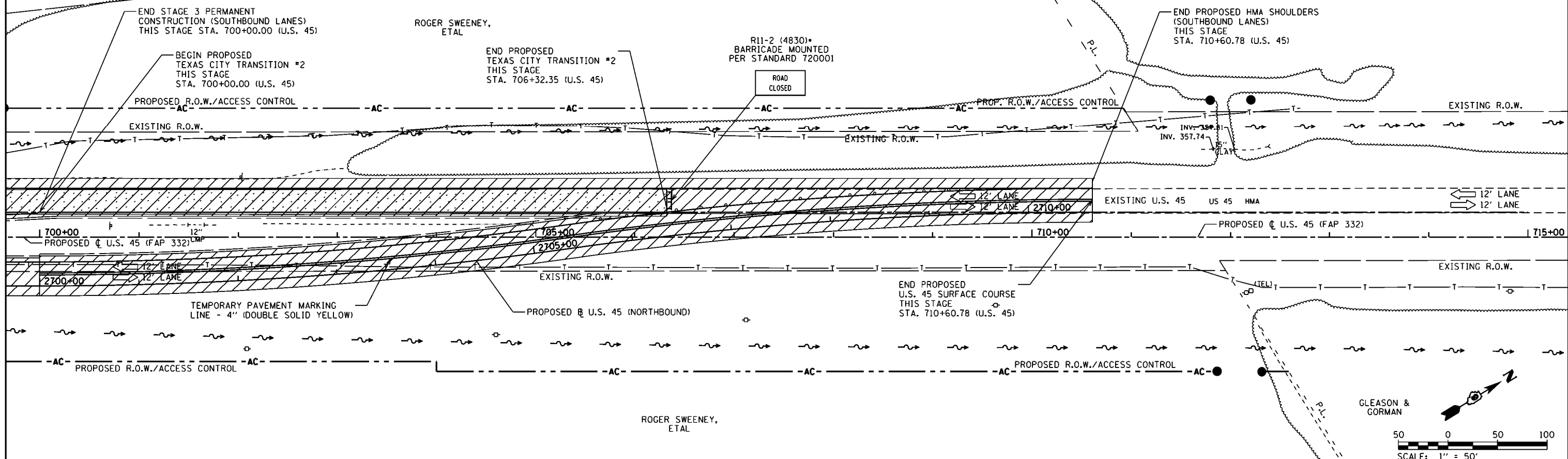

FILE NAME =	USER NAME = bemory	DESIGNED -	REVISED -	STATE OF ILLINOIS DEPARTMENT OF TRANSPORTATION	MAINTENANCE OF TRAFFIC - STAGE 3 U.S. 45				F.A.P. RTE. = 332	SECTION = (29,30)R-1	COUNTY = SALINE	TOTAL SHEETS = 745	SHEET NO. = 317
Default	Pl:\Projects\2011 Projects\11297 - IDOT US 45 Ph2\CV\CADD Sheets\0978077-sht-MOT-Stage3-DRAWN	CHECKED -	REVISED -		SCALE: 1" = 50'	SHEET	OF	SHEETS	STA. 685+00.00	TO STA. 715+00.00	CONTRACT NO. 78077		
	PLOT SCALE = 100.0000' / 1in.	DATE -	REVISED -		ILLINOIS FED. AID PROJECT								
	PLOT DATE = 4/30/2014												