

DATE	
BY	
FINAL SURVEY PLOTTED	
NOTE BOOK AREAS CHECKED	
NO.	

DATE	
BY	
ORIGINAL SURVEY PLOTTED	
NOTE BOOK AREAS CHECKED	
NO.	

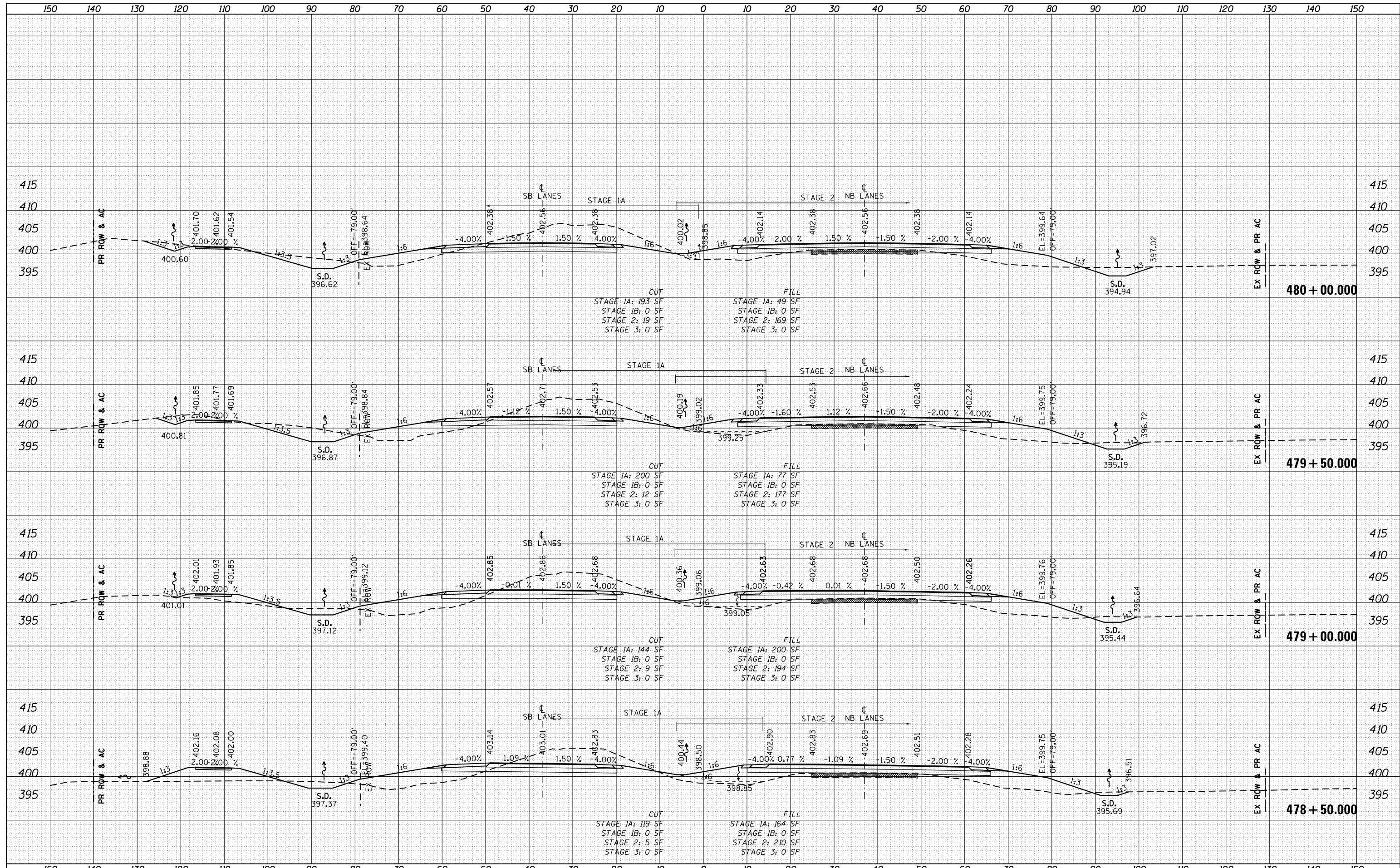

FILE NAME =	USER NAME = bemory	DESIGNED -	REVISED -	STATE OF ILLINOIS DEPARTMENT OF TRANSPORTATION	CROSS SECTIONS U.S. 45 (F.A.P. 332)			F.A.P. R.T.E. 332	SECTION (29,30)R-1	COUNTY SALINE	TOTAL SHEETS 745	SHEET NO. 547
P:\Projects\2011 Projects\11297 - IDOT US45 Ph2\CV\CADD Sheets\0978077-sht-xsc.dgn		DRAWN -	REVISED -		SCALE: 1" = 10'	SHEET	OF	SHEETS	STA. 478+50.00	TO STA. 480+00.00	CONTRACT NO. 78077	
PLOT SCALE = 20.0000' / in.		CHECKED -	REVISED -		ILLINOIS FED. AID PROJECT							
PLOT DATE = 4/30/2014		DATE -	REVISED -									