

DATE	
BY	
FINAL SURVEY	
SURVEYED	
PLOTTED	
TEMPLATE	
NOTE BOOK	
AREAS CHECKED	
NO.	

DATE	
BY	
ORIGINAL SURVEY	
SURVEYED	
PLOTTED	
TEMPLATE	
NOTE BOOK	
AREAS CHECKED	
NO.	

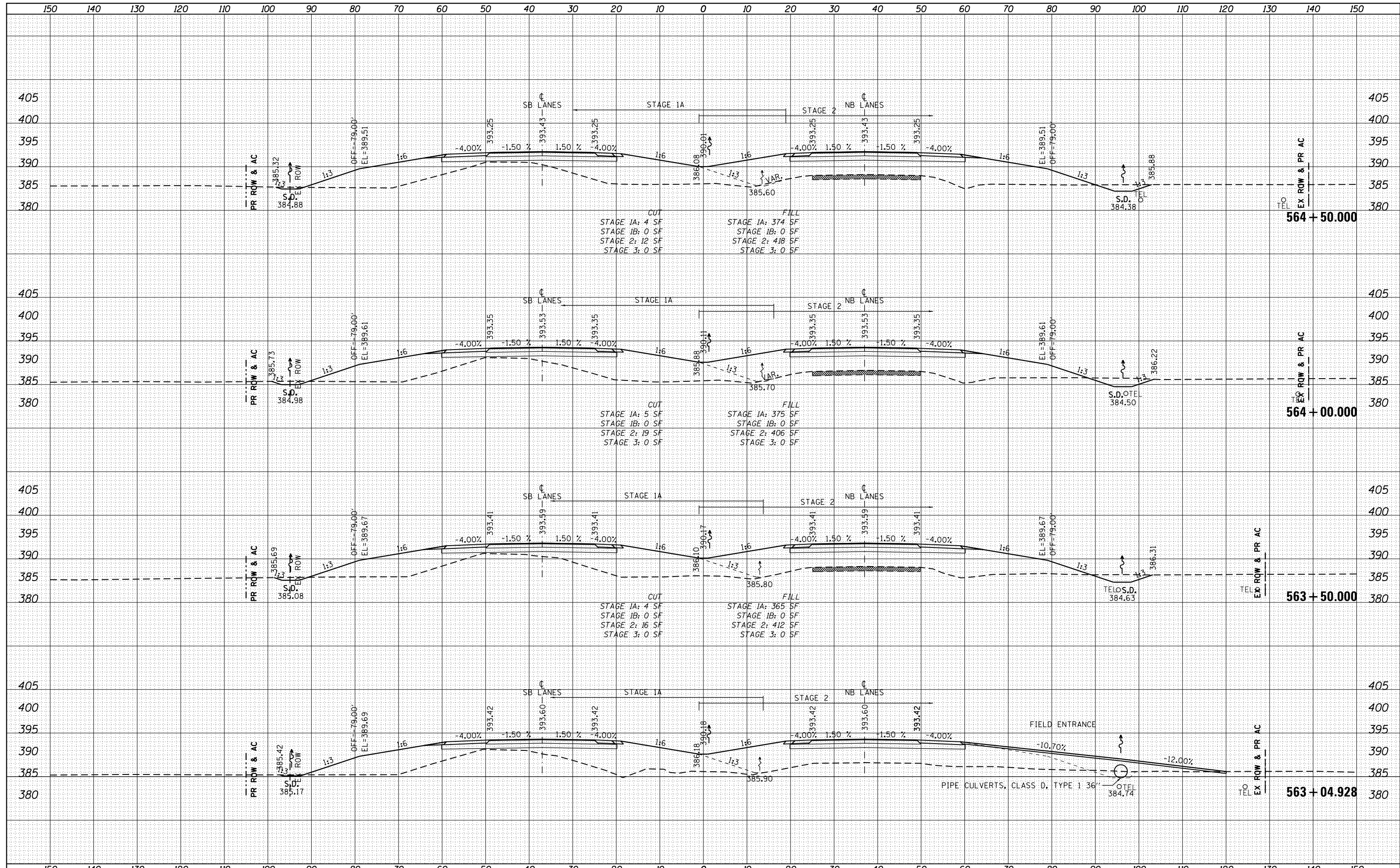

FILE NAME =	USER NAME = bemery	DESIGNED -	REVISED -	<b>STATE OF ILLINOIS</b> <b>DEPARTMENT OF TRANSPORTATION</b>	<b>CROSS SECTIONS U.S. 45 (F.A.P. 332)</b>			F.A.P. RTE.	SECTION	COUNTY	TOTAL SHEETS	SHEET NO.
P:\Projects\2011 Projects\11297 - IDOT US45 Ph2\CV\CADD Sheets\0978077-sht-xsc.dgn		DRAWN -	REVISED -		332	(29,30)R-1	SALINE	745	593			
PLOT SCALE = 20.0000' / in.		CHECKED -	REVISED -		SCALE: 1" = 10'    SHEET    OF    SHEETS    STA. 563+04.928 TO STA. 564+50.000			CONTRACT NO. 78077				
PLOT DATE = 4/30/2014		DATE -	REVISED -		ILLINOIS FED. AID PROJECT							