

SN 044-7017
Sta. 1557+63
5' x 5' Box

CURVE DATA

$\Delta = 3^{\circ} - 36' - 01''$ T = 356.77'
D = $0^{\circ} - 30' - 17''$ L = 713.30'
R = 11,351.62' E = 5.60'

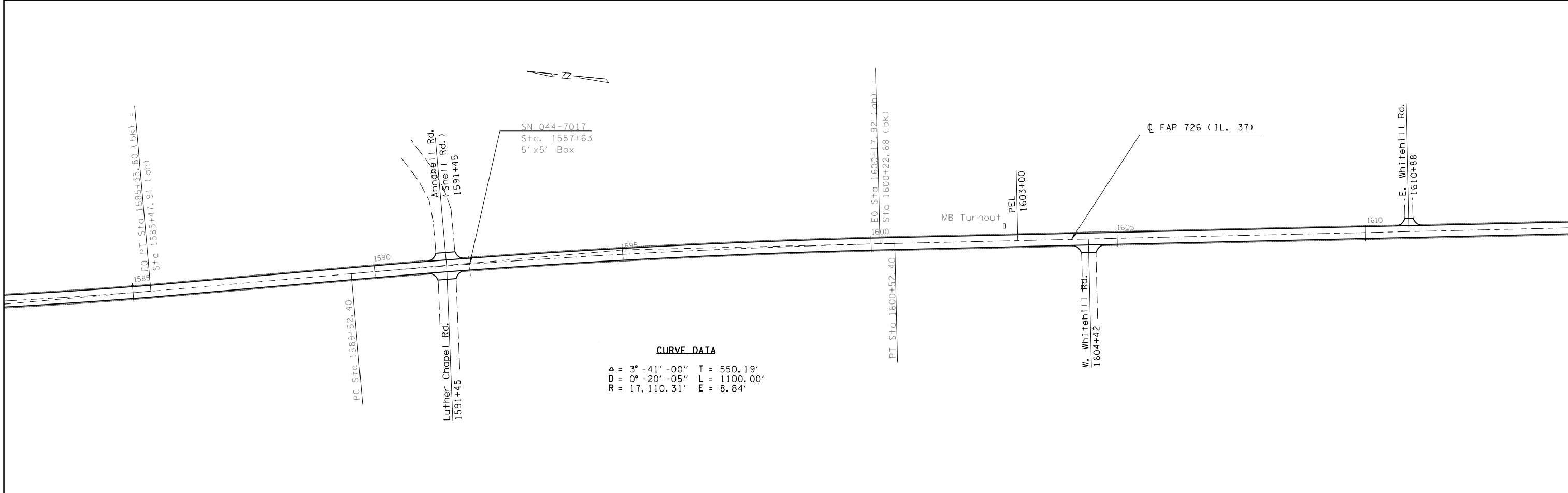
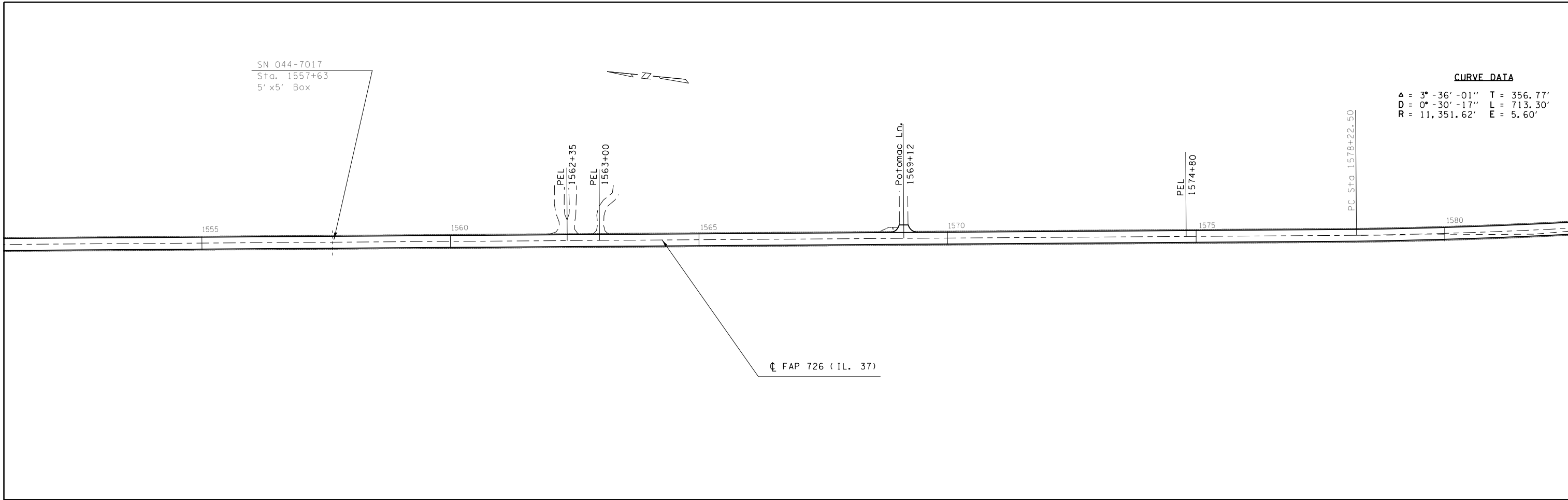

CURVE DATA

$\Delta = 3^{\circ} - 41' - 00''$ T = 550.19'
D = $0^{\circ} - 20' - 05''$ L = 1100.00'
R = 17,110.31' E = 8.84'

FILE NAME = c:\pwork\pwork\mccordkr\ad035259\78381-sh1-pln.dgn	USER NAME = mccordkr	DESIGNED - _____	REVISED - _____
Default	PLOT SCALE = 200.0000' / in.	DRAWN - _____	REVISED - _____
	PLOT DATE = 6/5/2014	CHECKED - _____	REVISED - _____
		DATE - _____	REVISED - _____

**STATE OF ILLINOIS
DEPARTMENT OF TRANSPORTATION**

**PLAN LAYOUT
STA. 1551 + 30 TO STA. 1614 + 00**

SCALE: _____ SHEET _____ OF _____ SHEETS STA. _____ TO STA. _____

F.A.P. RTE.	SECTION	COUNTY	TOTAL SHEETS	SHEET NO.
726	(114,115,116)RS-4	JOHNSON	26	21
CONTRACT NO. 78381				
ILLINOIS FED. AID PROJECT				