

STATE OF ILLINOIS
DEPARTMENT OF TRANSPORTATION

F.A.P. RTE.	SECTION	COUNTY	TOTAL SHEETS	SHEET NO.
311	2018-127-RS	DUPAGE	11	1
ILLINOIS CONTRACT NO. 62H61				

FOR INDEX OF SHEETS, SEE SHEET NO. 2

**PROJECT IS LOCATED IN:
THE CITY OF NAPERVILLE**

**PROPOSED
HIGHWAY PLANS**

**FAP ROUTE 311: US 34 (OGDEN AVE)
28W731 OGDEN AVE, NAPERVILLE
NAPERVILLE MAINTENANCE YARD
SECTION: 2018-127-RS
PARKING IMPROVEMENT
DUPAGE COUNTY
C-91-271-19**



**IMPROVEMENT LOCATION:
28W731 OGDEN AVE, NAPERVILLE**

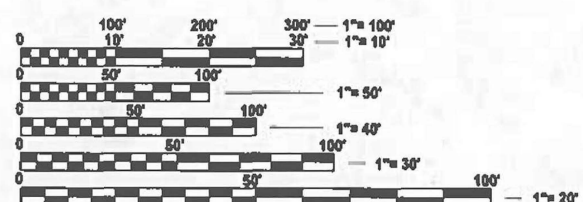

FULL SIZE PLANS HAVE BEEN PREPARED USING STANDARD ENGINEERING SCALES. REDUCED SIZED PLANS WILL NOT CONFORM TO STANDARD SCALES. IN MAKING MEASUREMENTS ON REDUCED PLANS, THE ABOVE SCALES MAY BE USED.

**J.U.L.I.E.
JOINT UTILITY LOCATION INFORMATION FOR EXCAVATION
1-800-892-0123
OR 811**

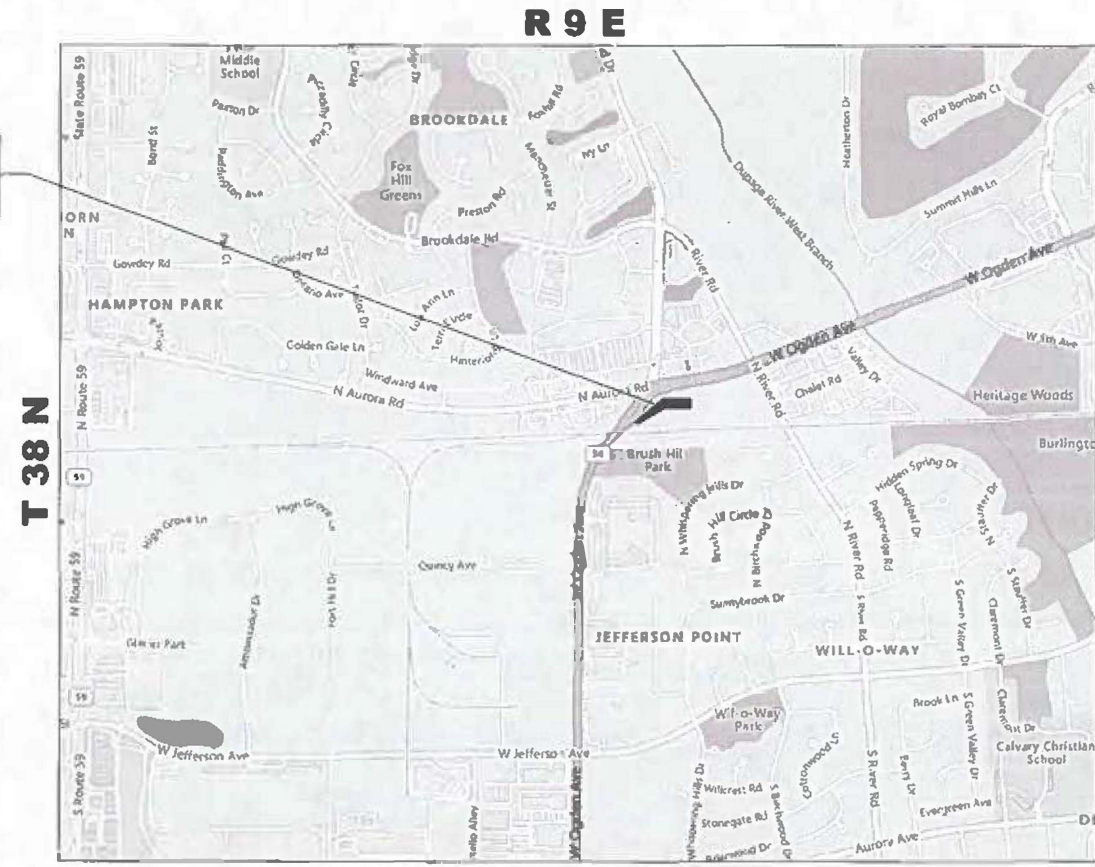

NAPERVILLE TOWNSHIP
GROSS & NET AREA OF MAINTENANCE YARD = 87,777 SQ FT = 9,753 SQ YD

**PROJECT ENGINEER: VESELIN VELICHKOV (847)705-4432
PROJECT MANAGER: VESELIN VELICHKOV**

CONTRACT NO. 62H61

STATE OF ILLINOIS
DEPARTMENT OF TRANSPORTATION

SUBMITTED May 12, 2025
[Signature]
REGIONAL ENGINEER

June 27, 2025
[Signature]
ENGINEER OF DESIGN AND ENVIRONMENT

June 27, 2025
[Signature]
DIRECTOR OF HIGHWAYS PROJECT IMPLEMENTATION

**PRINTED BY THE AUTHORITY
OF THE STATE OF ILLINOIS**

INDEX OF SHEETS

SHEET NO.	DESCRIPTION
1	TITLE SHEET
2	INDEX OF SHEETS, HIGHWAY STANDARDS AND GENERAL NOTES
3	SUMMARY OF QUANTITIES
4	EXISTING AND PROPOSED TYPICAL SECTIONS
5	EXISTING AND PROPOSED SITE PLAN
6	EXISTING AND PROPOSED SITE GRADING PLAN
7	BD-01: DRIVEWAY DETAILS - DISTANCE BETWEEN R.O.W. AND FACE OF CURB OR EDGE OF SHOULDER GREATER THAN OR EQUAL TO 15' (4.5 M)
8	BD-24: CURB OR CURB AND GUTTER REMOVAL AND REPLACEMENT
9	TC-10: TRAFFIC CONTROL AND PROTECTION FOR SIDEROADS, INTERSECTIONS, AND DRIVEWAYS
10	TC-13: DISTRICT ONE TYPICAL PAVEMENT MARKINGS
11	TC-22: ARTERIAL ROAD INFORMATION SIGN

STATE STANDARDS

STANDARD NO.	DESCRIPTION
000001-08	STANDARD SYMBOLS, ABBREVIATIONS AND PATTERNS
604001-05	FRAME AND LIDS TYPE 1
606001-08	CONCRETE CURB TYPE B AND COMBINATION CONCRETE CURB AND GUTTER
630001-12	STEEL PLATE BEAM GUARDRAIL
664001-02	CHAIN LINK FENCE
701006-05	OFF-RD OPERATIONS, 2L, 2W, 15' (4.5 m) TO 24" (600 mm) FROM PAVEMENT EDGE
701301-04	LANE CLOSURE, 2L, 2W, SHORT TIME OPERATIONS
701501-06	URBAN LANE CLOSURE, 2L, 2W, UNDIVIDED
701901-10	TRAFFIC CONTROL DEVICES

GENERAL NOTES

- BEFORE STARTING ANY EXCAVATION, THE CONTRACTOR SHALL CALL "J.U.L.I.E." AT (800) 892-0123 OR 811 FOR FIELD LOCATIONS OF BURIED ELECTRIC, TELEPHONE AND GAS UTILITIES (48 HOUR NOTIFICATION IS REQUIRED)
- THE CONTRACTOR SHALL COORDINATE CONSTRUCTION ACTIVITIES WITH THE NAPERVILLE MAINTENANCE YARD TECHNICIAN MIKE EURKAITIS AT 630-355-3958 OR 3959.
- THE CONTRACTOR WILL NOT BE ALLOWED TO SET UP A YARD OR FIELD OFFICE ON STATE PROPERTY WITHOUT WRITTEN PERMISSION FROM THE DEPARTMENT.
- DO NOT SCALE PLANS FOR CONSTRUCTION DIMENSIONS.
- IT SHALL BE THE CONTRACTOR'S RESPONSIBILITY TO VERIFY ALL DIMENSIONS AND CONDITIONS EXISTING IN THE FIELD PRIOR TO CONSTRUCTION AND ORDERING OF MATERIALS.
- THE CONTRACTOR SHALL BE REQUIRED TO PROVIDE ACCESS TO ABUTTING PROPERTY AT ALL TIMES DURING THE CONSTRUCTION OF THIS PROJECT.
- EXISTING BROKEN FRAMES AND LIDS SHALL BE REMOVED AND DISPOSED OF BY THE CONTRACTOR AND SHALL BE REPLACED AS DIRECTED BY THE ENGINEER. REPLACEMENT FRAMES AND LIDS WILL BE PAID FOR ACCORDING TO ARTICLE 109.04 OF THE STANDARD SPECIFICATIONS UNLESS A SEPARATE PAY ITEM HAS BEEN PROVIDED.
- THE CONTRACTOR SHALL CONTACT THE DISTRICT TRAFFIC CONTROL SUPERVISOR AT KALPANA.KANNAN-HOSADURGA@ILLINOIS.GOV A MINIMUM OF 72 HOURS IN ADVANCE OF BEGINNING WORK.

MODEL: GenNotesSh01 (Sheet)
FILE NAME: c:\pw\work\wis\shirani\bid1012032\107719-ahf-gennote.dgn

GENERAL NOTES CONTINUE ON NEXT SHEET

USER NAME = Sarah.Shirani	DESIGNED -	REVISED -	STATE OF ILLINOIS DEPARTMENT OF TRANSPORTATION	INDEX OF SHEETS, STATE STANDARDS & GENERAL NOTES NAPERVILLE MAINTENANCE YARD PARKING IMPROVEMENT	F A P RTE	SECTION	COUNTY	TOTAL SHEETS	SHEET NO.	
PLOT SCALE = \$\$SCALE\$	DRAWN -	REVISED -			311	2018-127-RS	DUPAGE	11	2	
PLOT DATE = 5/14/2025	CHECKED -	REVISED -			CONTRACT NO. 62H61					
	DATE -	REVISED -			SCALE: SHEET OF 1 SHEETS STA. TO STA.		ILLINOIS FED. AID PROJECT			

SUMMARY OF QUANTITIES					CONSTRUCTION TYPE CODE					SUMMARY OF QUANTITIES					CONSTRUCTION TYPE CODE				
CODE NO	ITEM	UNIT	TOTAL QUANTITIES	100% STATE 0004						CODE NO	ITEM	UNIT	TOTAL QUANTITIES	100% STATE 0004					
20200100	EARTH EXCAVATION	CU YD	2850	2850						* 66901003	REGULATED SUBSTANCES FINAL CONSTRUCTION REPORT	LSUM	1	1					
28000400	PERIMETER EROSION BARRIER	FOOT	2520	2520						* 66901006	REGULATED SUBSTANCES MONITORING	CAL DA	10	10					
28000510	INLET FILTERS	EACH	6	6						67100100	MOBILIZATION	L SUM	1	1					
31101400	SUBBASE GRANULAR MATERIAL, TYPE B 6"	SQ YD	8555	8555						72501000	TERMINAL MARKER - DIRECT APPLIED	EACH	2	2					
40600275	BITUMINOUS MATERIALS (PRIME COAT)	POUND	21945	21945						* 78000200	THERMOPLASTIC PAVEMENT MARKING - LINE 4"	FOOT	750	750					
40600290	BITUMINOUS MATERIALS (TACK COAT)	POUND	2195	2195						78200005	GUARDRAIL REFLECTORS, TYPE A	EACH	2	2					
40603085	HOT-MIX ASPHALT BINDER COURSE, IL-19.0, N70	TON	2007	2007						X4400501	COMBINATION CURB AND GUTTER REMOVAL AND REPLACEMENT LESS THAN OR EQUAL TO 10 FEET	FOOT	50	50					
40604062	HOT-MIX ASPHALT SURFACE COURSE, IL-9.5, MIX "D", N70	TON	820	820						X4400503	COMBINATION CURB AND GUTTER REMOVAL AND REPLACEMENT LESS THAN OR EQUAL TO 10 FEET	FOOT	100	100					
44000100	PAVEMENT REMOVAL	SQ YD	9753	9753						X5537800	STORM SEWERS TO BE CLEANED 12"	FOOT	100	100					
60250200	CATCH BASINS TO BE ADJUSTED	EACH	6	6						X6840300	CHAIN LINK FENCE REMOVAL	FOOT	250	250					
63100167	TRAFFIC BARRIER TERMINAL, TYPE 1 (SPECIAL) TANGENT	EACH	2	2						X6700407	ENGINEER'S FIELD OFFICE, TYPE A (D1)	CAL MO	6	6					
63200310	GUARDRAIL REMOVAL	FOOT	100	100						Z0013798	CONSTRUCTION LAYOUT	L SUM	1	1					
66400505	CHAIN LINK FENCE, 8'	FOOT	250	250						Z0018500	DRAINAGE STRUCTURES TO BE CLEANED	EACH	6	6					
* 66900200	NON-SPECIAL WASTE DISPOSAL	CU YD	690	690						X7200061	TEMPORARY INFORMATION SIGNING	SQ FT	51.4	51.4					
* 66900530	SOIL DISPOSAL ANALYSIS	EACH	2	2															
66901001	REGULATED SUBSTANCES PRE-CONSTRUCTION PLAN	LSUM	1	1															

MODEL: S0001 [Sheet]
FILE NAME: c:\pwworking\shirani\10120321\107719-shit-SQG.dgn

USER NAME = Sarah.Shirani	DESIGNED -	REVISED -
	DRAWN -	REVISED -
PLOT SCALE = \$SCALE\$	CHECKED -	REVISED -
PLOT DATE = 5/15/2025	DATE -	REVISED -

**STATE OF ILLINOIS
DEPARTMENT OF TRANSPORTATION**

**SUMMARY OF QUANTITIES
NAPERVILLE MAINTENANCE YARD PARKING IMPROVEMENT**

F.A.P. RTE.	SECTION	COUNTY	TOTAL SHEETS	SHEET NO.
311	2018-127-RS	DUPAGE	11	3
CONTRACT NO. 62H61				
ILLINOIS FED. AID PROJECT				

* SPECIALTY ITEMS

SCALE: SHEET OF 1 SHEETS STA. TO STA.

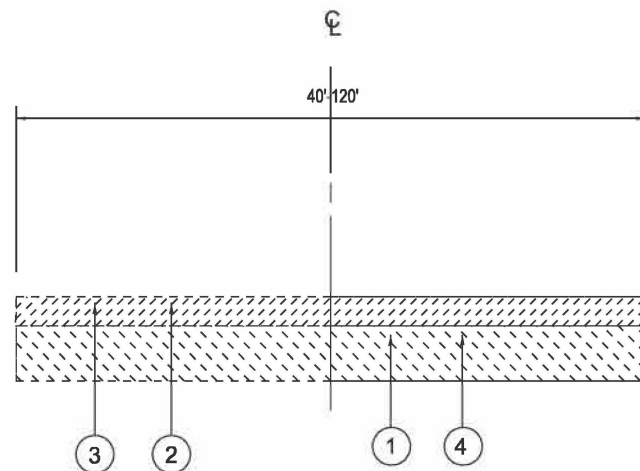

EXISTING TYPICAL SECTION
NAPERVILLE MAINTENANCE YARD

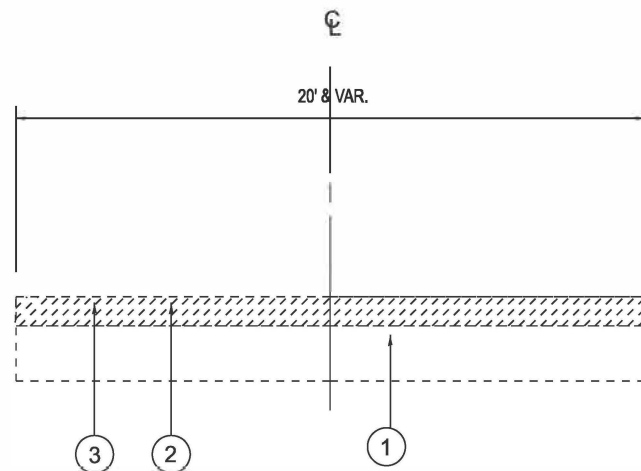

EXISTING TYPICAL SECTION
NAPERVILLE MAINTENANCE YARD ENTRANCE

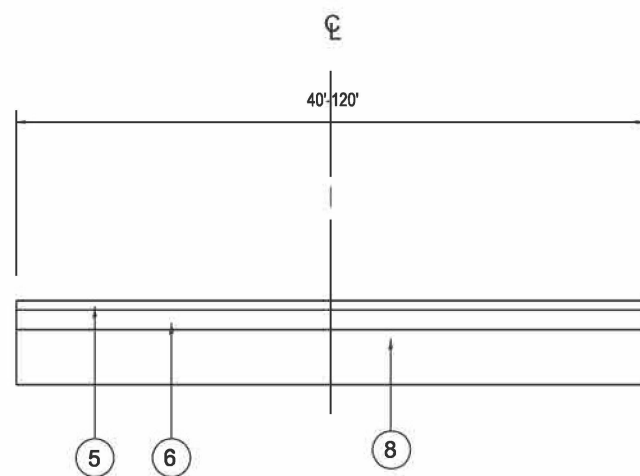

PROPOSED TYPICAL SECTION
NAPERVILLE MAINTENANCE YARD

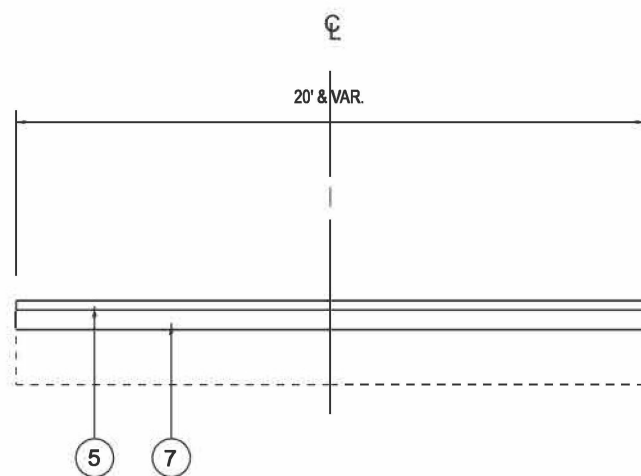

PROPOSED TYPICAL SECTION
NAPERVILLE MAINTENANCE YARD ENTRANCE

LEGEND

- ① EXISTING BASE GRAVEL/STONE
- ② EXISTING HOT-MIX ASPHALT SURFACE, 3.5"-5.25"
- ③ PROPOSED PAVEMENT REMOVAL
- ④ PROPOSED EARTH EXCAVATION
- ⑤ PROPOSED HMA SURFACE COURSE, IL 9.5, MIX "D", N70, 1.5"
- ⑥ PROPOSED HMA BINDER COURSE, IL-19.0, N70, 3"
- ⑦ PROPOSED HMA BINDER COURSE, IL-19.0, N70, 8.5"
- ⑧ PROPOSED SUBBASE GRANDULAR MATERIAL, TYPE B, 6"

NOTES:

- 1. LOCATIONS OF COMBINATION CONCRETE CURB AND GUTTER REMOVAL AND REPLACEMENT, WILL BE DETERMINED IN THE FIELD BY THE ENGINEER.

HMA MIXTURE REQUIREMENTS			
MIXTURE USES	MIXTURE TYPE	AIR VOIDS @ Ndes	QUALITY MANAGEMENT PROGRAM (QMP)
PAVEMENT RECON & RESURFACING	HMA SURFACE COURSE, MIX "D", IL-9.5, N70; 1.5" HMA BINDER COURSE, IL-19.0, N70, 3" & 8.5"	4% @ 70 GYR. 4% @ 70 GYR.	QC/QA QC/QA
QMP DESIGNATIONS: QUALITY CONTROL/QUALITY ASSURANCE (QC/QA) & QUALITY CONTROL FOR PERFORMANCE (QCP)			

NOTE #1: THE UNIT WEIGHT USED TO CALCULATE ALL HMA SURFACE MIXTURE QUANTITIES IS 112 LBS/SQ YD/IN.

NOTE #2: THE "AC TYPE" FOR POLYMERIZED HMA MIXES SHALL BE "SBS/SBR PG 76 -22" AND FOR NON-POLYMERIZED HMA THE "AC TYPE" SHALL BE "PG 64 -22" UNLESS MODIFIED BY RECLAIMED MATERIALS SPECIFICATIONS.

MODEL: TypSec01 [Sheet]
FILE NAME: c:\pwworkspace\hshirani\12032107719-alt-typical.dgn

USER NAME = Sarah.Shirani	DESIGNED -	REVISED -
	DRAWN -	REVISED -
	CHECKED -	REVISED -
PLOT DATE = 4/28/2025	DATE -	REVISED -

STATE OF ILLINOIS
DEPARTMENT OF TRANSPORTATION

EXISTING AND PROPOSED TYPICAL SECTIONS
NAPERVILLE MAINTENANCE YARD PARKING IMPROVEMENT

SCALE: SHEET OF 1 SHEETS STA. TO STA.

F.A.P. RTE.	SECTION	COUNTY	TOTAL SHEETS	SHEET NO.
311	2018-127-RS	DUPAGE	11	4
				CONTRACT NO. 62H61
ILLINOIS FED. AID PROJECT				

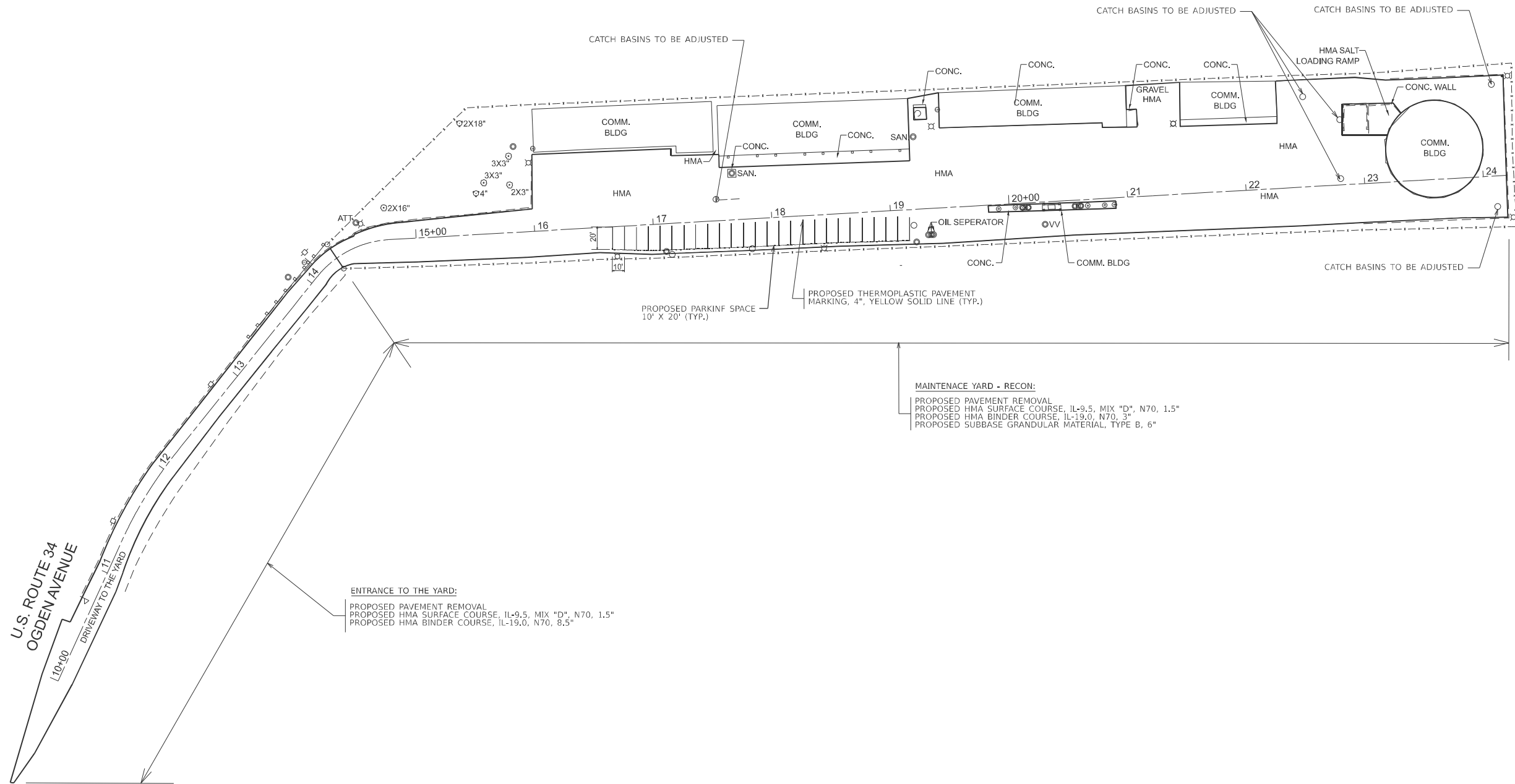

MAINTENACE YARD - RECON:
 PROPOSED PAVEMENT REMOVAL
 PROPOSED HMA SURFACE COURSE, IL-9.5, MIX "D", N70, 1.5"
 PROPOSED HMA BINDER COURSE, IL-19.0, N70, 3"
 PROPOSED SUBBASE GRANDULAR MATERIAL, TYPE B, 6"

ENTRANCE TO THE YARD:
 PROPOSED PAVEMENT REMOVAL
 PROPOSED HMA SURFACE COURSE, IL-9.5, MIX "D", N70, 1.5"
 PROPOSED HMA BINDER COURSE, IL-19.0, N70, 8.5"

**U.S. ROUTE 34
 OGDEN AVENUE**

MODEL: Untitled (Sheet)
 FILE NAME: c:\pik_work\pik\shirani\sd1012032\107719-shp-plan.dgn

USER NAME = Sarah,Shirani	DESIGNED -	REVISED -
	DRAWN -	REVISED -
	CHECKED -	REVISED -
PLOT DATE = 5/14/2025	DATE -	REVISED -

**STATE OF ILLINOIS
 DEPARTMENT OF TRANSPORTATION**

**EXISTING AND PROPOSED SITE PLAN
 NAPERVILLE MAINTENANCE YARD PARKING IMPROVEMENT**

SCALE: SHEET OF SHEETS STA. TO STA.

F.A.P. RTE.	SECTION	COUNTY	TOTAL SHEETS	SHEET NO.
311	2018-127-RS	DUPAGE	11	5
CONTRACT NO. 62H61				
ILLINOIS FED. AID PROJECT				

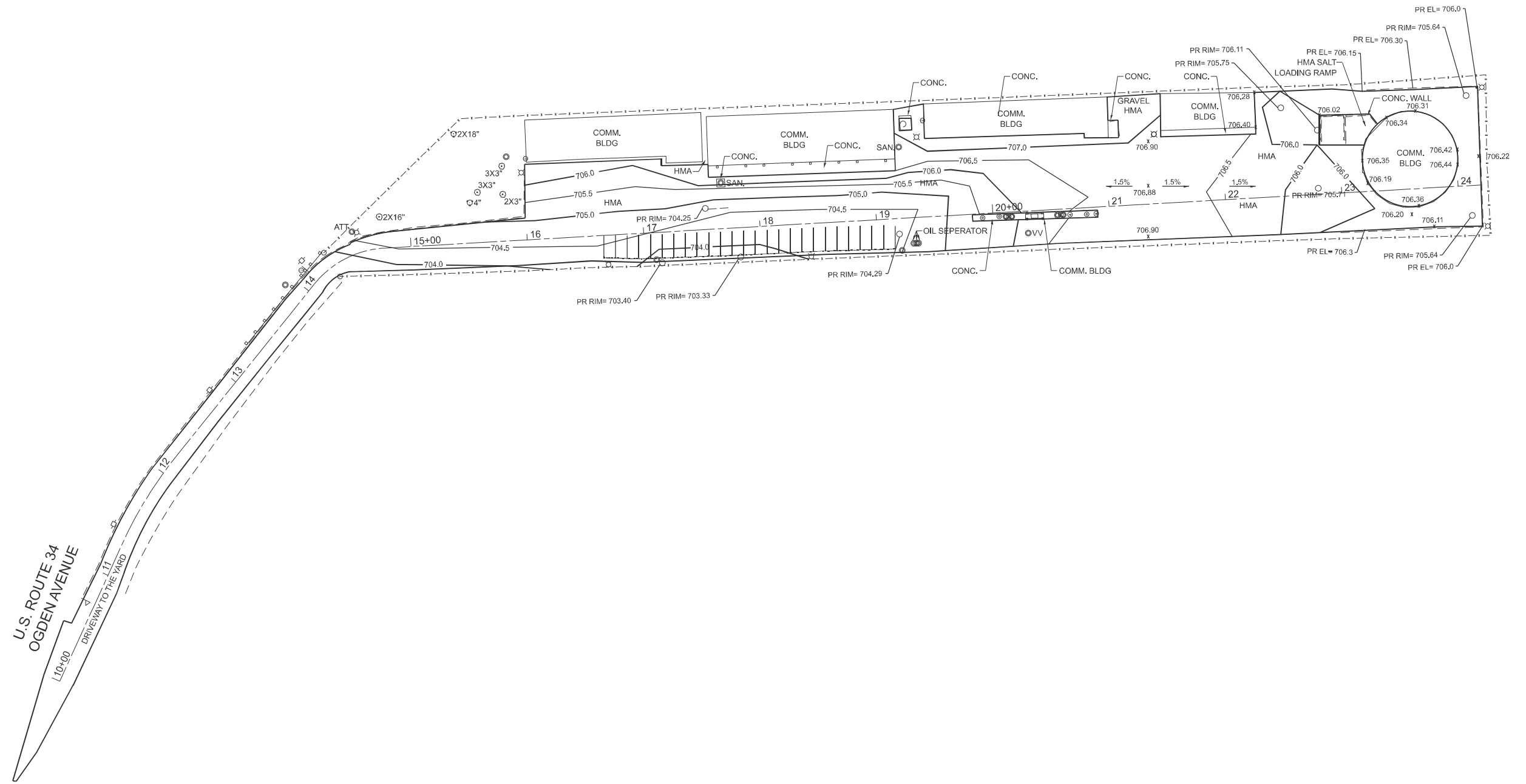

MODEL: MAINT_YARD - Plan01 [Sheet]
 FILE NAME: c:\p\work\wshirani\1012032\107719-shp-plan.dgn

USER NAME = Sarah,Shirani	DESIGNED -	REVISED -
	DRAWN -	REVISED -
	CHECKED -	REVISED -
PLOT DATE = 5/14/2025	DATE -	REVISED -

**STATE OF ILLINOIS
 DEPARTMENT OF TRANSPORTATION**

**EXISTING AND PROPOSED SITE GRADING PLAN
 NAPERVILLE MAINTENANCE YARD PARKING IMPROVEMENT**

SCALE: 1"=50' SHEET OF 1 SHEETS STA. 10+00.00 TO STA. 25+00.00

F.A.P RTE.	SECTION	COUNTY	TOTAL SHEETS	SHEET NO.
311	2018-127-RS	DuPAGE	11	6
CONTRACT NO. 62H61				
ILLINOIS FED. AID PROJECT				

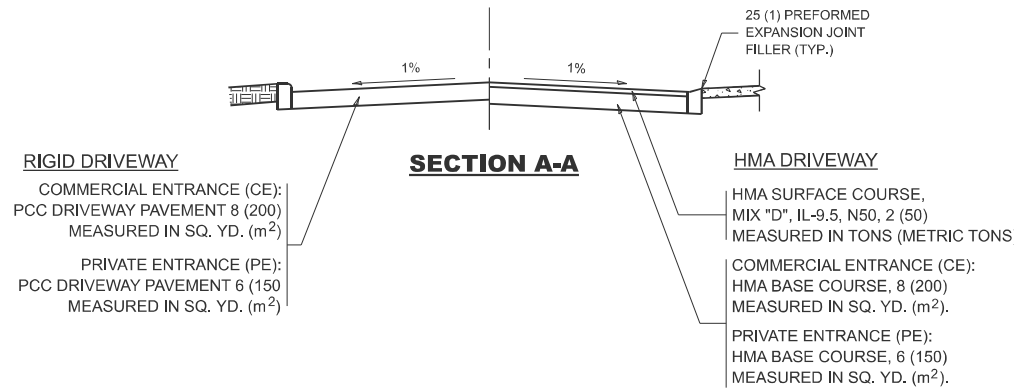
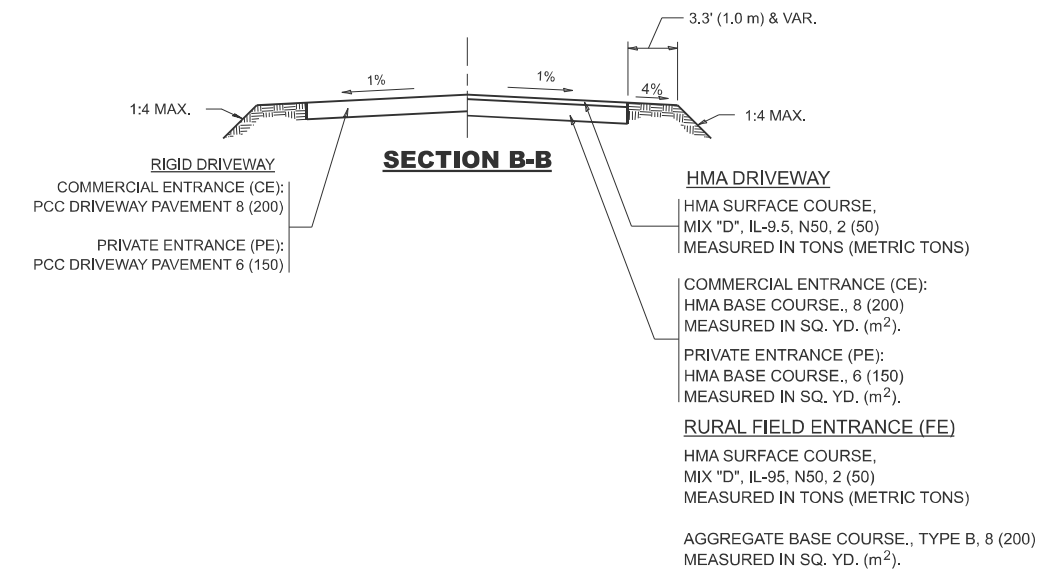
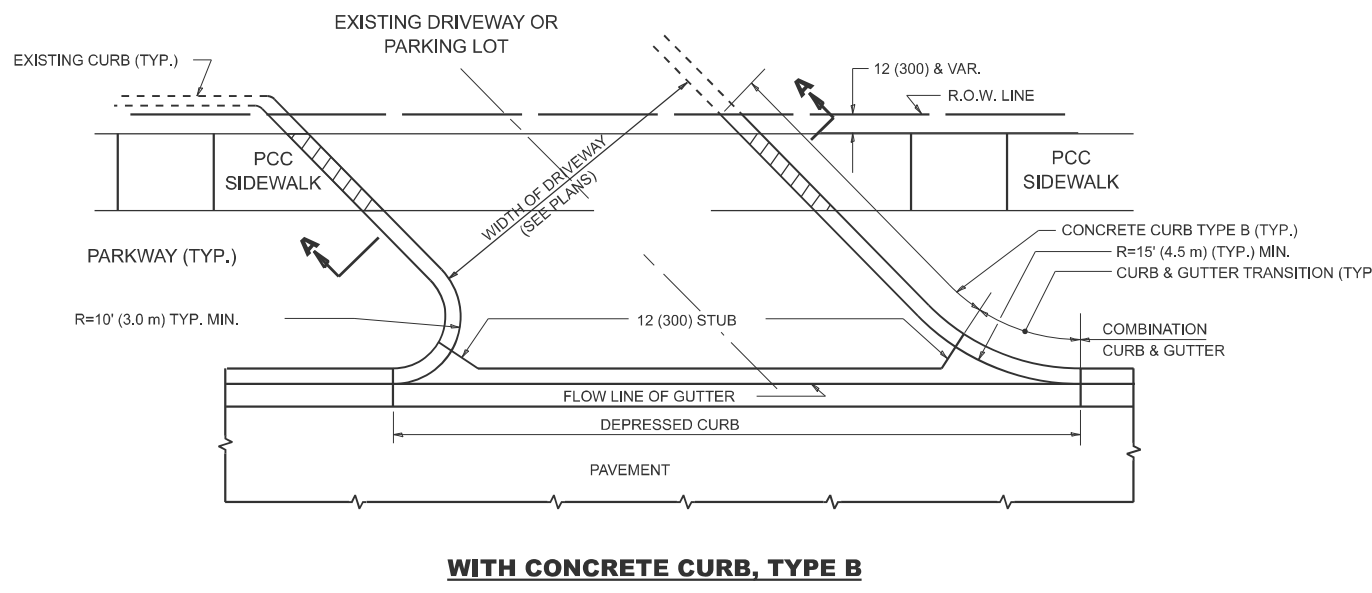
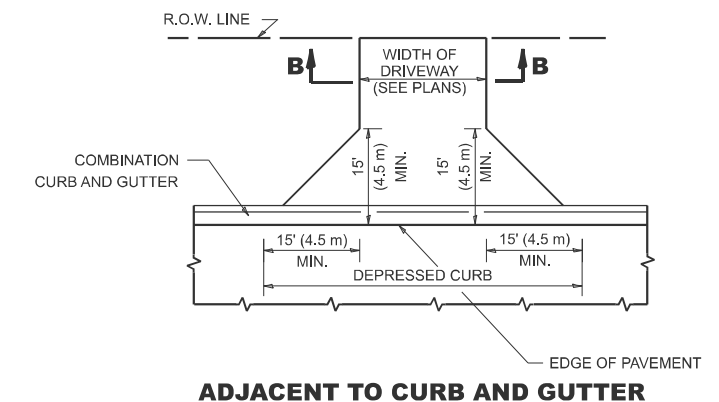
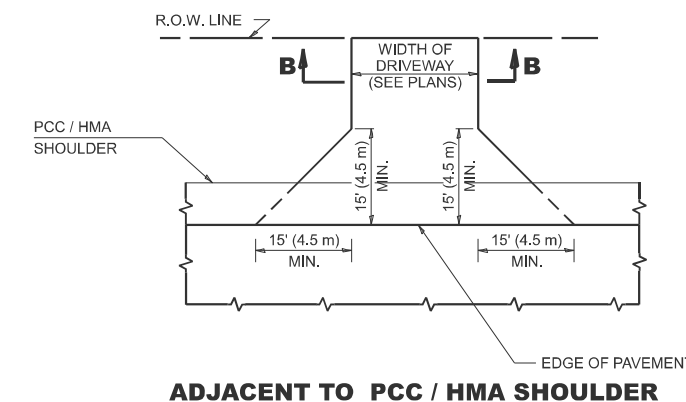
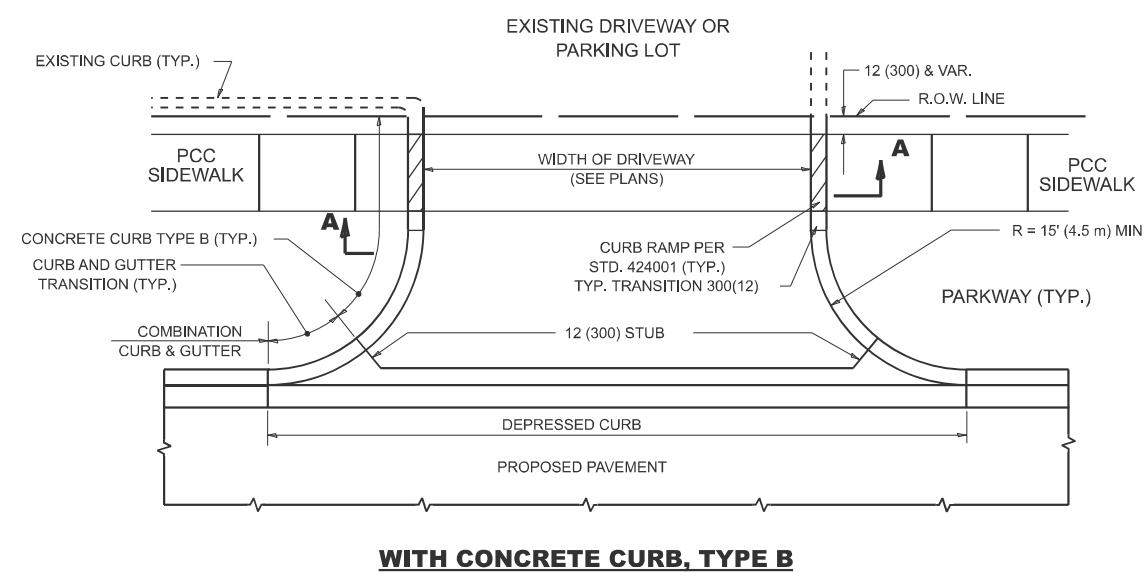

GENERAL NOTES

1. DRIVEWAY SLOPES, LOCATIONS, & GEOMETRIC LAYOUT SHALL BE IN ACCORDANCE WITH THE LATEST EDITION OF THE "HANDBOOK FOR POLICY ON PERMITS FOR ACCESS DRIVEWAYS TO STATE HIGHWAYS". FOR FURTHER LAYOUT REQUIREMENTS, REFER TO ILLUSTRATIONS IN THE PERMIT HANDBOOK. DRIVEWAYS SHALL BE REPLACED IN KIND, UNLESS OTHERWISE NOTED ON THE PLANS.
2. COMMERCIAL DRIVEWAYS SHALL BE CONSTRUCTED WITH CONCRETE CURB, TYPE B RETURNS EXCEPT WHEN THE SIDEWALK EDGE IS 4 FEET (1.2 METERS) OR LESS FROM THE BACK OF CURB, CONSTRUCT A FLARE DRIVEWAY WITHOUT CURB.

ALL DIMENSIONS ARE IN INCHES (MILLIMETERS) UNLESS OTHERWISE NOTED.

MODEL: Plan Single (Sheet)
FILE NAME: \\illinois.gov\DOT\Users\COTTHOMAS\My Documents\Bentley\CONNECT\1012\Organization-Civil\DOT_Standards\Digital\Sheet Seests\Civil_Named_Boundary_SheetSeests.dgn

USER NAME = Eric.L.Thomas	DESIGNED - R. SHAH	REVISED - R. BORO 06-11-08
	DRAWN -	REVISED - R. BORO 09-06-11
	CHECKED -	REVISED - K. SMITH 08-28-19
PLOT DATE = 8/20/2024	DATE - 11-04-95	REVISED - K. SMITH 11-18-22

STATE OF ILLINOIS
DEPARTMENT OF TRANSPORTATION

DRIVEWAY DETAILS - DISTANCE BETWEEN R.O.W. AND FACE OF CURB & EDGE OF SHOULDER >15'(4.5m)			
SCALE: NONE	SHEET 1	OF 1 SHEETS	STA. TO STA.

F.A.P RTE.	SECTION	COUNTY	TOTAL SHEETS	SHEET NO.
311	2018-127-RS	DUPAGE	11	7
BD400-01 (BD-01)			CONTRACT NO. 62H61	
ILLINOIS FED. AID PROJECT				

MODEL: Plan Street (Sheet)
 FILE NAME: \\illinois.gov\DOT\Users\COTTHOMASELM\My Documents\Bentley\CONNECT\1012\Organization-Civil\DOT_Standards\Digital\Sheet Seests\Civil_Named_Boundary_SheetSeests.dgnlib

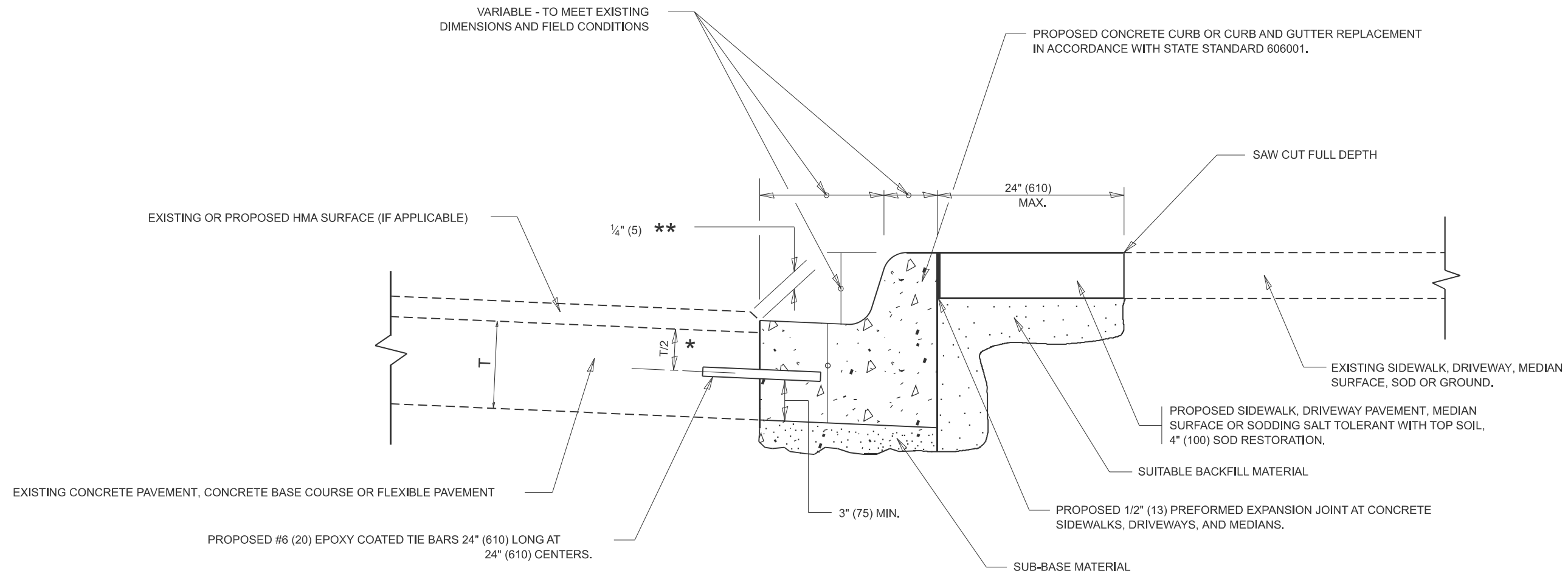

- * 3" (75) MINIMUM FROM TOP AND BOTTOM OF THE CONCRETE PAVEMENT OR BASE COURSE.
- ** IF THE FINAL SURFACE OF THE PAVEMENT IS CONCRETE, THE GUTTER IS TO BE FLUSH WITH THE PAVEMENT.

CURB OR CURB AND GUTTER REMOVAL AND REPLACEMENT

ALL DIMENSIONS ARE IN INCHES (MILLIMETERS)
 UNLESS OTHERWISE SHOWN.

USER NAME = Eric.L.Thomas	DESIGNED - A. HOUSEH	REVISED - A. ABBAS 03-21-97
	DRAWN -	REVISED - M. GOMEZ 01-22-01
	CHECKED -	REVISED - R. BORO 12-15-09
PLOT DATE = 8/20/2024	DATE - 03-11-94	REVISED - K. SMITH 07-11-19

**STATE OF ILLINOIS
 DEPARTMENT OF TRANSPORTATION**

**CURB OR CURB AND GUTTER
 REMOVAL AND REPLACEMENT**

SCALE: NONE SHEET 1 OF 1 SHEETS STA. TO STA.

F.A.P. RTE.	SECTION	COUNTY	TOTAL SHEETS	SHEET NO.
311	2018-127-RS	DUPAGE	11	8
BD600-06 (BD-24)			CONTRACT NO. 62H61	
ILLINOIS FED. AID PROJECT				

MODEL: Plan Single (Sheet)
 FILE NAME: \\illinois.gov\DOT\Users\COTHOMASELM\My Documents\Bentley\CONNECT\1012\Organization-Civil\DOT_Standards\Digital\Sheet\Seeds\Civil_Named_Boundary_SheetSeeds.dgn\lib

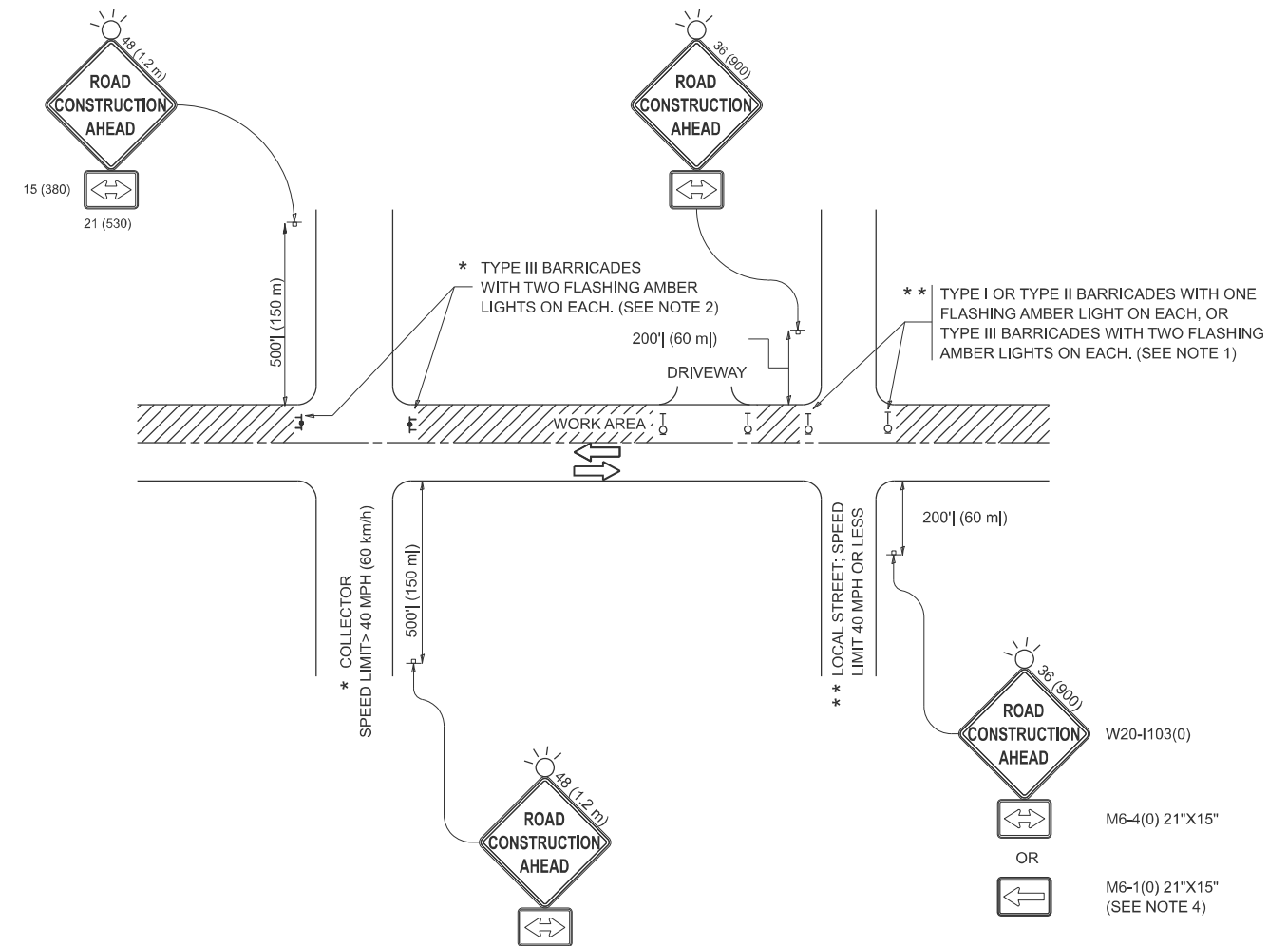

NOTES:

- SIDE ROAD WITH A SPEED LIMIT OF 40 MPH (60 km/h) OR LESS AS SHOWN ON THE DRAWING AND AS DIRECTED BY THE ENGINEER:
 - ONE "ROAD CONSTRUCTION AHEAD" SIGN 36 x 36 (900x900) WITH A FLASHER MOUNTED ON IT APPROXIMATELY 200' (60 m) IN ADVANCE OF THE MAIN ROUTE.
 - THE CLOSED PORTION OF THE MAIN ROUTE SHALL BE PROTECTED BY BLOCKING WITH TYPE I, TYPE II OR TYPE III BARRICADES, 1/3 OF THE CROSS SECTION OF THE CLOSED PORTION.
- SIDE ROAD WITH A SPEED LIMIT GREATER THAN 40 MPH (60 km/h) AS SHOWN ON THE DRAWING AND AS DIRECTED BY THE ENGINEER:
 - ONE "ROAD CONSTRUCTION AHEAD" SIGN 48 x 48 (1.2 m x 1.2 m) WITH A FLASHER MOUNTED ON IT APPROXIMATELY 500' (150 m) IN ADVANCE OF THE MAIN ROUTE.
 - THE CLOSED PORTION OF THE MAIN ROUTE SHALL BE PROTECTED BY BLOCKING WITH TYPE III BARRICADES, 1/2 OF THE CROSS SECTION OF THE CLOSED PORTION.
- CONES MAY BE SUBSTITUTED FOR BARRICADES OR DRUMS AT HALF THE SPACING DURING DAY OPERATIONS. CONES SHALL BE A MINIMUM OF 28 (710) IN HEIGHT.
- WHEN THE SIDE ROAD LIES BETWEEN THE BEGINNING OF THE MAINLINE SIGNING AND THE WORK ZONE, A SINGLE HEADED ARROW (M6-1) SHALL BE USED IN LIEU OF THE DOUBLE HEADED ARROW (M6-4).
- WHEN WORK IS BEING PERFORMED ON A SIDE ROAD OR DRIVEWAY, FOLLOW THE APPLICABLE STANDARD(S). THE DIRECTIONAL ARROW (M6-1 OR M6-4) SHALL BE COVERED OR REMOVED WHEN NO LONGER CONSISTENT WITH THE TRAFFIC CONTROL SET-UP.
- ADVANCE WARNING SIGNS ARE TO BE OMITTED ON DRIVEWAYS UNLESS OTHERWISE SPECIFIED IN THE PLANS OR BY THE ENGINEER.
- THE TRAFFIC CONTROL AND PROTECTION FOR SIDE ROADS, INTERSECTIONS, AND DRIVEWAYS SHALL BE INCLUDED IN THE COST OF SPECIFIED TRAFFIC CONTROL STANDARDS OR ITEMS.

All dimensions are in inches (millimeters) unless otherwise shown.

USER NAME = Eric.L.Thomas	DESIGNED - L.H.A.	REVISED - T. RAMMACHER 01-06-00
	DRAWN -	REVISED - A. SCHUETZE 07-01-13
	CHECKED -	REVISED - A. SCHUETZE 09-15-06
PLOT DATE = 8/20/2024	DATE - 06-89	REVISED - D. SENDERAK 05-03-24

**STATE OF ILLINOIS
 DEPARTMENT OF TRANSPORTATION**

**TRAFFIC CONTROL AND PROTECTION FOR
 SIDE ROADS, INTERSECTIONS, AND DRIVEWAYS**

SCALE: SHEET OF SHEETS STA. TO STA.

F.A.P. RTE.	SECTION	COUNTY	TOTAL SHEETS	SHEET NO.
311	2018-127-RS	DUPAGE	11	9
TC-10			CONTRACT NO. 62H61	
ILLINOIS FED. AID PROJECT				

MODEL - Plan Single (Sheet)
FILE NAME: \\illinois.gov\DOT\Users\COTTHOMAS\My Documents\Bentley\CONNECT\1012\Organization-Civil\DOT_Standards\Digital\Sheet\Seeds\Civil_Named_Boundary_SheetSeeds.dgn

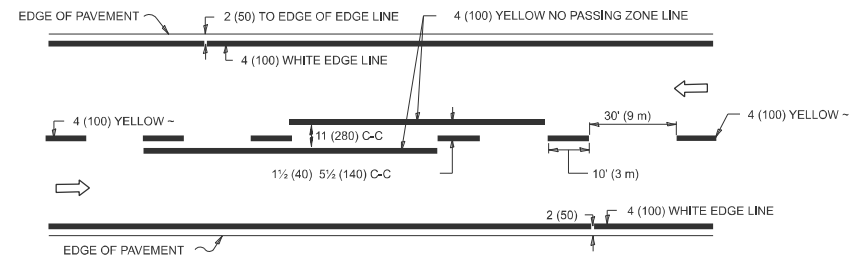

2-LANE ROADWAY

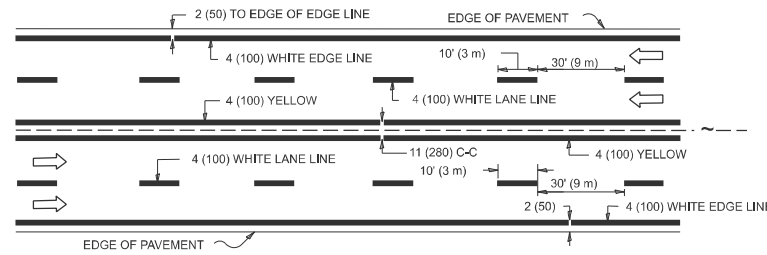

MULTI-LANE UNDIVIDED

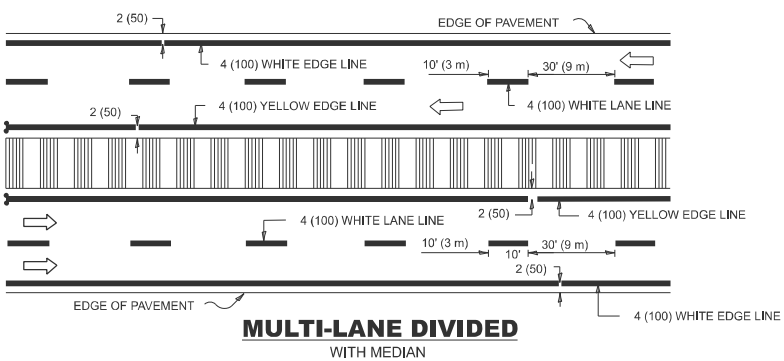

TYPICAL LANE AND EDGE LINE MARKING

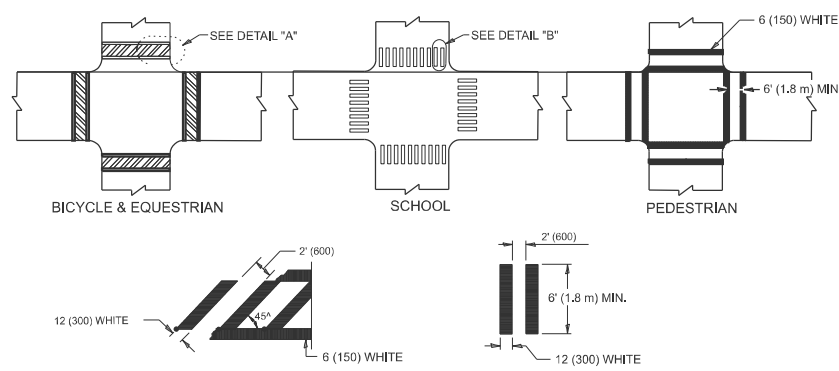

DETAIL "A" DETAIL "B"

TYPICAL CROSSWALK MARKING

* MARKINGS SHALL BE INSTALLED PARALLEL TO THE CENTERLINE OF THE ROAD WHICH IT CROSSES

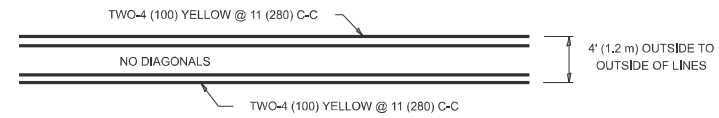

4' (1.2 m) WIDE MEDIANS ONLY

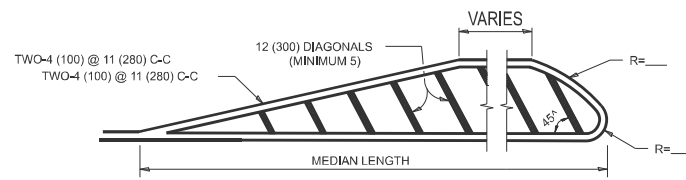

DIAGONAL LINE SPACING: 50' (15 m) C-C (LESS THAN 30MPH (50 km/h))
75' (25 m) C-C 30MPH (50 km/h) TO 45MPH (70 km/h)
150' (45 m) C-C (MORE THAN 45MPH (70 km/h))

MEDIANS OVER 4' (1.2 m) WIDE

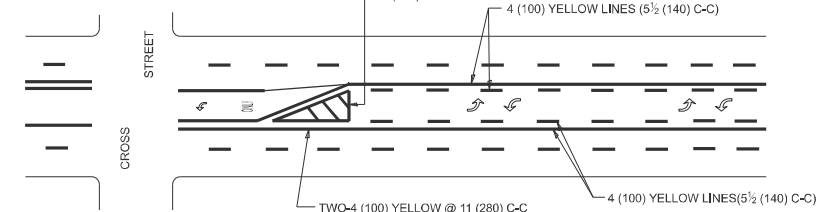

A MINIMUM OF TWO PAIRS OF TURN ARROWS SHALL BE USED, WHITE IN COLOR. ADDITIONAL PAIRS SHALL BE PLACED AT 200' (60 m) TO 300' (90 m) INTERVALS.

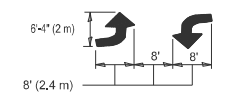

MEDIAN WITH TWO-WAY LEFT TURN LANE
TYPICAL PAINTED MEDIAN MARKING

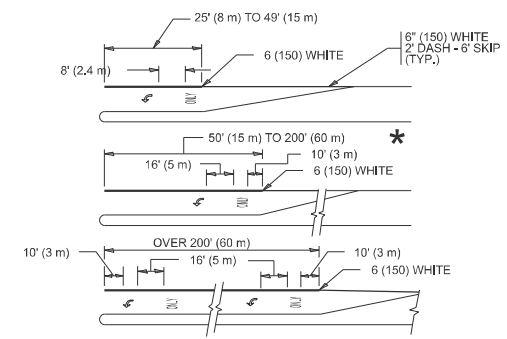

FULL SIZE LETTERS 8' (2.4 m) AND ARROWS SHALL BE USED. AREA = 15.6 SQ. FT. (1.5 m²) ONLY AREA = 20.8 SQ. FT. (1.9 m²)

* TURN LANES IN EXCESS OF 400' (120 m) IN LENGTH MAY HAVE AN ADDITIONAL SET OF ARROW - "ONLY" INSTALLED MIDWAY BETWEEN THE OTHER TWO SETS OF ARROW - "ONLY".

TYPICAL LEFT (OR RIGHT) TURN LANE

TYPICAL TURN LANE MARKING

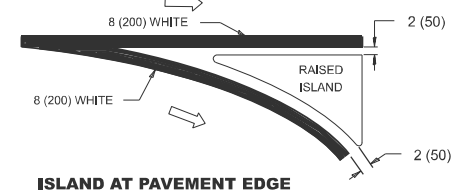
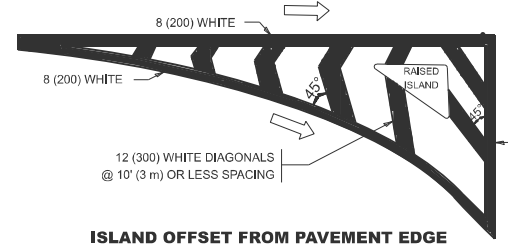

TYPICAL ISLAND MARKING

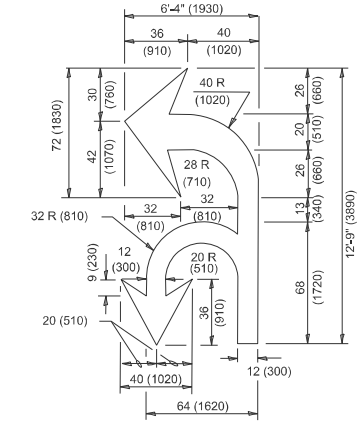

COMBINATION LEFT AND U-TURN

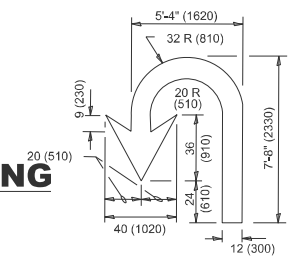

D(FT)	SPEED LIMIT
345	30
425	35
500	40
580	45
665	50
750	55

LANE REDUCTION TRANSITION

* LANE REDUCTION ARROWS REQUIRED AT SPEEDS OF 45 MPH OR GREATER OR WHEN SPECIFIED IN PLANS.

TYPE OF MARKING	WIDTH OF LINE	PATTERN	COLOR	SPACING / REMARKS
CENTERLINE ON 2 LANE PAVEMENT	4 (100)	SKIP-DASH	YELLOW	10' (3 m) LINE WITH 30' (9 m) SPACE
CENTERLINE ON MULTI-LANE UNDIVIDED PAVEMENT	2 @ 4 (100)	SOLID	YELLOW	11 (280) C-C
NO PASSING ZONE LINES: FOR ONE DIRECTION FOR BOTH DIRECTIONS	4 (100) 2 @ 4 (100)	SOLID SOLID	YELLOW YELLOW	5 1/2 (140) C-C FROM SKIP-DASH CENTERLINE 11 (280) C-C OMIT SKIP-DASH CENTERLINE BETWEEN
LANE LINES	4 (100) 5 (125) ON FREEWAYS	SKIP-DASH SKIP-DASH	WHITE WHITE	10' (3 m) LINE WITH 30' (9 m) SPACE
DOTTED LINES (EXTENSIONS OF CENTER, LANE OR TURN LANE MARKINGS)	SAME AS LINE BEING EXTENDED	SKIP-DASH	SAME AS LINE BEING EXTENDED	2' (600) LINE WITH 6' (1.8 m) SPACE
EDGE LINES	4 (100)	SOLID	YELLOW-LEFT WHITE-RIGHT	OUTLINE MEDIANS IN YELLOW
TURN LANE MARKINGS	6 (150) LINE-FULL SIZE LETTERS & SYMBOLS (8' (2.4m))	SOLID	WHITE	SEE TYPICAL TURN LANE MARKING DETAIL
TWO WAY LEFT TURN MARKING	2 @ 4 (100) EACH DIRECTION 8' (2.4m) LEFT ARROW	SKIP-DASH AND SOLID IN PAIRS	YELLOW WHITE	10' (3 m) LINE WITH 30' (9 m) SPACE FOR SKIP-DASH; 5 1/2 (140) C-C BETWEEN SOLID LINE AND SKIP-DASH LINE SEE TYPICAL TWO-WAY LEFT TURN MARKING DETAIL.
CROSSWALK LINES (PEDESTRIAN) A. DIAGONALS (BIKE & EQUESTRIAN) B. LONGITUDINAL BARS (SCHOOL)	2 @ 6 (150) 12 (300) @ 45° 12 (300) @ 90°	SOLID SOLID SOLID	WHITE WHITE WHITE	NOT LESS THAN 6' (1.8 m) APART 2' (600) APART 2' (600) APART SEE TYPICAL CROSSWALK MARKING DETAILS.
STOP LINES	24 (600)	SOLID	WHITE	PLACE 4' (1.2 m) IN ADVANCE OF AND PARALLEL TO CROSSWALK, IF PRESENT. OTHERWISE, PLACE AT DESIRED STOPPING POINT, PARALLEL TO CROSSROAD CENTERLINE, WHERE POSSIBLE.
PAINTED MEDIANS	2 @ 4 (100) WITH 12 (300) DIAGONALS @ 45° NO DIAGONALS USED FOR 4' (1.2 m) WIDE MEDIANS	SOLID	YELLOW; TWO WAY TRAFFIC WHITE; ONE WAY TRAFFIC	11 (280) C-C FOR THE DOUBLE LINE SEE TYPICAL PAINTED MEDIAN MARKING.
GORE MARKING AND CHANNELIZING LINES	8 (200) WITH 12 (300) DIAGONALS @ 45°	SOLID	WHITE	DIAGONALS: 15' (4.5 m) C-C (LESS THAN 30MPH (50 km/h)) 20' (6 m) C-C 30MPH (50 km/h) TO 45MPH (70 km/h) 30' (9 m) C-C (OVER 45MPH (70 km/h))
RAILROAD CROSSING	24 (600) TRANSVERSE LINES: "RR" IS 6' (1.8 m) LETTERS: 15 (400) LINE FOR "X"	SOLID	WHITE	SEE STATE STANDARD 780001 AREA OF: *R*=3.6 SQ. FT. (0.33 m ²) EACH *X*=54.0 SQ. FT. (5.0 m ²)
SHOULDER DIAGONALS (REQUIRED FOR SHOULDERS ≥ 8')	12 (300) @ 45°	SOLID	WHITE - RIGHT YELLOW - LEFT	50' (15 m) C-C (LESS THAN 30MPH (50 km/h)) 75' (25 m) C-C 30 MPH (50 km/h) TO 45MPH (70 km/h) 150' (45 m) C-C (OVER 45MPH (70 km/h))
U TURN ARROW	SEE DETAIL	SOLID	WHITE	16.3 SF
2 ARROW COMBINATION LEFT AND U TURN	SEE DETAIL	SOLID	WHITE	30.4 SF

FOR FURTHER DETAILS ON PAVEMENT MARKING REFER TO STANDARD SPECIFICATIONS FOR ROAD AND BRIDGE CONSTRUCTION AND STATE STANDARD 780001.

All dimensions are in inches (millimeters) unless otherwise shown.

USER NAME = Eric.L.Thomas	DESIGNED - EVERS	REVISED - C. JUCIUS 09-09-09
	DRAWN - C. JUCIUS 07-01-13	REVISED - C. JUCIUS 12-21-15
	CHECKED -	REVISED - C. JUCIUS 04-12-16
PLOT DATE = 8/20/2024	DATE - 03-19-90	

**STATE OF ILLINOIS
DEPARTMENT OF TRANSPORTATION**

DISTRICT ONE			
TYPICAL PAVEMENT MARKINGS			
SCALE: NONE	SHEET 1 OF 1 SHEETS	STA. TO STA.	

F.A.P RTE.	SECTION	COUNTY	TOTAL SHEETS	SHEET NO.
311	2018-127-RS	DUPAGE	11	10
TC-13		CONTRACT NO. 62H61		
ILLINOIS		FED. AID PROJECT		

MODEL: Plan Sign (Sheet)
 FILE NAME: \\illinois.gov\DOT\Users\COTHOMASELM\Documents\Bentley\CONNECT\1012\Organization-Civil\DOT_Standards\Digital\Sheet Seests\Civil_Named_Boundary_SheetSeests.dgnlib

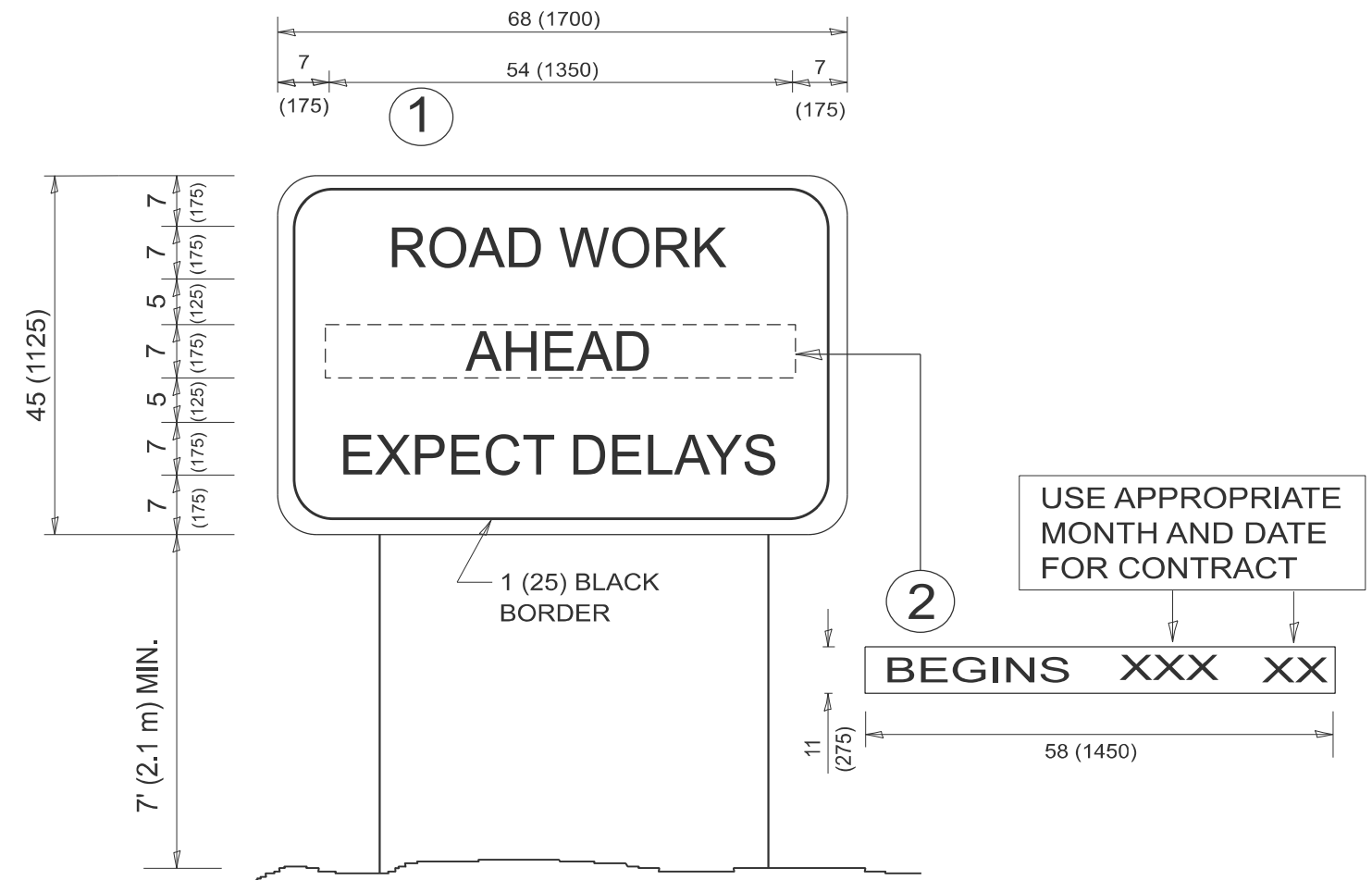

NOTES:

1. USE BLACK LETTERING ON ORANGE BACKGROUND.
2. ERECT SIGNS IN ADVANCE OF THE LOCATION FOR THE "ROAD CONSTRUCTION AHEAD" SIGN AT LOCATIONS AS DIRECTED BY THE ENGINEER.
3. ERECT SIGN ① WITH INSTALLED PANEL ② ONE WEEK PRIOR TO THE START OF CONSTRUCTION.
4. REMOVE PANEL ② SOON AFTER THE START OF CONSTRUCTION.
5. SEE SPECIAL PROVISION FOR "TEMPORARY INFORMATION SIGNING" FOR ADDITIONAL INFORMATION.
6. ONE SIGN ASSEMBLY EQUALS 25.70 SQ. FT. (2.3 SQ. M.)
7. SHALL BE PAID FOR AS TEMPORARY INFORMATION SIGNING.

ALL DIMENSIONS ARE IN INCHES (MILLIMETERS)
 UNLESS OTHERWISE SHOWN.

USER NAME = Eric.L.Thomas	DESIGNED -	REVISED - R. MIRS 09-15-97
	DRAWN -	REVISED - R. MIRS 12-11-97
	CHECKED -	REVISED - T. RAMMACHER 02-02-99
PLOT DATE = 8/20/2024	DATE -	REVISED - C. JUCIUS 01-31-07

**STATE OF ILLINOIS
 DEPARTMENT OF TRANSPORTATION**

**ARTERIAL ROAD
 INFORMATION SIGN**

SCALE: NONE SHEET 1 OF 1 SHEETS STA. TO STA.

F.A.P. RTE.	SECTION	COUNTY	TOTAL SHEETS	SHEET NO.
311	2018-127-RS	DUPAGE	11	11
TC-22			CONTRACT NO. 62H61	
ILLINOIS FED. AID PROJECT				