

STATE OF ILLINOIS
DEPARTMENT OF TRANSPORTATION

F.A.S. RTE.	SECTION	COUNTY	TOTAL SHEETS	SHEET NO.
1774	113B-1(BRR)	LOGAN	6	1
		ILLINOIS	CONTRACT NO. 72965	

D-96-044-25

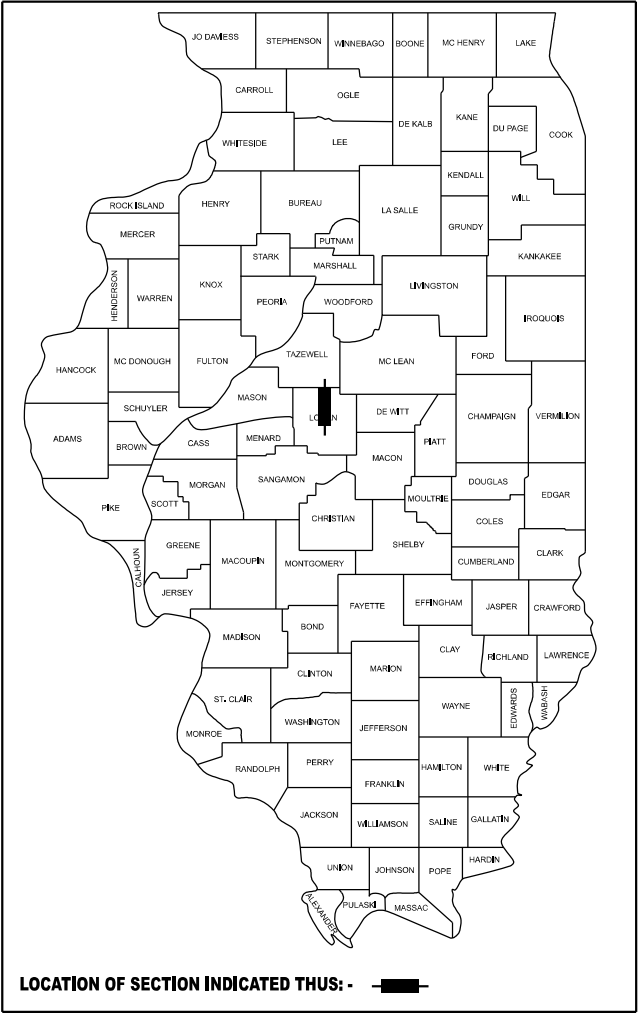

LOCATION OF SECTION INDICATED THUS: - ■ -

FOR INDEX OF SHEETS, SEE SHEET NO. 2

PROPOSED
HIGHWAY PLANS

FAS ROUTE 1774 (OLD IL 121)
SECTION 113B-1(BRR)
PROJECT (STATE ONLY)
BRIDGE SUBSTRUCTURE REPAIR
LOGAN COUNTY
C-96-080-25



PROJECT LOCATION:
SN 054-0103
OLD IL 121 OVER
BRANCH OF KICKAPOO CR.
0.5 MI N LINCOLN

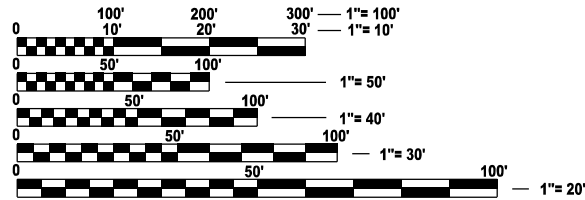

FULL SIZE PLANS HAVE BEEN PREPARED USING STANDARD
ENGINEERING SCALES. REDUCED SIZED PLANS WILL NOT
CONFORM TO STANDARD SCALES. IN MAKING MEASUREMENTS
ON REDUCED PLANS, THE ABOVE SCALES MAY BE USED.

J.U.L.I.E.
JOINT UTILITY LOCATION INFORMATION FOR EXCAVATION
1-800-892-0123
OR 811

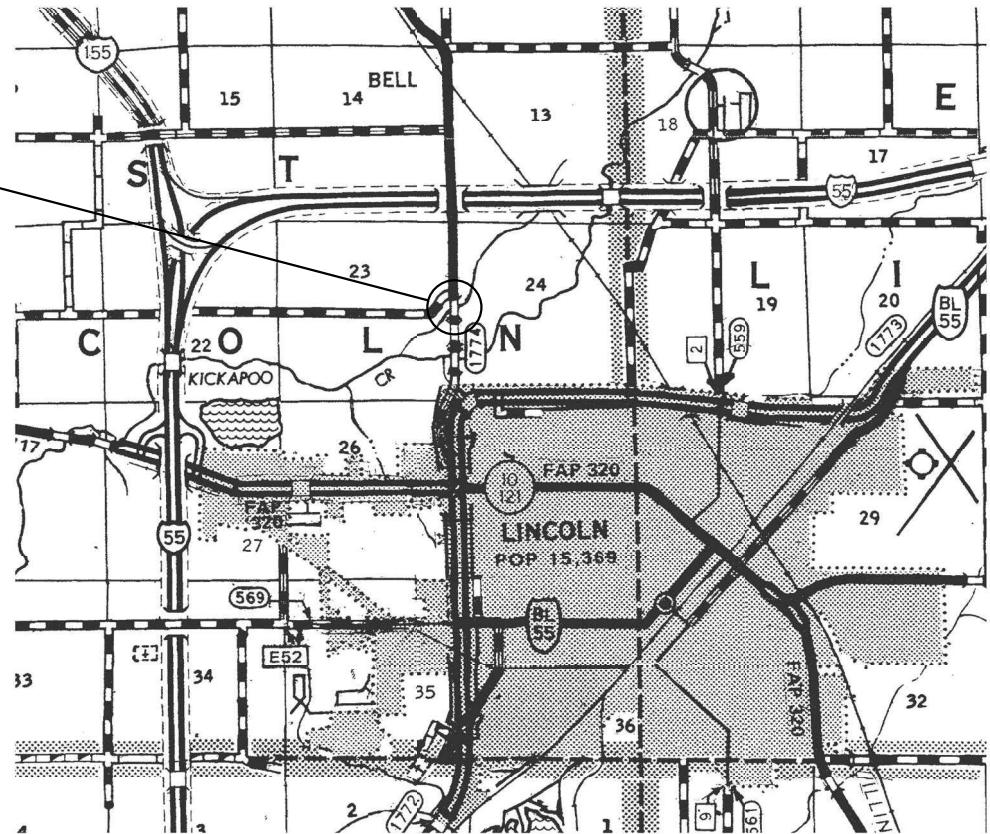

PROJECT ENGINEER: BRANDON DUDLEY - (217) 785-9290
PROJECT MANAGER

CONTRACT NO. 72965

GROSS LENGTH = 136 FT. = 0.03 MILE
NET LENGTH = 136 FT. = 0.03 MILE

STATE OF ILLINOIS
DEPARTMENT OF TRANSPORTATION

SUBMITTED May 7, 2025
Lora Renshaw REGIONAL ENGINEER
June 27, 2025
Scott E. [Signature] ENGINEER OF DESIGN AND ENVIRONMENT
June 27, 2025
[Signature] DIRECTOR OF HIGHWAYS PROJECT IMPLEMENTATION

PRINTED BY THE AUTHORITY
OF THE STATE OF ILLINOIS

INDEX OF SHEETS

- 1COVER SHEET
- 2INDEX, STANDARDS, GENERAL NOTES, SIGNATURES, & SCHEDULES
- 3SUMMARY OF QUANTITIES
- 4-6BRIDGE PLANS, SN 054-0103

HIGHWAY STANDARDS

- 000001-08
- 001001-02
- 001006
- 701001-02
- 701006-05
- 701201-05
- 701901-10

GENERAL NOTES:

STATE OF ILLINOIS
DEPARTMENT OF TRANSPORTATION
DIVISION OF HIGHWAYS
DISTRICT 6

EXAMINED

April 24,

20

25



ENGINEER OF OPERATIONS

EXAMINED

April 28,

20

25

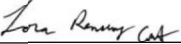

ENGINEER OF PROJECT IMPLEMENTATION

EXAMINED

April 28,

20

25

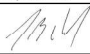

ENGINEER OF PROGRAM DEVELOPMENT

MODEL: index [Sheet]
FILE NAME: c:\p\work\pwt\td\duley\cml\1095491\72965 plansheet.dgn

	USER NAME = brandon.dudley	DESIGNED -	REVISED -	STATE OF ILLINOIS DEPARTMENT OF TRANSPORTATION	INDEX OF SHEETS, HIGHWAY STANDARDS, GENERAL NOTES, & SIGNATURES			F.A.S RTE.	SECTION	COUNTY	TOTAL SHEETS	SHEET NO.
		DRAWN -	REVISED -					1774	113B-1(BRR)	LOGAN	6	2
		CHECKED -	REVISED -					CONTRACT NO. 72965				
	PLOT DATE = 4/2/2025	DATE -	REVISED -		SCALE:	SHEET 1	OF 1	SHEETS	STA.	TO STA.	ILLINOIS FED. AID PROJECT	

[illegible]

MODEL: SOQ [Sheet]
FILE NAME: c:\pw_work\pwidot\dudley\bmid1099491\72965 plansheet.dgn

FILE NAME:	USER NAME = brandon.dudley	DESIGNED -	REVISED -	STATE OF ILLINOIS DEPARTMENT OF TRANSPORTATION	SUMMARY OF QUANTITIES			F.A.S RTE.	SECTION	COUNTY	TOTAL SHEETS	SHEET NO.	
		DRAWN -	REVISED -					1774	113B-1(BRR)	LOGAN	6	3	
		CHECKED -	REVISED -										
	PLOT DATE = 4/2/2025	DATE -	REVISED -		SCALE:	SHEET 1	OF 1	SHEETS	STA.	TO STA.	CONTRACT NO. 72965		
								ILLINOIS FED. AID PROJECT					

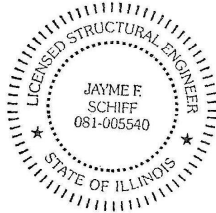
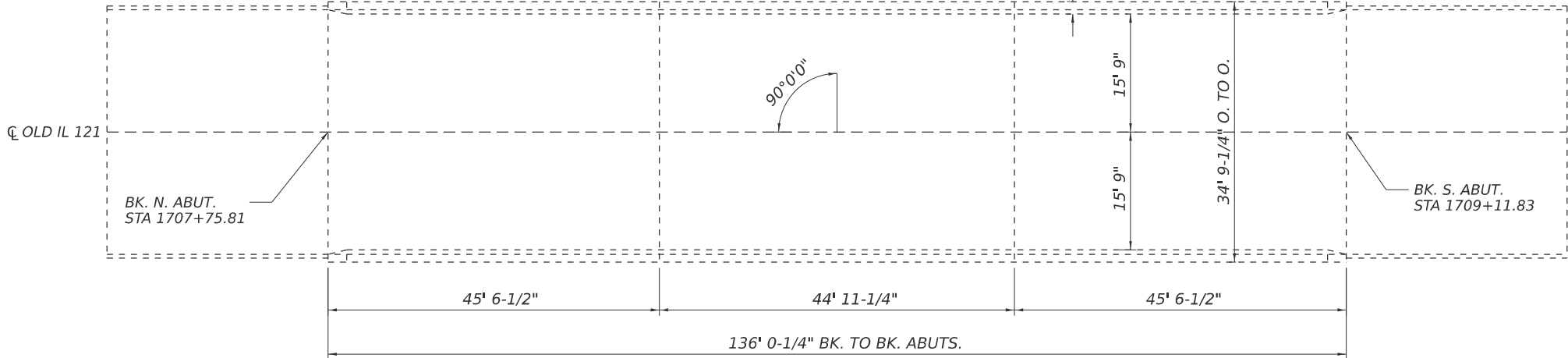
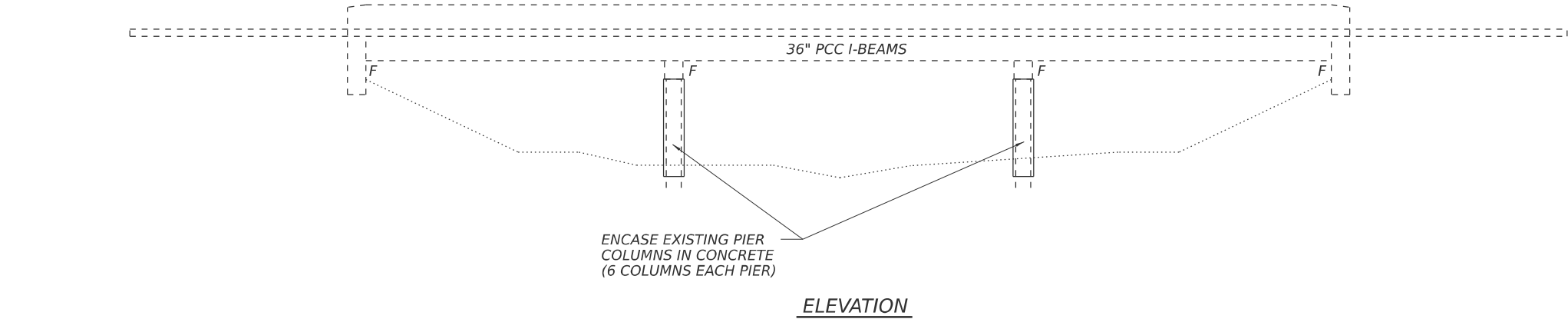

EXPIRES 11-30-2026

Jayme F. Schiff

STRUCTURE GENERAL NOTES:

PLAN DIMENSIONS AND DETAILS RELATIVE TO THE EXISTING STRUCTURE HAVE BEEN TAKEN FROM EXISTING PLANS AND ARE SUBJECT TO NOMINAL CONSTRUCTION VARIATIONS. THE CONTRACTOR SHALL FIELD VERIFY EXISTING DIMENSIONS AND DETAILS AFFECTING NEW CONSTRUCTION AND MAKE NECESSARY APPROVED ADJUSTMENTS PRIOR TO CONSTRUCTION OR ORDERING OF MATERIALS. SUCH VARIATIONS SHALL NOT BE CAUSE FOR ADDITIONAL COMPENSATION FOR A CHANGE IN THE SCOPE OF WORK, HOWEVER, THE CONTRACTOR WILL BE PAID FOR THE QUANTITY ACTUALLY FURNISHED AT THE UNIT PRICE BID FOR THE WORK.

EXISTING REINFORCEMENT BARS EXTENDING INTO THE REMOVAL AREA SHALL BE CLEANED, STRAIGHTENED, AND INCORPORATED INTO THE NEW CONSTRUCTION. ANY REINFORCEMENT BARS THAT ARE DAMAGED DURING CONCRETE REMOVAL SHALL BE REPLACED WITH AN APPROVED BAR SPLICER OR ANCHORAGE SYSTEM. COST INCLUDED WITH CONCRETE REMOVAL.

TOTAL BILL OF MATERIAL (054-0103)

ITEM	UNIT	QUANTITY
Concrete Structures	Cu. Yd.	26.4
Reinforcement Bars, Epoxy Coated	Pound	3610
Dewatering	L Sum	1

MODEL: bridge [Sheet]
FILE NAME: c:\p\work\jw\ford\dudley\mtd1095491172965 plansheet.dgn

	USER NAME = brandon.dudley	DESIGNED - BRANDON DUDLEY	REVISED -	STATE OF ILLINOIS DEPARTMENT OF TRANSPORTATION	BRIDGE PLAN & ELEVATION SN 054-0103				F.A.S RTE.	SECTION	COUNTY	TOTAL SHEETS	SHEET NO.
		DRAWN - BRANDON DUDLEY	REVISED -						1774	113B-1(BRR)	LOGAN	6	4
		CHECKED -	REVISED -		CONTRACT NO. 72965								
	PLOT DATE = 4/2/2025	DATE -	REVISED -		SCALE:	SHEET 1	OF 3	SHEETS	STA.	TO STA.	ILLINOIS FED. AID PROJECT		

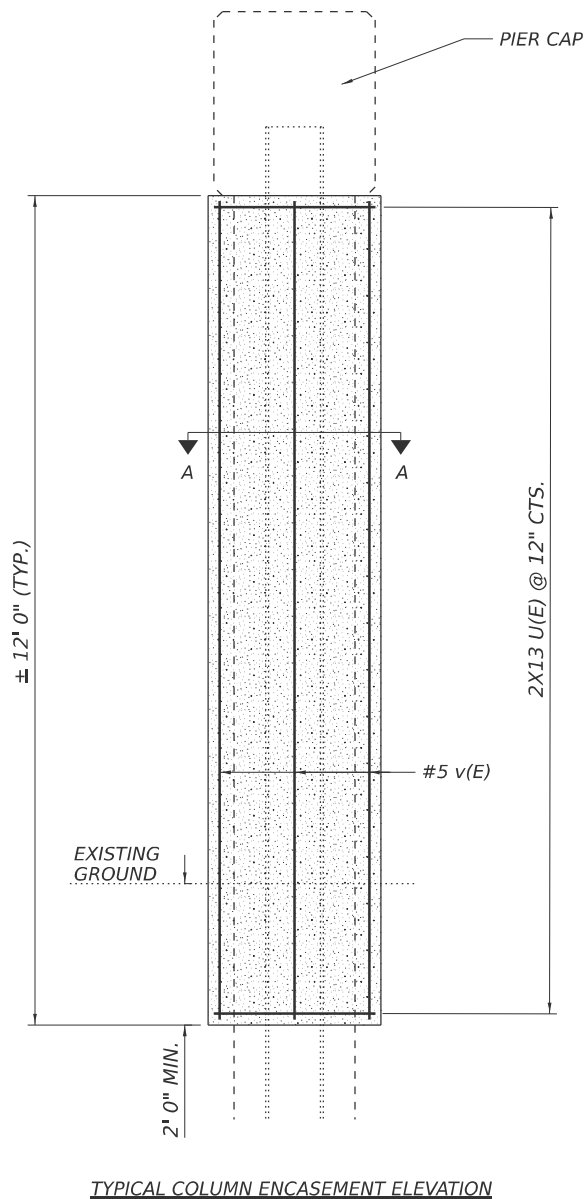
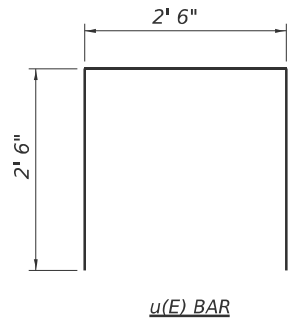
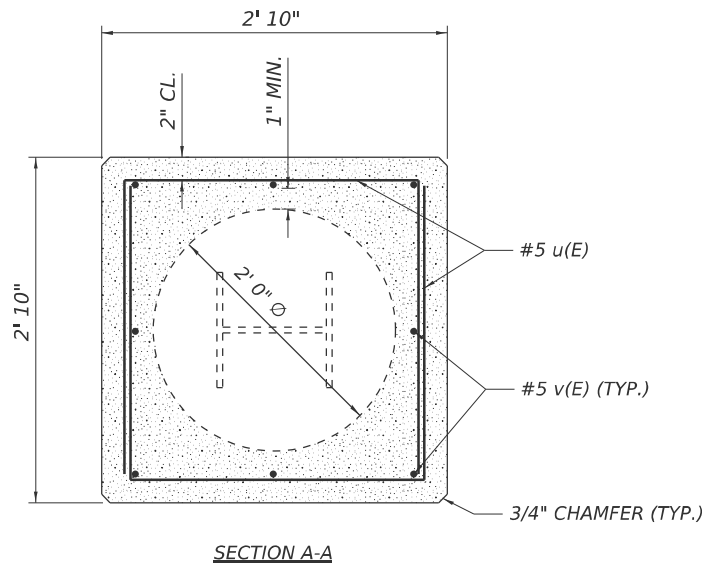

COLUMN ENCASEMENT
BILL OF MATERIAL (12 COLUMNS)

Bar	No.	Size	Length	Shape
u(E)	312	#5	7'-6"	U
v(E)	96	#5	11' 8"	—
Concrete Structures			Cu. Yd.	26.4
Reinforcement Bars, Epoxy Coated			Pound	3610

NOTES:

THE COST OF EXCAVATION NECESSARY FOR COLUMN ENCASEMENTS SHALL BE INCLUDED IN THE COST OF CONCRETE STRUCTURES.

ALL DETERIORATED OR DELAMINATED CONCRETE ENCOUNTERED ON THE EXISTING COLUMNS SHALL BE REMOVED AND HAVE CONTACT SURFACES CLEANED PRIOR TO POURING THE NEW ENCASEMENTS. CONCRETE REMOVAL AND SURFACE PREPARATION SHALL BE ACCORDING TO THE SPECIAL PROVISION FOR STRUCTURAL REPAIR OF CONCRETE. COST INCLUDED IN CONCRETE STRUCTURES.

MODEL: bridge-1 [Sheet]
FILE NAME: c:\p\work\p\work\dudley\cml\1095491\72965 plansheet.dgn

USER NAME = brandon.dudley	DESIGNED -	REVISED -
	DRAWN -	REVISED -
	CHECKED -	REVISED -
PLOT DATE = 4/2/2025	DATE -	REVISED -

STATE OF ILLINOIS
DEPARTMENT OF TRANSPORTATION

COLUMN ENCASEMENT DETAIL
SN 054-0103

SCALE: SHEET 2 OF 3 SHEETS STA. TO STA.

F.A.S RTE.	SECTION	COUNTY	TOTAL SHEETS	SHEET NO.
1774	113B-1(BRR)	LOGAN	6	5
CONTRACT NO. 72965				
ILLINOIS FED. AID PROJECT				

