

ALIGNMENT COORDINATES
W. 63rd STREET - S. STEWART AV. TO EAST OF S. WENTWORTH AV.

63rd	STATION	N	E
POT	10+00.00	1,863,159.83	1,174,638.25
PC	15+88.70	1,863,177.66	1,175,226.68
PI	16+04.07	1,863,178.12	1,175,242.04
PT	16+19.43	1,863,177.68	1,175,257.40
PC	17+77.70	1,863,173.08	1,175,415.61
PI	17+93.30	1,863,172.63	1,175,431.20
PT	18+08.89	1,863,173.10	1,175,446.79
PC	23+86.73	1,863,190.51	1,176,024.37
PI	24+06.91	1,863,191.11	1,176,044.54
PT	24+27.07	1,863,193.05	1,176,064.63
PC	25+01.29	1,863,200.17	1,176,138.51
PI	25+21.48	1,863,202.11	1,176,158.60
PT	25+41.65	1,863,202.75	1,176,178.78
POT	29+10.68	1,863,214.45	1,176,547.62

CURVE C1
PI STA. = 16+04.07
 $\Delta = 3^\circ 23' 57''$ (RT)
D = $11^\circ 03' 40''$
R = 517.99'
T = 15.37'
L = 30.73'
E = 0.23'
P.C. STA. = 15+88.70
P.T. STA. = 16+19.43

CURVE C2
PI STA. = 17+93.30
 $\Delta = 3^\circ 23' 26''$ (LT)
D = $10^\circ 52' 17''$
R = 527.04'
T = 15.60'
L = 31.19'
E = 0.23'
P.C. STA. = 17+77.70
P.T. STA. = 18+08.89

CURVE C3
PI STA. = 24+06.91
 $\Delta = 3^\circ 46' 39''$ (LT)
D = $9^\circ 21' 49''$
R = 611.89'
T = 20.18'
L = 40.34'
E = 0.33'
P.C. STA. = 23+86.73
P.T. STA. = 24+27.07

CURVE C4
PI STA. = 25+21.48
 $\Delta = 3^\circ 41' 13''$ (RT)
D = $9^\circ 08' 06''$
R = 627.21'
T = 20.19'
L = 40.36'
E = 0.32'
P.C. STA. = 25+01.29
P.T. STA. = 25+41.65

BENCHMARK #1
ELEV. 603.071'
CHISELED SQUARE ON THE NORTHEAST CORNER OF CONCRETE BASE FOR TRAFFIC CONTROL BOX AT THE SOUTHEAST CORNER OF W. 63rd STREET & S. WENTWORTH AVENUE
STATION 24+42.75, 42.63' RT.
N 1,863,152.12
E 1,176,084.33

BENCHMARK #2
ELEV. 601.095'
CHISELED CROSS ON CHAIN BOLT OF HYDRANT AT THE SOUTHWEST CORNER OF S. YALE AVENUE & W. 63rd STREET
STATION 19+20.27, 48.49' RT.
N 1,863,128.00
E 1,175,559.54

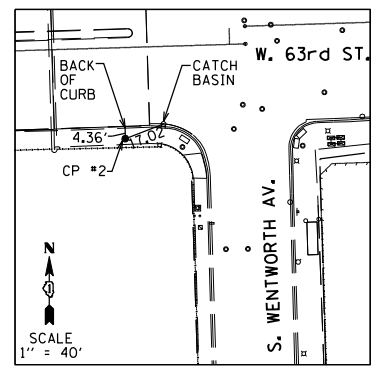

CONTROL POINT #2
CHISELED CROSS IN CONCRETE WALK ON THE SOUTH SIDE OF W. 63rd STREET AT THE EAST END OF BRIDGE, WEST OF S. WENTWORTH AVENUE
ELEV. 600.14'
STATION 23+55.39, 37.95' RT.
N 1,863,151.637
E 1,175,994.484

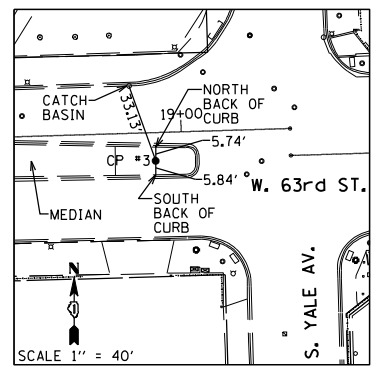

CONTROL POINT #3
CHISELED CROSS IN CONCRETE MEDIAN ISLAND 30' WEST OF MEDIAN NOSE WEST OF S. YALE AV. IN W. 63rd STREET
ELEV. 600.25'
STATION 18+89.02, 11.77' RT.
N 1,863,174.983
E 1,175,527.219

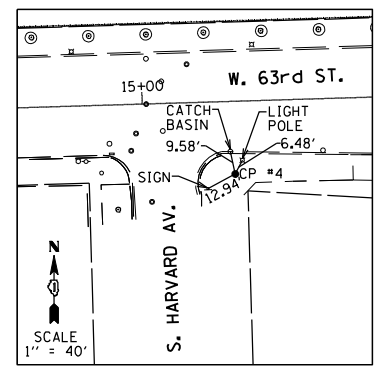

CONTROL POINT #4
CHISELED CROSS IN SIDEWALK AT THE NE CORNER OF S. HARVARD AVENUE & W. 63rd STREET
ELEV. 599.01'
STATION 15+37.90, 30.31' RT.
N 1,863,145.819
E 1,175,176.823

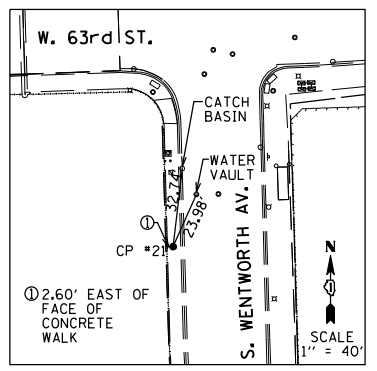

CONTROL POINT #21
CHISELED CROSS IN CONCRETE WALK ON THE WEST SIDE OF S. WENTWORTH AVENUE 66.20' SOUTH OF THE SOUTH LINE OF W. 63rd STREET
ELEV. 600.92'
STATION 23+85.55, 106.76' RT.
N 1,863,083.76
E 1,176,026.70

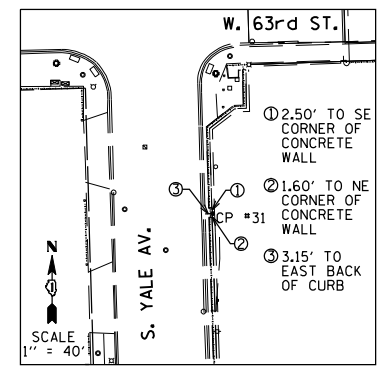

CONTROL POINT #31
CHISELED CROSS IN CONCRETE WALK ON THE EAST SIDE OF S. YALE AVENUE 62.00' SOUTH OF THE SOUTH LINE OF W. 63rd STREET
ELEV. 599.65'
STATION 19+68.01, 102.78' RT.
N 1,863,075.16
E 1,175,609.23

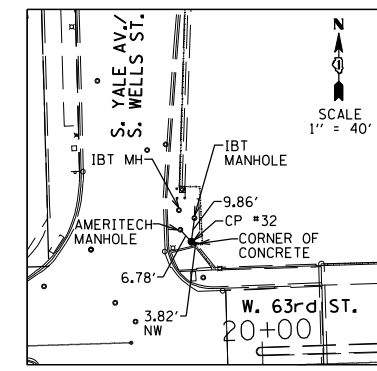

CONTROL POINT #32
CHISELED CROSS IN CONCRETE WALK AT THE NE CORNER OF S. YALE AVENUE/S. WELLS STREET & W. 63rd STREET
ELEV. 599.90'
STATION 19+71.80, 52.56' LT.
N 1,863,230.55
E 1,175,608.34

5/21/2013 10:54 AM



USER NAME = 0766	DESIGNED - JSO	REVISED -
DRAWN - HUM	CHECKED - TNS	REVISED -
PLOT SCALE = 1/8" = 40' IN.	DATE - 03-15-2013	REVISED -
PLOT DATE = 5/21/2013		

**STATE OF ILLINOIS
DEPARTMENT OF TRANSPORTATION**

**63rd STREET BRIDGE REPLACEMENT - COOK COUNTY
ALIGNMENT, TIES AND BENCHMARKS**

SCALE: 1"=50' SHEET 1 OF 1 SHEETS STA. TO STA.

F.A.I. RTE. 94	SECTION 1920-B	COUNTY COOK	TOTAL SHEETS 137	SHEET NO. 10
ILLINOIS FED. AID PROJECT			CONTRACT NO. 60J15	