

NOTE: ALL DIMENSIONS ARE TO EDGE OF SIDEWALK AND BACK OF CURB UNLESS OTHERWISE NOTED.

- LEGEND**
- 600.32 PROPOSED SIDEWALK ELEVATION
  - 600.32 C PROPOSED TOP OF CURB ELEVATION
  - 600.32 FL PROPOSED GUTTER FLOW LINE ELEVATION
  -  CATCHBASIN

**NE CORNER**

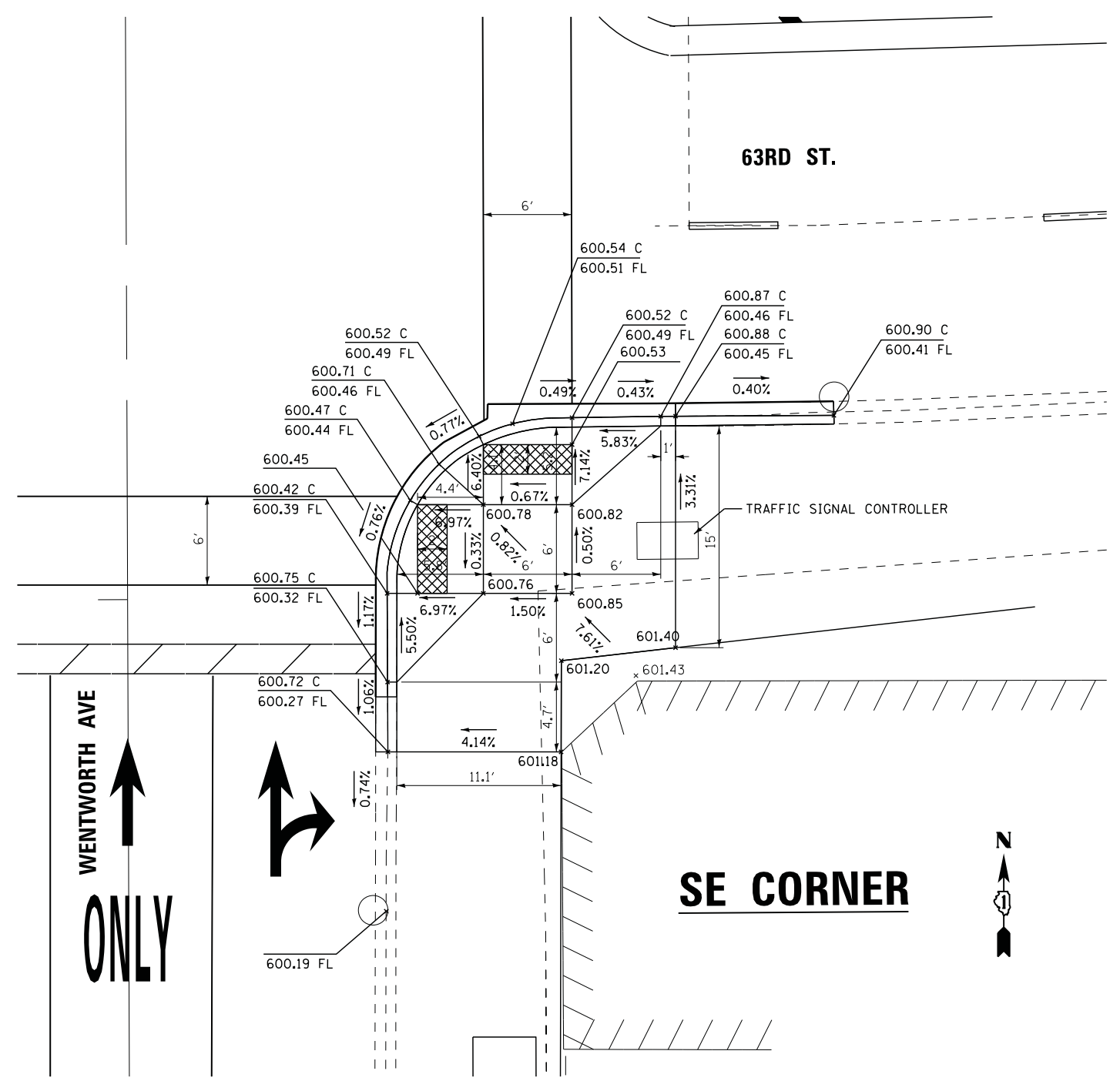
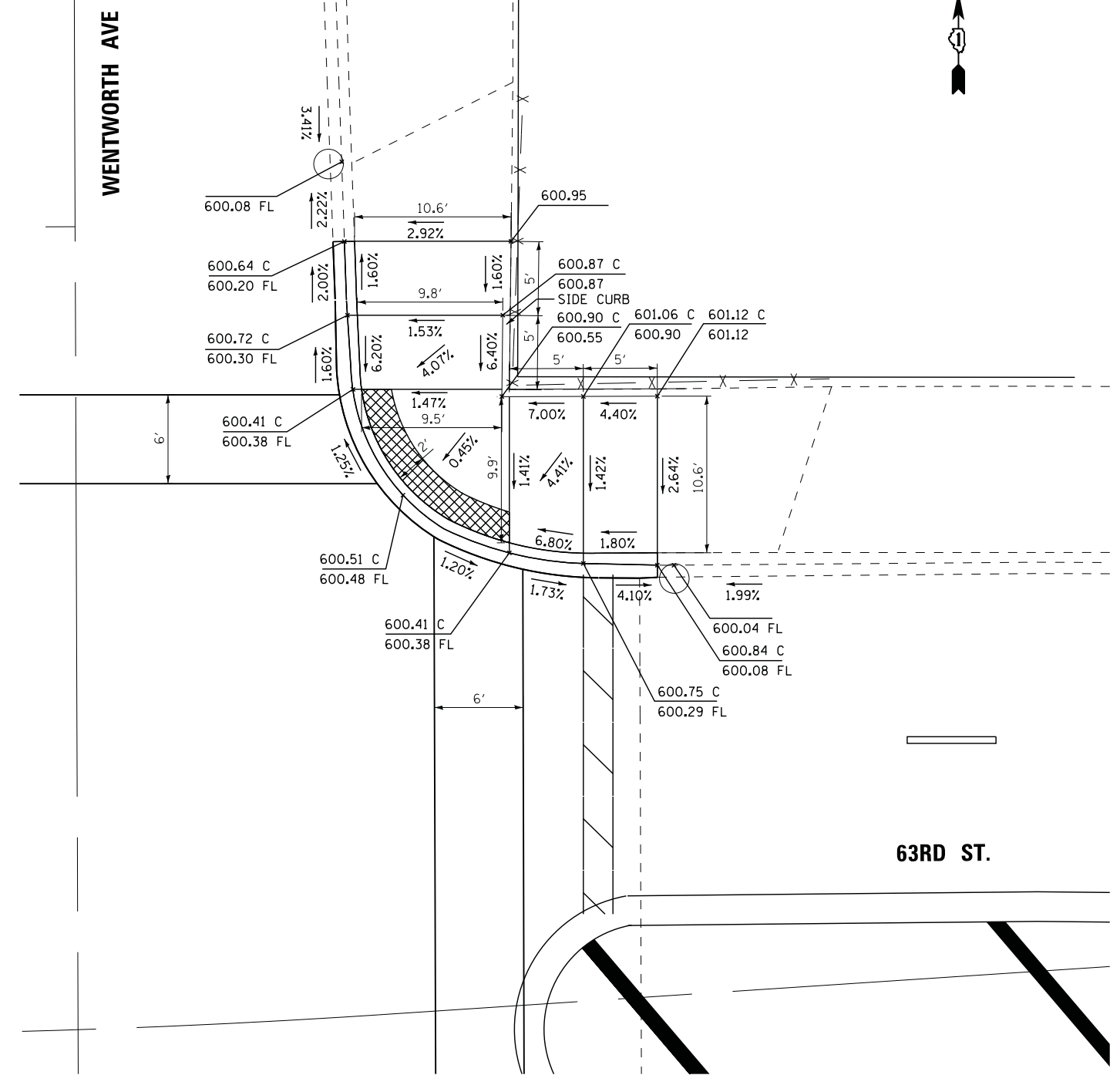

STATE OF ILLINOIS  
 DEPARTMENT OF TRANSPORTATION

CURB RAMP DETAILS			
63RD ST. AT WENTWORTH AVE			
SCALE: 1"=5'	SHEET NO.	OF SHEETS	STA. TO STA.

F.A.I. RTE.	SECTION	COUNTY	TOTAL SHEETS	SHEET NO.
94	1920-B	COOK	137	123
ILLINOIS FED. AID PROJECT			CONTRACT NO. 60J15	