

LEGEND

- ① STEEL PLATE BEAM GUARDRAIL, TYPE A, 6 FT POSTS
- ② TRAFFIC BARRIER TERMINAL, TYPE 2
- ③ AGGREGATE SHOULDER, TYPE B, 8"
- ④ AGGREGATE WEDGE SHOULDER, TYPE B, 3" MAX.
- ⑤ B-6.12 CURB AND GUTTER
- ⑥ B-6.24 CURB AND GUTTER
- ⑦ CONCRETE CURB, TYPE B
- ⑧ TOPSOIL, FURNISH & PLACE, 30"
- ⑨ CONCRETE MEDIAN, 4"
- ⑩ HOT-MIX ASPHALT PAVEMENT (FULL DEPTH)
- ⑪ HOT-MIX ASPHALT SHOULDER
- ⑫ HOT-MIX ASPHALT PAVEMENT OVERLAY AND WIDENING
- ⑬ HOT-MIX ASPHALT DRIVEWAY
- ⑭ P.C.C. DRIVEWAY PAVEMENT, 8"
- ⑮ P.C.C. SIDEWALK, 6"

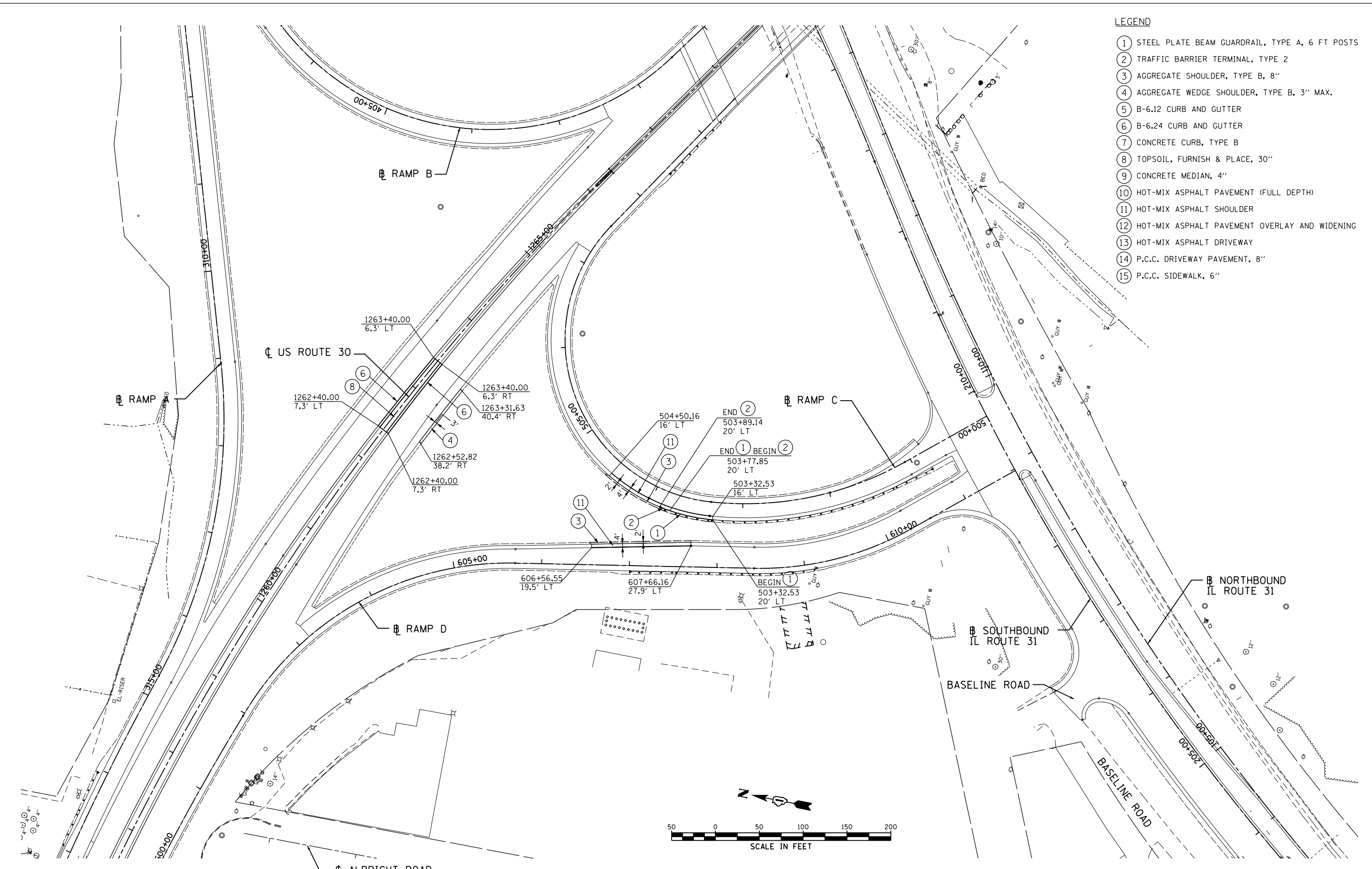

P:\1\1052010\20103003\cadd\site\vgd\01\Di60V53-sht+plan-01.dgn
 5/16/2013 2:52:22 PM

| | | |
|------------------------------|-------------------|-----------|
| USER NAME = 1654 | DESIGNED - JWB | REVISED - |
| | DRAWN - JWB | REVISED - |
| PLOT SCALE = 100.0000' / in. | CHECKED - RS | REVISED - |
| PLOT DATE = 5/16/2013 | DATE - 05/17/2013 | REVISED - |

STATE OF ILLINOIS
DEPARTMENT OF TRANSPORTATION

WATKINS STREET AT IL ROUTE 31
ROADWAY PLAN - RAMP C AND RAMP D
 SCALE: 1"=50' SHEET PLAN-1 OF 1
(RAMP C) STA. 500+00 TO STA. 507+52
 (RAMP D) STA. 600+00 TO STA. 609+96

| | | | | |
|---------------------------|---------|--------|--------------|-----------|
| F.A.U. RTE. | SECTION | COUNTY | TOTAL SHEETS | SHEET NO. |
| 3902 | 12R-N | KANE | 92 | 27 |
| CONTRACT NO. 60V53 | | | | |
| ILLINOIS FED. AID PROJECT | | | | |