

**NOTES:**

1. A SEPARATE CONTRACT (60133) WHICH WAS LET IN SEPTEMBER 2012 WILL BE ONGOING DURING CONSTRUCTION OF THIS CONTRACT. COORDINATION WITH CONTRACTORS AND CONSTRUCTION ACTIVITIES FOR THAT PROJECT WILL BE REQUIRED.
2. ALL FIBER OPTIC AND TRACER CABLE BETWEEN IL 31 @ RAMP C/D AND IL 31 @ AUCUTT RD./WEBSTER ST. SHALL BE INSTALLED UNDER THIS CONTRACT.
3. THE WIRELESS INTERCONNECT BETWEEN IL 31 @ RAMP C/D, US 30 @ IL 31 TEMP RAMP, IL 31 @ RAMP A/B/CASE ST, AND IL 31 @ AUCUTT RD./WEBSTER ST WAS INSTALLED UNDER CONTRACT 60133. THE WIRELESS INTERCONNECT ANTENNA SYSTEM WILL BE REMOVED UNDER THIS CONTRACT AFTER THE IL ROUTE 31/RAMP A & B/WATKINS SIGNAL AND THE PROPOSED INTERCONNECT SYSTEM ARE OPERATIONAL OR AS DIRECTED BY THE ENGINEER. THE REMOVAL OF THE WIRELESS INTERCONNECT SYSTEM SHALL BE APPROVED BY THE IDOT AREA TRAFFIC SIGNAL MAINTENANCE AND OPERATIONS ENGINEER.
4. TEMPORARY TRAFFIC CONTROL AT THE RAILROAD CROSSING DURING CONSTRUCTION SHALL FOLLOW SECTION 8 OF THE MANUAL ON UNIFORM TRAFFIC CONTROL DEVICES AS FOLLOWS:  
  
WHEN A GRADE CROSSING EXISTS EITHER WITHIN OR IN THE VICINITY OF A TEMPORARY TRAFFIC CONTROL ZONE, LANE RESTRICTIONS, FLAGGING (SEE CHAPTER 6E), OR OTHER OPERATIONS SHALL NOT BE PERFORMED IN A MANNER THAT WOULD CAUSE HIGHWAY VEHICLES TO STOP ON THE RAILROAD OR LRT TRACKS, UNLESS A FLAGGER OR UNIFORMED LAW ENFORCEMENT OFFICER IS PROVIDED AT THE GRADE CROSSING TO MINIMIZE THE POSSIBILITY OF HIGHWAY VEHICLES STOPPING ON THE TRACKS, EVEN IF AUTOMATIC WARNING DEVICES ARE IN PLACE.

\* INSTALLED BY OTHERS UNDER CONTRACT 60133

**REMOVAL OF EXISTING TRAFFIC SIGNAL EQUIPMENT**

THE FOLLOWING EXISTING TRAFFIC SIGNAL EQUIPMENT SHALL BE REMOVED BY THE CONTRACTOR, SHALL REMAIN THE PROPERTY OF THE STATE AND SHALL BE DELIVERED BY THE CONTRACTOR TO THE STATE'S TRAFFIC SIGNAL MAINTENANCE CONTRACTOR'S MAIN FACILITY AS PER THE TRAFFIC SIGNAL SPECIFICATIONS.

- 1 EACH WIRELESS INTERCONNECT ANTENNA COMPLETE SYSTEM

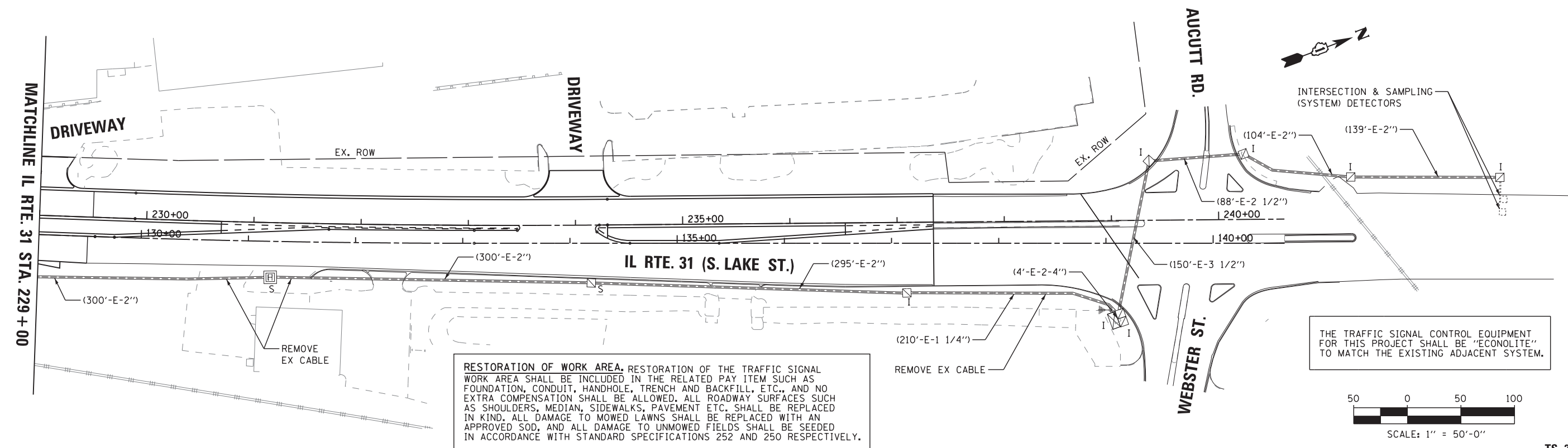

RESTORATION OF WORK AREA. RESTORATION OF THE TRAFFIC SIGNAL WORK AREA SHALL BE INCLUDED IN THE RELATED PAY ITEM SUCH AS FOUNDATION, CONDUIT, HANDHOLE, TRENCH AND BACKFILL, ETC., AND NO EXTRA COMPENSATION SHALL BE ALLOWED. ALL ROADWAY SURFACES SUCH AS SHOULDERS, MEDIAN, SIDEWALKS, PAVEMENT ETC. SHALL BE REPLACED IN KIND. ALL DAMAGE TO MOWED LAWNS SHALL BE REPLACED WITH AN APPROVED SOD, AND ALL DAMAGE TO UNMOWED FIELDS SHALL BE SEEDED IN ACCORDANCE WITH STANDARD SPECIFICATIONS 252 AND 250 RESPECTIVELY.

THE TRAFFIC SIGNAL CONTROL EQUIPMENT FOR THIS PROJECT SHALL BE "ECONOLITE" TO MATCH THE EXISTING ADJACENT SYSTEM.

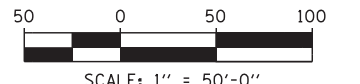

FILE NAME = *FILEL*	USER NAME = *USER*	DESIGNED - KMM	REVISED -	<b>STATE OF ILLINOIS DEPARTMENT OF TRANSPORTATION</b>	<b>INTERCONNECT PLAN IL ROUTE 31 (CATERPILLAR DRIVE TO KNELL RD)</b>	F.A. RTE.	SECTION	COUNTY	TOTAL SHEETS	SHEET NO.
	PLOT SCALE = *SCALE*	DRAWN - LV	REVISED -			349	(10 & 11 VB) R-3	ILLINOIS	6	20
	PLOT DATE = *DATE*	CHECKED - JDH	REVISED -			* KANE AND KENDALL		CONTRACT NO. 60V53		
		DATE - 6/15/2012	REVISED -			ILLINOIS FED. AID PROJECT				
					SCALE: 1"=50'	SHEET NO. 2 OF 2 SHEETS	STA. 215+00 TO STA. 241+50			

TS-20