

THE PROPOSED BEACON SHALL BE LOCATED OVER THE INTERSECTION CENTER LINES OF US 150 & MAHER RD.

WIRING DIAGRAM

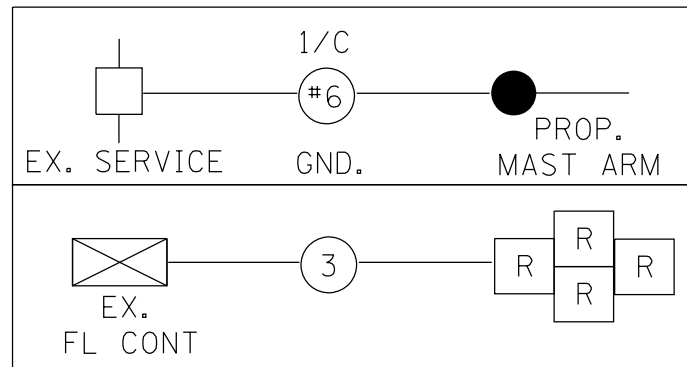

SCHEDULE OF QUANTITIES - US 150 & MAHER ROAD FLASHING BEACON

ITEM DESCRIPTION	UNIT	TOTAL QTY.
UNDERGROUND CONDUIT, PVC, 2" DIA.	FOOT	45
ELECTRIC CABLE IN CONDUIT, 600V, (XLP-TYPE USE) 1/C NO. 6	FOOT	65.5
ELECTRIC CABLE IN CONDUIT, SIGNAL, NO. 14 3C	FOOT	140.5
STEEL MAST ARM ASSEMBLY AND POLE, 55 FT.	EACH	1
CONCRETE FOUNDATION, TYPE E, 36-INCH DIAMETER	FOOT	15
DRILL EXISTING HANDHOLE	EACH	1
SIGNAL HEAD, POLYCARBONATE, LED, 4-FACE, 1-SECTION, MAST ARM MOUNTED	EACH	1
REMOVE EXISTING TRAFFIC SIGNAL EQUIPMENT	EACH	1
REMOVE EXISTING HANDHOLE	EACH	3

CONSTRUCTION NOTES

- ANY MAINTENANCE OF EXISTING TRAFFIC SIGNALS WILL BE CONSIDERED EXTRA WORK IN ACCORDANCE WITH ARTICLE 109.04 OF THE STANDARD SPECIFICATIONS.
- THE LOCATION OF ALL UTILITIES AND PRIVATELY OWNED FACILITIES SHALL BE FIELD VERIFIED BY THE CONTRACTOR PRIOR TO THE INSTALLATION OF ANY COMPONENTS.
- THE CONTRACTOR SHALL BE RESPONSIBLE FOR LOCATING EXISTING IDOT ELECTRICAL FACILITIES AT HIS/HER OWN EXPENSE IF REQUIRED. THE CONTRACTOR SHALL ALSO BE LIABLE FOR ANY DAMAGE TO IDOT FACILITIES RESULTING FROM INACCURATE LOCATING.
- THE LOCATIONS FOR MASTARM FOUNDATIONS ARE PROVIDED FOR REFERENCE ONLY. THE CONTRACTOR SHALL NOTIFY RANDY LANINGA AT (309) 671-4477 FOR LOCATION VERIFICATION PRIOR TO INSTALLATION.
- ELECTRICAL WORK SHALL CONFORM WITH NATIONAL, STATE, AND LOCAL CODES.
- ALL TRAFFIC SIGNAL SECTIONS SHALL HAVE 12" SINGLE LED LENSES.
- THE RED SECTIONS OF THE SIGNAL HEADS SHARING THE SAME MAST ARM SHALL BE LEVEL WITH ONE ANOTHER AND MAINTAIN A 17 FT. MINIMUM CLEARANCE FROM THE HIGHEST POINT OF THE ROADWAY.
- ALL TRAFFIC SIGNAL HEAD BRACKETS ARE TO BE ALUMINUM WITH A NATURAL FINISH.
- THE EXISTING FLASHING BEACONS SHALL REMAIN IN OPERATION DURING THE CONSTRUCTION OF THE PROPOSED FLASHING BEACON.
- THE CONTRACTOR SHALL PROVIDE ELECTRICAL CABLE SLACK IN ACCORDANCE WITH ARTICLE 873.03.
- ELECTRICAL CABLE WILL BE MEASURED FOR PAYMENT IN ACCORDANCE WITH ARTICLE 873.04.
- ALL SURPLUS MATERIALS SHALL BE DISPOSED OF IN ACCORDANCE WITH ARTICLE 202.03 OF THE STANDARD SPECIFICATIONS.

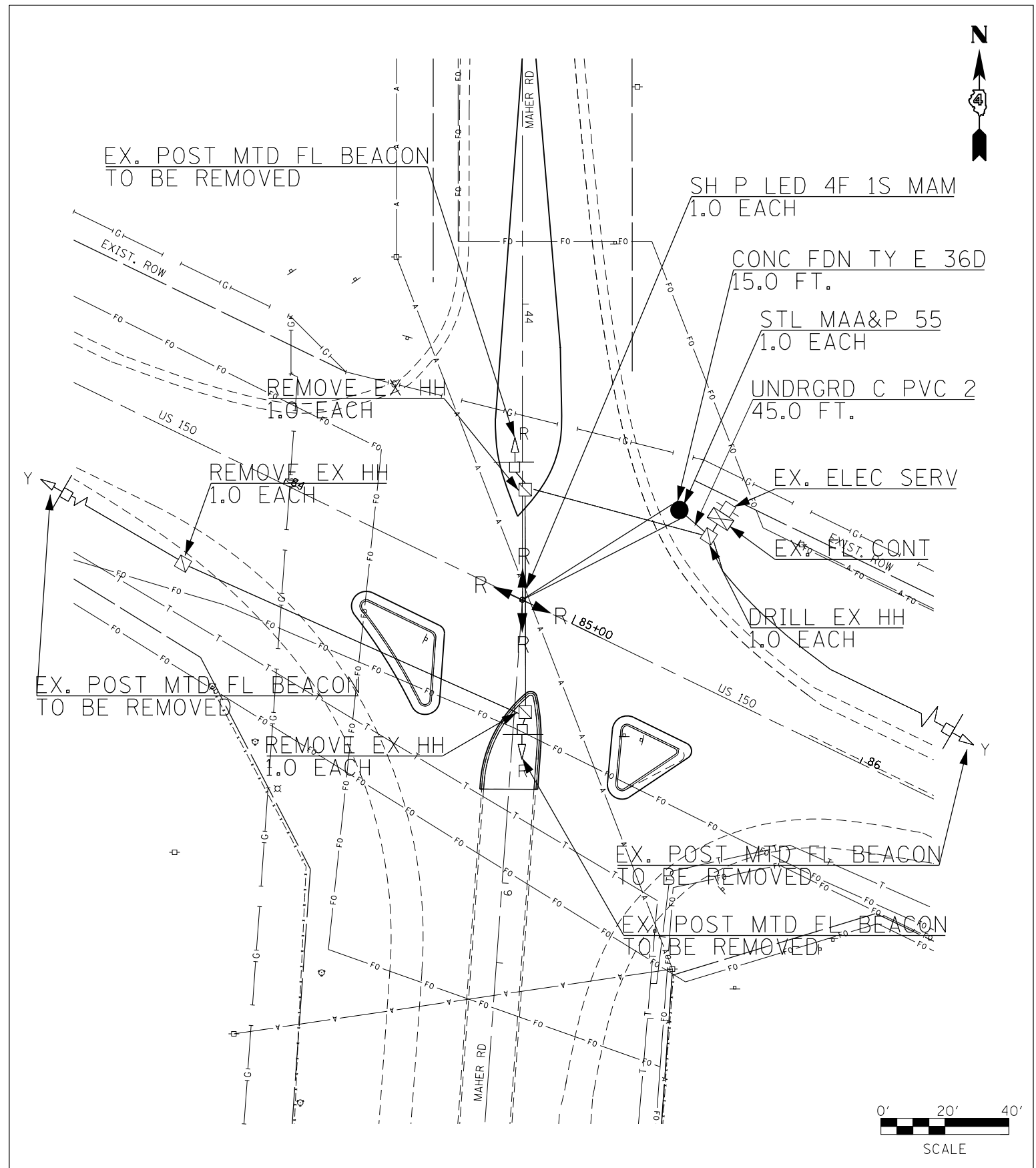

FILE NAME	USER NAME	DESIGNED -	REVISED -
		DRAWN -	REVISED -
		CHECKED -	REVISED -
		DATE -	REVISED -

STATE OF ILLINOIS
DEPARTMENT OF TRANSPORTATION

Flashing Beacon Plans

SCALE: SHEET OF SHEETS STA. TO STA.

F.A.S. RTE.	SECTION	COUNTY	TOTAL SHEETS	SHEET NO.
2402		PEORIA	76	40
CONTRACT NO. 68614				

(110,111,112,113)RS-3; 114RS-4; 112C-2