

EXISTING TYPICAL CROSS SECTION ⑥

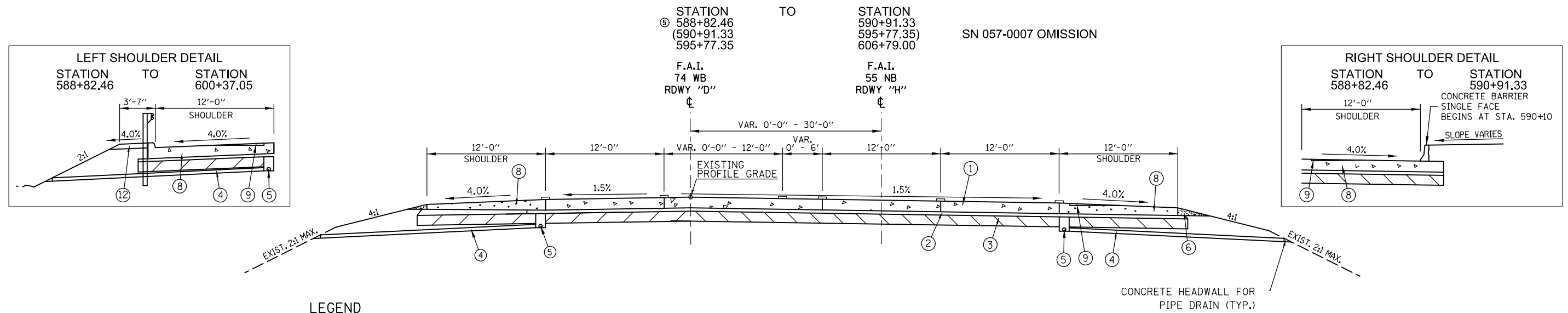

LEGEND

- | | | |
|--|--|--|
| ① EXISTING CONTINUOUSLY REINFORCED P.C.C. PAVEMENT 12 1/2" | ⑥ EXISTING AGGREGATE SHOULDER TYPE B, 6" | ⑫ EXISTING HMA SHOULDER, 8" |
| ② EXISTING STABILIZED SUB-BASE 4" | ⑦ EXISTING CONCRETE BARRIER | ⑬ CONCRETE SHOULDER CURB |
| ③ EXISTING PROCESSING LIME MODIFIED SOIL 12" | ⑧ EXISTING P.C.C. SHOULDER 12 1/2" | ⑭ EXISTING CONTINUOUSLY REINFORCED P.C.C. PAVEMENT 13 1/2" |
| ④ EXISTING PIPE UNDERDRAIN 4" (SPECIAL) | ⑩ 4" P.V.C. EMBEDDED IN STRUCTURE | ⑮ EXISTING P.C.C. SHOULDER 13 1/2" |
| ⑤ EXISTING PIPE UNDERDRAIN 4" | ⑪ 2" P.V.C. CONDUIT FOR LIGHTING | |

NOTES

- ① LONGITUDINAL CONSTRUCTION JOINT WITH GROUTED-IN-PLACE TIE BAR STD 420001 TYPICAL FOR ALL LONGITUDINAL CONSTRUCTION JOINTS.

PROPOSED TYPICAL CROSS SECTION ⑥

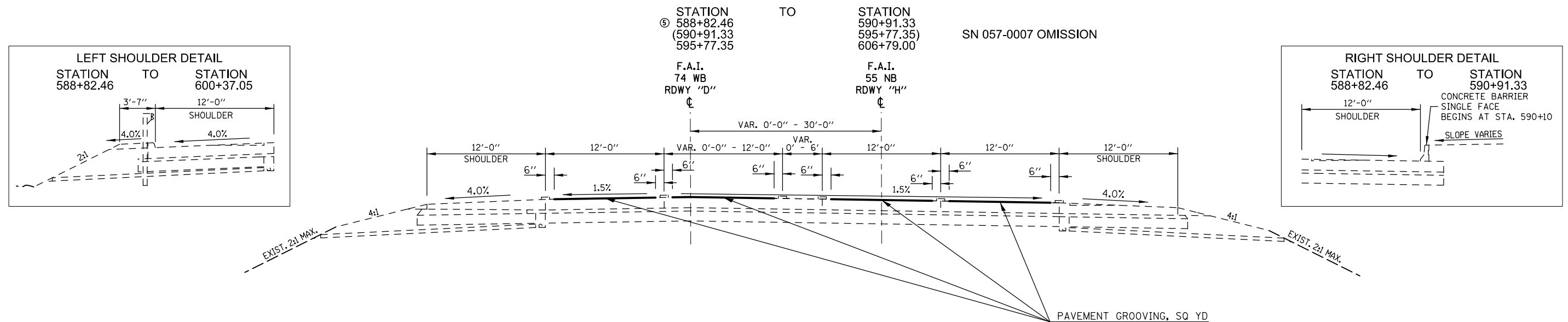

LEGEND

- | | | |
|--|--|--|
| ① EXISTING CONTINUOUSLY REINFORCED P.C.C. PAVEMENT 12 1/2" | ⑥ EXISTING AGGREGATE SHOULDER TYPE B, 6" | ⑫ EXISTING HMA SHOULDER, 8" |
| ② EXISTING STABILIZED SUB-BASE 4" | ⑦ EXISTING CONCRETE BARRIER | ⑬ CONCRETE SHOULDER CURB |
| ③ EXISTING PROCESSING LIME MODIFIED SOIL 12" | ⑧ EXISTING P.C.C. SHOULDER 12 1/2" | ⑭ EXISTING CONTINUOUSLY REINFORCED P.C.C. PAVEMENT 13 1/2" |
| ④ EXISTING PIPE UNDERDRAIN 4" (SPECIAL) | ⑩ 4" P.V.C. EMBEDDED IN STRUCTURE | ⑮ EXISTING P.C.C. SHOULDER 13 1/2" |
| ⑤ EXISTING PIPE UNDERDRAIN 4" | ⑪ 2" P.V.C. CONDUIT FOR LIGHTING | |

NOTES

- ① LONGITUDINAL CONSTRUCTION JOINT WITH GROUTED-IN-PLACE TIE BAR STD 420001 TYPICAL FOR ALL LONGITUDINAL CONSTRUCTION JOINTS.

FILE NAME =	USER NAME = bergana.j	DESIGNED -	REVISED -	STATE OF ILLINOIS DEPARTMENT OF TRANSPORTATION	TYPICAL SECTIONS	F.A.I. RTE.	SECTION	COUNTY	TOTAL SHEETS	SHEET NO.
et:\pw\work\p\idot\bergana.j\0337583\0570A25-sh-typical.dgn		DRAWN -	REVISED -			•	HSIP 2013-1	MCLEAN	11	9
	PLOT SCALE = 100.0000' / 1"	CHECKED -	REVISED -							
	PLOT DATE = 4/23/2013	DATE -	REVISED -							
					SCALE:	SHEET NO. 6 OF 6 SHEETS		STA. 588+82.46 TO STA. 606+79.00		CONTRACT NO. 70A25
										ILLINOIS FED. AID PROJECT

• F.A.I. 55, F.A.I. 74, & U.S. 51