

STATE OF ILLINOIS
DEPARTMENT OF TRANSPORTATION

ROUTE NO.	SECTION	COUNTY	TOTAL SHEETS	SHEET NO.	SHEET NO.
F.A.U. 7706	23(B-1)	LOGAN	179	99	52 SHEETS
FED. ROAD DIST. NO. 7	ILLINOIS	FED. AID PROJECT-			

Contract #72789

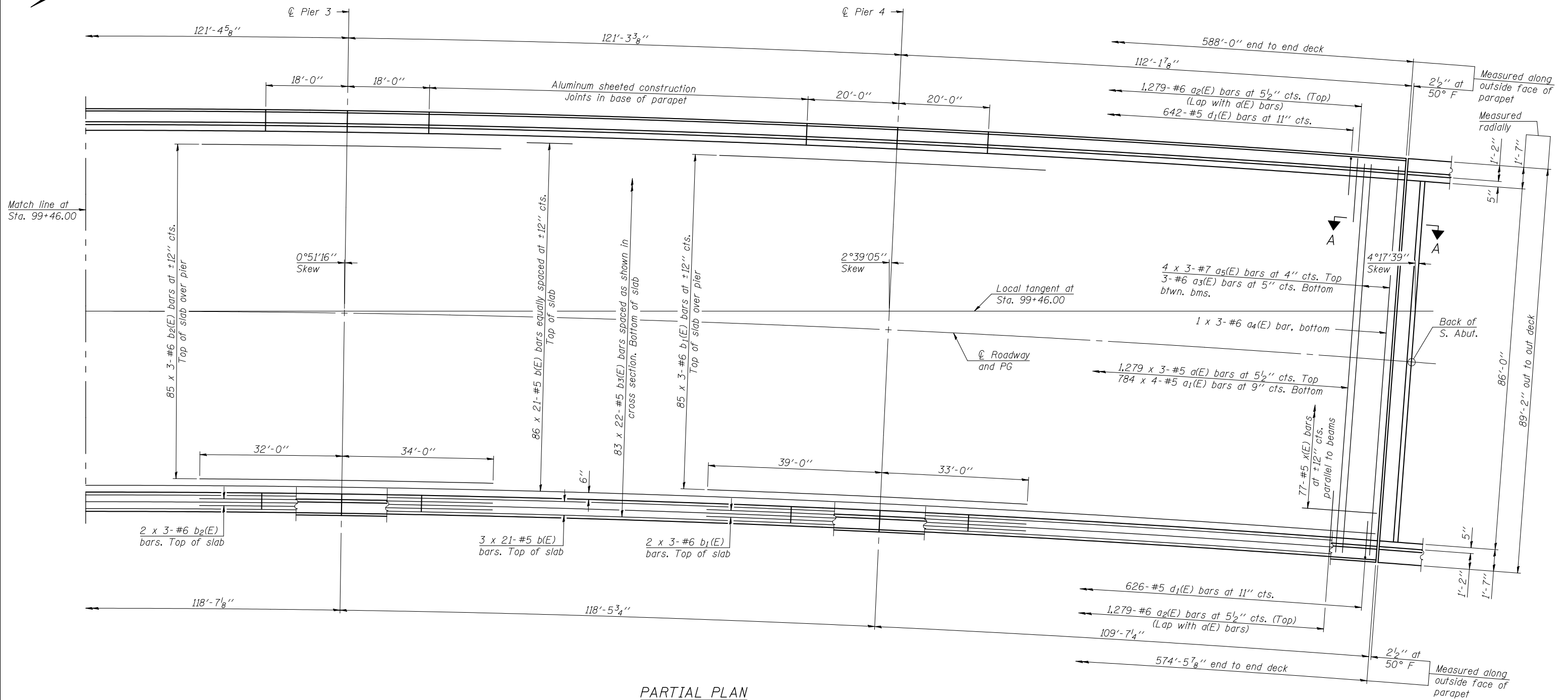

PARTIAL PLAN

DESIGNED	JJD
CHECKED	EML
DRAWN	JJD
CHECKED	EML

MINIMUM BAR LAP
 #5 bar = 3'-3"
 #6 bar = 3'-10"
 #7 bar = 5'-2"



SUPERSTRUCTURE
 F.A.U. ROUTE 7706 - SECTION 23(B-1)
 LOGAN COUNTY
 STATION 99+46.00
 STRUCTURE NO. 054-0512