

STATE OF ILLINOIS
DEPARTMENT OF TRANSPORTATION

ROUTE NO.	SECTION	COUNTY	TOTAL SHEETS	SHEET NO.	SHEET NO. 20 52 SHEETS
F.A.U. 7706	23(B-1)	LOGAN	179	104	
FED. ROAD DIST. NO. 7	ILLINOIS	FED. AID PROJECT-			

Contract #72789

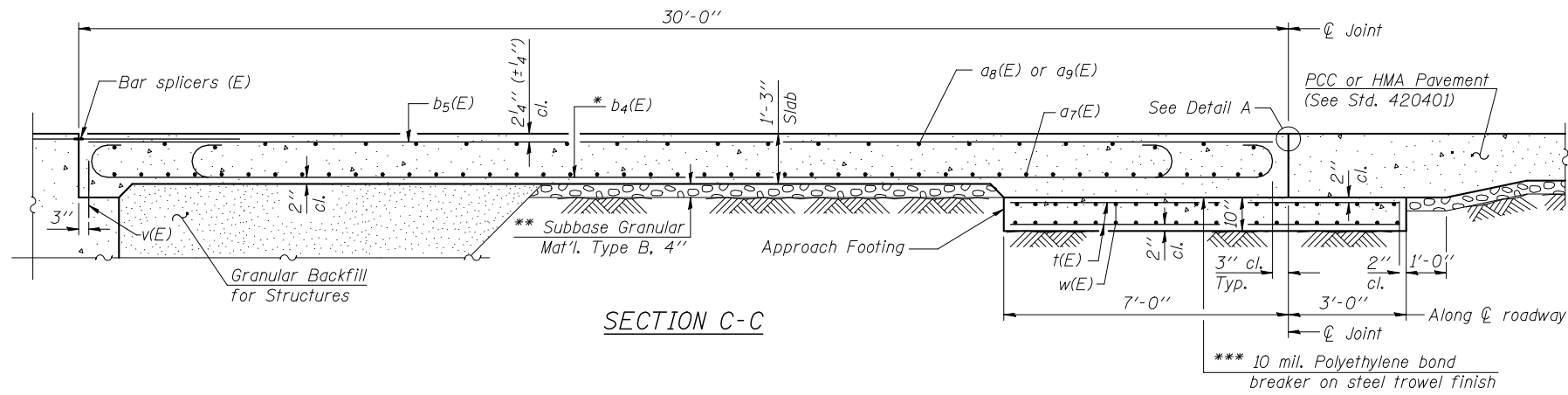

Notes:
See sheet 19 of 52 for Detail A and View B-B.
Approach slab concrete shall be paid for as Concrete Superstructure.
Approach footing concrete shall be paid for as Concrete Structures.
Reinforcement shall be paid for as Reinforcement Bars, Epoxy Coated.
For v(E) bar details, see sheet 36 of 52.
The approach footing maximum applied service bearing pressure (Qmax) = 2.0 ksf.
For bar splicer details, see sheet 46 of 52.
Cost of excavation for approach footing included with Concrete Structures.
For Granular Backfill for Structures and drainage treatment details, see sheet 2 of 52.

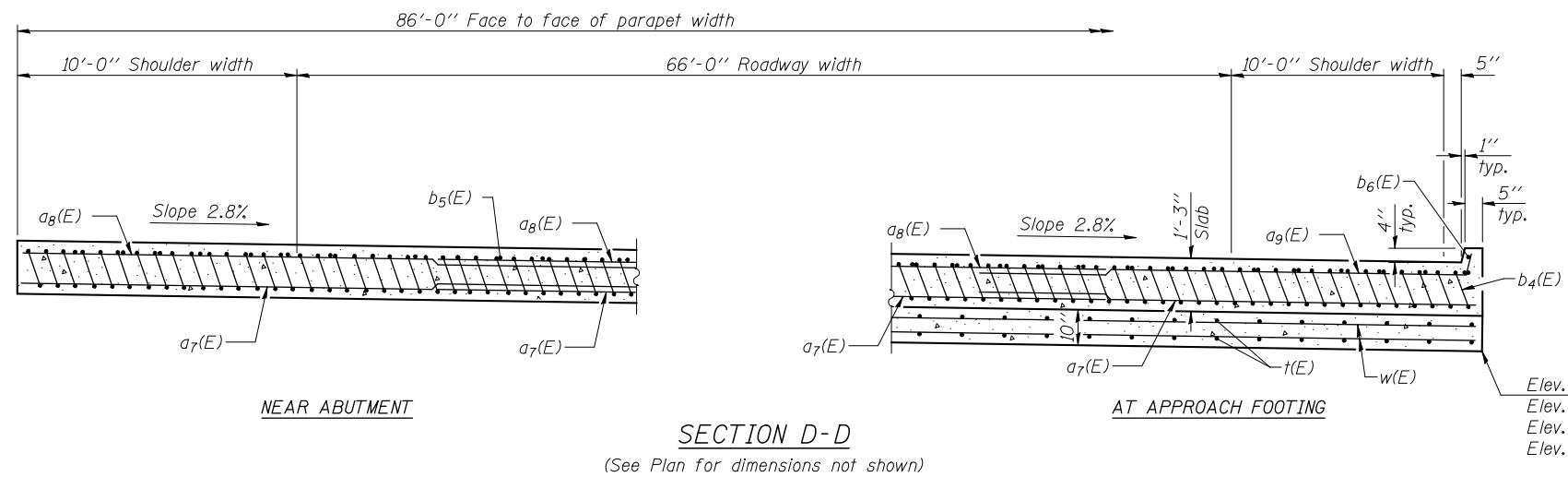

* Tilt #9 b4(E) bars as required to maintain clearance.
*** Cost included with Concrete Superstructure.

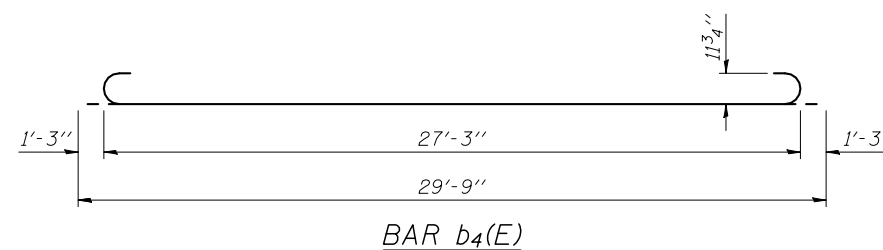
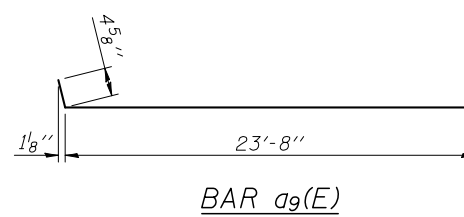

TWO APPROACHES
BILL OF MATERIAL

Bar	No.	Size	Length	Shape
a7(E)	276	#5	31'-3"	—
a8(E)	152	#4	23'-8"	—
a9(E)	48	#4	24'-1"	—
b4(E)	422	#9	29'-9"	—
b5(E)	142	#4	29'-8"	—
b6(E)	4	#4	15'-4"	—
t(E)	352	#4	9'-8"	—
w(E)	240	#5	31'-2"	—
Concrete Superstructure			Cu. Yd.	258.8
Concrete Structures			Cu. Yd.	54.2
Reinforcement Bars, Epoxy Coated			Pound	67,790

DESIGNED	EML
CHECKED	KLH
DRAWN	EML
CHECKED	KLH

BRIDGE APPROACH SLAB DETAILS
F.A.U. ROUTE 7706 - SECTION 23(B-1)
LOGAN COUNTY
STATION 99+46.00
STRUCTURE NO. 054-0512

