

Contract #72789

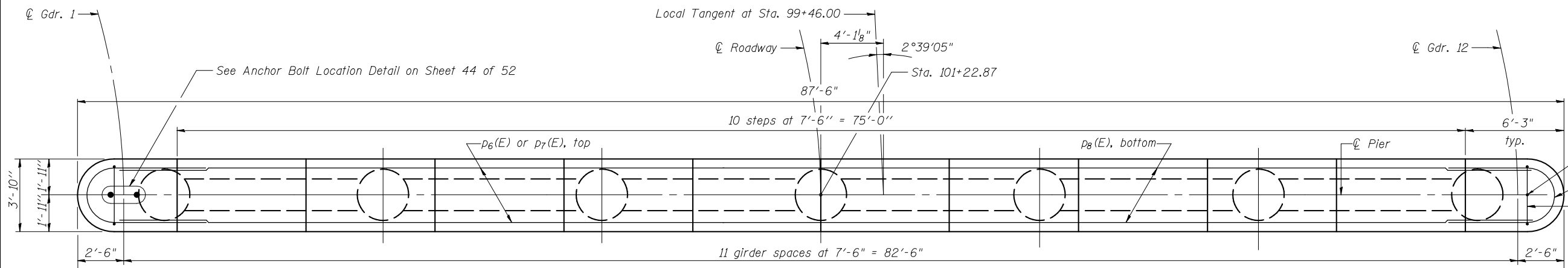

NOTES

- Cast steps monolithically with cap.
- Space cap reinforcement to miss anchor bolts.
- Minimum lap for spirals = 2'-7"
- Concrete within limits of Drilled Shaft in Rock at each shaft location shall be poured within 24 hours of rock excavation for that shaft.
- See Sheet 44 of 52 for Sections A-A, B-B and C-C.
- See Sheet 44 of 52 for bar details and Bill of Material.
- Bars indicated thus 3x3-#6 etc. indicates 3 lines of bars with 3 lengths per line.

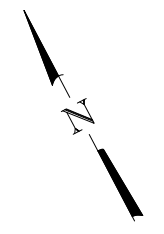
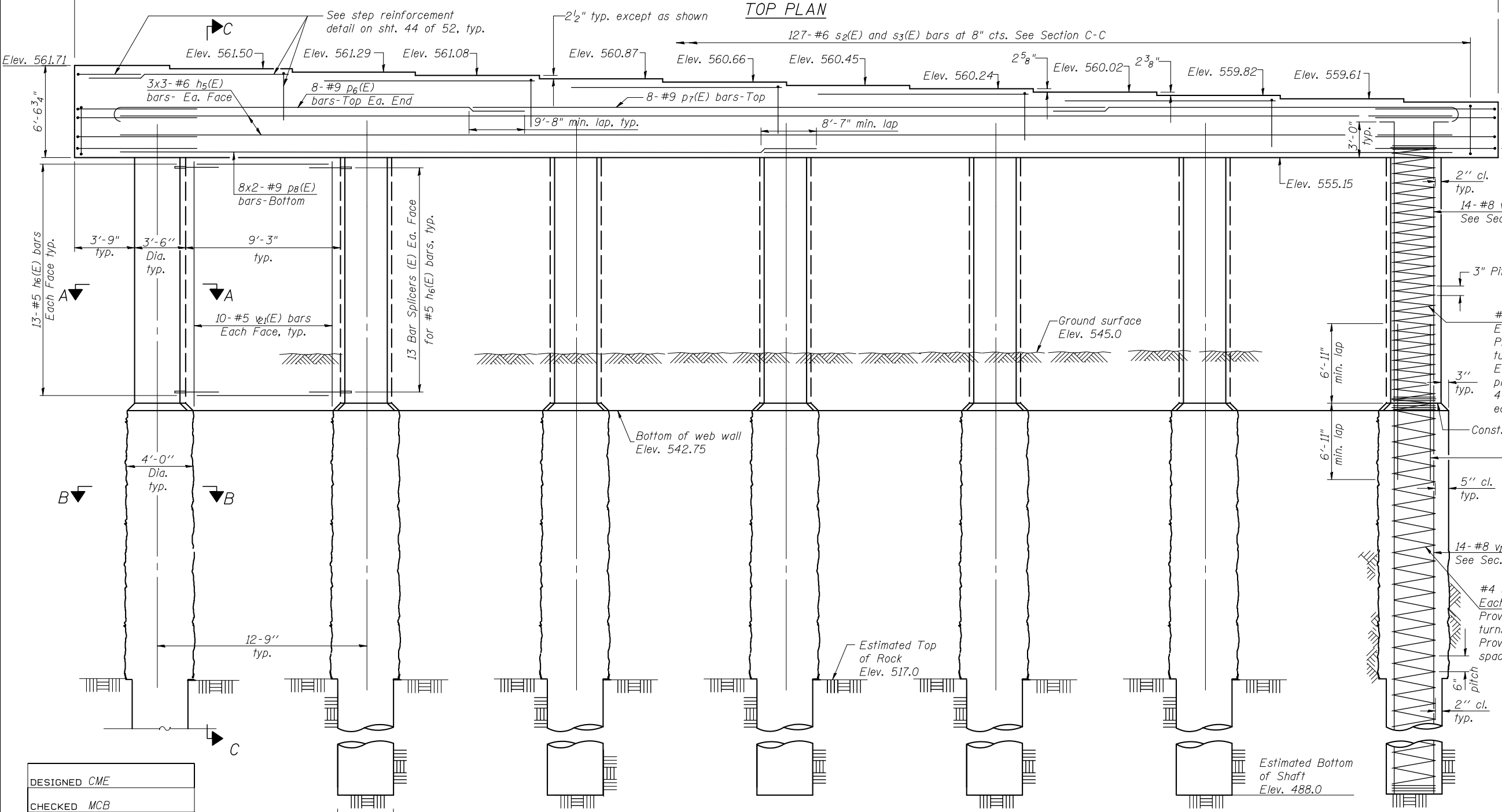

MIN BAR LAP
#6 bars = 4'-5"

DESIGNED	CME
CHECKED	MCB
DRAWN	TFG
CHECKED	MCB

ELEVATION
(Looking South)

COOMBE-BLOXDORF P.C.
Engineers / Land Surveyors
Springfield, Illinois
Design Firm License No. 184-002708

PIER 4
F.A.U. ROUTE 7706 - SECTION 23(B-1)
LOGAN COUNTY
STATION 99+46.00
STRUCTURE NO. 054-0512