

STATE OF ILLINOIS
DEPARTMENT OF TRANSPORTATION
DIVISION OF HIGHWAYS

**PROPOSED
HIGHWAY PLANS**

FAI ROUTE 55/70 (I-55/70)
SECTION 60-10RS-2
RESURFACING AND PATCHING
MADISON COUNTY

C-98-056-13

F.A.I. RTE.	SECTION	COUNTY	TOTAL SHEETS	SHEET NO.
55/70	60-10RS-2	MADISON	12	1
		ILLINOIS	CONTRACT NO. 76G54	

FOR INDEX OF SHEETS, SEE SHEET NO. 2

TRAFFIC DATA

F.A.I. 55/70

2011 ADT	=	36500 (ACTUAL)
2013 ADT	=	37200 (ESTIMATED)
2033 ADT	=	45400 (ESTIMATED)
SU	=	2.6%
MU	=	23.3%

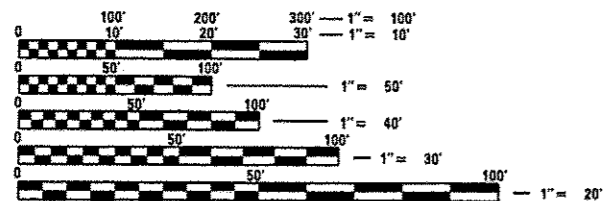
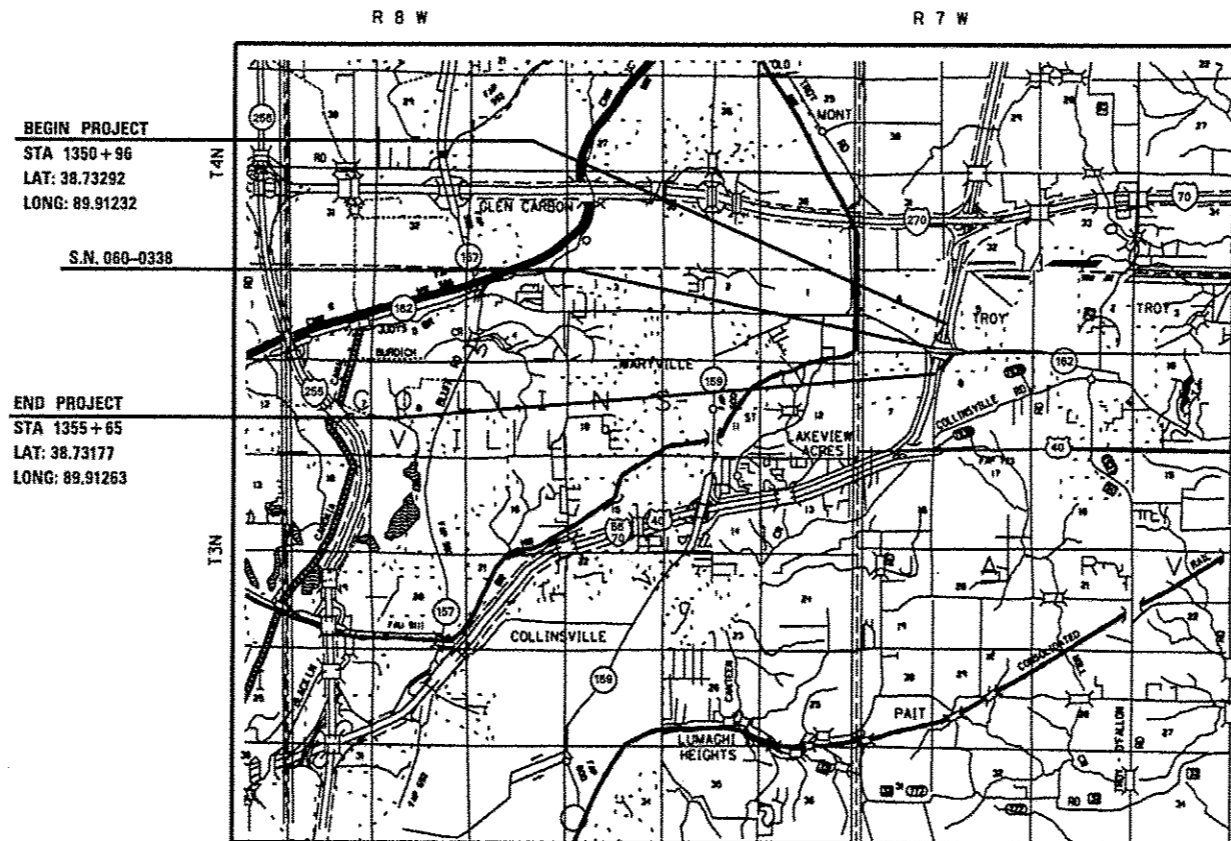
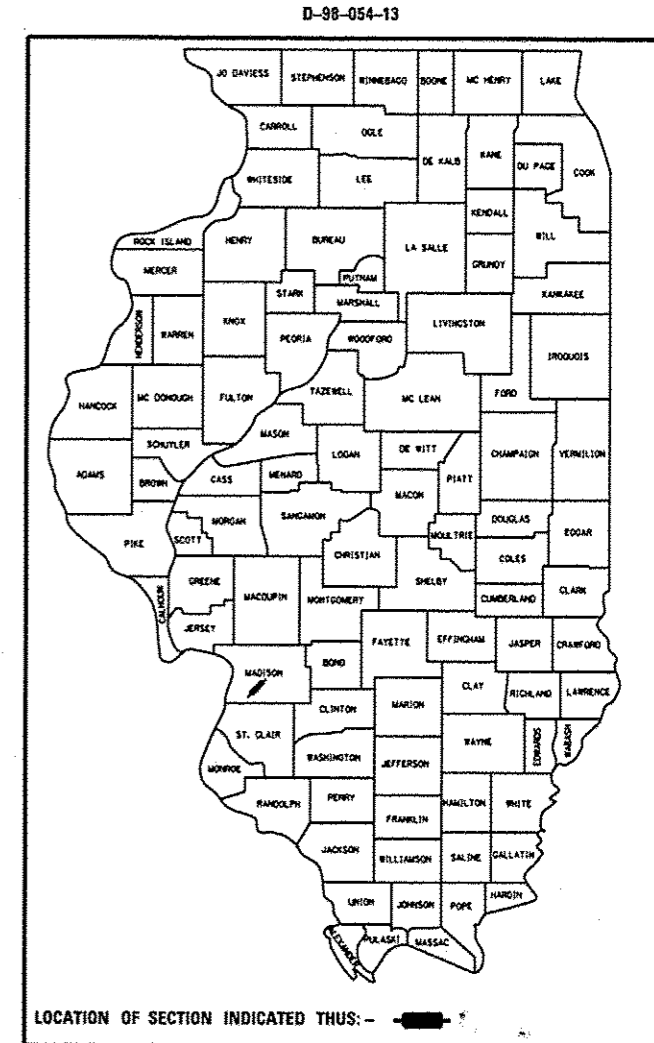

FULL SIZE PLANS HAVE BEEN PREPARED USING STANDARD ENGINEERING SCALES. REDUCED SIZED PLANS WILL NOT CONFORM TO STANDARD SCALES. IN MAKING MEASUREMENTS ON REDUCED PLANS, THE ABOVE SCALES MAY BE USED.

J.U.L.I.E.
JOINT UTILITY LOCATION INFORMATION FOR EXCAVATION
1-800-892-0123
OR 811

PROJECT ENGINEER: PATTI LeBEAU (618) 346-3179
PROJECT MANAGER: REBECCA THARP (618) 346-3323

CONTRACT NO. 76G54

DESIGN DESIGNATION
NA

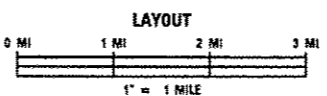

GROSS LENGTH = 469 FT. = 0.089 MILE
NET LENGTH = 469 FT. = 0.089 MILE

STATE OF ILLINOIS
DEPARTMENT OF TRANSPORTATION
DIVISION OF HIGHWAYS

SUBMITTED May 16 20 13
Clifford J. Ken
DEPUTY DIRECTOR OF HIGHWAYS, REGION 5 ENGINEER

June 28 20 13
John D. Baranelli, P.E.
ENGINEER OF DESIGN AND ENVIRONMENT

June 28 20 13
Omer Osman, P.E.
DIRECTOR OF HIGHWAYS, CHIEF ENGINEER

PRINTED BY THE AUTHORITY
OF THE STATE OF ILLINOIS

INDEX OF SHEETS

- 1 COVER SHEET
- 2 INDEX OF SHEETS, HIGHWAY STANDARDS, GENERAL NOTES & COMMITMENTS
- 3-4 SUMMARY OF QUANTITIES
- 5-6 TYPICAL SECTIONS
- 7-8 SCHEDULE OF QUANTITIES
- 9 PLAN SHEET
- 10 PAVEMENT MARKING SHEET
- 11-12 SEQUENCE OF CONSTRUCTION / MISCELLANEOUS DETAILS

HIGHWAY STANDARDS

- 000001-06 STANDARD SYMBOLS, ABBREVIATIONS AND PATTERNS
- 001006 DECIMAL OF AN INCH AND OF A FOOT
- 442201-03 CLASS C AND D PATCHES
- 642201-02 SHOULDER RUMBLE STRIPS, 16 IN.
- 601001-04 SUB-SURFACE DRAIN
- 601101-01 CONCRETE HEADWALL FOR PIPE DRAIN
- 701400-06 APPROACH TO LANE CLOSURE, FREEWAY/EXPRESSWAY
- 701401-07 LANE CLOSURE, FREEWAY/EXPRESSWAY
- 701411-08 LANE CLOSURE, MULTILANE, AT ENTRANCE OR EXIT RAMP, FOR SPEEDS ≥ 45 MPH
- 701426-05 LANE CLOSURE, MULTILANE, INTERMITTENT OR MOVING OPERATIONS FOR SPEEDS ≥ 45 MPH
- 701901-02 TRAFFIC CONTROL DEVICES
- 780001-03 TYPICAL PAVEMENT MARKINGS
- 781001-03 TYPICAL APPLICATIONS RAISED REFLECTIVE PAVEMENT MARKERS

COMMITMENTS

NONE

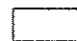
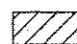
-  - LANE RESTRICTIONS PERMITTED
-  - NO LANE RESTRICTIONS PERMITTED

GENERAL NOTES

1. IT SHALL BE THE CONTRACTOR'S RESPONSIBILITY TO ENSURE THAT ADJACENT PAVEMENT & APPURTENANCES ARE NOT DAMAGED DURING ANY CONSTRUCTION OPERATION.
2. "ROAD CONSTRUCTION AHEAD" SIGNS SHALL BE PLACED AT EACH END OF THE PROJECT PLUS THE INTERSECTING SIDE ROADS AND INTERCHANGES, AND WILL BE CONSIDERED INCLUDED IN THE TRAFFIC CONTROL AND PROTECTION PAY ITEMS. ALL CONSTRUCTION SIGNS SHALL BE FLUORESCENT ORANGE IN COLOR (48" X 48").
3. ALL DISTURBED EMBANKMENT AREAS SHALL BE SEEDED WITH CLASS 2A SEED, FERTILIZED AND MULCHED AS PER SECTION 250 OF THE STANDARD SPECIFICATIONS AND AS DIRECTED BY THE ENGINEER. THE COST FOR PERFORMING THIS WORK SHALL BE CONSIDERED INCLUDED IN THE UNIT PRICE BID FOR THE ITEM OF WORK INITIATING THE DISTURBANCE.
4. THE THICKNESS OF THE HOT-MIX ASPHALT MIXTURE SHOWN ON THE PLANS IS THE NOMINAL THICKNESS. DEVIATIONS MAY OCCUR DUE TO IRREGULARITIES IN THE EXISTING SURFACE OR BASE ON WHICH THE HOT-MIX ASPHALT MIXTURE IS PLACED.
5. ILLINOIS STATE LAW REQUIRES A 48-HOUR NOTICE BE GIVEN TO ALL UTILITIES WITHIN THE PROJECT AREA BEFORE DIGGING. FIELD MARKING OF FACILITIES MAY BE OBTAINED BY CONTACTING J.U.L.I.E. OR FOR NON-MEMBERS, THE UTILITY COMPANY DIRECTLY. AGENCIES KNOWN TO HAVE FACILITIES WITHIN THE PROJECT AREA ARE AS FOLLOWS:
 - AT&T ILLINOIS
 - CHARTER COMMUNICATIONS, INC.
 - SOUTHWESTERN ELECTRIC COOPERATIVE, INC.
 - CITY OF TROY

MEMBERS OF J.U.L.I.E. CALL TOLL FREE (800) 892-0123 OR 811 AND ARE INDICATED BY *. NON-J.U.L.I.E. MEMBERS MUST BE NOTIFIED INDIVIDUALLY.
6. ANY EXCAVATION OR DROP-OFF OF MORE THAN 3" AT THE EDGE OF PAVEMENT SHALL BE PROTECTED WITH EXTENDED LEG BARRICADES AND APPROPRIATE LIGHTING.
7. THE RESIDENT ENGINEER SHALL VERIFY THE EXISTENCE OF HIGHWAY LIGHTING AND/OR ITS UTILITIES WITHIN THE PROJECT LIMITS. IF HIGHWAY LIGHTING AND/OR ITS EXISTS WITHIN THE PROJECT LIMITS, AND IF THESE ITEMS REQUIRE LOCATING, THE CONTRACTOR SHALL BE DIRECTED TO DO SO ACCORDING TO SECTION 803 OF THE STANDARD SPECIFICATIONS. IF 'LOCATING UNDERGROUND CABLE' IS NOT INCLUDED AS PART OF THE PLANS, THIS WORK SHALL BE PAID FOR ACCORDING TO ARTICLE 109.04 OF THE STANDARD SPECIFICATIONS.
8. THE CONTRACTOR AND THE ENGINEER SHALL BE AWARE THAT NO SURVEY WAS PERFORMED FOR THIS PROJECT. THE STATIONING AND TOPOGRAPHY SHOWN IN THE PLANS WAS CREATED USING MICROFILM AND FIELD MEASUREMENTS. BOTH SHALL BE ASSUMED TO BE APPROXIMATE. THE CONTRACTOR SHALL VERIFY DIMENSIONS AND CONDITIONS IN THE FIELD PRIOR TO CONSTRUCTION AND ORDERING OF MATERIALS.
9. FLAGGERS WILL BE REQUIRED AT ALL TIMES DURING PATCHING OPERATIONS.
10. THE DEPARTMENT STRONGLY ENCOURAGES THE PRIME CONTRACTOR AND THEIR APPROVED SUB-CONTRACTORS TO HIRE MINORITY, WOMEN AND DISADVANTAGED INDIVIDUALS FROM ITS FEDERALLY FUNDED HIGHWAY CONSTRUCTION CAREERS TRAINING PROGRAM (HCCTP) TO HELP MEET WORKFORCE AND TRAINEE GOALS. THIS PROGRAM IS TRAINING MINORITIES, WOMEN AND DISADVANTAGED INDIVIDUALS IN HIGHWAY CONSTRUCTION-RELATED SKILLS, E.G., MATH FOR THE TRADES, JOB READINESS, TECHNICAL SKILLS COURSEWORK (CARPENTRY, CONCRETE FLATWORK, BLUEPRINT READING, SITE PLANS, SITE WORK, TOOLS USE, ETC.) AND OSHA 10 HOUR CERTIFICATION, TO PREPARE THEM FOR A CAREER IN THE HIGHWAY CONSTRUCTION TRADES. GRADUATES ARE WELL-TRAINED AND READY TO BECOME PRODUCTIVE ENTRY-LEVEL CONSTRUCTION WORKERS. CONTACT THE DISTRICT 8 EEO OFFICE AT 618-346-3360 AND/OR THE HCCTP COORDINATOR AT 618-874-6528 TO LEARN MORE ABOUT THE PROGRAM AND FOR ASSISTANCE IN MEETING WORKFORCE AND TRAINEE GOALS.
11. THE FOLLOWING MIXTURE REQUIREMENTS ARE APPLICABLE FOR THIS PROJECT:

MIXTURE USE	POLY SURF SMA	POLY BINDER SMA	PATCHING	SHOULDERS ≥ 2.25"	SHOULDERS < 2.25"
AC/PG	SBS PG 76-22	SBS PG 76-22	SBS PG 76-22	PG 64-22	PG 64-22
DESIGN AIR VOIDS	4.0% @ Ndes=80	4.0% @ Ndes=80	4.0% @ Ndes=90	*2.0% @ Ndes=30	*2.0% @ Ndes=30
MIX COMPOSITION (GRADATION MIXTURE)			IL 19.0 FG	NMAS 3/4"	NMAS 1/2"
FRICITION AGGREGATE	SMA	SMA	MIXTURE "B"		

*TOP LIFT SHOULDERS - DESIGN THIS MIX AT 2.0% VOIDS AND ADD ASPHALT TO REDUCE VOIDS TO 1.5%.

PLAN QUANTITIES FOR BITUMINOUS CONCRETE SURFACE COURSE ITEMS ARE CALCULATED USING A UNIT WEIGHT OF 112 LB/SQ YD/IN.

12. SHORT TERM PAVEMENT MARKING SHALL BE PLACED ON THE PRIMED, BINDER, AND SURFACE LAYERS. ONLY REMOVAL FROM THE FINAL SURFACE SHALL BE PAID FOR AS "WORK ZONE PAVEMENT MARKING REMOVAL".
13. CONCRETE SAW SHALL BE USED TO SCORE THE PAVEMENT FULL DEPTH TO SEVER ALL REINFORCEMENT. THE CONTRACTOR SHALL NOT HAVE THE OPTION TO SUBSTITUTE A WHEEL SAW TO ESTABLISH THE PATCH LIMITS.

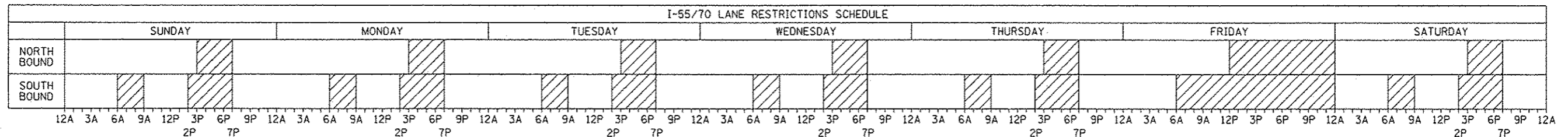

FILE NAME *	USER NAME * keypa	DESIGNED -	REVISED -	STATE OF ILLINOIS DEPARTMENT OF TRANSPORTATION	INDEX OF SHEETS, HIGHWAY STANDARDS, GENERAL NOTES & COMMITMENTS			F.A.I. RTE.	SECTION	COUNTY	TOTAL SHEETS	SHEET NO.
os:\pwwork\pwwork\keypa\0834866B\0870054\shh-gannote.dgn	DRAWN -	REVISED -	55/70					60-10RS-2	MADISON	12	2	
PLOT SCALE * 1/8"=1'-0" / 1/4"=1'-0"	CHECKED -	REVISED -	SCALE: N/A			SHEET NO. 1 OF 1 SHEETS	STA.	TO STA.	CONTRACT NO. 76654			
PLOT DATE * 5/17/2013	DATE -	REVISED -	ILLINOIS FED. AID PROJECT									

CODE NO.	ITEM	UNIT	URBAN TOTAL QUANTITY	CONSTR. CODE
				100% STATE
				ROADWAY 0005
20200100	EARTH EXCAVATION	CU YD	115	115
40600200	BITUMINOUS MATERIALS (PRIME COAT)	TON	0.5	0.5
40600300	AGGREGATE (PRIME COAT)	TON	3	3
40600990	TEMPORARY RAMP	SQ YD	243	243
40603148	POLYMERIZED HOT-MIX ASPHALT BINDER COURSE, STONE MATRIX ASPHALT, N80	TON	252.4	252.4
40603153	POLYMERIZED HOT-MIX ASPHALT SURFACE COURSE, STONE MATRIX ASPHALT, N80	TON	316.9	316.9
44004250	PAVED SHOULDER REMOVAL	SQ YD	672	672
44201827	CLASS D PATCHES, TYPE II, 15 INCH	SQ YD	54	54
44201831	CLASS D PATCHES, TYPE III, 15 INCH	SQ YD	75	75
48101200	AGGREGATE SHOULDERS, TYPE B	TON	94	94
48203057	HOT-MIX ASPHALT SHOULDERS, 15"	SQ YD	939	939
48203100	HOT-MIX ASPHALT SHOULDERS	TON	377	377
60100060	CONCRETE HEADWALLS FOR PIPE DRAINS	EACH	8	8
60100072	SHOULDER REMOVAL AND REPLACEMENT 5"	FOOT	989	989
60107600	PIPE UNDERDRAINS 4"	FOOT	1978	1978
60108100	PIPE UNDERDRAINS 4" (SPECIAL)	FOOT	186	186
64200116	SHOULDER RUMBLE STRIPS, 16 INCH	FOOT	1978	1978

FILE NAME =	USER NAME = keyps	DESIGNED -	REVISED -
c:\pwork\pwork\keyps\d0348068\d076g	4-shr-plan.dgn	DRAWN -	REVISED -
PLOT SCALE = 180.0000' / 1"	CHECKED -	REVISED -	REVISED -
PLOT DATE = 5/17/2013	DATE -	REVISED -	REVISED -

**STATE OF ILLINOIS
DEPARTMENT OF TRANSPORTATION**

SUMMARY OF QUANTITIES

SCALE: N/A SHEET NO. 1 OF 2 SHEETS STA. TO STA.

F.A.I. RTE.	SECTION	COUNTY	TOTAL SHEETS	SHEET NO.
55/70	60-10RS-2	MADISON	12	3
FED. ROAD DIST. NO. ILLINOIS FED. AID PROJECT			CONTRACT NO. 76054	

CODE NO.	ITEM	UNIT	URBAN TOTAL QUANTITY	CONSTR. CODE
				100% STATE
				ROADWAY 0005
67100100	MOBILIZATION	L SUM	1	1
70100420	TRAFFIC CONTROL AND PROTECTION, STANDARD 701411	EACH	2	2
70100800	TRAFFIC CONTROL AND PROTECTION, STANDARD 701401	L SUM	1	1
70103815	TRAFFIC CONTROL SURVEILLANCE	CAL DA	79	79
70200100	NIGHTTIME WORK ZONE LIGHTING	L SUM	1	1
* 70300100	SHORT TERM PAVEMENT MARKING	FOOT	576	576
* 70300240	TEMPORARY PAVEMENT MARKING - LINE 6"	FOOT	2238	2238
70301000	WORK ZONE PAVEMENT MARKING REMOVAL	SQ FT	1311	1311
* 78000100	THERMOPLASTIC PAVEMENT MARKING - LETTERS AND SYMBOLS	SQ FT	16	16
* 78000400	THERMOPLASTIC PAVEMENT MARKING - LINE 6"	FOOT	2238	2238
* 78100100	RAISED REFLECTIVE PAVEMENT MARKER	EACH	32	32
78300200	RAISED REFLECTIVE PAVEMENT MARKER REMOVAL	EACH	32	32
X0323583	SPEED INDICATOR SIGN	CAL DA	79	79
X4401198	HOT-MIX ASPHALT SURFACE REMOVAL, VARIABLE DEPTH	SQ YD	729	729

14

***SPECIALTY ITEM**

FILE NAME =	USER NAME = thorp1	DESIGNED -	REVISED -	STATE OF ILLINOIS DEPARTMENT OF TRANSPORTATION	SUMMARY OF QUANTITIES			F.A.I. RTE.	SECTION	COUNTY	TOTAL SHEETS	SHEET NO.
oi\pv_work\pvidot\thorp1\0340060\0876	54*ah1-plan.dgn	DRAWN -	REVISED -					55/70	60-10RS-2	HAOJSON	12	4
PLOT SCALE = 100.0000' / in.	CHECKED -	REVISED -	REVISED -		SCALE: N/A			SHEET NO. 2 OF 2 SHEETS		STA. _____ TO STA. _____	CONTRACT NO. 76G54	
PLOT DATE = 5/17/2013	DATE -	REVISED -	REVISED -		FED. ROAD DIST. NO. - ILLINOIS FED. AID PROJECT							

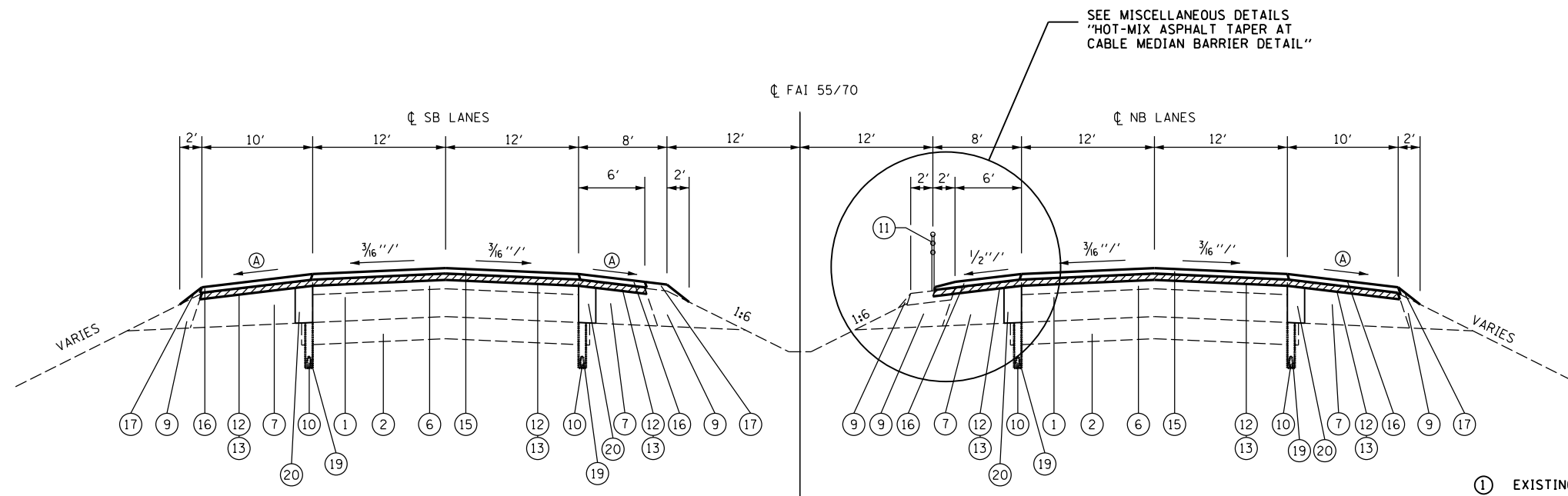

TYPICAL SECTION

Ⓐ SHOULDER SLOPE
RANGE FROM 1/4''/1' TO 3/4''/1'
DESIRABLE 1/2''/1'

STA 1350+60 TO STA 1350+96 NB LANES
STA 1355+24 TO STA 1355+60 NB LANES
STA 1350+87 TO STA 1351+23 SB LANES
STA 1355+40 TO STA 1355+76 SB LANES

▨ = PROPOSED HOT-MIX ASPHALT SURFACE REMOVAL, VARIABLE DEPTH

LEGEND

- ① EXISTING P.C.C. PAVEMENT 10"
- ② EXISTING SUB-BASE GRANULAR MATERIAL, TYPE A 8"
- ③ EXISTING CLASS A CONCRETE PATCH, 15"
- ④ EXISTING AGGREGATE BASE COURSE, TYPE B 12"
- ⑤ EXISTING CLASS B CONCRETE PATCH, 15"
- ⑥ EXISTING HOT-MIX ASPHALT OVERLAY, ±6 3/4 "
- ⑦ EXISTING BITUMINOUS SHOULDERS 14"
- ⑧ EXISTING BITUMINOUS SHOULDERS 8"
- ⑨ EXISTING AGGREGATE SHOULDER TYPE B
- ⑩ EXISTING PIPE UNDERDRAINS, 4"
- ⑪ EXISTING HIGH TENSION CABLE MEDIAN BARRIER & HOT-MIX ASPHALT SHOULDER, 4" (4' WIDE)
- ⑫ PROPOSED BITUMINOUS MATERIALS (PRIME COAT)
- ⑬ PROPOSED AGGREGATE (PRIME COAT)
- ⑭ PROPOSED POLYMERIZED HOT-MIX ASPHALT BINDER COURSE, STONE MATRIX ASPHALT, N 80, 2"
- ⑮ PROPOSED POLYMERIZED HOT-MIX ASPHALT SURFACE COURSE, STONE MATRIX ASPHALT, N 80, 2"
- ⑯ PROPOSED HOT-MIX ASPHALT SHOULDERS, 4"
- ⑰ PROPOSED AGGREGATE SHOULDERS TYPE B
- ⑱ PROPOSED CLASS D PATCH, 15"
- ⑲ PROPOSED PIPE UNDERDRAIN 4"
- ⑳ PROPOSED SHOULDER REMOVAL AND REPLACEMENT, 5"
- ㉑ PROPOSED HOT-MIX ASPHALT SHOULDERS, 15"

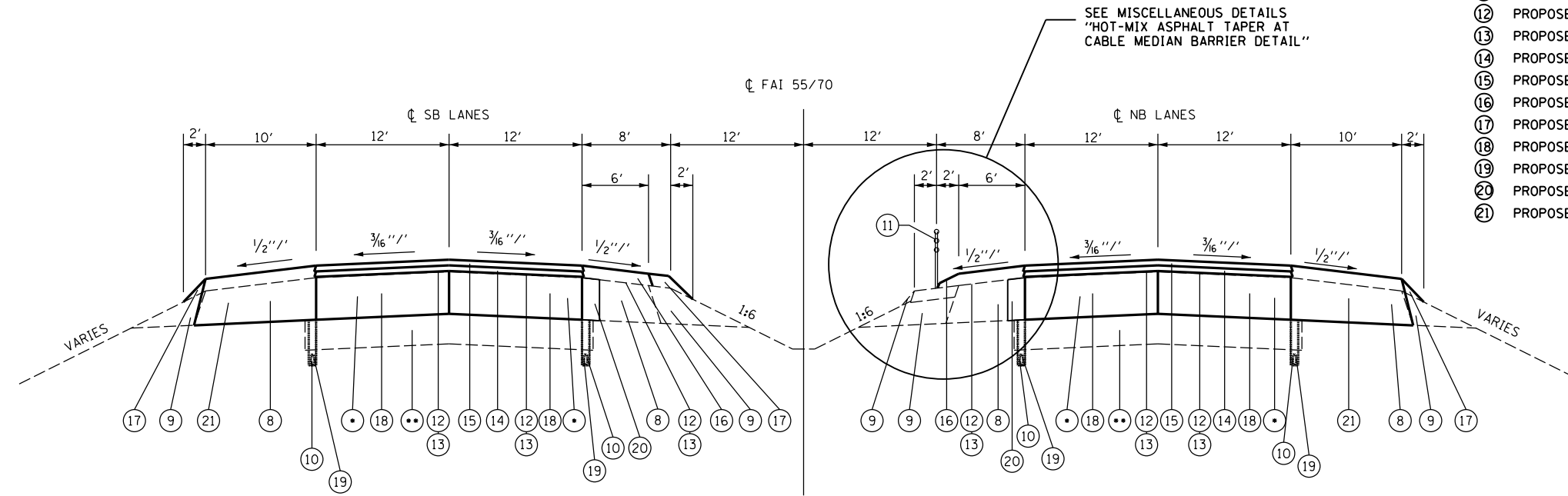

TYPICAL SECTION

• = 5 OR 1 (TO BE REMOVED)
** = 4 OR 2 OR EXISTING CONCRETE FOOTING
(TO REMAIN IN PLACE) - SEE MISCELLANEOUS
DETAIL "PATCHING DETAIL"

STA 1350+96 TO STA 1351+12 NB LANES
STA 1355+12 TO STA 1355+24 NB LANES
STA 1351+23 TO STA 1351+33 SB LANES
STA 1355+30 TO STA 1355+40 SB LANES

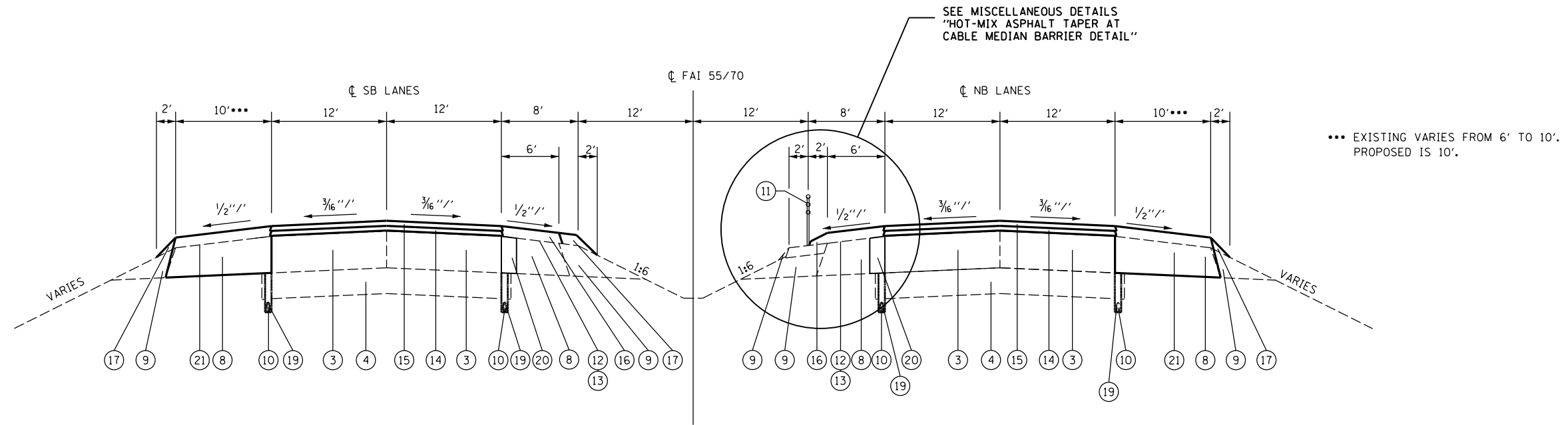

TYPICAL SECTION

STA 1351+12 TO STA 1355+12 NB LANES
STA 1351+33 TO STA 1355+30 SB LANES

LEGEND

- ① EXISTING P.C.C. PAVEMENT 10"
- ② EXISTING SUB-BASE GRANULAR MATERIAL, TYPE A 8"
- ③ EXISTING CLASS A CONCRETE PATCH, 15"
- ④ EXISTING AGGREGATE BASE COURSE, TYPE B 12"
- ⑤ EXISTING CLASS B CONCRETE PATCH, 15"
- ⑥ EXISTING HOT-MIX ASPHALT OVERLAY, ±6 3/4 "
- ⑦ EXISTING BITUMINOUS SHOULDERS 14"
- ⑧ EXISTING BITUMINOUS SHOULDERS 8"
- ⑨ EXISTING AGGREGATE SHOULDER TYPE B
- ⑩ EXISTING PIPE UNDERDRAINS, 4"
- ⑪ EXISTING HIGH TENSION CABLE MEDIAN BARRIER & HOT-MIX ASPHALT SHOULDER, 4" (4' WIDE)
- ⑫ PROPOSED BITUMINOUS MATERIALS (PRIME COAT)
- ⑬ PROPOSED AGGREGATE (PRIME COAT)
- ⑭ PROPOSED POLYMERIZED HOT-MIX ASPHALT BINDER COURSE, STONE MATRIX ASPHALT, N 80, 2"
- ⑮ PROPOSED POLYMERIZED HOT-MIX ASPHALT SURFACE COURSE, STONE MATRIX ASPHALT, N 80, 2"
- ⑯ PROPOSED HOT-MIX ASPHALT SHOULDERS, 4"
- ⑰ PROPOSED AGGREGATE SHOULDERS TYPE B
- ⑱ PROPOSED CLASS D PATCH, 15"
- ⑲ PROPOSED PIPE UNDERDRAIN 4"
- ⑳ PROPOSED SHOULDER REMOVAL AND REPLACEMENT, 5"
- ㉑ PROPOSED HOT-MIX ASPHALT SHOULDERS, 15"

FILE NAME =	USER NAME = tharp1	DESIGNED - _____	REVISED - _____	STATE OF ILLINOIS DEPARTMENT OF TRANSPORTATION	TYPICAL SECTIONS			F.A.I. RTE.	SECTION	COUNTY	TOTAL SHEETS	SHEET NO.
et:\pw_work\p1dot\tharp1\0340868\087654-sht-typical.dgn		DRAWN - _____	REVISED - _____		55/70	60-10RS-2	MADISON	12	6			
MODELNAME	PLOT SCALE = 40.0000' / in.	CHECKED - _____	REVISED - _____		SCALE: N/A	SHEET 2	OF 2 SHEETS	STA. _____	TO STA. _____	CONTRACT NO. 76054		
	PLOT DATE = 5/29/2013	DATE - _____	REVISED - _____		ILLINOIS FED. AID PROJECT							

PAVEMENT MARKING SCHEDULE															
LOCATION				THERMOPLASTIC PAVEMENT MARKING - LINE 6"			LETTERS & SYMBOLS (SQ FT.)	TEMPORARY PAVEMENT MARKING - LINE 6"			SHORT TERM PAVEMENT MARKING		RAISED REFLECTIVE PAVEMENT MARKERS		WORK ZONE PAVEMENT MARKING REMOVAL (SQ FT.)
STATION	TO	STATION	LANES	WHITE SKIP DASH (FT.)	SOLID YELLOW (FT.)	SOLID WHITE (FT.)		WHITE SKIP DASH (FT.)	SOLID YELLOW (FT.)	SOLID WHITE (FT.)	WHITE SKIP DASHES (FT.)	EDGE LINE (FT.)	REMOVAL (EA.)	PLACED (EA.)	
1350+60.00	TO	1355+60.00	NB	130	500	500	4	130	500	500	144	144	16	16	661
1350+87.00	TO	1355+76.00	SB	130	489	489	4	130	489	489	144	144	16	16	650
SUBTOTAL				260	989	989	8	260	989	989	288	288	32	32	1311
TOTAL				2238			8	2238			576		32	32	1311

PIPE DRAINS SCHEDULE								
LOCATION					SHOULDER REMOVAL AND REPLACEMENT 5"	CONCRETE HEADWALLS FOR PIPE DRAINS	PIPE UNDERDRAINS, 4"	PIPE UNDERDRAINS, 4" (SPECIAL)
STATION	TO	STATION	LANES	LT/RT	FOOT	EACH	FOOT	FOOT
1350+60.00	TO	1355+60.00	NB	LT	500.00		500	
1350+60.00	TO	1355+60.00	NB	RT			500	
1350+87.00	TO	1355+76.00	SB	LT	489.00		489	
1350+87.00	TO	1355+76.00	SB	RT			489	
1351+42.00			NB	RT		2		30
1354+77.00			NB	RT		2		60
1351+73.00			SB	LT		2		36
1355+00.00			SB	LT		2		60
TOTAL					989	8	1978	186

TEMPORARY RAMP SCHEDULE						
STATION	TO	STATION	LENGTH (FT.)	LANE	WIDTH (FT.)	AREA (SQYD.)
1350+60.00	TO	1350+66.67	6.7	NB	42	31.13
1355+53.33	TO	1355+60.00	6.7	NB	42	31.13
1350+89.33	TO	1350+96.00	6.7	NB	42	31.13
1355+24.00	TO	1355+30.67	6.7	NB	42	31.13
1350+87.00	TO	1350+93.67	6.7	SB	40	29.64
1355+69.33	TO	1355+76.00	6.7	SB	40	29.64
1351+16.33	TO	1351+23.00	6.7	SB	40	29.64
1355+40.00	TO	1355+46.67	6.7	SB	40	29.64
SUBTOTAL						243.08
TOTAL						243

NOTE: LEFT/RIGHT (LT/RT) IS DEFINED LOOKING UPSTATION.

RESURFACING SCHEDULE

LOCATION	LENGTH	BITUMINOUS MATERIALS (PRIME COAT)			AGGREGATE (PRIME COAT)			POLYMERIZED HOT-MIX ASPHALT SURFACE COURSE, STONE MATRIX ASPHALT, N80	POLYMERIZED HOT-MIX ASPHALT BINDER COURSE, STONE MATRIX ASPHALT, N80	SHOULDER RUMBLE STRIPS, 16 INCH	AGGREGATE SHOULDER, TYPE B		HOT-MIX ASPHALT SHOULDERS		HOT-MIX ASPHALT SHOULDERS, 15"		PAVED SHOULDER REMOVAL		EARTH EXCAVATION						
		STATION TO STATION	LANE	LEFT SHLD	MAIN	RIGHT SHLD	LEFT SHLD				MAIN	RIGHT SHLD	TON	TON	FOOT	LEFT	RIGHT	LEFT	RIGHT	LEFT	RIGHT	LEFT	RIGHT	LEFT	RIGHT
				TON	TON	TON	TON				TON	TON				TON	TON	TON	TON	SO YD	SO YD	SO YD	SO YD	CU YD	CU YD
1350+60 TO 1350+96	NB	36.0	0.01	0.03	0.01	0.05	0.14	0.06	16.13		72	1.33	4.35	6.72											
1350+96 TO 1351+12	NB	16.0	0.00	0.01		0.02	0.06		4.78	4.78	32	0.79	2.27			17.8	17.8								
1351+12 TO 1352+00	NB	88.0	0.02			0.12			26.28	26.28	176	4.35	12.48			97.8	97.8								
1352+00 TO 1355+00	NB	300.0	0.08			0.40			89.60	89.60	600	14.81	42.56			333.3	200.0			55.6					
1355+00 TO 1355+12	NB	12.0	0.00			0.02			3.58	3.58	24	0.59	1.70			13.3	13.3								
1355+12 TO 1355+24	NB	12.0	0.00	0.01		0.02	0.05		3.58	3.58	24	0.59	1.70			13.3	13.3								
1355+24 TO 1355+60	NB	36.0	0.01	0.03	0.01	0.05	0.14	0.06	16.13		72	1.33	4.35	6.72											
1350+87 TO 1351+23	SB	36.0	0.01	0.03	0.01	0.06	0.14	0.04	16.13		72	1.33	2.67	6.72	4.03										
1351+23 TO 1351+33	SB	10.0		0.01	0.00		0.04	0.01	2.99	2.99	20	0.49	0.99		1.49	11.1	11.1								
1351+33 TO 1351+50	SB	17.0			0.00			0.02	5.08	5.08	34	0.84	1.68		2.54	18.9	18.9								
1351+50 TO 1354+50	SB	300.0			0.06			0.30	89.60	89.60	600	14.81	29.63		44.80	333.3	200.0			55.6					
1354+50 TO 1355+30	SB	80.0			0.02			0.08	23.89	23.89	160	3.95	7.90		11.95	88.9	88.9								
1355+30 TO 1355+40	SB	10.0		0.01	0.00		0.04	0.01	2.99	2.99	20	0.49	0.99		1.49	11.1	11.1								
1355+40 TO 1355+76	SB	36.0	0.01	0.03	0.01	0.06	0.14	0.04	16.13		72	1.33	2.67	6.72	4.03										
SUBTOTAL				0.16	0.16	0.13	0.79	0.77	0.61	316.89	252.37	1978	23.26	70.31	82.87	83.78	463.3	475.6	330.0	342.2	55.6	55.6			
TOTAL				0.5			3			316.9	252.4	1978	94		167		939		672		115				

NOTE: LEFT/RIGHT (LT/RT) IS DEFINED LOOKING UPSTATION.

HMA SURFACE REMOVAL, VARIABLE DEPTH

STATION TO STATION	LANE	LENGTH (FT.)	WIDTH (FT.)	AREA (SQ YD.)
1350+60.00 TO 1351+00.00	NB	40.0	42	186.7
1350+87.00 TO 1351+27.00	SB	40.0	40	177.8
1355+20.00 TO 1355+60.00	NB	40.0	42	186.7
1355+36.00 TO 1355+76.00	SB	40.0	40	177.8
SUBTOTAL				728.9
TOTAL				729

PATCHING SCHEDULE

LOCATION				LANES				AREA (SQ YD.)	CLASS D, TYPE II, 15" (SQ YD.)	CLASS D, TYPE II, 15" (SQ YD.)
STATION TO STATION	DISTANCE (FT.)	NB	SB	WIDTH (FT.)	DEPTH (FT.)					
1350+96.00 TO 1351+12.00	16.0	2		12	0.17	21.33		42.67		
1355+12.00 TO 1355+24.00	12.0	2		12	0.17	16.00		32.00		
1351+23.00 TO 1351+33.00	10.0		2	12	0.17	13.33	26.67			
1355+30.00 TO 1355+40.00	10.0		2	12	0.17	13.33	26.67			
SUBTOTAL								53.33	74.67	
TOTAL								54	75	

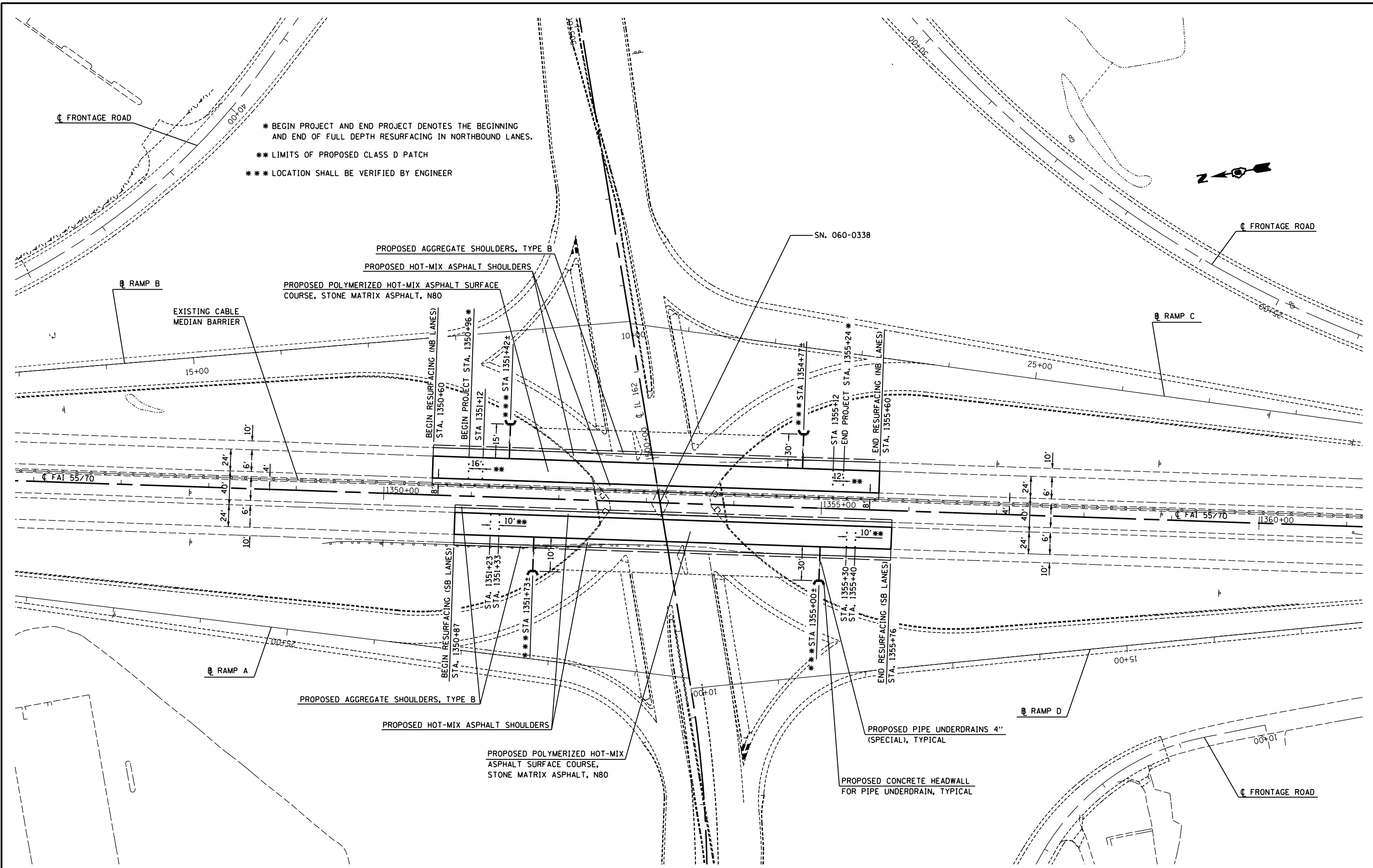

FILE NAME =	USER NAME = thorp1	DESIGNED -	REVISED -	STATE OF ILLINOIS DEPARTMENT OF TRANSPORTATION	PLAN SHEET		F.A.I. RTE.	SECTION	COUNTY	TOTAL SHEETS	SHEET NO.	
ce:\pw\work\p1dot\thorp1\d0340868\087654-sht-pln1.dgn		DRAWN -	REVISED -		SCALE: N/A	SHEET 1 OF 1 SHEETS	STA. 1345+75 TO STA. 1361+25	55/70	60-10RS-2	MADISON	12	9
MODELNAME	PLOT SCALE = 100.0000' / in.	CHECKED -	REVISED -		CONTRACT NO. 76054							
	PLOT DATE = 5/29/2013	DATE -	REVISED -		ILLINOIS FED. AID PROJECT							

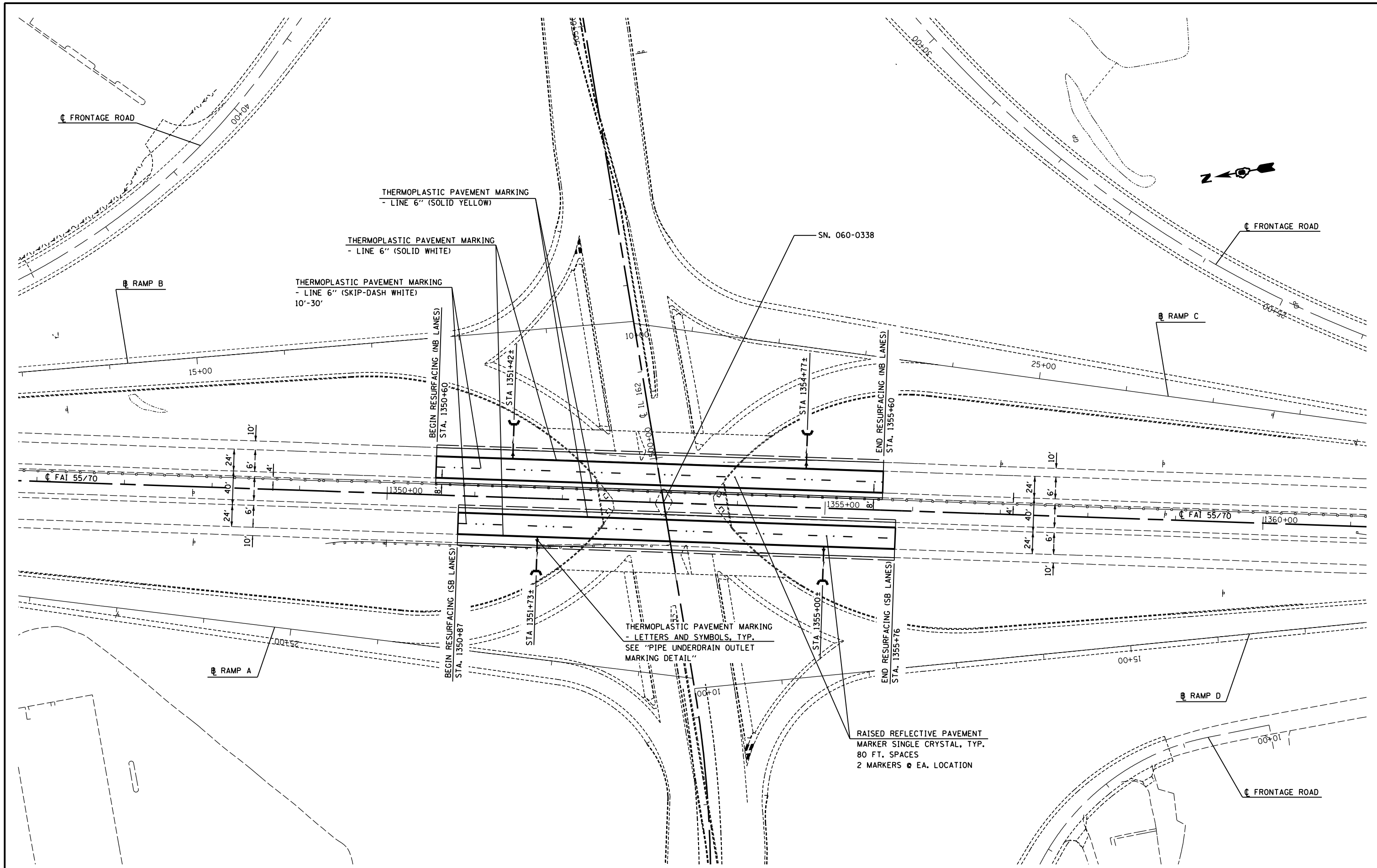

FILE NAME =	USER NAME = thorp1	DESIGNED -	REVISED -
e:\pw_work\p1dot\thorp1\d0340868\087654-sht-pmk.dgn		DRAWN -	REVISED -
MODELNAME	PLOT SCALE = 100.0000' / 1in.	CHECKED -	REVISED -
	PLOT DATE = 5/29/2013	DATE -	REVISED -

**STATE OF ILLINOIS
DEPARTMENT OF TRANSPORTATION**

PAVEMENT MARKING SHEET			
SCALE: N/A	SHEET 1 OF 1 SHEETS	STA. 1345+75	TO STA. 1361+25

F.A.I. RTE.	SECTION	COUNTY	TOTAL SHEETS	SHEET NO.
55/70	60-10RS-2	MADISON	12	10
CONTRACT NO. 76054				
ILLINOIS FED. AID PROJECT				

SUGGESTED SEQUENCE OF CONSTRUCTION

REMOVE EXISTING PAVEMENT AND PLACE CLASS D PATCHES AS DETAILED IN THE PLANS, SPECS, AND SPECIAL PROVISIONS.

REMOVE EXTERIOR SHOULDER, PLACE PIPE UNDERDRAINS, PIPE UNDERDRAINS (SPECIAL), AND PLACE FULL DEPTH HMA SHOULDERS AS DETAILED IN THE PLANS AND SPECS.

PERFORM SHOULDER REMOVAL AND REPLACEMENT ON THE INTERIOR SHOULDERS AND PLACE PIPE UNDERDRAINS IN EXISTING SHOULDERS AS DETAILED IN THE PLANS AND SPECS.

PLACE POLYMERIZED HMA BINDER COURSE SMA 2" AS DETAILED IN THE PLANS. PLACE TEMPORARY RAMP TO ALLOW TRAFFIC TO DRIVE ON THE HMA BINDER COURSE SMA 2".

SAWCUT AND REMOVE HOT-MIX ASPHALT SURFACE REMOVAL, VARIABLE DEPTH AS DETAILED IN THE PLANS. PLACE TEMPORARY RAMP AT THE HMA SURFACE REMOVAL, VARIABLE DEPTH LOCATION.

REMOVE TEMPORARY RAMPS AND PLACE HMA SURFACE COURSE, SMA 2" AS DETAILED IN THE PLANS.

PLACE HMA SHOULDER OVERLAY AND/OR FINAL LIFT OF HMA SHOULDER AND AGGREGATE SHOULDERS AS DETAILED IN THE PLANS.

TRAFFIC CONTROL FOR THE ABOVE ITEMS SHALL BE DONE IN ACCORDANCE WITH TRAFFIC CONTROL AND PROTECTION, STANDARDS 701400, 701401, AND 701411.

APPLY PAVEMENT MARKINGS UTILIZING TRAFFIC CONTROL AND PROTECTION, STANDARD 701426.

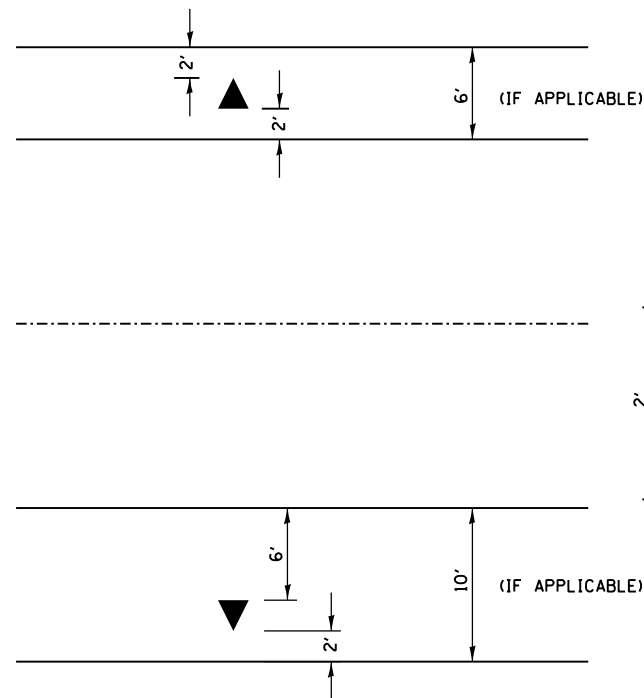

PIPE UNDERDRAIN OUTLET MARKING DETAIL

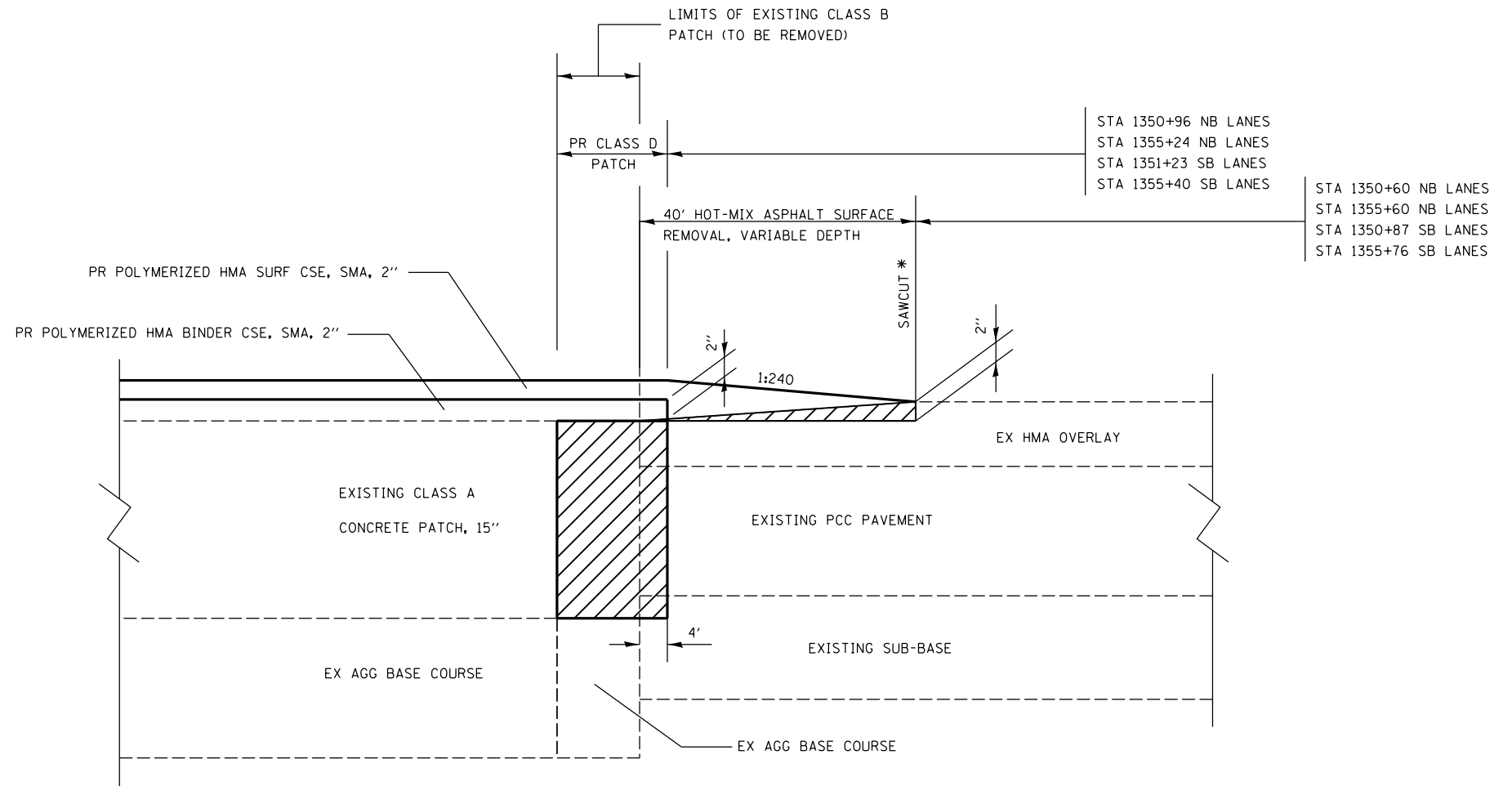
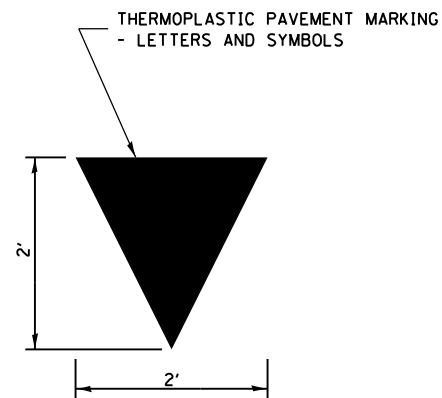

TIE-IN DETAIL

* COST OF SAWCUT TO BE INCLUDED IN HOT-MIX ASPHALT SURFACE REMOVAL, VARIABLE DEPTH

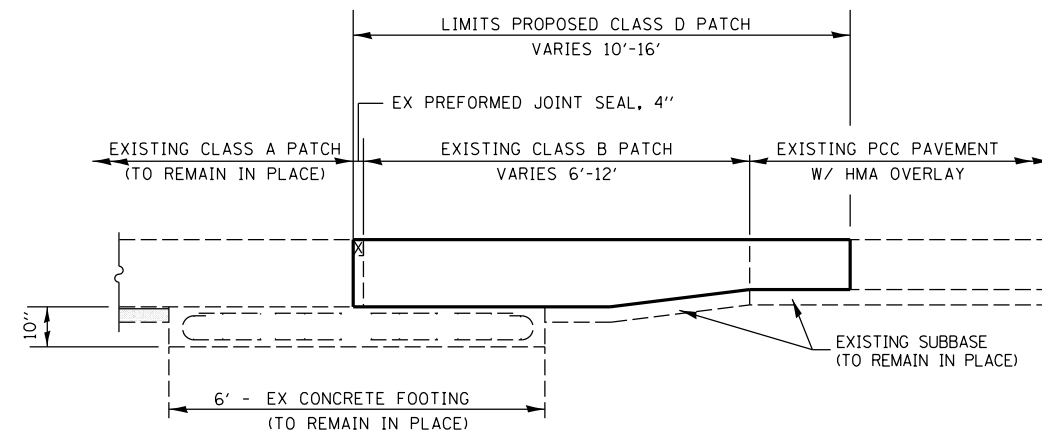

PATCHING DETAIL

FILE NAME =	USER NAME = thorp1	DESIGNED -	REVISED -
es:\pw\work\p1dot\thorp1\10340868\107654-sht-details.dgn		DRAWN -	REVISED -
PLOT SCALE = 100.0000' / 1in.		CHECKED -	REVISED -
PLOT DATE = 5/29/2013		DATE -	REVISED -

**STATE OF ILLINOIS
DEPARTMENT OF TRANSPORTATION**

SEQUENCE OF CONSTRUCTION / MISCELLANEOUS DETAILS

SCALE: N/A SHEET NO. 1 OF 1 SHEETS STA. _____ TO STA. _____

F.A.I. RTE.	SECTION	COUNTY	TOTAL SHEETS	SHEET NO.
55/70	60-10RS-2	MADISON	12	11
CONTRACT NO. 76054				
FED. ROAD DIST. NO. - ILLINOIS FED. AID PROJECT				

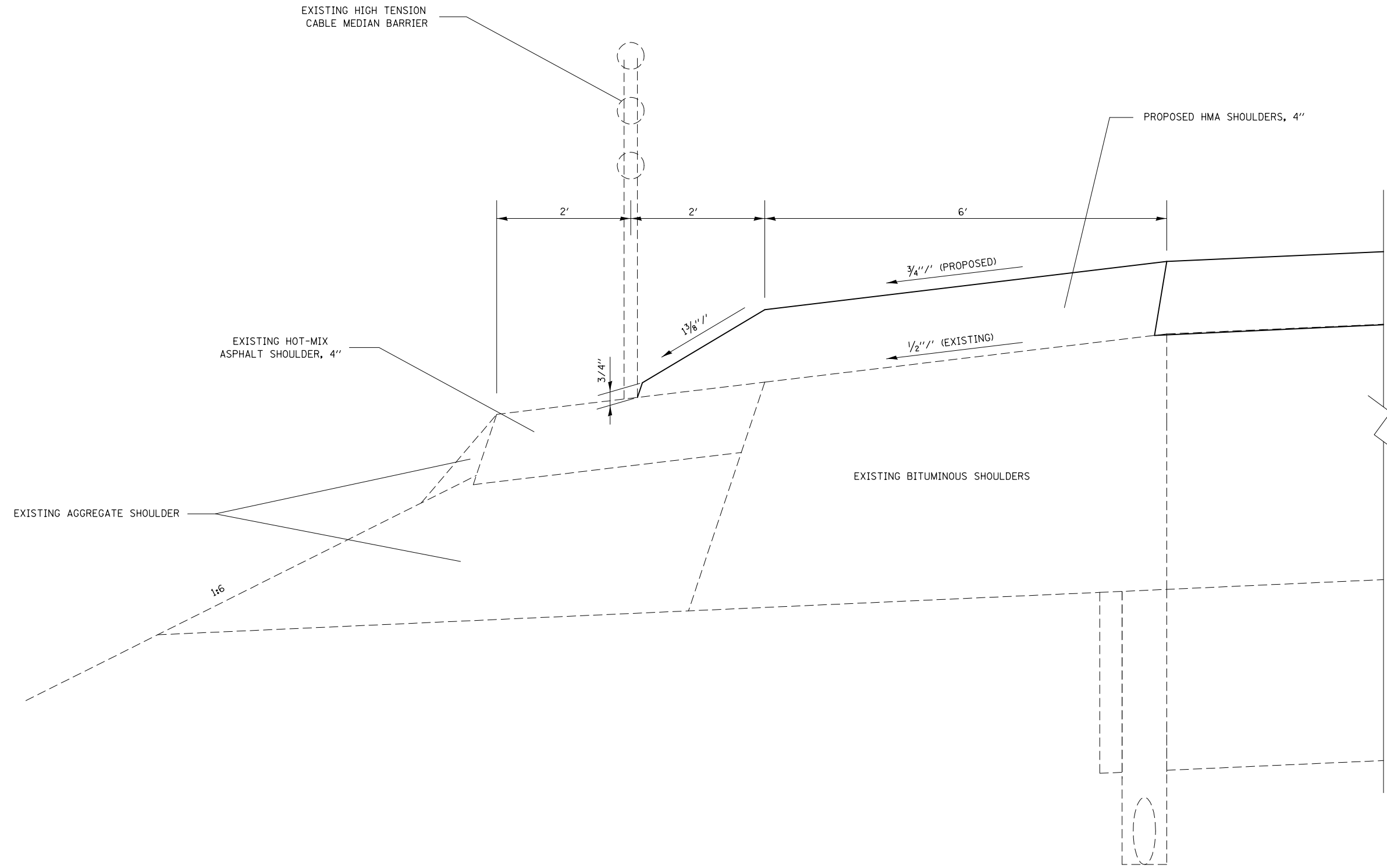

HOT-MIX ASPHALT TAPER AT CABLE MEDIAN BARRIER DETAIL

LOOKING NORTH

FILE NAME =	USER NAME = keyps	DESIGNED -	REVISED -
et:\pwork\pwork\keyps\d0340868\d876g54-sh-t-details.dgn		DRAWN -	REVISED -
	PLOT SCALE = 100.0000' / 1in.	CHECKED -	REVISED -
	PLOT DATE = 5/17/2013	DATE -	REVISED -

**STATE OF ILLINOIS
DEPARTMENT OF TRANSPORTATION**

MISCELLANEOUS DETAILS

SCALE: N/A SHEET NO. 2 OF 2 SHEETS STA. TO STA.

F.A.I. RTE.	SECTION	COUNTY	TOTAL SHEETS	SHEET NO.
55/70	60-10RS-2	MADISON	12	12
FED. ROAD DIST. NO. ILLINOIS FED. AID PROJECT			CONTRACT NO. 76G54	