

(B) (C) STA 3+25
 67' LT
 (A) (A) 6 SIGN PANELS - TYPE 1
 (M) (L) 2 METAL POSTS - TYPE B

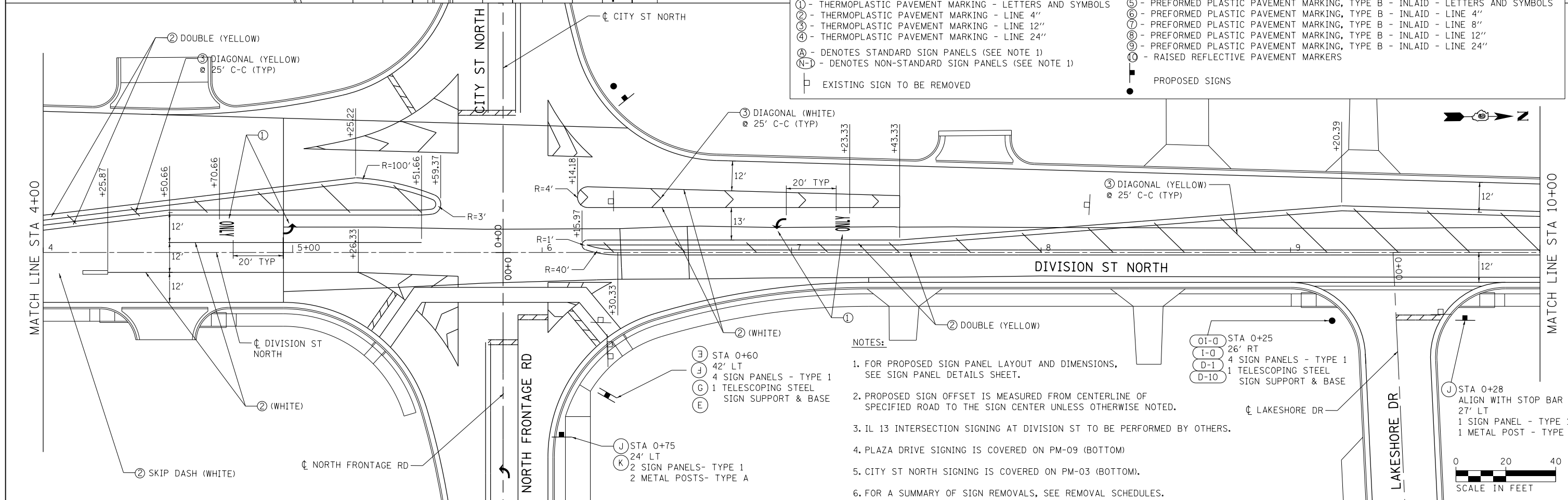

LEGEND

① - THERMOPLASTIC PAVEMENT MARKING - LETTERS AND SYMBOLS	⑤ - PREFORMED PLASTIC PAVEMENT MARKING, TYPE B - INLAID - LETTERS AND SYMBOLS
② - THERMOPLASTIC PAVEMENT MARKING - LINE 4"	⑥ - PREFORMED PLASTIC PAVEMENT MARKING, TYPE B - INLAID - LINE 4"
③ - THERMOPLASTIC PAVEMENT MARKING - LINE 12"	⑦ - PREFORMED PLASTIC PAVEMENT MARKING, TYPE B - INLAID - LINE 8"
④ - THERMOPLASTIC PAVEMENT MARKING - LINE 24"	⑧ - PREFORMED PLASTIC PAVEMENT MARKING, TYPE B - INLAID - LINE 12"
(A) - DENOTES STANDARD SIGN PANELS (SEE NOTE 1)	⑨ - PREFORMED PLASTIC PAVEMENT MARKING, TYPE B - INLAID - LINE 24"
(N) - DENOTES NON-STANDARD SIGN PANELS (SEE NOTE 1)	Ⓜ - RAISED REFLECTIVE PAVEMENT MARKERS
□ - EXISTING SIGN TO BE REMOVED	● - PROPOSED SIGNS

- NOTES:**
- FOR PROPOSED SIGN PANEL LAYOUT AND DIMENSIONS, SEE SIGN PANEL DETAILS SHEET.
 - PROPOSED SIGN OFFSET IS MEASURED FROM CENTERLINE OF SPECIFIED ROAD TO THE SIGN CENTER UNLESS OTHERWISE NOTED.
 - IL 13 INTERSECTION SIGNING AT DIVISION ST TO BE PERFORMED BY OTHERS.
 - PLAZA DRIVE SIGNING IS COVERED ON PM-09 (BOTTOM)
 - CITY ST NORTH SIGNING IS COVERED ON PM-03 (BOTTOM).
 - FOR A SUMMARY OF SIGN REMOVALS, SEE REMOVAL SCHEDULES.

FILE NAME =
 D978258-sht-pmk-05.dgn
CH2MHILL

USER NAME = mfox
 DESIGNED - KN
 DRAWN - AS
 CHECKED -
 DATE -

REVISED -
 REVISED -
 REVISED -
 REVISED -

STATE OF ILLINOIS
DEPARTMENT OF TRANSPORTATION

PAVEMENT MARKING AND SIGNING PLAN
DIVISION STREET NORTH
 SCALE: SHEET NO. 5 OF 16 SHEETS STA. 0+00.00 TO STA. 10+00.00

F.A.P. RTE.	SECTION	COUNTY	TOTAL SHEETS	SHEET NO.
331	(1-4)R-2, N-4, TS-4	WILLIAMSON	381	226
DRAWING NO. PM-05			CONTRACT NO. 78258	
ILLINOIS FED. AID PROJECT				