

**NOTES:**

1. FOR PROPOSED SIGN PANEL LAYOUT AND DIMENSIONS, SEE SIGN PANEL DETAILS SHEET.
2. PROPOSED SIGN OFFSET IS MEASURED FROM CENTERLINE OF SPECIFIED ROAD TO THE SIGN CENTER UNLESS OTHERWISE NOTED.
3. FOR A SUMMARY OF SIGN REMOVALS, SEE REMOVAL SCHEDULES.

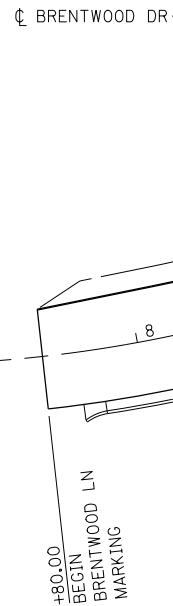

- ⊕-N STA 9+75
- ⊕-N 32' LT
- N-2 4 SIGN PANELS - TYPE 1
- N-3 1 TELESCOPING STEEL SIGN SUPPORT & BASE

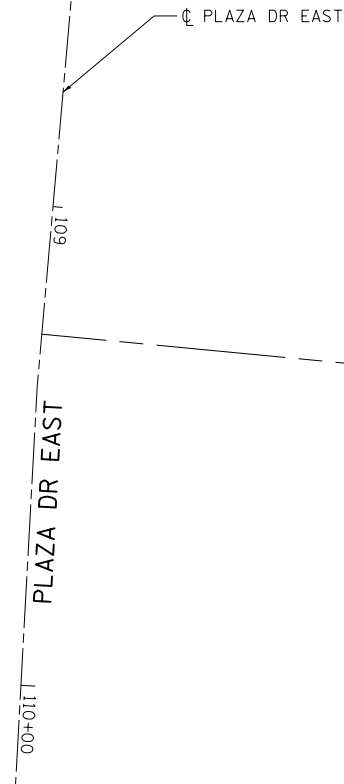

- ② (WHITE)
- ④ (WHITE)

- J
- STA 9+72
- ALIGN WITH STOP BAR
- 41' RT
- 1 SIGN PANEL - TYPE 1
- 1 METAL POST - TYPE B



LEGEND	
① - THERMOPLASTIC PAVEMENT MARKING - LETTERS AND SYMBOLS	⑤ - PREFORMED PLASTIC PAVEMENT MARKING, TYPE B - INLAID - LETTERS AND SYMBOLS
② - THERMOPLASTIC PAVEMENT MARKING - LINE 4"	⑥ - PREFORMED PLASTIC PAVEMENT MARKING, TYPE B - INLAID - LINE 4"
③ - THERMOPLASTIC PAVEMENT MARKING - LINE 12"	⑦ - PREFORMED PLASTIC PAVEMENT MARKING, TYPE B - INLAID - LINE 8"
④ - THERMOPLASTIC PAVEMENT MARKING - LINE 24"	⑧ - PREFORMED PLASTIC PAVEMENT MARKING, TYPE B - INLAID - LINE 12"
Ⓐ - DENOTES STANDARD SIGN PANELS (SEE NOTE 1)	⑨ - PREFORMED PLASTIC PAVEMENT MARKING, TYPE B - INLAID - LINE 24"
Ⓝ-1 - DENOTES NON-STANDARD SIGN PANELS (SEE NOTE 1)	Ⓞ - RAISED REFLECTIVE PAVEMENT MARKERS
□ - EXISTING SIGN TO BE REMOVED	● - PROPOSED SIGNS

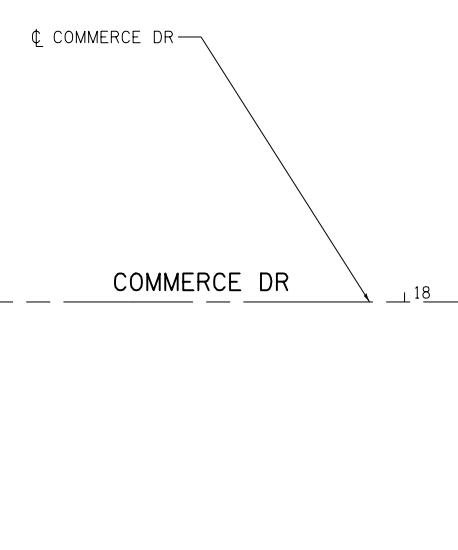
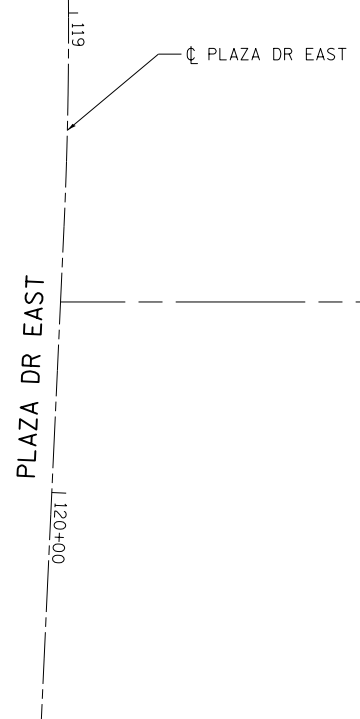

- ② (WHITE)
- ④ (WHITE)

- J
- STA 19+71
- ALIGN WITH STOP BAR
- 31' RT
- 1 SIGN PANEL - TYPE 1
- 1 METAL POST - TYPE B



FILE NAME = D978258-sht-pmk-15.dgn  
**CH2MHILL**

USER NAME = mfox	DESIGNED - KN	REVISED -
PLOT SCALE = 40.0000' / in.	DRAWN - AS	REVISED -
PLOT DATE = 3/11/2013	CHECKED -	REVISED -
	DATE -	REVISED -

**STATE OF ILLINOIS  
DEPARTMENT OF TRANSPORTATION**

**PAVEMENT MARKING AND SIGNING PLAN  
BRENTWOOD DRIVE AND COMMERCE DRIVE**

SCALE: SHEET NO. 15 OF 16 SHEETS STA. TO STA.

F.A.P. RTE.	SECTION	COUNTY	TOTAL SHEETS	SHEET NO.
331	(1-4)R-2, N-4, TS-4	WILLIAMSON	381	236
DRAWING NO. PM-15			CONTRACT NO. 78258	
ILLINOIS FED. AID PROJECT				