

DATE	
BY	
FINISHED	
SURVEYED	
PLOTTED	
TEMPLATE	
NOTE BOOK	
AREAS CHECKED	
NO.	

DATE	
BY	
ORIGINAL	
SURVEY	
PLOTTED	
TEMPLATE	
NOTE BOOK	
AREAS CHECKED	
NO.	

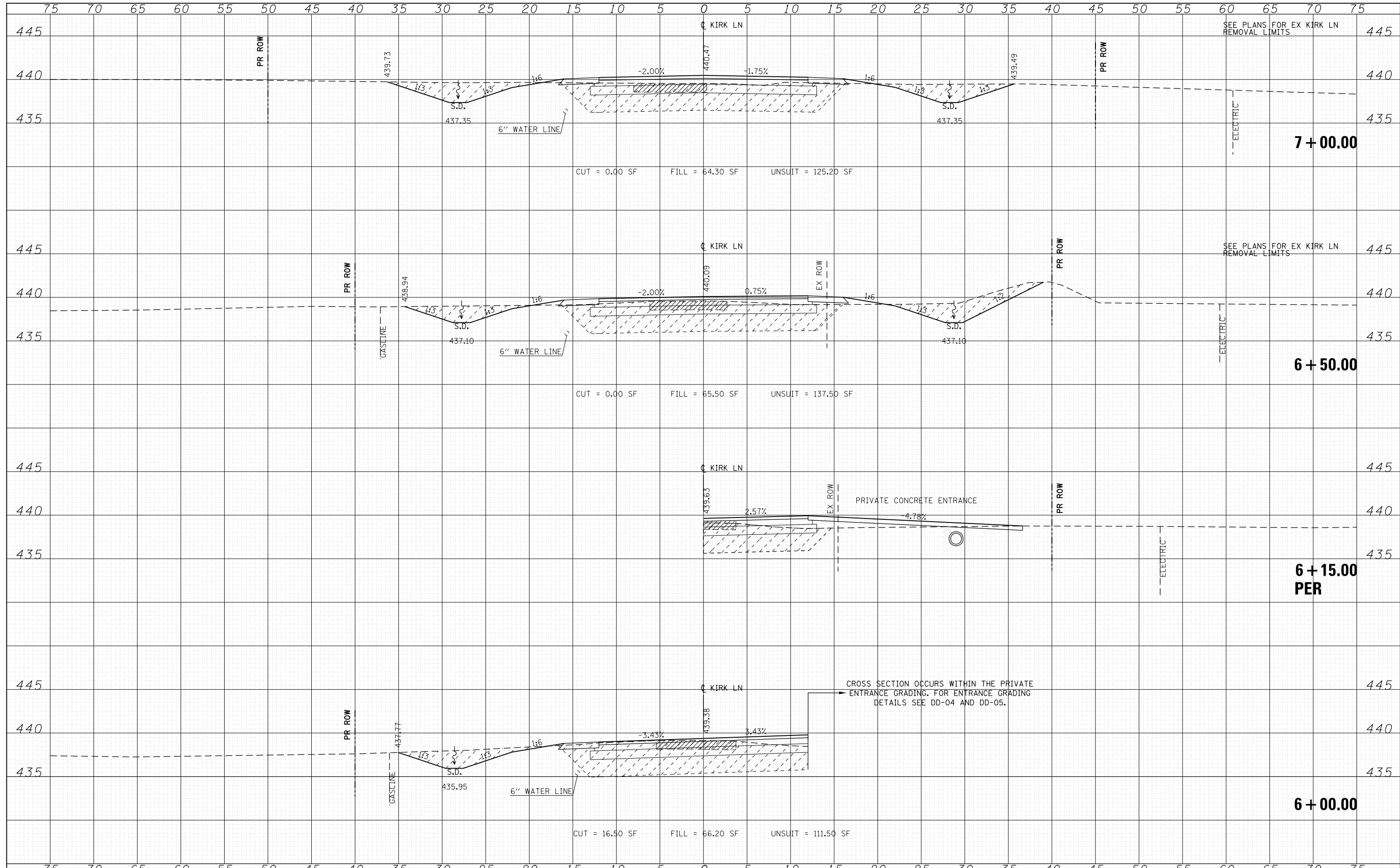

FILE NAME = D978258-sht-xssht-Kirk.dgn
CH2MHILL

USER NAME = mfox	DESIGNED - KN	REVISED -
	DRAWN - AS	REVISED -
PLOT SCALE = 10.0000' / 1"	CHECKED -	REVISED -
PLOT DATE = 3/11/2013	DATE -	REVISED -

**STATE OF ILLINOIS
 DEPARTMENT OF TRANSPORTATION**

**PROPOSED CROSS SECTIONS
 KIRK LANE**

SCALE: SHEET NO. 5 OF 6 SHEETS STA. 6+00.00 TO STA. 7+00.00

F.A.P. RTE.	SECTION	COUNTY	TOTAL SHEETS	SHEET NO.
331	(1-4)R-2, N-4, TS-4	WILLIAMSON	381	376
DRAWING NO. XS-108			CONTRACT NO. 78258	
ILLINOIS FED. AID PROJECT				