

Summary of Quantities

#	Item	Section	Quantity	Unit	Rates/Remarks
1	Special Clearing	201	1	L.S.	
2	Earth Excavation	202	166,224	C.Y.	Compaction required in accordance with Sec. 205.
3	Seeding	250	56.8	Acre	See Schedule - This Sheet
4	Nitrogen Fertilizer Nutrient	250	10,224	Pound	120 lbs./Acre
5	Phosphorous Fertilizer Nutrient	250	4,260	Pound	50 lbs./Acre
6	Potassium Fertilizer Nutrient	250	18,744	Pound	220 lbs./Acre
7	Agricultural Ground Limestone	250	113.6	Ton	4 Tons/Acre
8	Mulch, Method 2, Procedure 1	IDOT 251	56.8	Acre	2 Tons/Acre
9	Erosion Control Blanket	IDOT 251	1,951	S.Y.	
10	Incorporation - Limestone	256	1,136	Ton	40 Tons/Acre
11	Incorporation - Mulch	256	56.8	Ton	2 Tons/Acre
12	Green Manuring	257	28.4	Acre	See "Special Note" Below
13	Mowing	258	28.4	Acre	
14	Perimeter Erosion Barrier	280	1,040	Foot	
15	Stone Riprap A-3	IDOT 281	847	S.Y.	
16	Filter Fabric for use with Riprap	IDOT 282	847	S.Y.	
17	Pipe Culvert 30" Corrugated Polyethylene (PE) with Smooth Interior	IDOT 542	36	Foot	
18	Dewatering Impoundment 1	614	1	L.S.	
19	Dewatering Impoundment 2	614	1	L.S.	
20	Mobilization (Max. 6% of Bid)	671	1	L.S.	

Special Note: Based on the success of the First seeding (March 1, - April 20, 2008) the Department reserves the right to delete the Second seeding, fertilizing, mulching and Green Manuring (August 1, - September 1, 2008) and all costs associated with the work, with no penalty to the Department. The fertilization and Mowing scheduled for (April 1, - May 1, 2009) would then be changed to (August 1, - September 1, 2008).

Schedule of Seeding, Fertilizer Nutrients, Mulch and Mowing

ITEM (unit)	March 1, - April 20, 2008	August 1, - September 1, 2008	April 1, - May 1, 2009	TOTAL QUANTITY
SEEDING (acres)	28.4 Acres	28.4 Acres		56.8 Acres
AGRICULTURAL GROUND LIMESTONE (tons)	56.8 Tons 2 Tons/Acre	56.8 Tons 2 Tons/Acre (for Green Manuring)		113.6 Tons
NITROGEN FERTILIZER NUTRIENT (pounds)	3,408 Pounds 120 Lbs./Acre	3,408 Pounds 120 Lbs./Acre	3,408 Pounds 120 Lbs./Acre	10,224 Pounds
PHOSPHOROUS FERTILIZER NUTRIENT (pounds)	1,420 Pounds 50 Lbs./Acre	1,420 Pounds 50 Lbs./Acre	1,420 Pounds 50 Lbs./Acre	4,260 Pounds
POTASSIUM FERTILIZER NUTRIENT (pounds)	6,248 Pounds 220 Lbs./Acre	6,248 Pounds 220 Lbs./Acre	6,248 Pounds 220 Lbs./Acre	18,744 Pounds
MULCH, METHOD 2 PROCEDURE 1 (acres)	28.4 Acres 2 Tons/Acre	28.4 Acres 2 Tons/Acre		56.8 Acres
MOWING (acres)			28.4 Acres	28.4 Acres
GREEN MANURING		28.4 Acres		28.4 Acres

GENERAL NOTES

Unless otherwise noted on the plans, all disturbed areas within the construction limits will be amended with agricultural ground limestone, fertilizer nutrients, seeded and mulched at the required rates specified in the plans.

The contractor is responsible for visiting the site and familiarizing himself with the existing conditions and the proposed reclamation work prior to submitting a bid.

The contractor shall provide and pay for all field engineering services to execute the project as specified in the Field Engineering section of the Special Provisions.

The contractor is responsible for locating and protecting all existing utility lines pertaining to the work.

Unless noted on the plans, all onsite access roads may be used for construction and must be maintained during construction and restored to original or better condition at the completion of work by the contractor. Access roads to the site as designated in the plans are to be maintained to the satisfaction of the engineer.

The construction limits will be staked by the contractor prior to construction. The contractor is responsible for the repair and or restitution at his own expense for all damages done to any area outside the construction limits.

Application rates specified in the plans are shown in the Summary of Quantities-Rates/Remarks column.

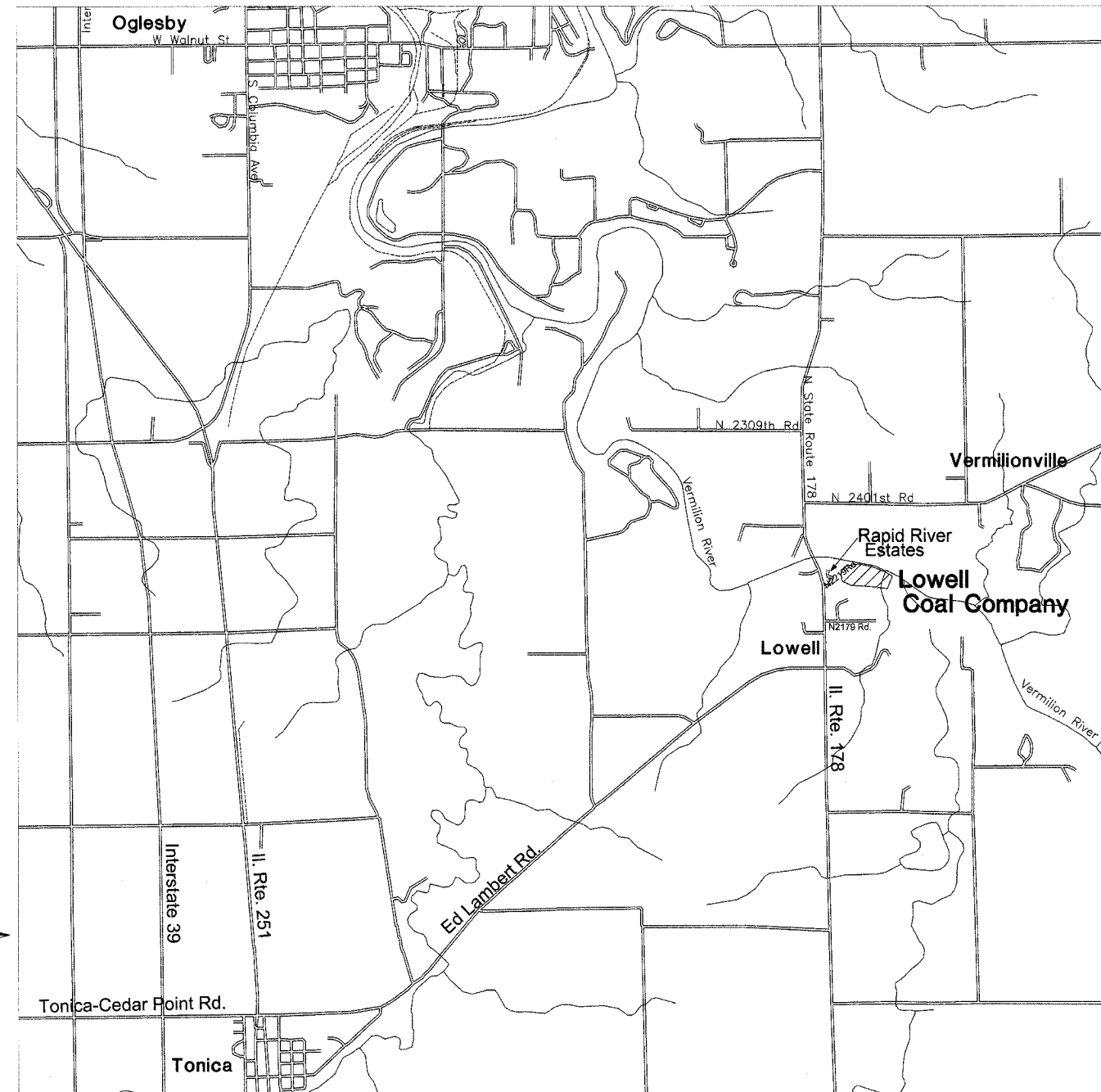

Location Map

CONSTRUCTION NOTES

BURIAL/REMOVAL OF MATERIAL--Concrete and masonry debris designated for burial by the engineer shall be buried at least three feet below proposed final grade. Onsite organic debris and trash shall be disposed of in an engineer approved offsite landfill in accordance with Sections 201 and 501 of the Special Provisions.

TREE REMOVAL--Trees removed shall be disposed of onsite per Section 201 of the Special Provisions. Clearing of trees shall be completed between Oct 1 and March 31.

ACID WATER TREATMENT--If acid mine drainage treatment is determined necessary by the engineer, and not otherwise specified in the plans, any water treatment will be paid for in accordance with Article 109.04 of the Standard Specifications.

EROSION CONTROL--The contractor shall schedule his operations and take such precautions that may be necessary to prevent or minimize erosion. Failure to comply with this requirement shall cause the contractor to be fully responsible for repairing any eroded areas and cleaning up areas or drainage structures that have become silted in or damaged.

AGRICULTURAL GROUND LIMESTONE--Immediately prior to seed bed preparation, fertilizer nutrients and agricultural ground limestone shall be uniformly spread at the rates specified in the plans.

MULCHING--Within 24 hours from the time seeding has been performed, the seeded area shall be given a covering of mulch at the rates specified in the plans. The mulch is to be anchored into the soil in accordance with the requirements for method 2, procedure 1 of Article 251.03 of the Standard Specifications. If Excelsior or Special Excelsior Blanket is to be used, the blanket shall be placed the same day that the areas are seeded.