

F.A. RTE.	SECTION	COUNTY	TOTAL SHEETS	SHEET NO.
		POPE	60	9
STA.	TO STA.			
FED. ROAD DIST. NO.	ILLINOIS FED. AID PROJECT			
IDNR PROJECT NO. 05-06-008				

- NOTES:
- 1.) ROADWAYS ON THIS SHEET WITH GIVEN STATIONING INVOLVE RESURFACING WITH PROPOSED WIDENING. (SEE PLAN-PROFILE SHEET)
 - 2.) ROADWAYS ON THIS SHEET WITHOUT GIVEN STATIONING INVOLVE A NOMINAL THICKNESS IMPROVEMENT WITH RESPECTIVE LENGTHS GIVEN. (SEE TYPICAL SECTIONS)
 - 3.) DISTRICT OFFICE/SUPERINTENDENT'S OFFICE ENTRANCE ROAD IS 2839.70' EAST OF DIXON SPRINGS STATE PARK MAIN ENTRANCE ROAD. (SEE SITE PLAN SHEET)

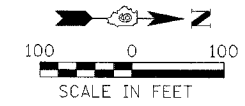
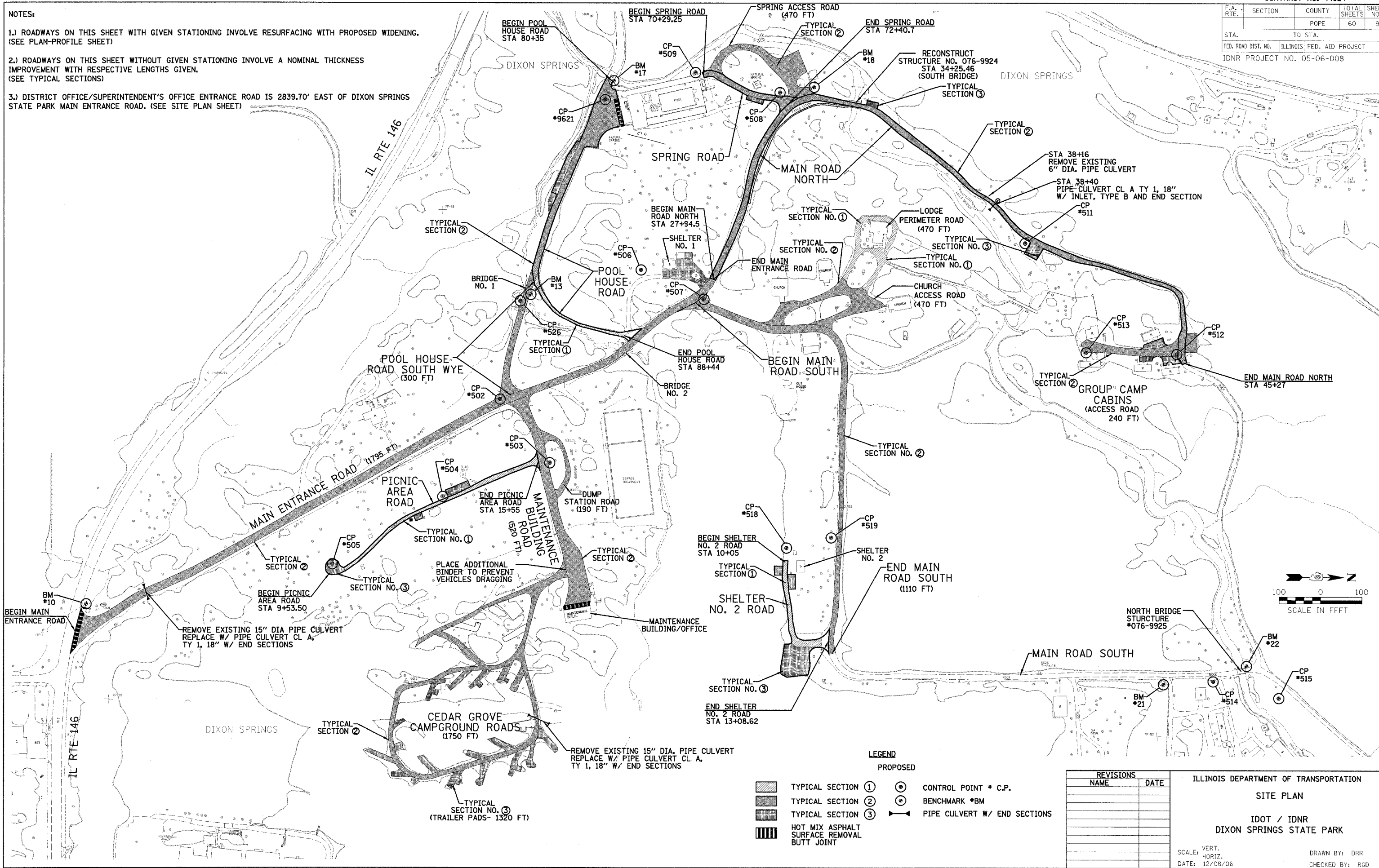

- LEGEND
- PROPOSED
- TYPICAL SECTION ①
 - TYPICAL SECTION ②
 - TYPICAL SECTION ③
 - HOT MIX ASPHALT SURFACE REMOVAL BUTT JOINT
 - CONTROL POINT * C.P.
 - BENCHMARK *BM
 - PIPE CULVERT W/ END SECTIONS

REVISIONS	
NAME	DATE

ILLINOIS DEPARTMENT OF TRANSPORTATION

SITE PLAN

IDOT / IDNR

DIXON SPRINGS STATE PARK

SCALE: VERT. _____

HORIZ. _____

DATE: 12/08/06

DRAWN BY: DRR

CHECKED BY: RGD