

F.A. RTE.	SECTION	COUNTY	TOTAL SHEETS	SHEET NO.
		POPE	60	20
STA.		TO STA.		
FED. ROAD DIST. NO.	ILLINOIS	FED. AID PROJECT		
IDNR PROJECT NO. 05-06-008				

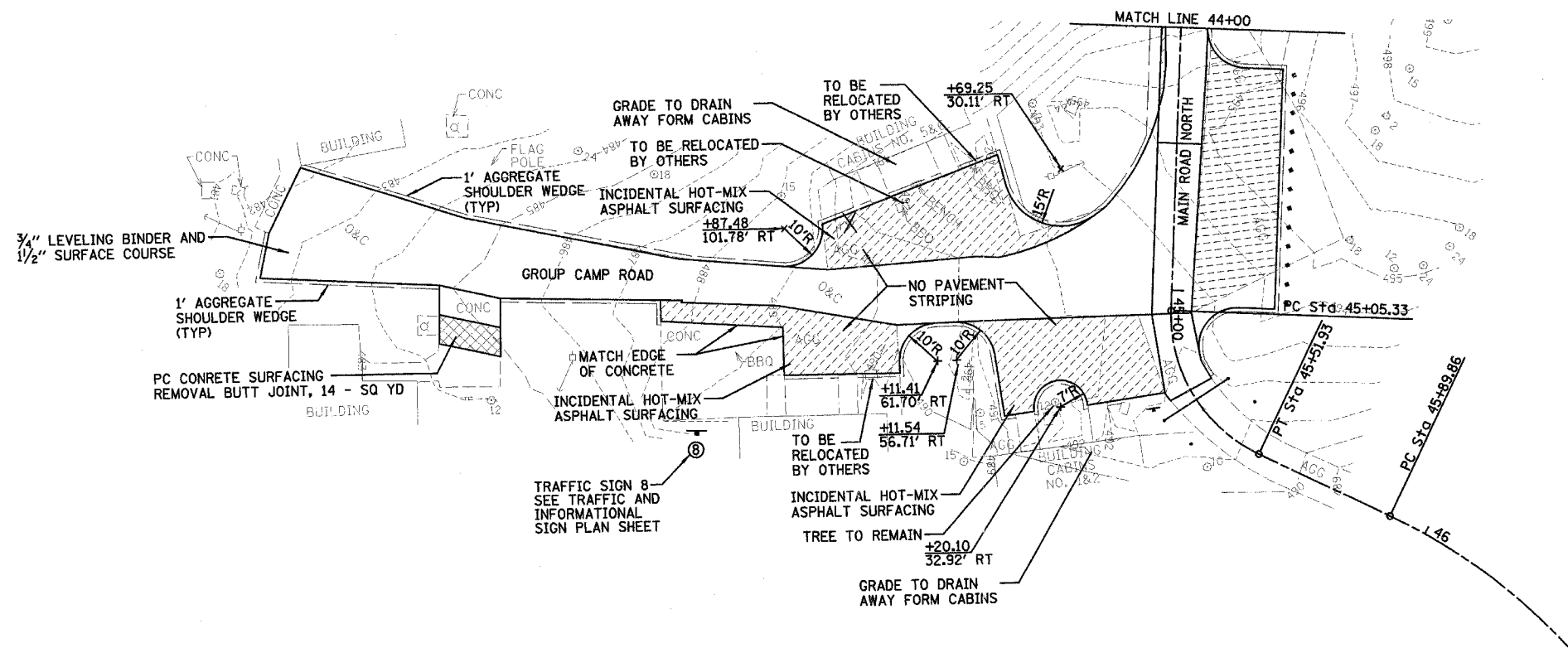

NOTE:
 NO PROFILE SHOWN ON THIS SHEET
 SINCE THIS IS A NOMINAL OVERLAY WITH 3/4 " LEVELING BINDER
 AND 1 1/2 " SURFACING WITH NO EARTH EXCAVATION ON GROUP
 CAMP ROAD. CONSTRUCT AGGREGATE BASE AT A DEPTH OF
 PROVIDE 3 3/4" INCIDENTAL HOT-MIX ASPHALT SURFACING. MATCH
 SURFACE TO ROADWAY SURFACE.

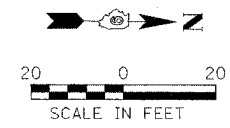

REVISIONS	
NAME	DATE

ILLINOIS DEPARTMENT OF TRANSPORTATION
 GROUP CAMP AREA
 IDOT / IDNR
 DIXON SPRINGS STATE PARK
 SCALE: VERT. _____
 HORIZ. _____
 DATE: 12/08/06
 DRAWN BY: ORR
 CHECKED BY: RGD