

F.A. RTE.	SECTION	COUNTY	TOTAL SHEETS	SHEET NO.
		POPE	60	31
STA.		TO STA.		
FED. ROAD DIST. NO.		ILLINOIS FED. AID PROJECT		

SHEET NO. B5
OF 11 SHEETS

STATE OF ILLINOIS
DEPARTMENT OF TRANSPORTATION

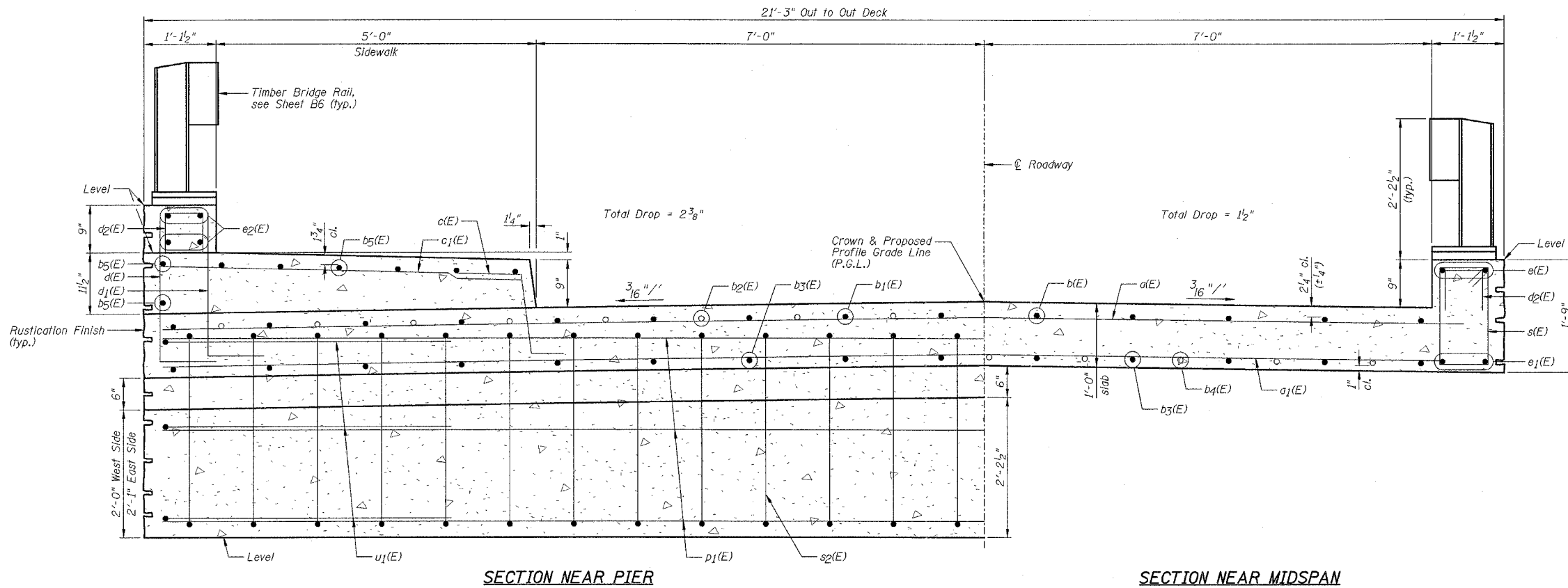

SECTION NEAR PIER

SECTION NEAR MIDSPAN

CROSS SECTION
(Looking North)

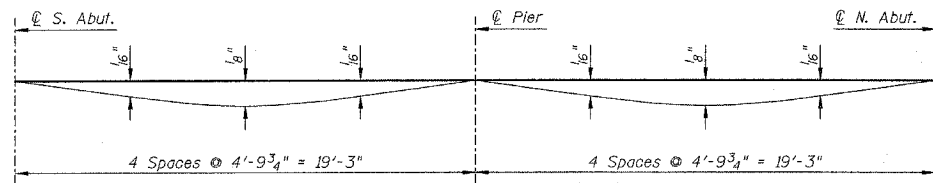

DEAD LOAD DEFLECTION DIAGRAM
(Includes weight of concrete only)

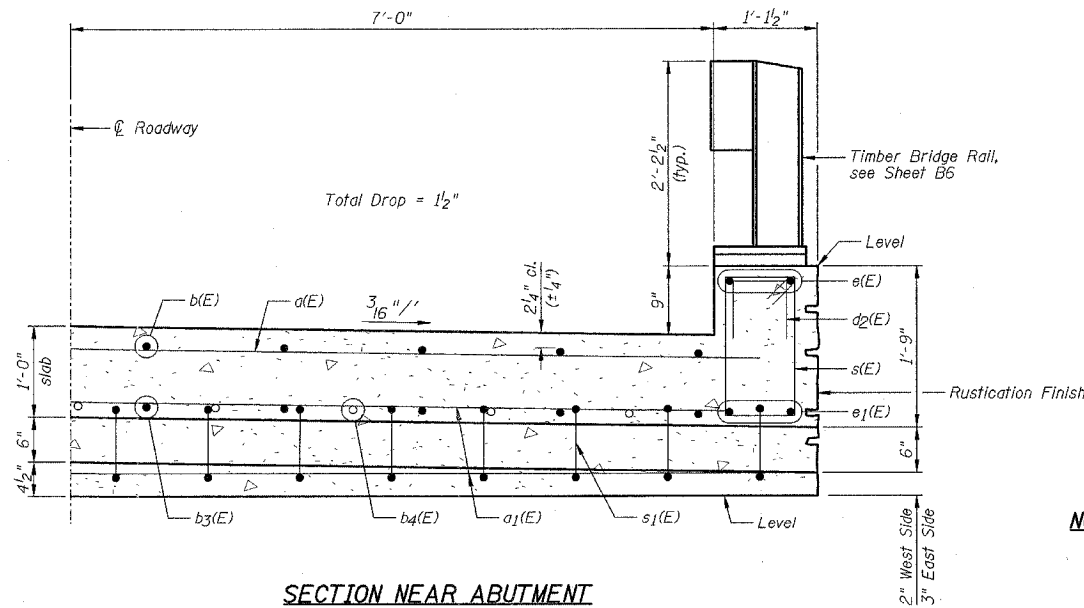

SECTION NEAR ABUTMENT

- NOTES:**
- 1) Work this sheet with Sheets B3 & B4.
 - 2.) Reinforcement bars designated (E) shall be epoxy coated.

REVISIONS	
NAME	DATE
DJM	4/02/07

ILLINOIS DEPARTMENT OF TRANSPORTATION
SUPERSTRUCTURE CROSS SECTION
DIXON SPRINGS STATE PARK
ROAD OVER HILLS BRANCH
POPE COUNTY
STRUCTURE NO. 076-9924
DESIGNED BY: MJG
DATE: 11/30/06
DRAWN BY: DJM
CHECKED BY: MSW