

REF-TP003
REF-PP03

CONTRACT NO. 60A91

F.A.P. RTE.	SECTION	COUNTY	TOTAL SHEETS	SHEET NO.
334	111 RS-5 & 116 B-1	MCHEMRY	98	16
STA. TO STA.		FED. ROAD DIST. NO. ILLINOIS FED. AID PROJECT		

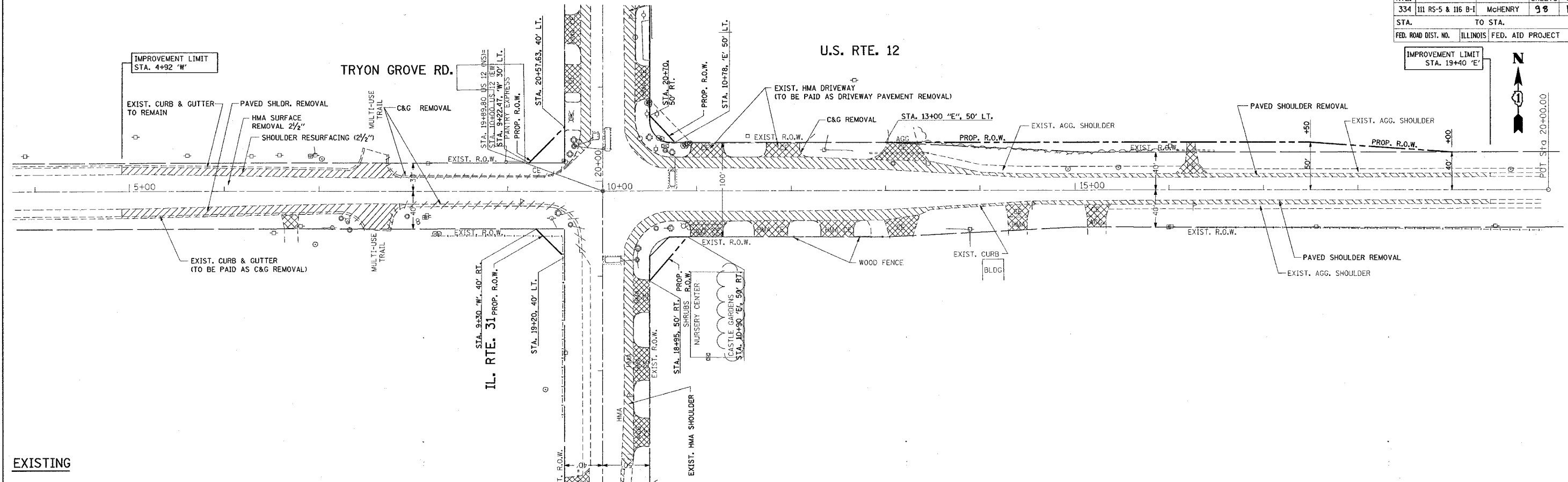

EXISTING

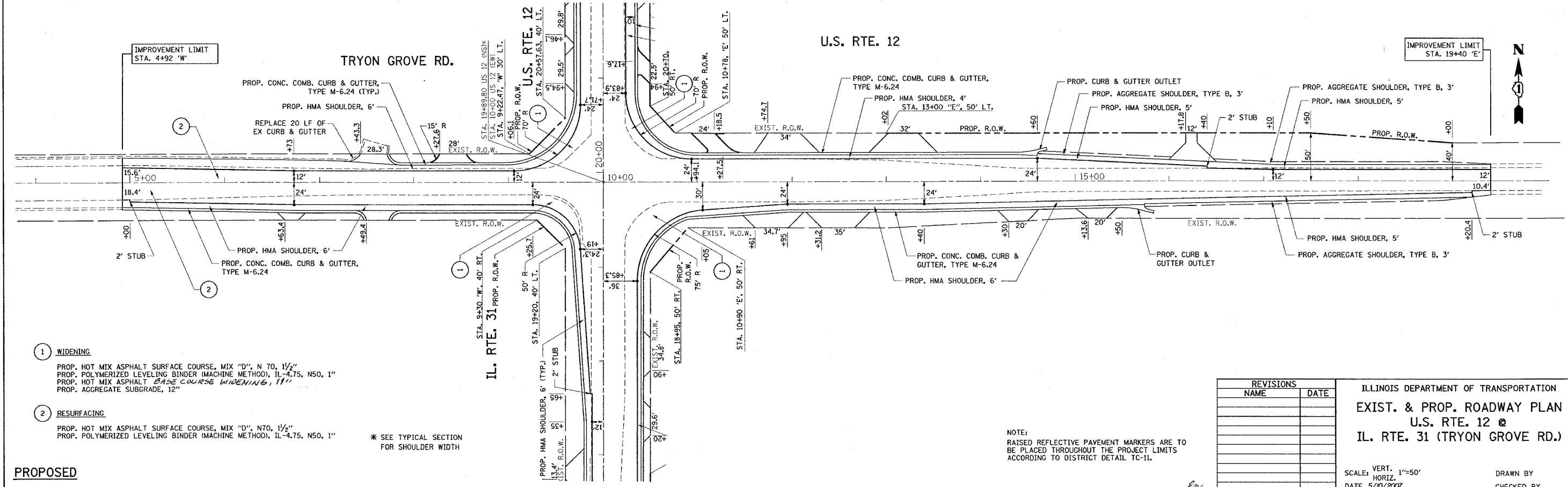

PROPOSED

- ① WIDENING
 PROP. HOT MIX ASPHALT SURFACE COURSE, MIX "D", N 70, 1 1/2"
 PROP. POLYMERIZED LEVELING BINDER (MACHINE METHOD), IL-4.75, N50, 1"
 PROP. HOT MIX ASPHALT BASE COURSE WIDENING, 1 1/2"
 PROP. AGGREGATE SUBGRADE, 12"
- ② RESURFACING
 PROP. HOT MIX ASPHALT SURFACE COURSE, MIX "D", N70, 1 1/2"
 PROP. POLYMERIZED LEVELING BINDER (MACHINE METHOD), IL-4.75, N50, 1"

* SEE TYPICAL SECTION FOR SHOULDER WIDTH

NOTE:
 RAISED REFLECTIVE PAVEMENT MARKERS ARE TO BE PLACED THROUGHOUT THE PROJECT LIMITS ACCORDING TO DISTRICT DETAIL TC-11.

REVISIONS	
NAME	DATE

ILLINOIS DEPARTMENT OF TRANSPORTATION
 EXIST. & PROP. ROADWAY PLAN
 U.S. RTE. 12 @
 IL. RTE. 31 (TRYON GROVE RD.)

SCALE: VERT. 1"=50'
 HORIZ. DATE 5/10/2007

DRAWN BY
 CHECKED BY

PLOT DATE = 5/10/2007
 FILE NAME = C:\Users\jcl14699\My Documents\2.dgn
 PLOT SCALE = 50.0000 / IN.
 USER NAME = board