

REF-TP002  
REF-PP02

CONTRACT NO. 60A91

F.A.P. RTE.	SECTION	COUNTY	TOTAL SHEETS	SHEET NO.
334	III RS-5 & 116 B-I	McHENRY	98	18
STA.		TO STA.		
FED. ROAD DIST. NO.	ILLINOIS	FED. AID PROJECT		

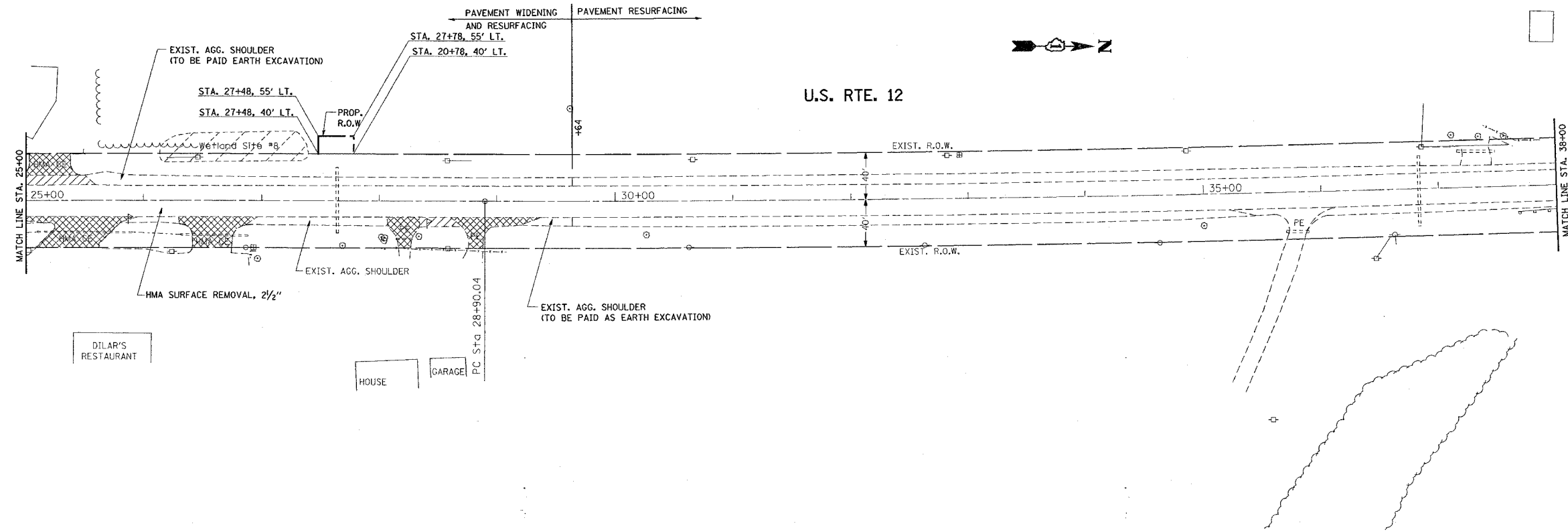

EXISTING

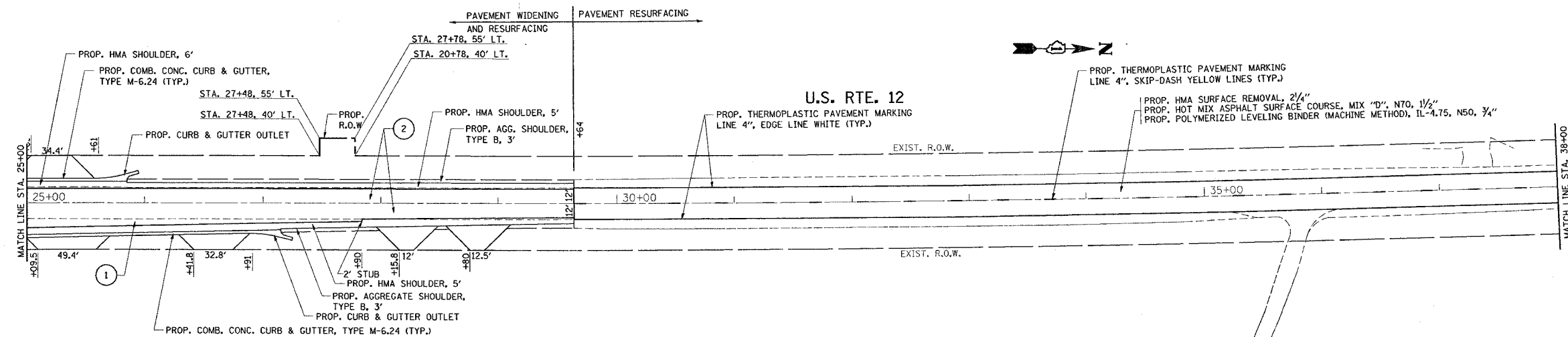

1 WIDENING

PROP. HOT MIX ASPHALT SURFACE COURSE, MIX "D", N 70, 1 1/2"  
PROP. POLYMERIZED LEVELING BINDER (MACHINE METHOD), IL-4.75, N50, 1"  
PROP. HOT MIX ASPHALT BASE COURSE WIDENING, 11"  
PROP. AGGREGATE SUBGRADE, 12"

2 RESURFACING

PROP. HOT MIX ASPHALT SURFACE COURSE, MIX "D", N70, 1 1/2"  
PROP. POLYMERIZED LEVELING BINDER (MACHINE METHOD), IL-4.75, N50, 1"

\* SEE TYPICAL SECTION FOR SHOULDER WIDTH

PROPOSED

REVISIONS	
NAME	DATE

ILLINOIS DEPARTMENT OF TRANSPORTATION  
EXIST. & PROP. ROADWAY PLAN  
U.S. RTE. 12 @  
IL. RTE. 31 (TRYON GROVE RD.)

SCALE: VERT. 1"=50'  
HORIZ. 1"=50'  
DATE 5/10/2007

DRAWN BY  
CHECKED BY

PLOT DATE = 5/10/2007  
FILE NAME = c:\nrcs\msta\0114895\msta\rdwg2.dgn  
PLOT SCALE = 5/8"=1'-0" / IN.  
USER NAME = bward

Rev.