

*REF-er001
*REF-er002

CONTRACT NO. 60A91

F.A.P. RTE.	SECTION	COUNTY	TOTAL SHEETS	SHEET NO.
334	11 RS-5 & 116 B-1	McHENRY	98	36
STA.		TO STA.		
FED. ROAD DIST. NO.		ILLINOIS FED. AID PROJECT		

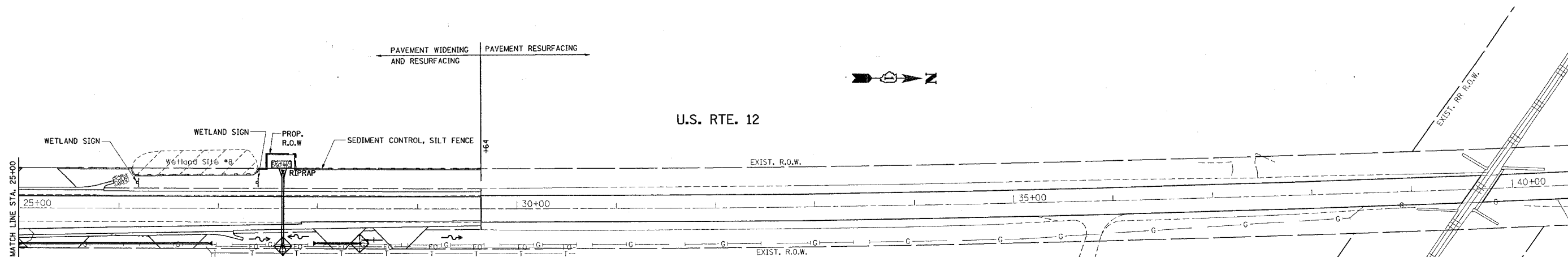
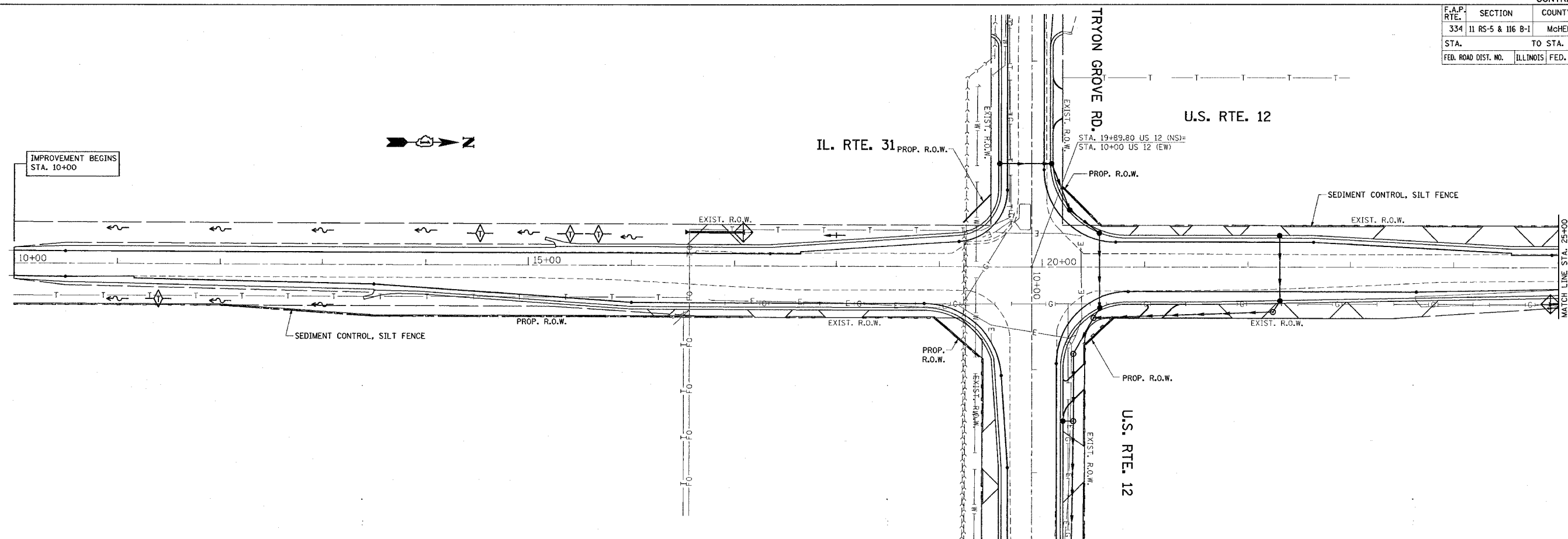

LEGEND FOR EROSION CONTROL NOTES

- SEDIMENT CONTROL, SILT FENCE
- ◇ DITCH CHECK @ EVERY 1' DROP IN DITCH ELEVATION
- SWALE
- DITCH
- ◇ INLET PROTECTION

NOTE: WETLAND SIGN



1. TEMPORARY CONTROL SEEDING TO BE PROVIDED AT ALL ERODIBLE BARE EARTH AREAS, REFER TO SPECIAL PROVISION.
2. NPDES PERMIT IS REQUIRED FOR THE PROJECT.
3. THE CONTRACTORS SHALL PROVIDE AND MAINTAIN INLET PROTECTION AT ALL PROPOSED DRAINAGE STRUCTURES AND AT OTHER LOCATIONS DIRECTED BY THE ENGINEER AND/OR SHOWN ON THE PLANS. INLET PROTECTION SHALL BE PLACED IMMEDIATELY AFTER THE AREA INVOLVED HAS BEEN DISTURBED.
4. ALL EROSION CONTROL MEASURES SHALL BE IN ACCORDANCE WITH THE REQUIREMENTS OF THE STANDARD SPECIFICATION AND THE APPLICABLE STATE STANDARDS SPECIFICATION AND OF THE APPLICABLE STATE STANDARDS FOR THE ENTIRE DURATION OF THE CONTRACT OR UNTIL SUCH A TIME AS DIRECTED BY THE ENGINEER.
5. AT ANY AREA WHERE THERE IS NON PROPOSED GRADING, THE EXISTING GROUND COVER SHALL REMAIN.
6. "WETLANDS" SIGN SHALL BE ATTACHED TO THE SEDIMENT CONTROL SILT FENCE POST AT EACH WETLAND, SIGNS ARE AVAILABLE FROM THE ROADSIDE DEVELOPMENT UNIT (847)705-4171

REVISIONS	
NAME	DATE

ILLINOIS DEPARTMENT OF TRANSPORTATION
EROSION CONTROL PLAN
 U.S. RTE. 12 @
 IL. RTE. 31 (TRYON GROVE RD.)

SCALE: VERT. 1"=50'
 HORIZ. 1"=50'
 DATE 5/10/2007

DRAWN BY
 CHECKED BY

PLOT DATE = 5/10/2007
 FILE NAME = c:\projects\111899\111899_erosion.dgn
 PLOT SCALE = 1/8"=1'-0"
 USER NAME = bauerdl